

WINDOW SCHEDULE

SCALE: 1/4" = 1'-0"

NOTE: ALL GLAZING TO BE TEmPERED GLASS UNLESS SPECIFIED OTHERWISE

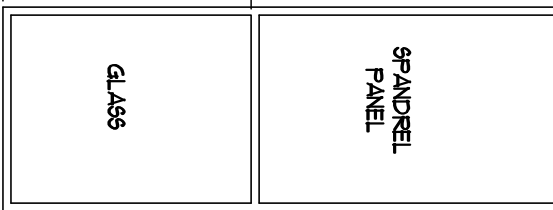
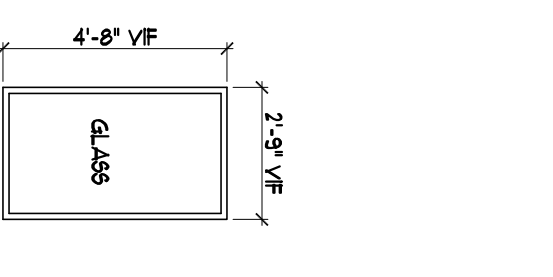
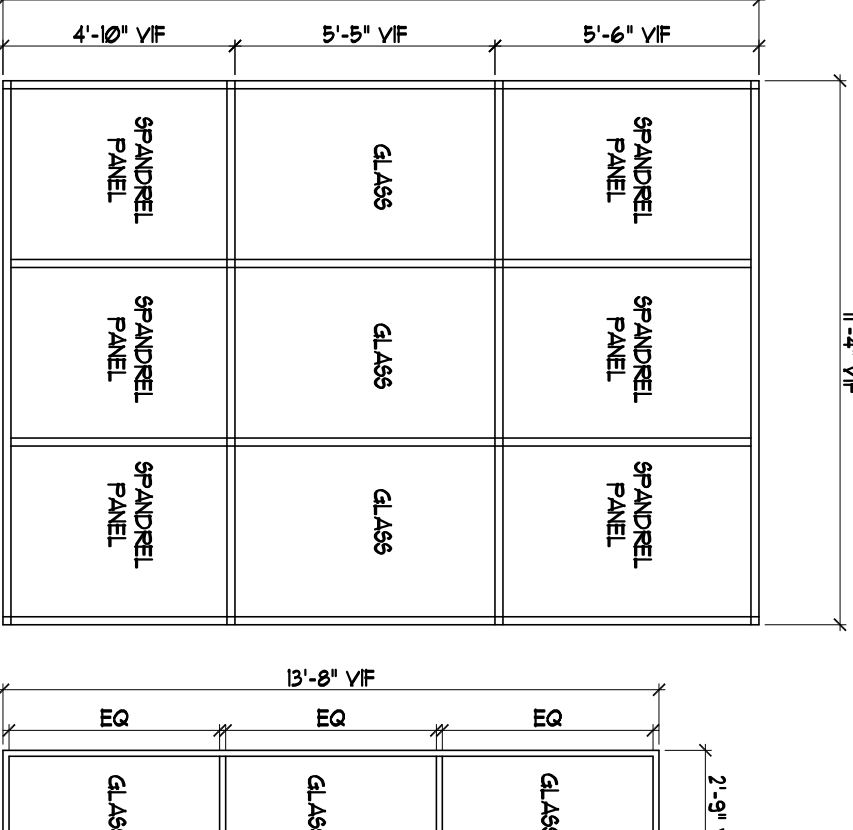
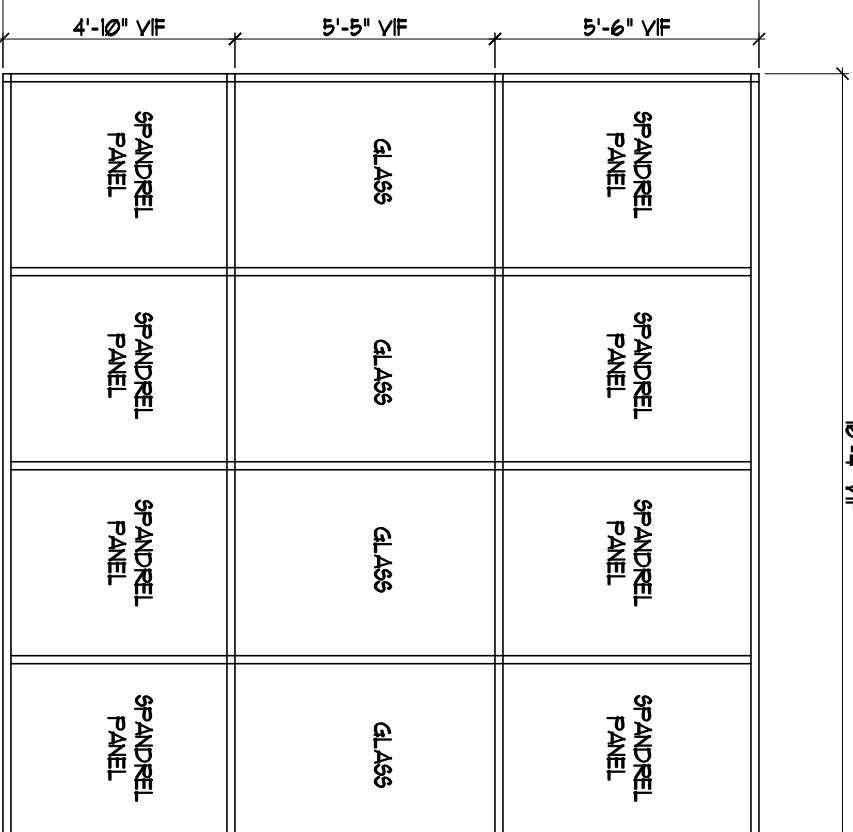
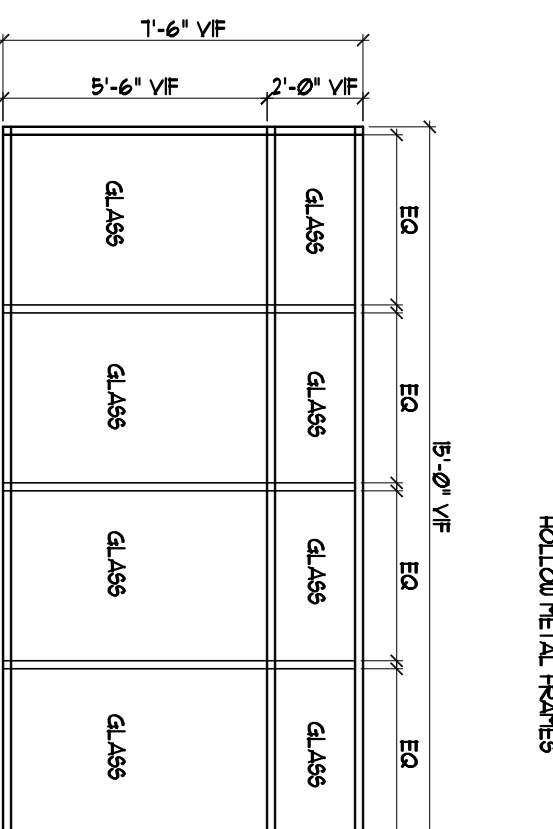
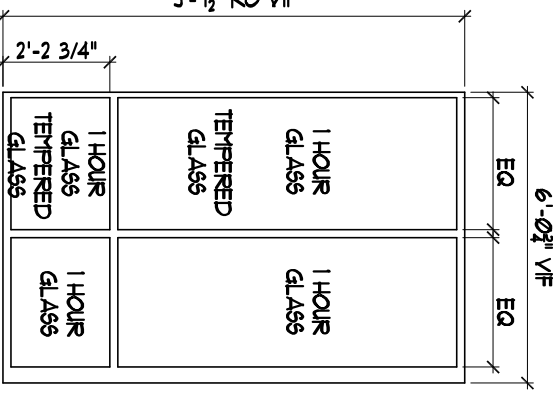
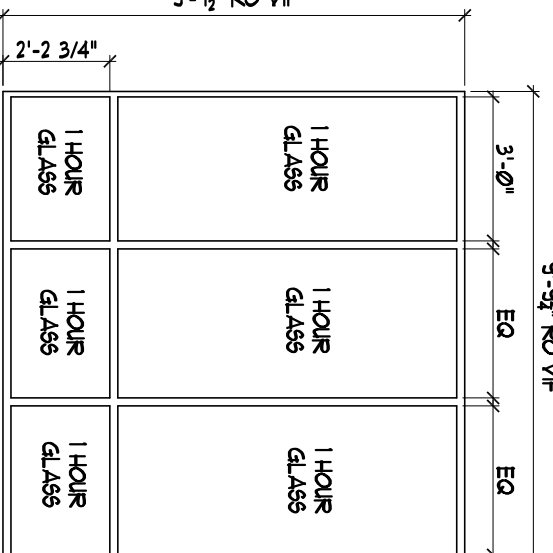
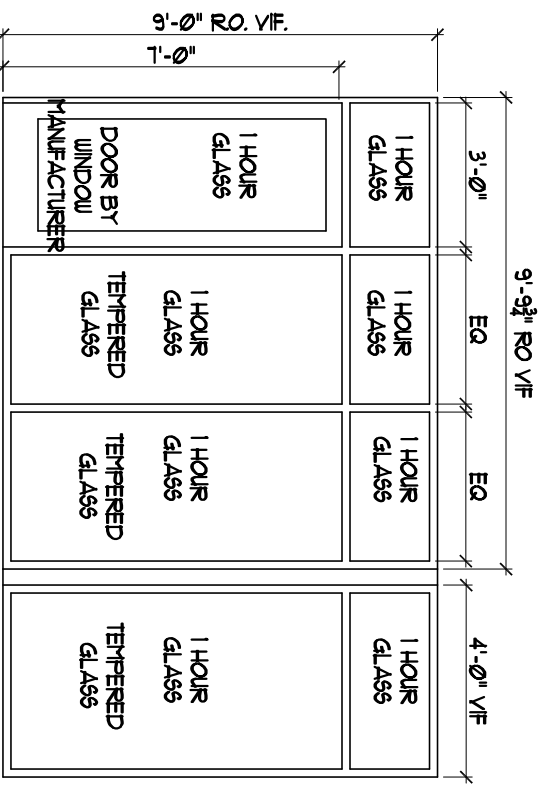
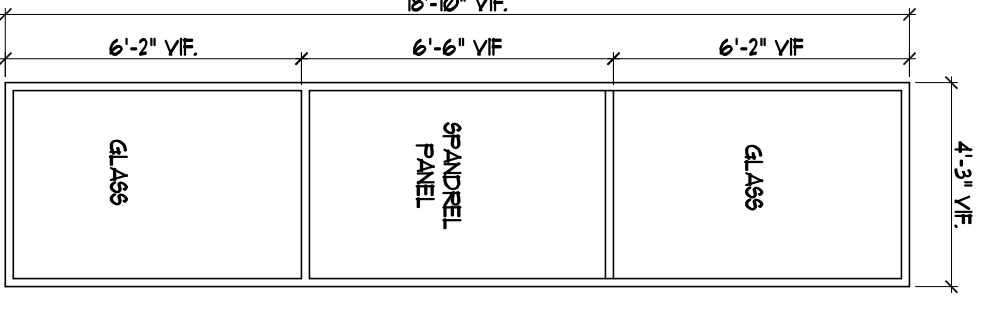
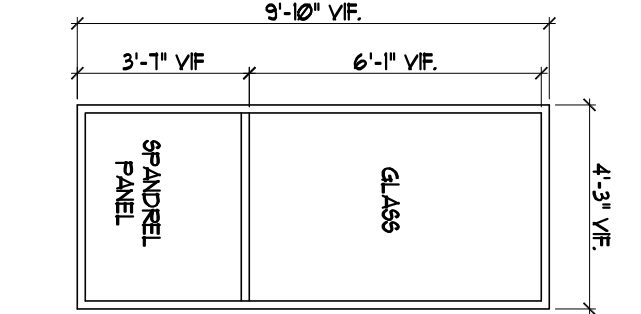
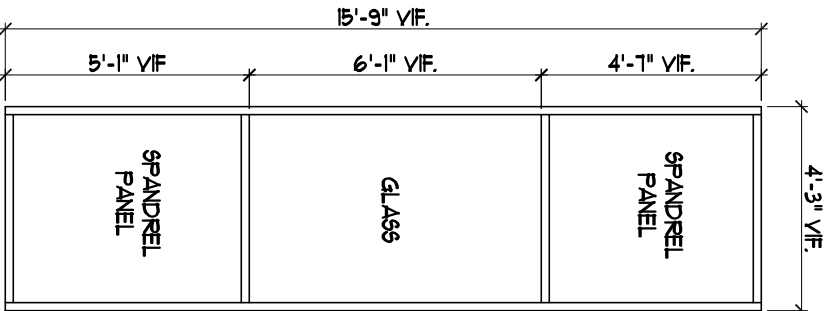
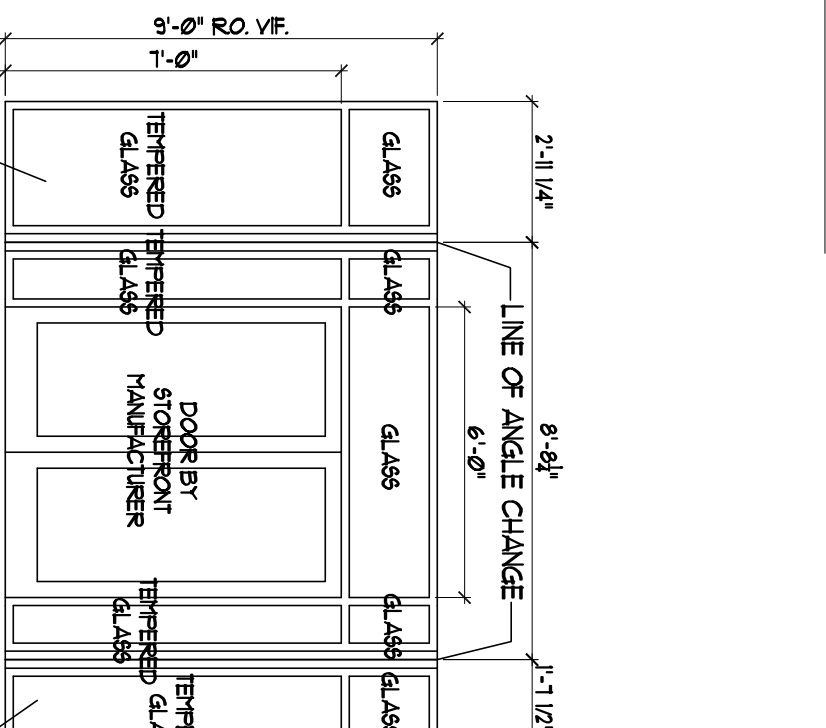
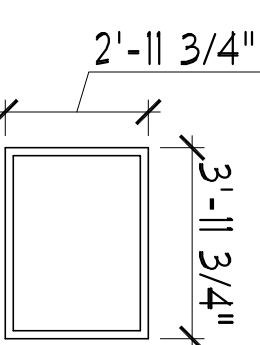
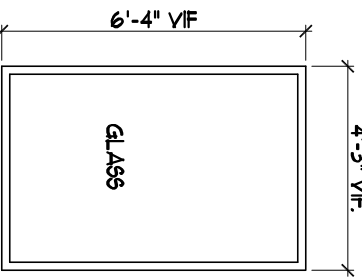
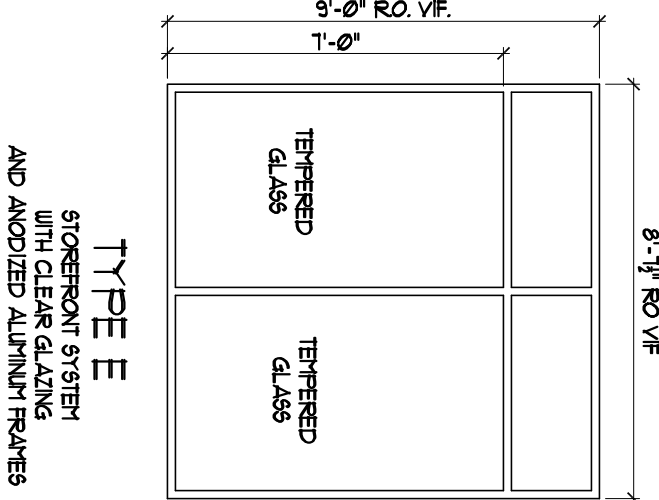
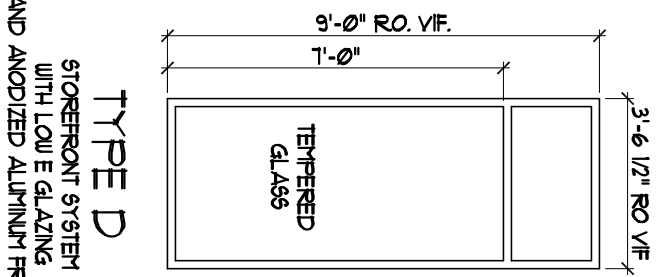
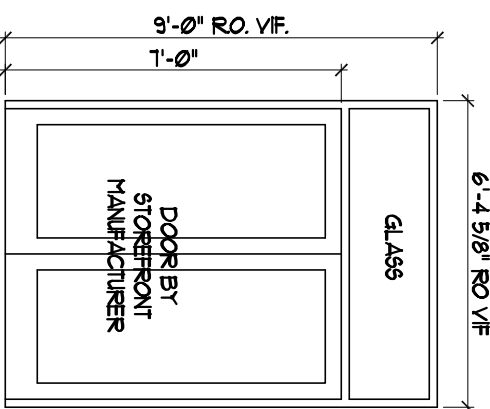
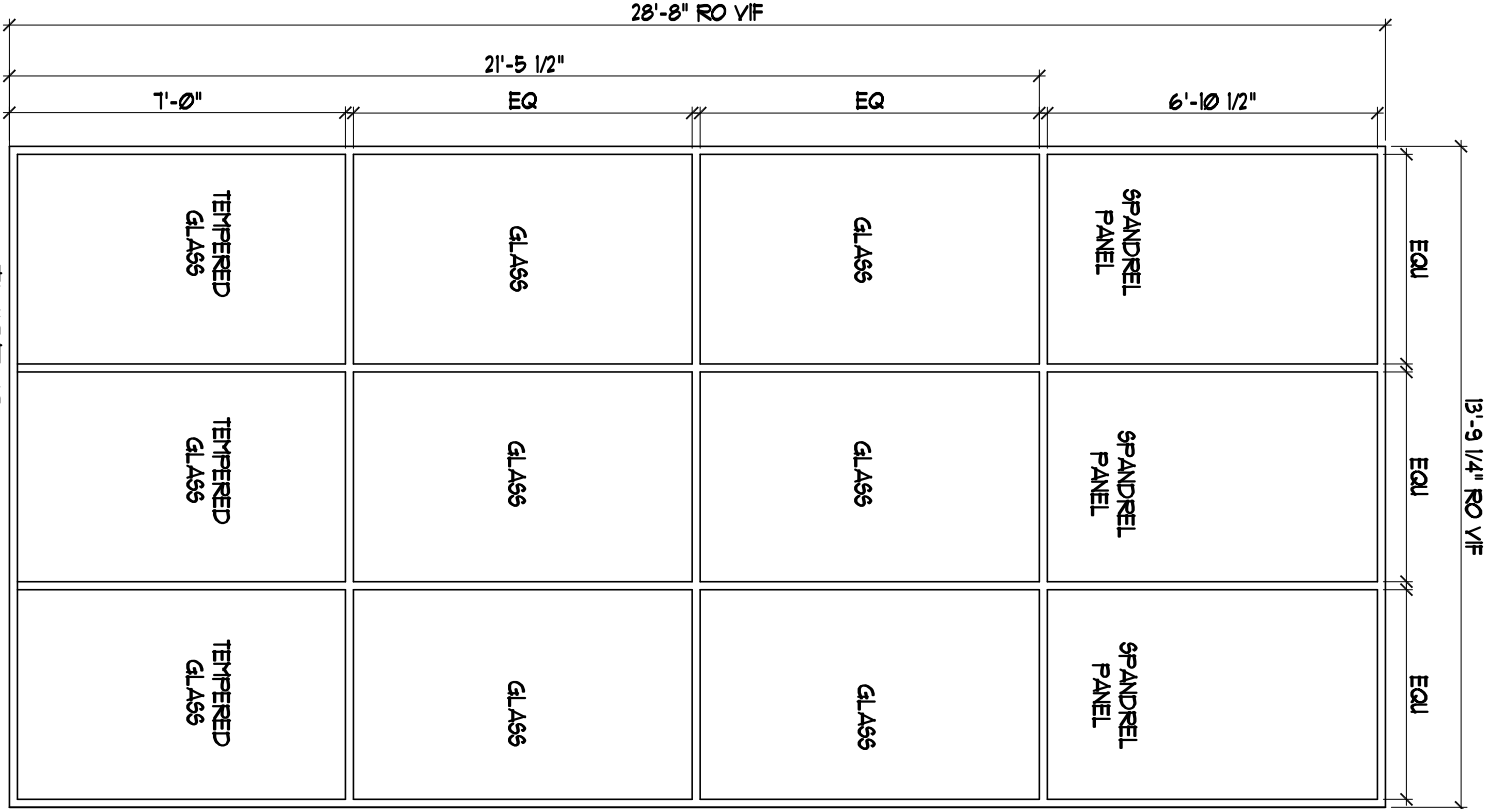
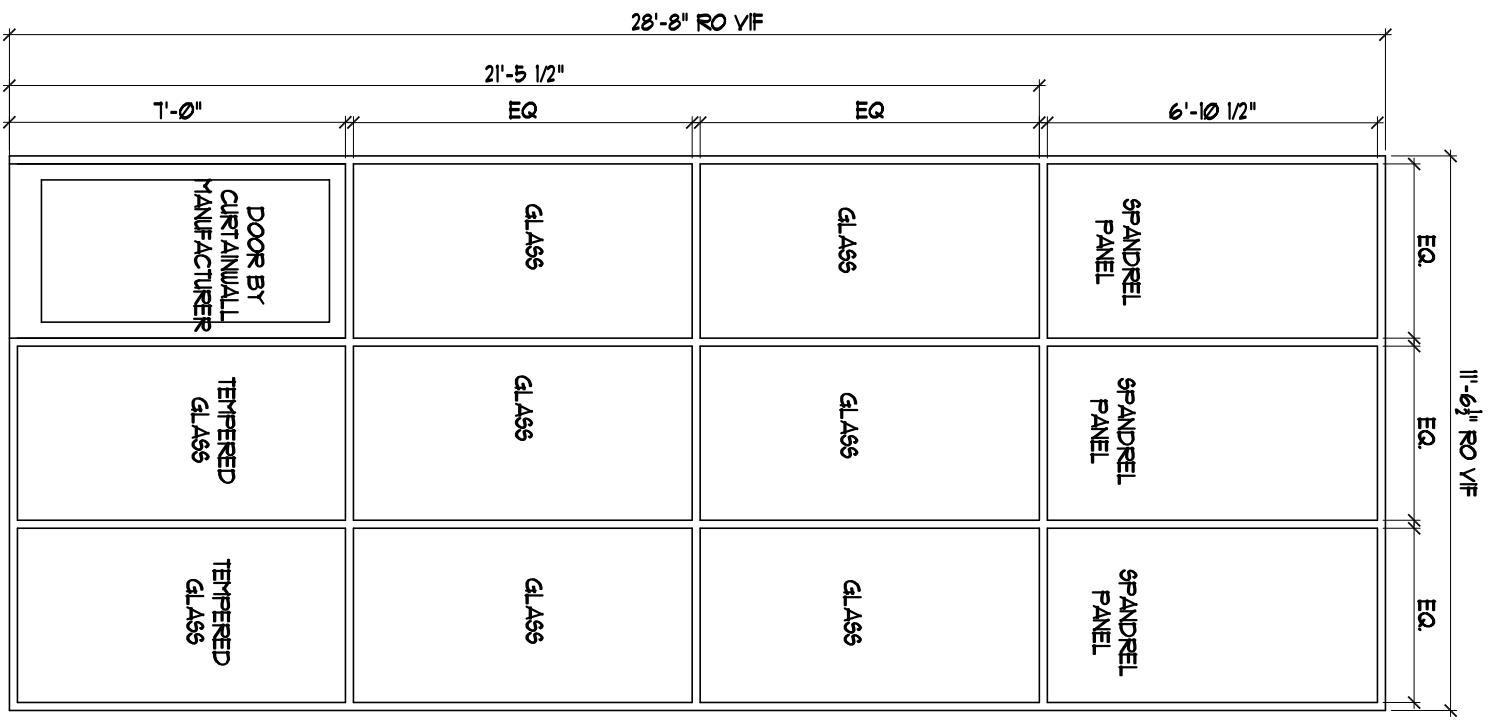

DOOR SCHEDULE

DOOR #	LOCATION	WIDTH HEIGHT x THICKNESS	DOOR			REMARKS
			TYPE	MATERIAL	FRAME	
1	LOBBY ENTRY	6'-0" X 7'-0" X 1 3/4"	A	METAL AND GLASS PAIR OF DOORS	ALUM	DOOR ON CLOSER
2	BANK ENTRY	6'-0" X 7'-0" X 1 3/4"	A	METAL AND GLASS PAIR OF DOORS	METAL	DOOR ON CLOSER
3	STAIR ENTRY	3'-9 3/4" X 7'-0" X 1 3/4"	B	METAL AND GLASS DOOR	METAL	DOOR ON CLOSER VERIFY WIDTH IN FIELD
4	STAIR / LOBBY	3'-0" X 7'-0" X 1 3/4"	B	METAL AND GLASS DOOR	ALUM	DOOR ON CLOSER VERIFY WIDTH IN FIELD
5	2ND FLOOR ENTRANCE	3'-0" X 7'-0" X 1 3/4"	B	METAL AND GLASS DOOR	METAL	DOOR ON CLOSER FIRE RATED GLASS
6	2ND FLOOR BATHROOM	3'-0" X 6'-8" X 1 3/4"	C	PAINTED WOOD DOOR	WOOD	
7	2ND FLOOR BATHROOM	3'-0" X 6'-8" X 1 3/4"	C	PAINTED WOOD DOOR	WOOD	
8	2ND FLOOR CONFERENCE RM	3'-0" X 6'-8" X 1 3/4"	C	PAINTED WOOD DOOR	WOOD	
9	2ND FLOOR CONFERENCE RM	3'-0" X 6'-8" X 1 3/4"	C	PAINTED WOOD DOOR	WOOD	
10	2ND FLOOR BREAKROOM	3'-0" X 6'-8" X 1 3/4"	C	PAINTED WOOD DOOR	WOOD	
11	2ND FLOOR OFFICE	3'-0" X 6'-8" X 1 3/4"	E	PAINTED WOOD DOOR	WOOD	
12	2ND FLOOR OFFICE	3'-0" X 6'-8" X 1 3/4"	E	PAINTED WOOD DOOR	WOOD	
13	2ND FLOOR OFFICE	3'-0" X 6'-8" X 1 3/4"	E	PAINTED WOOD DOOR	WOOD	
14	ELEV MECH ROOM	3'-0" X 6'-8" X 1 3/4"	C	PAINTED WOOD DOOR	WOOD	
15	JANITOR	3'-0" X 6'-8" X 1 3/4"	C	PAINTED WOOD DOOR	WOOD	
16	ELEC ROOM	3'-0" X 6'-8" X 1 3/4"	C	PAINTED WOOD DOOR	WOOD	
17	CLOSET 1	5'-0" X 6'-8" X 1 3/4"	D	PAINTED WOOD DOOR	WOOD	
18	2ND FLOOR OFFICE	3'-0" X 6'-8" X 1 3/4"	E	PAINTED WOOD DOOR	WOOD	

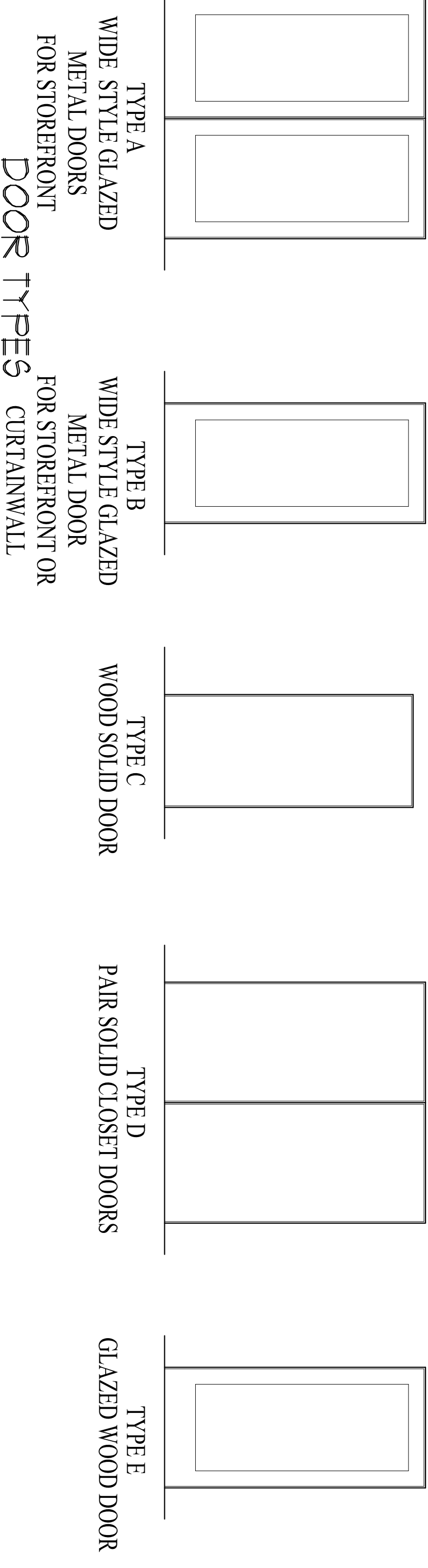

<h1 style="font-size: 48px;">A8</h1>	SCHEDULES	Date 26 APRIL 2010	Scale 1/4" = 1'-0"	ARCHETYPE, P.A. ARCHITECTS 48 Union Wharf Portland, Maine 04101 (207) 772-6022 Fax (207) 772-4056	Prepared for:
	Project: TOWN & COUNTRY 426 FOREST AVENUE PORTLAND, MAINE				