

CONSTRUCTION PLAN

SCALE: 1/4"=1'-0"

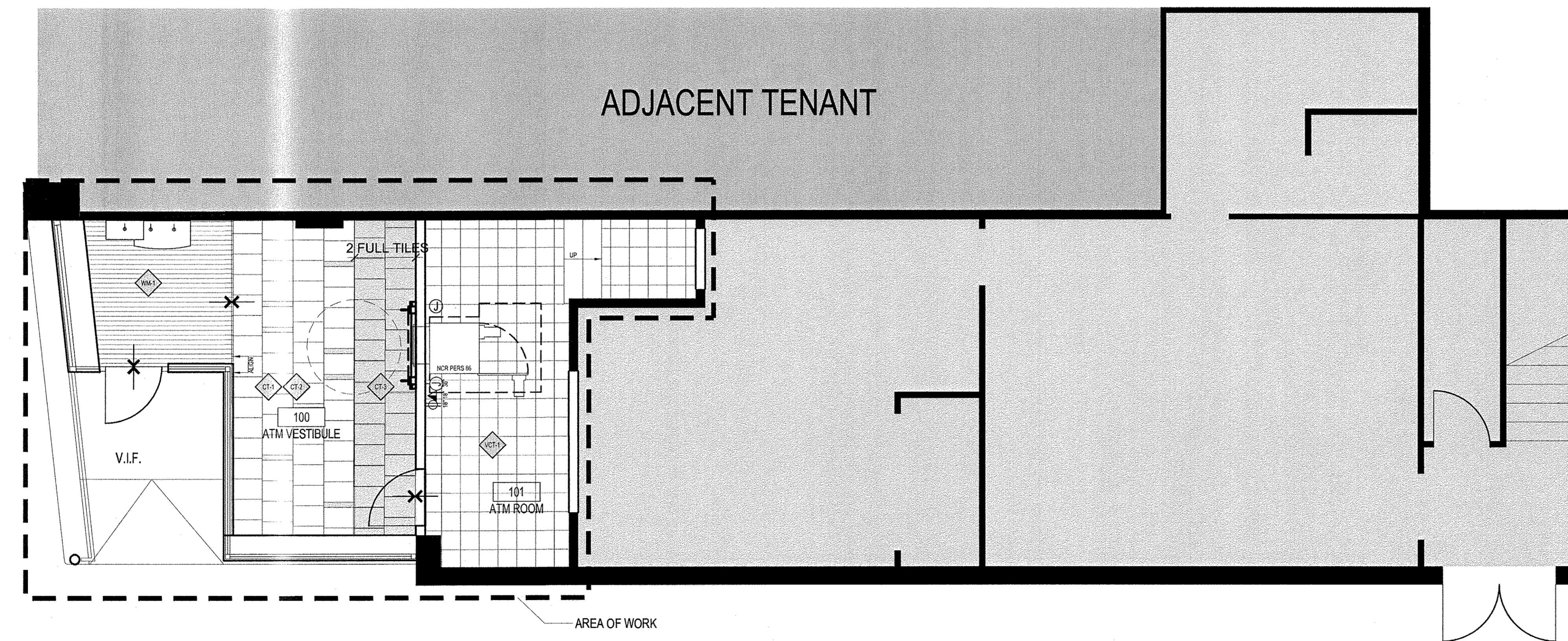

CONSTRUCTION PLAN

SCALE: 1/4"=1'-0"

KEY NOTES

- ① NEW ADA COMPLIANT RAMP. REFER TO CIVIL ENGINEERING DWGS.
- ② NEW 36" DOOR, DOOR FRAME, AND ASSOCIATED HARDWARE.
- ③ NEW COMPLIANT VESTIBULE CHECK DESK. SEE 1/A12.00.
- ④ NEW STOREFRONT SYSTEM TO MATCH EXISTING 'SLOPPED' INSTALLATION.
- ⑤ NEW ADA COMPLIANT NCR PERSONAS 86 WALK UP THROUGH WALL ATM PROVIDED BY OWNER AND INSTALLED BY GC. INSTALL PER OWNERS STANDARDS AND MANUFACTURER INSTRUCTIONS, PROVIDE NECESSARY POWER AND COMMUNICATION CONNECTION.
- ⑥ NEW PARTITION TO MATCH EXISTING FINISHES.
- ⑦ NEW STOREFRONT SYSTEM TO MATCH EXISTING FINISHES.
- ⑧ NEW KNEE WALL TO SUPPORT STOREFRONT ABOVE. REFER TO STRUCTURAL ENGINEERING DRAWINGS.
- ⑨ FINISH FACE OF KNEE WALL TO MATCH EXISTING.
- ⑩ PROVIDE NEW MILLWORK COUNTER.

FINISH SCHEDULE

ITEM	PRODUCT (SEE CONTRACTOR NOTES AT BOTTOM OF PAGE)
CERAMIC TILE	
CT-1	DAL TILE CONTACT; EMAIL: NATIONAL_ACCOUNT@DAL TILE.COM; TOLL FREE NUMBER: 877.596.5728; FAX 214.309.4228 FIELD TILE: 12" X 20" DAL TILE: VERANDA 3/8" THICK TILE SAND P54 - SKURP52413201P GROUT (G-1): STARQUARTZ QUARTZLOCK2 255 SOLID BUFF - SKUR999920741
CT-2	ACCENT TILE: 9" X 20" DAL TILE: VERANDA 3/8" THICK TILE GRAVEL P501 - SKURP501501P1 GROUT (G-1): STARQUARTZ QUARTZLOCK2 255 SOLID BUFF - SKUR999920741
CT-3	ACCENT TILE: 12" X 20" DAL TILE: VERANDA 3/8" THICK TILE SLUEDE P524 - SKURP52413201P GROUT (G-2): STARQUARTZ QUARTZLOCK2 260 CHESTNUT - SKUR999920756
VINYL COMPOSITION TILE	
VCT-1	VINYL COMPOSITION TILE: 12" X 12" ARMSTRONG: 219 TOFFEE
WALK-OFF MAT	
WM-1	REESE PERFECT MAT/RUBBER HINGE TREAD PAIS; ANODIZED ALUMINUM, CLEAR POLYPROPYLENE BRUSH, GRAY/SQUARE VINYL EDGE, BLACK
WALL BASE	
B-2	JOHNSONITE FLEXIBLE WALL BASE, RUBBER, 4 1/2" X 3/8", #283 TOAST.
B-4A	JOHNSONITE FLEXIBLE WALL BASE, RUBBER, 4 1/2" X 3/8", #88 WHITE SAND.
CEILING	
ACT-1	ARMSTRONG: 24"X24" WHITE INTERIOR CEILING PANELS; ASTM E 1284 TYPE 3 FORM 2 PATTERN CE.
PAINT	
P-1	BENJAMIN MOORE: ECO SPEC WB INTERIOR LATEX EGGSHELL ENAMEL NO. 00-122; COLOR: COTTON BALLS
P-2	BENJAMIN MOORE: ECO SPEC WB INTERIOR LATEX SEMI-GLOSS ENAMEL NO. 00-122; COLOR: COTTON BALLS

SHEET NOTES

1. REFER TO A00.00 FOR GENERAL NOTES.
3. ALL NEW PARTITIONS TO BE PAINTED P-1 LION.
4. FURNITURE AND EQUIPMENT LOCATIONS ARE SHOWN FOR INFORMATION ONLY.
5. GC SHALL PROVIDE ALL WORK RELATED TO ENGINEERING TO INCLUDE, BUT NOT LIMITED TO: STRUCTURAL, MECHANICAL, ELECTRICAL, FIRE PROTECTION & LIFE SAFETY. GC SHALL PROVIDE DESIGN DRAWINGS, PERMITS & INSTALLATION OF SYSTEMS ON A DESIGN BUILD BASIS.
6. GC IS TO INSTALL THE ELECTRIFIED HARDWARE AND TO PROVIDE THE WIRING AND CONCEALED CONDUIT TO ATM SERVICE ROOM FOR TERMINATION BY OTHERS

EXIT SIGN	EXIT SIGN
FIRE ALARM STROBE	FIRE ALARM STROBE
FIRE ALARM PULL	FIRE ALARM PULL
FIRE WARDEN STATION	FIRE WARDEN STATION
WALL MOUNTED, SINGLE RECEPTACLE	WALL MOUNTED, SINGLE RECEPTACLE
WALL MOUNTED, DUPLEX RECEPTACLE	WALL MOUNTED, DUPLEX RECEPTACLE
WALL MOUNTED, QUADRUPLEX RECEPTACLE	WALL MOUNTED, QUADRUPLEX RECEPTACLE
WALL MOUNTED, VOICE/DATA RECEPTACLE	WALL MOUNTED, VOICE/DATA RECEPTACLE
WALL MOUNTED, DATA RECEPTACLE	WALL MOUNTED, DATA RECEPTACLE
WALL MOUNTED, VOICE RECEPTACLE	WALL MOUNTED, VOICE RECEPTACLE
WALL MOUNTED, ELECTRICAL JUNCTION BOX	WALL MOUNTED, ELECTRICAL JUNCTION BOX
ABOVE CEILING SINGLE GANG J-BOX WITH 1/2" STUB UP.	ABOVE CEILING SINGLE GANG J-BOX WITH 1/2" STUB UP.
CARD READER	CARD READER

**Bank of America
ATM Installation**

500 Forest Avenue
Portland, ME 04101

One Beacon Street
3rd Floor
Boston, MA 02108
Telephone 617.619.5700
Facsimile 617.619.5701

Gensler

Issue	Date & Issue Description	By	Check
1	08/03/2015	DG/CV	JR
ISSUED FOR BID AND PERMIT			

Seal/Signature

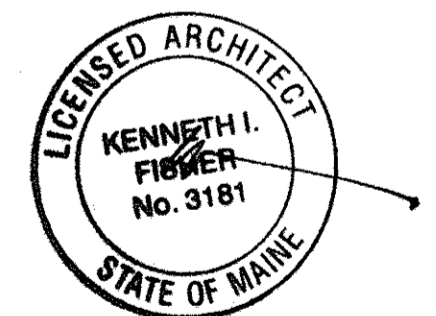

Project Name
BANK OF AMERICA
ATM INSTALLATION

Project Number
11.6563.084

CAD File Name
A02-01

Description
CONSTRUCTION PLAN

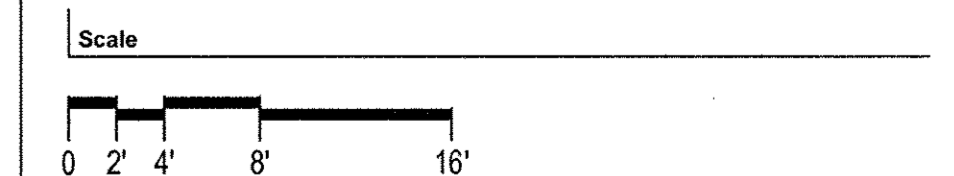

A02.01

©2015 Gensler