

**PERMIT ISSUED**

**City of Portland, Maine - Building or Use Permit Application**  
389 Congress Street, 04101 Tel: (207) 874-8703, Fax: (207) 874-8716

Permit No: 03-0650	Issue Date: <b>JUN 12 2003</b>	CBL: 116 D010001
-----------------------	-----------------------------------	---------------------

Location of Construction: 34 Fessenden St	Owner Name: Shigley Basil Roy &	Owner Address: 34 Fessenden St <b>CITY OF PORTLAND</b>	Phone:
Business Name:	Contractor Name: no contractor / self	Contractor Address: Portland	Phone:
Lessee/Buyer's Name	Phone:	Permit Type: Alterations - Dwellings	Zone: <b>R-5</b>

Past Use: 2 unit	Proposed Use: 2 unit - build rear 10' x 15' deck	Permit Fee: \$37.00	Cost of Work: \$1,900.00	CEO District: 2
		FIRE DEPT: <input type="checkbox"/> Approved <input checked="" type="checkbox"/> Denied <i>NA</i>	INSPECTION: Use Group: <b>R-3</b> Type: <b>SB</b> <b>BOVA 99</b> <i>02</i>	

Proposed Project Description: build 10' x 15' rear deck	Signature:	Signature:
PEDESTRIAN ACTIVITIES DISTRICT (P.A.D.)		
Action: <input type="checkbox"/> Approved <input type="checkbox"/> Approved w/Conditions <input type="checkbox"/> Denied		
Signature:	Date:	

Permit Taken By: trmm	Date Applied For: 06/10/2003	<b>Zoning Approval</b>	
--------------------------	---------------------------------	------------------------	--

- This permit application does not preclude the Applicant(s) from meeting applicable State and Federal Rules.
- Building permits do not include plumbing, septic or electrical work.
- Building permits are void if work is not started within six (6) months of the date of issuance. False information may invalidate a building permit and stop all work..

<b>Special Zone or Reviews</b> <input type="checkbox"/> Shoreland <input type="checkbox"/> Wetland <input type="checkbox"/> Flood Zone <input type="checkbox"/> Subdivision <input type="checkbox"/> Site Plan Maj <input type="checkbox"/> Minor <input type="checkbox"/> MM <input type="checkbox"/> Date: <b>6/12/03</b>	<b>Zoning Appeal</b> <input type="checkbox"/> Variance <input type="checkbox"/> Miscellaneous <input type="checkbox"/> Conditional Use <input type="checkbox"/> Interpretation <input type="checkbox"/> Approved <input type="checkbox"/> Denied Date:	<b>Historic Preservation</b> <input checked="" type="checkbox"/> Not in District or Landmark <input type="checkbox"/> Does Not Require Review <input type="checkbox"/> Requires Review <input type="checkbox"/> Approved <input type="checkbox"/> Approved w/Conditions <input type="checkbox"/> Denied Date: <b>6/12/03</b>
--	---	---

**CERTIFICATION**

I hereby certify that I am the owner of record of the named property, or that the proposed work is authorized by the owner of record and that I have been authorized by the owner to make this application as his authorized agent and I agree to conform to all applicable laws of this jurisdiction. In addition, if a permit for work described in the application is issued, I certify that the code official's authorized representative shall have the authority to enter all areas covered by such permit at any reasonable hour to enforce the provision of the code(s) applicable to such permit.

SIGNATURE OF APPLICANT	ADDRESS	DATE	PHONE
RESPONSIBLE PERSON IN CHARGE OF WORK, TITLE		DATE	PHONE

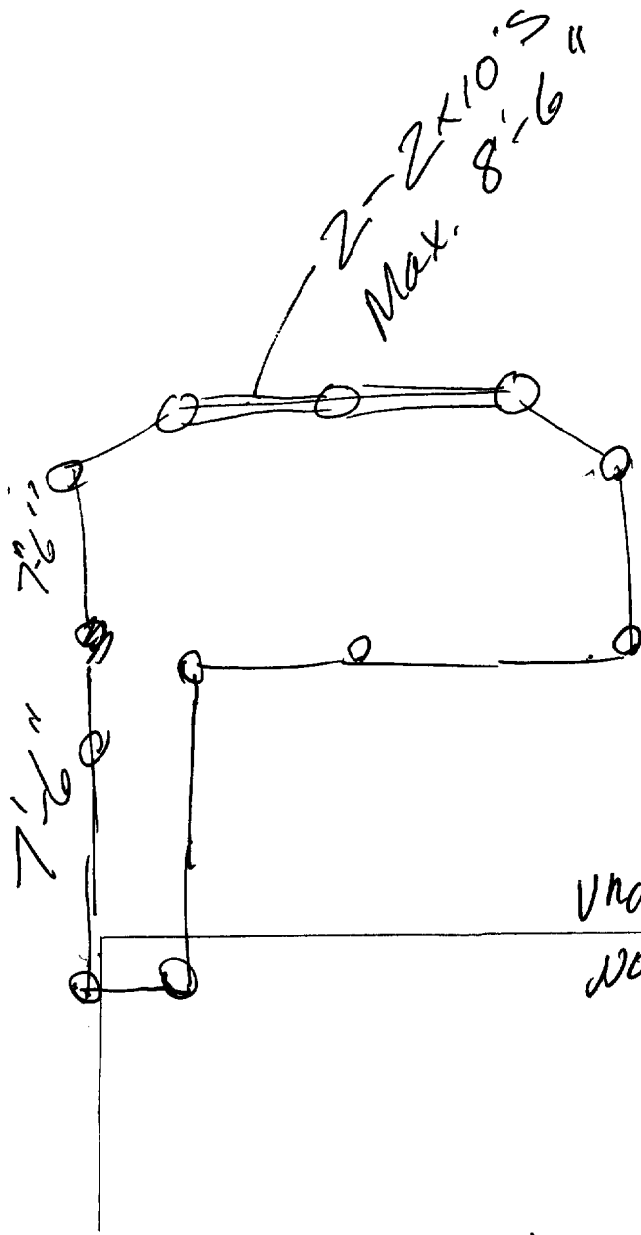

Under 200 SF -  
no frost protection needed.

2x10 framing - w/ Joist hangers -  
4x4 post at 8'  
16 ON CENTER



This page contains a detailed description of the Parcel ID you selected. Press the **New Search** button at the bottom of the screen to submit a new query.

**Current Owner Information**

<b>Card Number</b>	1 of 1
<b>Parcel ID</b>	116 D010001
<b>Location</b>	34 FESSENDEN ST
<b>Land Use</b>	TWO FAMILY
<b>Owner Address</b>	SHIGLEY BASIL ROY & JANET R BENTZ JTS 34 FESSENDEN ST PORTLAND ME 04103
<b>Book/Page</b>	16230/181
<b>Legal</b>	116-D-10 FESSENDEN ST 32-34  5000 SF

**Valuation Information**

<b>Land</b>	<b>Building</b>	<b>Total</b>
\$30,240	\$120,330	\$150,570

**Property Information**

<b>Year Built</b> 1917	<b>Style</b> Old Style	<b>Story Height</b> 2	<b>Sq. Ft.</b> 2838	<b>Total Acres</b> 0.115		
<b>Bedrooms</b> 5	<b>Full Baths</b> 3	<b>Half Baths</b>	<b>Total Rooms</b> 14	<b>Attic</b> Full Finsh	<b>Basement</b> Full	

**Outbuildings**

<b>Type</b> GARAGE-WD/CB	<b>Quantity</b> 1	<b>Year Built</b> 1945	<b>Size</b> 17X20	<b>Grade</b> C	<b>Condition</b> A
-----------------------------	----------------------	---------------------------	----------------------	-------------------	-----------------------

**Sales Information**

<b>Date</b> 04/24/2001	<b>Type</b> LAND + BLDING	<b>Price</b> \$185,000	<b>Book/Page</b> 16230-181
---------------------------	------------------------------	---------------------------	-------------------------------

**Picture and Sketch**

[Picture](#)                      [Sketch](#)

[Click here](#) to view Tax Roll Information.

Any information concerning tax payments should be directed to the Treasury office at 874-8490 or [e-mailed](#).



# BUILDING PERMIT INSPECTION PROCEDURES

Please call 874-8703 or 874-8693 to schedule your inspections as agreed upon

Permits expire in 6 months, if the project is not started or ceases for 6 months.

The Owner or their designee is required to notify the inspections office for the following inspections and provide adequate notice. Notice must be called in 48-72 hours in advance in order to schedule an inspection:

By initialzing at each inspection time, you are agreeing that you understand the inspection procedure and additional fees from a "Stop Work Order" and "Stop Work Order Release" will be incurred if the procedure is not followed as stated below.

\_\_\_\_\_ **Pre-construction Meeting:** Must be scheduled with your inspection team upon receipt of this permit. Jay Reynolds, Development Review Coordinator at 874-8632 must also be contacted at this time, before any site work begins on any project other than single family additions or alterations.

NA **Footing/Building Location Inspection:** Prior to pouring concrete

\_\_\_\_\_ **Re-Bar Schedule Inspection:** Prior to pouring concrete

\_\_\_\_\_ **Foundation Inspection:** Prior to placing ANY backfill

**Framing/Rough Plumbing/Electrical:** Prior to any insulating or drywalling

**Final/Certificate of Occupancy:** Prior to any occupancy of the structure or use. NOTE: There is a \$75.00 fee per inspection at this point.

SAME  
TIME

Certificate of Occupancy is not required for certain projects. Your inspector can advise you if your project requires a Certificate of Occupancy. All projects DO require a final inspection

\_\_\_\_\_ **If any of the inspections do not occur, the project cannot go on to the next phase, REGARDLESS OF THE NOTICE OR CIRCUMSTANCES.**

**CERIFICATE OF OCCUPANICES MUST BE ISSUED AND PAID FOR, BEFORE THE SPACE MAY BE OCCUPIED**

X JM \_\_\_\_\_ 6/12/03  
Signature of applicant/designee Date  
\_\_\_\_\_  
Signature of Inspections Official 6/12/03  
Date

CBL: 116-D-010 Building Permit #: 03-0650

# DISPLAY THIS CARD ON PRINCIPAL FRONTAGE OF WORK CITY OF PORTLAND

Please Read  
Application And  
Notes, if Any,  
Attached

BUILDING DEPARTMENT

## PERMIT

Permit Number: 030650

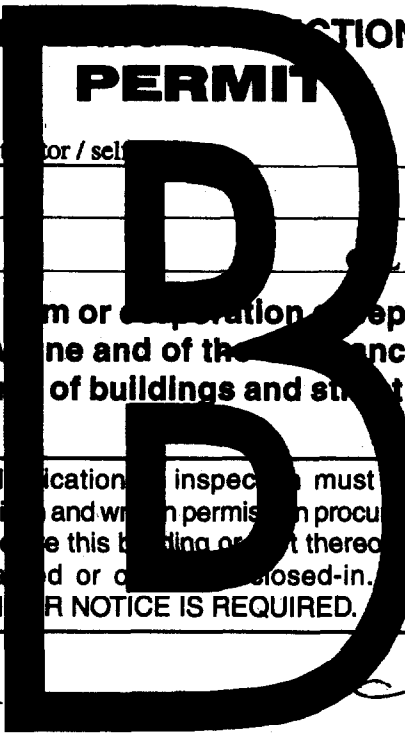

This is to certify that Shigley Basil Roy & /no contractor / self  
has permission to build 10' x 15' rear deck  
AT 34 Fessenden St 116 D010001

provided that the person or persons, firm or corporation accepting this permit shall comply with all of the provisions of the Statutes of Maine and of the ordinances of the City of Portland regulating the construction, maintenance and use of buildings and structures, and of the application on file in this department.

Apply to Public Works for street line and grade if nature of work requires such information.

Notification of inspection must be given and written permission procured before this building or part thereof is occupied or enclosed-in. HEAVY NOTICE IS REQUIRED.

A certificate of occupancy must be procured by owner before this building or part thereof is occupied.

OTHER REQUIRED APPROVALS

Fire Dept. **PERMIT ISSUED**  
Health Dept. \_\_\_\_\_  
Appeal Board **JUN 12 2003**  
Other \_\_\_\_\_

Director - Building & Inspection Services

**CITY OF PORTLAND**

**PENALTY FOR REMOVING THIS CARD**

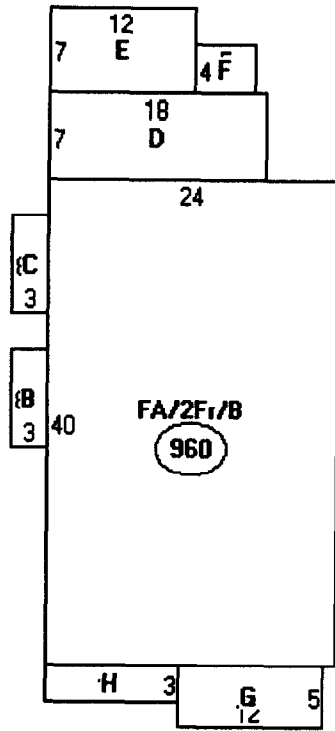

Descriptor/Area

- A: FA/2Fr/B  
960 sqft
- B: 2FBAY/B  
24 sqft
- C: WD  
24 sqft
- D: 2Fr/B  
126 sqft
- E: 2Fr  
84 sqft
- F: FUB  
20 sqft
- G: OFP  
60 sqft
- H: 2FBAY/B  
33 sqft

1331

340 Garage

1671

34 Fessenden  
R-5  
40% - 5000 SF  
Front - 20'  
Sides - 8'

1671 -  
117 - ex. deck  
1788

160 SF  
48  
208

Permit #  
03-0650

116-D=10



# Residential Building Permit Application

If you or the property owner owes real estate or personal property taxes or user charges on any property within the City, payment arrangements must be made before permits of any kind are accepted.

Location/Address of Construction:		
Total Square Footage of Proposed Structure <b>164.6' SQ FT</b>	Square Footage of Lot <b>5,000 -</b>	
Tax Assessor's Chart, Block & Lot Chart#      Block#      Lot# <b>38</b>	Owner: <b>ROY SHIGLEY</b>	Telephone: <b>207-761-7995</b>
Lessee/Buyer's Name (If Applicable)  <b>N/A</b>	Applicant name, address & telephone: <b>ROY SHIGLEY 34 FESSENDEN ST PORTLAND, ME 04103 761-7995</b>	Cost Of Work: <b>\$1900 -</b>  Fee: <b>\$37<sup>00</sup><sub>22</sub></b>
Current Specific use: <u><b>DECK</b></u>		
Proposed Specific use: <u><b>DECK</b></u>		
Project description: <b>DECK EXTENSION AT HOUSE REAR. 15 1/2" HIGH, NO RAILING. FRAMING 1' ON CENTER, USING PRESSURE TREATED CONSTRUCTION</b>		
Contractor's name, address & telephone: <b>SELF</b>		
Who should we contact when the permit is ready: <u><b>ROY SHIGLEY</b></u>		
Mailing address: <b>34 FESSENDEN ST PORTLAND, ME 04103</b>		Phone: <b>207-761-7995</b>

**Please submit all of the information outlined in the Residential Application Checklist. Failure to do so will result in the automatic denial of your permit.**

At the discretion of the Planning and Development Department, additional information may be required prior to permit approval. For further information stop by the Building Inspections office, room 315 City Hall or call 874-8703.

I hereby certify that I am the Owner of record of the named property, or that the owner of record authorizes the proposed work and that I have been authorized by the owner to make this application as his/her authorized agent. I agree to conform to all applicable laws of this jurisdiction. In addition, if a permit for work described in this application is issued, I certify that the Code Official's authorized representative shall have the authority to enter all areas covered by this permit at any reasonable hour to enforce the provisions of the codes applicable to this permit.

Signature of applicant:	Date:
-------------------------	-------

**Permit Fee: \$30.00 for the first \$1000.00 Construction Cost, \$7.00 per additional \$1000.00 cost**

**This is not a Permit; you may not commence any work until the Permit is issued.**