

I hereby certify that this drawing, Specification, plan, or report was prepared by me or under my direct supervision and that I am a duly registered Architect (or Engineer, respectively) under the laws of the State of which govern this project. **WARNING:** No person may alter these documents unless person is or under the direct supervision of the licensed record architect (or Engineer, respectively). [including all copyrights: JCV] PROFESSIONAL SEAL:

Date: _____
John C. Workley Registration No. 03-42844-1
Expiration Date: 6/30/2015

PROPOSED TENANT IMPROVEMENTS FOR:

KeyBank National Association
Forest Avenue Branch
400 Forest Ave.
Portland, Maine 04101

DRAWING RELEASE

No.	Date	Description
1	05/28/2014	OWNER REVIEW

DRAWN BY: SDR
CHECKED BY: SDW
JOB NUMBER: 140480.00

DATE ISSUED FOR: 5/28/2014 - CD APPROVAL

SHEET TITLE:

FINISH PLAN, SCHEDULE AND NOTES

SHEET NUMBER:

A4.1

ADD ALTERNATE:
GC TO PROVIDE SEPARATE LINE ITEM COST FOR THE FOLLOWING EXTERIOR WORK:

- SCRAPE, REPAIR AND PAINT ALL EXTERIOR TRIM. COLOR SPECIFIED BY KEYBANK. TYP. ENTIRE BUILDING
- PATCH, REPAIR AND PAINT ALL EXTERIOR EIFS. COLOR SPECIFIED BY KEYBANK. TYP. ENTIRE BUILDING

NOTE:
EXISTING CARPET MAY BE 18"X18" TILES INSTEAD OF STANDARD 24"X24" TILES. GC TO WORK WITH KEYBANK TO FIND ATTIC STOCK OR REPURPOSE TILES FROM OTHER ROOMS. ALL PATCHED AREAS ARE TO USE FULL TILES. GC IS RESPONSIBLE FOR INCLUDING IN HIS ORIGINAL COST.

FINISH SCHEDULE

NOTE:
- ALL FINISH ITEMS ARE FURNISHED BY GC, INSTALLED BY GC, UON
- NOT ALL ITEMS LISTED BELOW ARE USED ON THIS PROJECT
- REFER TO PLANS & DETAILS FOR LOCATION OF ITEMS USED ON THIS PROJECT
- ALL PAINT TO BE EGGSHELL FINISH, UON

CODE	MATERIAL	MANUFACTURER	MODEL	COLOR	MODULE	MAIN CONTACT	REMARKS
ACP-1	ACOUSTICAL CEILING PANEL	ARMSTRONG	DUNE 1775	WHITE	24"x24"x5/8"	PHILLIS MILLER 800-442-4212	SUPRAFINE XL EXPOSED TEE
CPT-1	CARPET TILE	BENTLEY PRINCE STREET	NEW DEMOGRAPHIC CUSTOM	CUSTOM COLOR	24"x24"	CHRIS CLARK 330-391-4614	INSTALL QUARTER TURNED
CPT-2	WALK-OFF MAT	BENTLEY PRINCE STREET	DECO RIB 6230100004	ANTIRACITE 602371	19.69"x19.69"	DONNA DAVIS 908-849-3076	VESTIBULE, INSTALL QUARTER TURNED
CPT-3	CARPET TILE	BENTLEY PRINCE STREET	8MK28-0220T MODERN BLOK	CRUSHED STONE - 801081	24"x24"	CHRIS CLARK 330-391-4614	INNOVATION ZONE, INSTALL QUARTER TURNED
FRP-1	FIBER REINFORCED PLASTIC BOARD	MARLITE	S100G	WHITE	4'-0"x8'-0"	MARLITE 330-343-6621	JANITOR, LOUNGE WALL BY LADDER
G-1	GROUT TEC	ACCUCOLOR	XT SANDED	CORNSILK #906	1/8" GROUT JOINTS	TEC www.tecspecialty.com	USE WITH RF-2 TILE
PL-1	PLASTIC LAMINATE	NEVAMAR	RK 2001-T	CLASSIC ROCK	---	NEVAMAR www.nevamar.com	TELLER LINE FRONT
PL-2	PLASTIC LAMINATE	WILSONART LAMINATE	11046K-07	MOCHA CHERRY	---	WILSONART www.wilsonart.com	BACK OF HOUSE CABINET FRONTS
PL-3	PLASTIC LAMINATE	NEVAMAR	RK 2001-T	CLASSIC ROCK	---	NEVAMAR www.nevamar.com	BACK OF HOUSE COUNTER TOPS
PL-4	PLASTIC LAMINATE	WILSONART LAMINATE	11046K-07	MOCHA CHERRY	---	WILSONART www.wilsonart.com	INNOVATION ZONE TABLES & TELLER LINE
PT-1	PAINT	SHERWIN WILLIAMS	PRO MAR ZERO VOC EG-SHELL, B20-600	ACCESSIBLE BEIGE SW7036	---	RYAN SCHNEEMAN 216-566-1765	ALL INTERIOR WALLS, UON EXTRA WHITE BASE
PT-2	PAINT	SHERWIN WILLIAMS	PRO MAR ZERO VOC EG-SHELL, B20-600	TURKISH COFFEE SW6076	---	RYAN SCHNEEMAN 216-566-1765	ALL INTERIOR WALLS, UON EXTRA WHITE BASE
PT-3	PAINT	SHERWIN WILLIAMS	PRO MAR ZERO VOC FLAT, B30-600	CITYSCAPE SW7067	---	RYAN SCHNEEMAN 216-566-1765	ACCENT PAINT OFFICE WALL & CONFERENCE ROOM
PT-4	PAINT	SHERWIN WILLIAMS	DURATION HOME SATIN	RAVE RED SW6608	---	RYAN SCHNEEMAN 216-566-1765	TELLERLINE PORTAL CEILING, LEVEL 5 FINISH
PT-5	PAINT	SHERWIN WILLIAMS	BRILLIANT WHITE	WHITE	---	877-397-7897 www.flamestop.com	CEILING PAINTING
PT-6	PAINT	SHERWIN WILLIAMS	PRO CLASSIC WATER BOUNCE SEMI-GLOSS	IRON ORE SW 7069	---	RYAN SCHNEEMAN 216-566-1765	METAL DOORS & FRAMES
RB-1	RUBBER BASE	JOHNSONITE	COVE BASE	FUDGE	4" HEIGHT	LAURIE BAATZ 440-313-8238	
RF-1	VCT	ARMSTRONG	IMPERIAL TEXTURE STANDARD EXCELON	WASHED LINEN - 51810	12"x12"	TRINA SIEGRIST 717 3963676	BACK OF HOUSE LOUNGE, ETO, ATM, ELECT.
RF-2	PORCELAIN TILES	CROSSVUE	SAHARA DUNE	A235 SAHARA DUNE	3"x3"	SHEILAH WINN 8656750939	RESTROOMS PROVIDE INTEGRAL COVE BASE, INSIDE OUTSIDE CORNERS & BULL NOSE EDGES
RS-1	REDUCER STRIP	CERAMIC TOOL CO.	CTC38CT	ALUMINUM-CLEAR ANODIZED	---	---	
RS-2	REDUCER STRIP	JOHNSONITE	CTA-XX-D	FUDGE	---	---	
RS-3	REDUCER STRIP	JOHNSONITE	CTA-XX-H	FUDGE	---	---	
RS-4	REDUCER STRIP	JOHNSONITE	EG-XX-G	FUDGE	---	---	
RS-5	REDUCER STRIP	JOHNSONITE	CTA-XX-K	FUDGE	---	---	
RS-6	REDUCER STRIP	CERAMIC TOOL CO.	CTC38CTB	ALUMINUM-CLEAR ANODIZED	---	---	
T-1	VINYL TILE	MANNINGTON	SPATIA	EBONY WOOD SS5W2511	7 1/4"x48"	---	LOBBY-FIELD
T-2	VINYL TILE	MANNINGTON	SPATIA	WHITE ASH SS5W2540	7 1/4"x48"	---	LOBBY-ACCENT
ST-1	STAIN	---	---	---	---	---	GC TO VERIFY WITH MILLWORK VENDOR
WT-1	WINDOW BLINDS	MECHOSHADE	MECHOSHADE 5 WITH METAL CHROME PULL CHAIN	STONE 6018	---	---	INCLUDE OPTIONAL FASCIA; COLOR: ALUMINUM
WT-2	WINDOW FILM	3M	FASARA	OPAQUE WHITE	---	---	
SS-1	SOLID SURFACE	---	---	DELTA SAND	---	---	TELLER COUNTER TOP AND FRONT PANEL
WC-1	WALL COVERING	SURFACE MATERIALS	SANFOOT	NATURAL WOOD VENEER WALLCOVERING QC FIGURED ANIGRE	3'-9"x3'10"	MICHELLE VNUK	INNOVATION MEDIA WALL
ACP-2	ACOUSTICAL CEILING PANEL	ARMSTRONG	12" AXIOM TRIM	WHITE	12"x3/4"	PHILLIS MILLER 800-442-4212	INNOVATION ZONE CLOUD TRIM CHANNEL
4" CAN	4" CAN LIGHT	GOTHAM	EVO-356 4AR 120	-	4" DIA.	-	VARIES
2X2	2X2 STANDARD LIGHT	LITHONIA	2RTS-24T5HO-MVOLT-GEB10PS-LP835	-	2x2	-	STANDARD 2x2 BRANCH FIXTURE

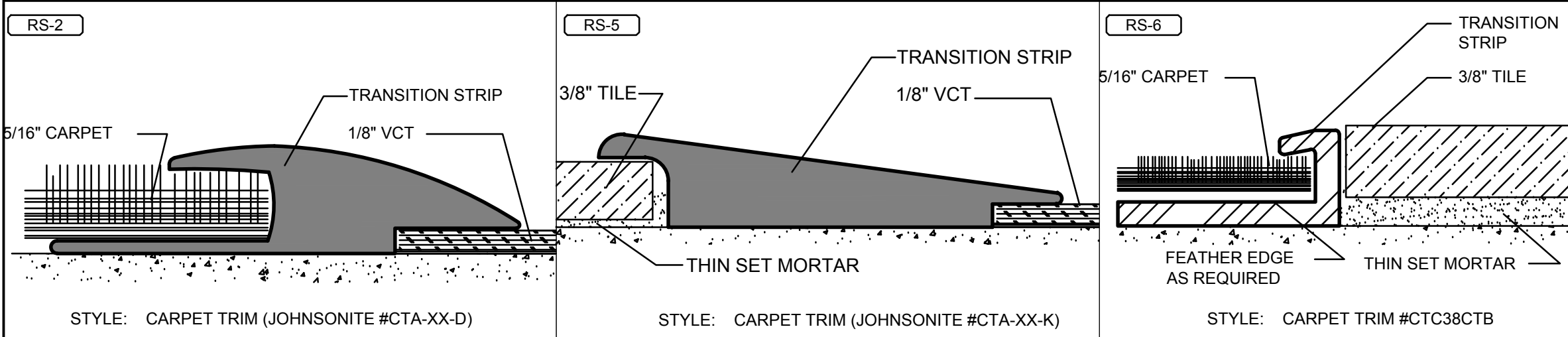

FINISH PLAN KEY NOTES:

- ALL LIGHT WOOD DOORS, FRAMES AND TRIM TO BE REFINISHED IN PT-2, TURKISH COFFEE. TYP. ENTIRE BRANCH
- EXIST'G WOOD BASEBOARD TO BE CLEANED AND REFINISHED IN PT-2, TURKISH COFFEE. TYP OF ENTIRE BRANCH
- CLEAN AND REPAIR ANY TILE AND GROUT AS NEEDED. TYP OF ENTIRE BRANCH
- PATCH AND INFILL CARPET AS NEEDED FROM NEW TELLERLINE INSTALL
- EXIST'G BLOCK 'O' CEILING SOFFIT TO BE PAINTED ALL IN PT-5
- SOFFIT ABOVE TELLERLINE TO BE PAINTED PT-4

SYMBOL LEGEND

- INDICATES AREA NOT IN SCOPE OF WORK
- FLOORING TRANSITION STRIP: REFER TO GENERAL FINISH NOTES FOR SPECIFICATION INFORMATION AND DETAILS
- DENOTES DIRECTION OF FLOORING INSTALLATION.
- XXX WALLS
- XXX FLOORS
- XXX BASE

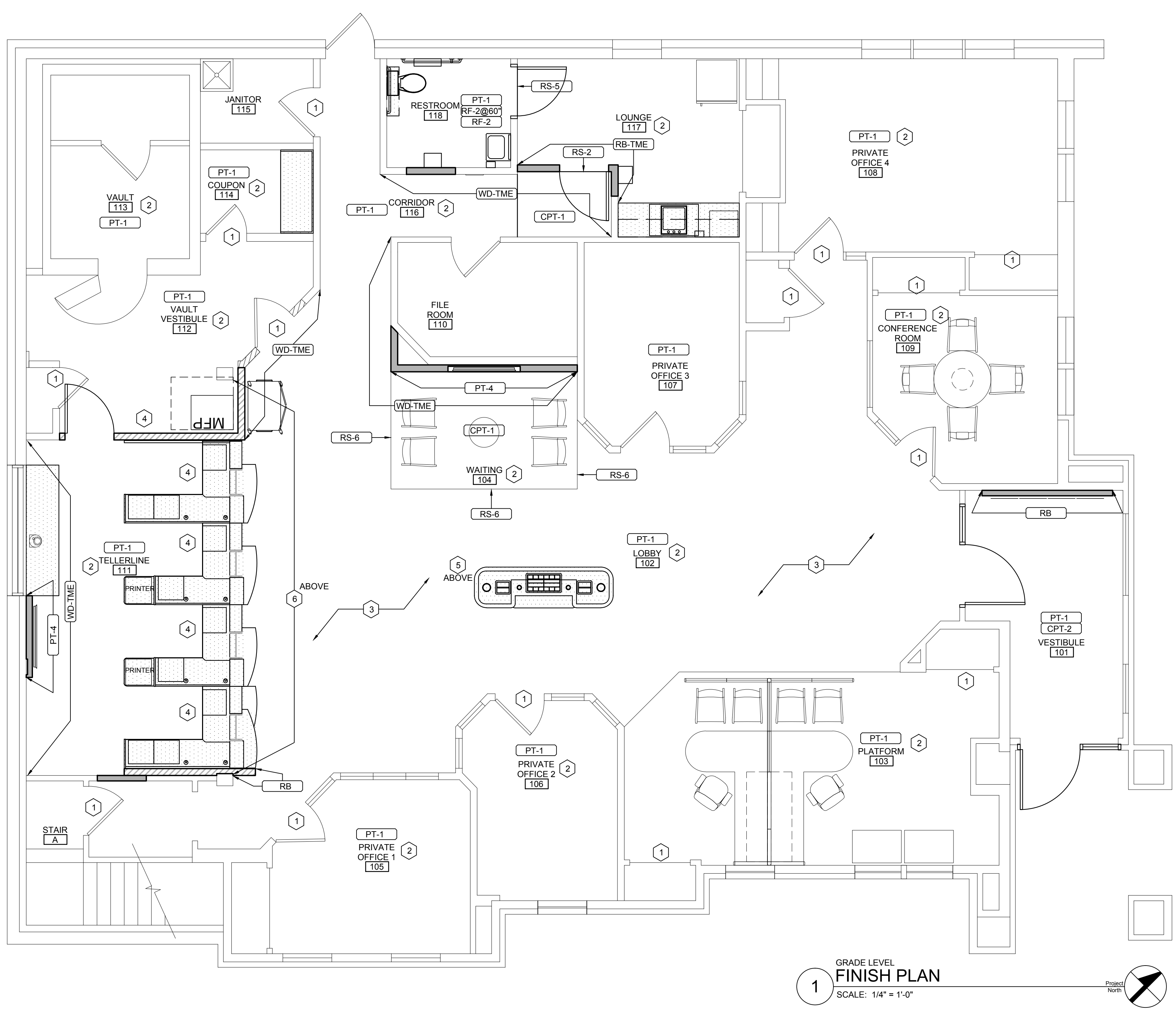

GRADE LEVEL
FINISH PLAN
SCALE: 1/4" = 1'-0"

