

- Exit sign
- Exit sign w/Direction
- ⊕ Fire Extinguisher
- P Fire Alarm Pull Station
- ☐ Strobe
- ☒ Emergency Light Pack
- ▨ Minimum 42" Wide Egress Path to be Kept Clear
- ① Existing Egress Door with Panic Hardware and Closer
- ② Existing Egress Door with Panic Hardware and Closer

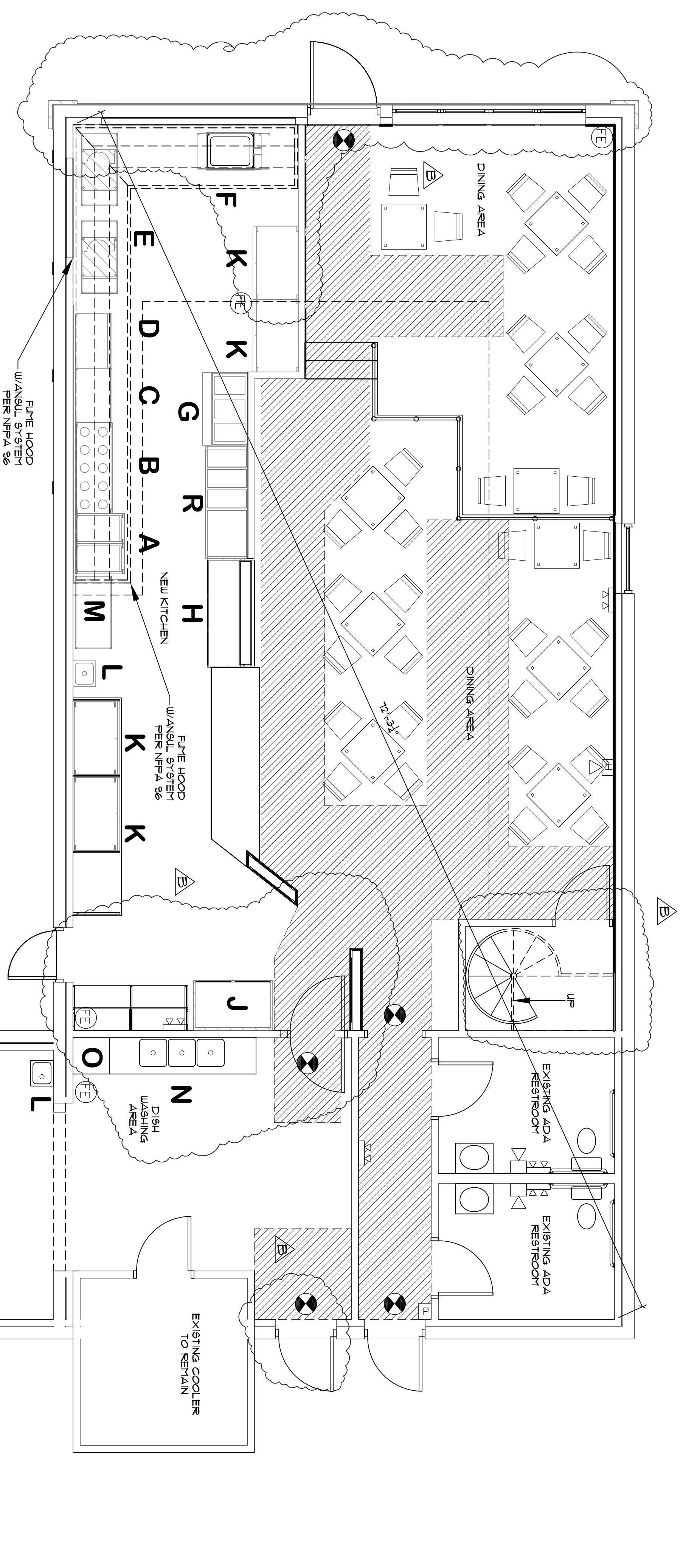

LIFE SAFETY FLOOR PLAN
SCALE: 1/4" = 1'-0"

DATE	NO	REMARKS	BY
08-27-09	A	ISSUED FOR PERMITTING	JJO
12-17-09	B	REVISED PER OWNER	JJO

CODE: IBC 2003
TOWN: Portland
DATE: 08-27-09
SCALE: AS NOTED
DRAWN: JJO

TITLE:
Life Safety Floor Plan

FILE:
SHEET: A-3

Your Grandma's Place
408 Forest Ave, Portland, Maine
Pavlo Casikes

@d-de-Tech
235 Riverside Industrial Parkway
Portland, ME 04102

PROPERTY OF