

WHIPPLE  
 CALLENDER  
 ARCHITECTS

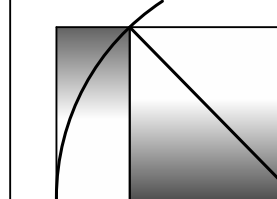

136 PLEASANT AVE.  
 PORTLAND, ME 04103  
 P 207.775.3696  
 F 207.775.3631  
 www.whipplecallender.com

DATE	DESCRIPTION

DATE: PERMIT APP. 9.20.16  
 CHECKED BY: JAD  
 DRAWN BY: CLBC  
 JOB: 432-2016  
 SHEET TITLE:

SECOND FLOOR  
 LIFE SAFETY PLAN

**A1.3.2**

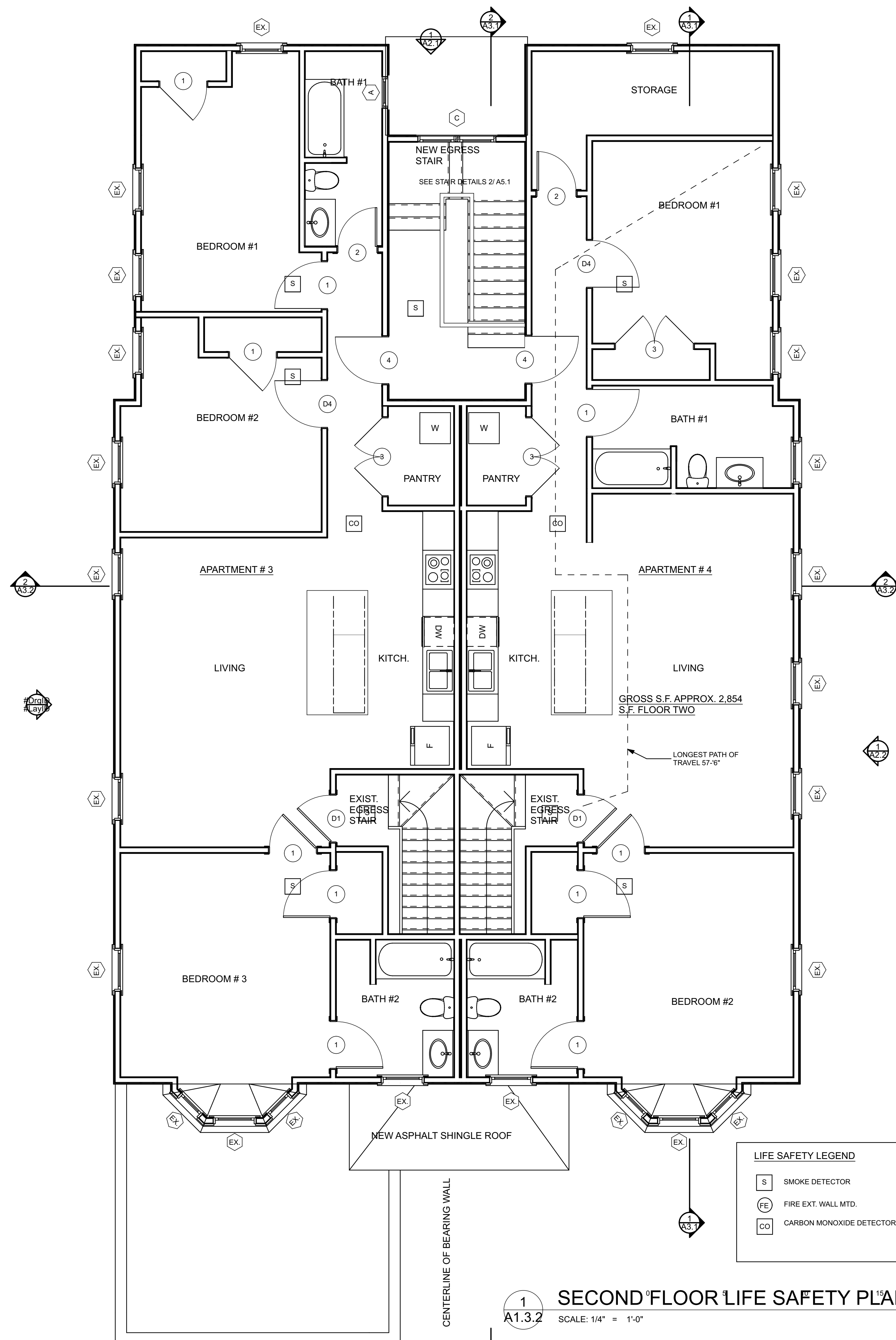

**LIFE SAFETY LEGEND**

- [S] SMOKE DETECTOR
- [FE] FIRE EXT. WALL MTD.
- [CO] CARBON MONOXIDE DETECTOR

**1**  
**A1.3.2** SECOND FLOOR LIFE SAFETY PLAN  
 SCALE: 1/4" = 1'-0"

THIS DRAWING IS AN INSTRUMENT OF SERVICE AND SHALL REMAIN THE PROPERTY OF WHIPPLE CALLENDER ARCHITECTS. IT SHALL NOT BE USED FOR ANY OTHER PURPOSE THAT FOR WHICH IT IS SPECIFICALLY FURNISHED.