

49-55 OAK STREET



APPLICATION FOR PERMIT
DEPARTMENT OF BUILDING INSPECTIONS SERVICES
ELECTRICAL INSTALLATIONS

Date April 8, 19 80
Receipt and Permit number A 45612

To the CHIEF ELECTRICAL INSPECTOR, Portland, Maine:

The undersigned hereby applies for a permit to make electrical installations in accordance with the laws of
Maine, the Portland Electrical Ordinance, the National Electrical Code and the following specifications:

LOCATION OF WORK: 51 Oak Street Plan-A-Tan
OWNER'S NAME: Thibodeau ADDRESS: same FEES

OUTLETS:
Receptacles _____ Switches _____ Plugmold _____ ft. TOTAL _____

FIXTURES: (number of)
Incandescent _____ Fluorescent _____ (not strip) TOTAL _____
Strip Fluorescent _____ ft. _____

SERVICES:
Overhead _____ Underground _____ Temporary _____ TOTAL amperes _____

METERS: (number of) _____

MOTORS: (number of)
Fractional _____
1 HP or over _____

RESIDENTIAL HEATING:
Oil or Gas (number of units) _____
Electric (number of rooms) _____

COMMERCIAL OR INDUSTRIAL HEATING:
Oil or Gas (by a main boiler) _____
Oil or Gas (by separate units) _____
Electric Under 20 kws ☒ Over 20 kws _____ 5.00

APPLIANCES: (number of)
Ranges _____ Water Heaters _____
Cook Tops _____ Disposals _____
Wall Ovens _____ Dishwashers _____
Dryers _____ Compactors _____
Fans _____ Others (denote) _____

TOTAL _____

MISCELLANEOUS: (number of)
Branch Panels _____
Transformers _____
Air Conditioners Central Unit _____
Separate Units (windows) _____
Signs 20 sq. ft. and under _____
Over 20 sq. ft. _____
Swimming Pools Above Ground _____
In Ground _____
Fire/Burglar Alarms Residential _____
Commercial _____
Heavy Duty Outlets, 220 Volt (such as welders) 30 amps and under _____
over 30 amps _____
Circus, Fairs, etc. _____
Alterations to wires _____
Repairs after fire _____
Emergency Lights, battery _____
Emergency Generators _____

INSTALLATION FEE DUE: _____
FOR ADDITIONAL WORK NOT ON ORIGINAL PERMIT DOUBLE FEE DUE: _____
FOR REMOVAL OF A "STOP ORDER" (304-16.b) TOTAL AMOUNT DUE: 5.00

INSPECTION.

Will be ready on ready, 19 80; or Will Call _____

CONTRACTOR'S NAME: Hogers Electric
ADDRESS: 32 Clark St. Saco, Me.
TEL.: 282-1894
MASTER LICENSE NO.: 2757 SIGNATURE OF CONTRACTOR: [Signature]
LIMITED LICENSE NO.: _____

INSPECTOR'S COPY — WHITE
OFFICE COPY — CANARY
CONTRACTOR'S COPY — GREEN

Permit Number: 1001201

[illegible]

Owner - J. C. ...

Date of Permit: 11/16/00

Final inspection : *2/2/2*

by Inspector

20
 19
 18
 17
 16
 15
 14
 13
 12
 11
 10
 9
 8
 7
 6
 5
 4
 3
 2
 1

Service called in _____

Closing-in _____ by _____

PROGRESS INSPECTIONS: 7-8-82 / / /

CODE
COMPLIANCE
COMPLETED

DATE 4

REMARKS:

[illegible]



APPLICATION FOR PERMIT
DEPARTMENT OF BUILDING INSPECTIONS SERVICES
ELECTRICAL INSTALLATIONS

Date 10-10, 1979
Receipt and Permit number A34841

To the CHIEF ELECTRICAL INSPECTOR, Portland, Maine:

The undersigned hereby applies for a permit to make electrical installations in accordance with the laws of Maine, the Portland Electrical Ordinance, the National Electric Code and the following specifications:

LOCATION OF WORK: 47 Oak St.
OWNER'S NAME: Lou's Corner Rest. ADDRESS: same FEES

OUTLETS:	Receptacles _____	Switches _____	Plugmold _____	ft. TOTAL _____	
FIXTURES: (number of)	Incandescent _____	Flourescent _____	(not strip) TOTAL _____		
	Strip Flourescent _____	ft. _____			
SERVICES:	Overhead _____	Underground _____	Temporary _____	TOTAL amperes _____	
METERS: (number of)	_____				
MOTORS: (number of)	Fractional _____				
	1 HP or over _____				
RESIDENTIAL HEATING:	Oil or Gas (number of units) _____				
	Electric (number of rooms) _____				
COMMERCIAL OR INDUSTRIAL HEATING:	Oil or Gas (by a main boiler) _____				
	Oil or Gas (by separate units) _____				
	Electric Under 20 kws <input checked="" type="checkbox"/> Over 20 kws _____				5.00
APPLIANCES: (number of)	Ranges _____	Water Heaters _____			
	Cook Tops _____	Disposals _____			
	Wall Ovens _____	Dishwashers _____			
	Dryers _____	Compactors _____			
	Fans _____	Others (denote) _____			
	TOTAL _____				
MISCELLANEOUS: (number of)	Branch Panels _____				
	Transformers _____				
	Air Conditioners Central Unit _____				
	Separate Units (windows) _____				
	Signs 20 sq. ft. and under _____				
	Over 20 sq. ft. _____				
	Swimming Pools Above Ground _____				
	In Ground _____				
	Fire/Burglar Alarms Residential _____				
	Commercial _____				
	Heavy Duty Outlets, 220 Volt (such as welders) 30 amps and under _____				
	over 30 amps _____				
	Circus, Fairs, etc. _____				
	Alterations to wires _____				
	Repairs after fire _____				
	Emergency Lights, battery _____				
	Emergency Generators _____				
	INSTALLATION FEE DUE: _____				
FOR ADDITIONAL WORK NOT ON ORIGINAL PERMIT	DOUBLE FEE DUE: _____				
FOR REMOVAL OF A "STOP ORDER" (304-16.b)	TOTAL AMOUNT DUE: <u>5.00</u>				

INSPECTION:

Will be ready on _____, 19__; or Will Call ☒

CONTRACTOR'S NAME: Caron & Waltz
ADDRESS: 416 Preble St., S.P.

TEL.: 799-2228

MASTER LICENSE NO.: On File SIGNATURE OF CONTRACTOR: [Signature]
LIMITED LICENSE NO.: _____

INSPECTOR'S COPY — WHITE
OFFICE COPY — CANARY
CONTRACTOR'S COPY — GREEN

ELECTRICAL INSTALLATIONS—

34841

47 Oak St.

Don't know

10-10-01

8-15-8

Friday

Register Page No. -

INSPECTIONS: Service _____ by _____

Service called in _____

Closing-in _____ by _____

PROGRESS INSPECTIONS: 2-13-84 _____ / _____

CODE
COMPLIANCE
COMPLETED

715

DATE:

REMARKS:



APPLICATION FOR PERMIT
DEPARTMENT OF BUILDING INSPECTIONS SERVICES
ELECTRICAL INSTALLATIONS

Date 8-6, 19 79
Receipt and Permit number A28923

To the CHIEF ELECTRICAL INSPECTOR, Portland, Maine:

The undersigned hereby applies for a permit to make electrical installations in accordance with the laws of Maine, the Portland Electrical Ordinance, the National Electrical Code and the following specifications:

LOCATION OF WORK: 51 A Oak St. (Hotel Everett)

OWNER'S NAME: Joseph Paulin ADDRESS: Craigie St.

FEEs

OUTLETS:

Receptacles _____ Switches _____ Plugmold _____ ft. TOTAL _____

FIXTURES: (number of)

Incandescent _____ Fluorescent _____ (not strip) TOTAL _____

Strip Fluorescent _____ ft. _____

SERVICES:

Overhead _____ Underground ☒ Temporary _____ TOTAL amperes 100-3 phase 3.00

METERS: (number of)

1 _____ .50

MOTORS: (number of)

Fractional _____

1 HP or over _____

RESIDENTIAL HEATING:

Oil or Gas (number of units) _____

Electric (number of rooms) _____

COMMERCIAL OR INDUSTRIAL HEATING:

Oil or Gas (by a main boiler) _____

Oil or Gas (by separate units) _____

Electric Under 20 kws _____ Over 20 kws _____

APPLIANCES: (number of)

Ranges _____ Water Heaters _____

Cook Tops _____ Disposals _____

Wall Ovens _____ Dishwashers _____

Dryers _____ Compactors _____

Fans _____ Others (denote) _____

TOTAL _____

MISCELLANEOUS: (number of)

Branch Panels _____

Transformers _____

Air Conditioners Central Unit _____

Separate Units (windows) _____

Signs 20 sq. ft. and under _____

Over 20 sq. ft. _____

Swimming Pools Above Ground _____

In Ground _____

Fire/Burglar Alarms Residential _____

Commercial _____

Heavy Duty Outlets, 220 Volt (such as welders) 30 amps and under _____

over 30 amps _____

Circus, Fairs, etc. _____

Alterations to wires _____

Repairs after fire _____

Emergency Lights, battery _____

Emergency Generators _____

INSTALLATION FEE DUE:

FOR ADDITIONAL WORK NOT ON ORIGINAL PERMIT DOUBLE FEE DUE:

FOR REMOVAL OF A "STOP ORDER" (304-16.b)

TOTAL AMOUNT DUE: 3.50

INSPECTION:

Will be ready on _____, 19__; or Will Call ☒

CONTRACTOR'S NAME: Dan DiMatteo

ADDRESS: 1084 Washington Ave.

TEL.: 797-2251

MASTER LICENSE NO.: 02833 SIGNATURE OF CONTRACTOR:

LIMITED LICENSE NO.: _____ Dan DiMatteo

INSPECTOR'S COPY — WHITE

OFFICE COPY — CANARY

CONTRACTOR'S COPY — GREEN

ELECTRICAL INSTALLATIONS—

Permit Number 28923

Location 517 Oak St.

Owner J. Pauline

Date of Permit 8-6-79

Final Inspection 8-7-79

By Inspector Libby

Permit Application Register Page No. 32

INSPECTIONS: Service by Libby
Service called in 8-7-79
Closing-in _____ by _____

PROGRESS INSPECTIONS: _____ / _____ / _____
_____ / _____ / _____
_____ / _____ / _____
_____ / _____ / _____
_____ / _____ / _____

CODE
COMPLIANCE
COMPLETED
DATE 8-7-79
DATE: _____

REMARKS:

OK

55 OAK ST

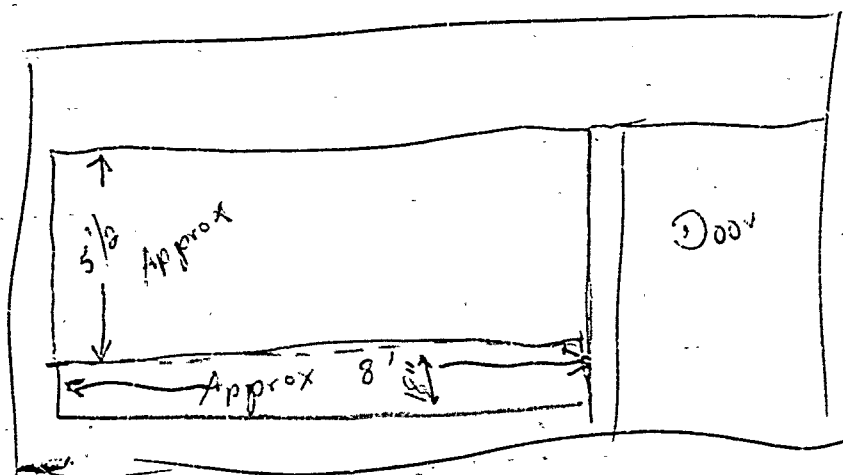

B3 BUSINESS ZONE

Drop opening
18"

RECEIVED
NOV 19 1973
DEPT. OF BLDG. INSP.
CITY OF PORTLAND



APPLICATION FOR PERMIT

B3 BUSINESS ZONE

PERMIT ISSUED

01347 20 1973

Class of Building or Type of Structure

Portland, Maine, November 19, 1973

CITY OF PORTLAND

To the INSPECTOR OF BUILDINGS, PORTLAND, MAINE

The undersigned hereby applies for a permit to erect alter repair demolish install the following building structure equipment in accordance with the Laws of the State of Maine, the Building Code and Zoning Ordinance of the City of Portland, plans and specifications, if any, submitted herewith and the following specifications:

Location 55 Oak St Within Fire Limits? Dist. No.
Owner's name and address Sid & Mol Shage, same Telephone
Lessee's name and address Coulombe Telephone
Contractor's name and address Lester A. Coulombe, RFD # 1, Westbrook Telephone 4864
Architect Specifications Plans No. of lots
Proposed use of building Wallpaper retail store No. families
Last use past use - finance office No. families
Material No. stories Heat Style of roof Roofing
Other buildings on same lot Fee \$ 5.00
Estimated cost \$ 550.00

General Description of New Work

To enlarge an existing approx 5 1/2 x 8' existing front window to approx 7' x 8' per plan. (height to be enlarged approx 18").

It is understood that this permit does not include installation of heating apparatus which is to be taken out separately by the name of the heating contractor. PERMIT TO BE ISSUED TO Contractor

Details of New Work

Is any plumbing involved in this work? Is any electrical work involved in this work?
Is connection to be made to public sewer? If not, what is proposed for sewage?
Has septic tank notice been sent? Form notice sent?
Height average grade to top of plate Height average grade to highest point of roof
Size, front depth No. stories solid or filled land? earth or rock?
Material of foundation Thickness, top bottom cellar
Kind of roof Rise per foot Roof covering
No. of chimneys Material of chimneys of lining Kind of heat fu
Framing Lumber-Kind Dressed or full size? Corner posts Sills
Size Girder Columns under girders Size Max. on centers
Studs (outside walls and carrying partitions) 2x4-16" O. C. Bridging in every floor and flat roof span over 8 ft
Joists and rafters: 1st floor , 2nd , 3rd , roof
On centers: 1st floor , 2nd , 3rd , roof
Maximum span: 1st floor , 2nd , 3rd , roof
If one story building with masonry walls, thickness of walls? height?

If a Garage

No. cars now accommodated on same lot , to be accommodated number commercial cars to be accommodated
Will automobile repairing be done other than minor repairs to cars habitually stored in the proposed building?

Miscellaneous

Will work require disturbing of any tree on a public street?
Will there be in charge of the above work a person competent to see that the State and City requirements pertaining thereto are observed? yes

APPROVED:

O.K. E.B. 11/26/73

CS 301

INSPECTION COPY

Signature of owner by

Lester A. Coulombe

Lester A. Coulombe

NOTES

12-4-73 About
d. 10 840

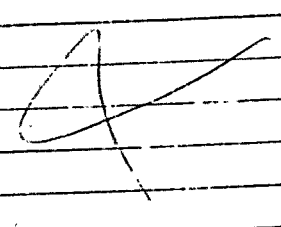

Permit No. 73/1347
Location 55 North St
Owner ~~John~~ Sid & Ned Shave
Date of permit 11/22/73
Notif. closing-in
Inspn. closing-in
Final Notif.
Final Inspn.
Cert. of Occupancy issued
Staking Out Notice
Form Check Notice

Nelson

to
are

5072 CITY OF PORTLAND, MAINE Application for Permit to Install Wires

Permit No. 203
Issued

Portland, Maine 19...

To the City Electrician, Portland, Maine:

The undersigned hereby applies for a permit to install wires for the purpose of conducting electric current, in accordance with the laws of Maine, the Electrical Ordinance of the City of Portland, and the following specifications:

(This form must be completely filled out — Minimum Fee, \$1.00)

Owner's Name and Address Beneficial Finance Tel.

Contractor's Name and Address James Kelly, Inc. Tel. 253 2632

Location 55 Oak St. Use of Building Office

Number of Families Apartments Stores Number of Stories

Description of Wiring: New Work Additions Alterations

Pipe Cable Metal Molding BX Cable Plug Molding (No. of feet)

No. Light Outlets Plugs 2 Light Circuits Plug Circuits

FIXTURES: No. Fluor. or Strip Lighting (No. feet)

SERVICE: Pipe Cable Underground No. of Wires Size

METERS: Relocated Added Total No. Meters

MOTORS: Number Phase H. P. Amps Volts Starter

HEATING UNITS: Domestic (Oil) No. Motors Phase H.P.

Commercial (Oil) No. Motors Phase H.P.

Electric Heat (No. of Rooms)

APPLIANCES: No. Ranges Watts Brand Feeds (Size and No.)

Elec. Heaters Watts Extra Cabinets or Panels

Miscellaneous Watts Signs (No. Units)

Transformers Air Conditioners (No. Units) 19 ... Inspection 19 ...

Will commence 19 ... Ready to cover in 19 ...

Amount of Fee \$...

Signed James Kelly

DO NOT WRITE BELOW THIS LINE

SERVICE METER GROUND

VISITS: 1 2 3 4 5 6

..... 7 8 9 10 11 12

REMARKS:

INSPECTED BY [Signature] (OVER)

Date Issued

5/12/67

Portland Plumbing Inspector

By ERNOLD R GOODWIN

App. First Insp.

Date 5/13/67

By ERNOLD R GOODWIN

App. Final Insp.

Date MAY 15 1967

By ERNOLD R GOODWIN

Type of Bldg.

☐ Commercial
☐ Residential
☐ Single
☐ Multi Family
☐ New Construction
☐ Remodeling

PERMIT TO INSTALL PLUMBING

Office PERMIT NUMBER 17801

Address 51A Oak Street, 2nd floor

Installation For Hotel

Owner of Bldg Everett Chambers Company

Owner's Address Box 151 Pearl Street, Sta. Portland, Maine

Plumber Nelson Tripp

Date 5/12/67

NEW	REPL.		NO.	FEE
		SINKS	1	2.00
1		LAVATORIES	1	2.00
1		TOILETS		
		BATH TUBS		
		SHOWERS		
		DRAINS FLOOR SURFACE		
		HOT WATER TANKS		
		TANKLESS WATER HEATERS		
		GARBAGE DISPOSALS		
		SEPTIC TANKS		
		HOUSE SEWERS		
		ROOF LEADERS		
		AUTOMATIC WASHERS		
		DISHWASHERS		
		OTHER		
			TOTAL	4.00

Building and Inspection Services Dept.: Plumbing Inspection



B3 BUSINESS ZONE

APPLICATION FOR PERMIT

Class of Building or Type of Structure Second Class
Portland, Maine, May 3, 1967

PERMIT ISSUED

MAY 8 1967 00305

CITY of PORTLAND

To the INSPECTOR OF BUILDINGS, PORTLAND, MAINE

The undersigned hereby applies for a permit to erect alter repair demolish install the following building structure equipment in accordance with the Laws of the State of Maine, the Building Code and Zoning Ordinance of the City of Portland, plans and specifications, if any, submitted herewith and the following specifications:

Location 51A Oak Street Within Fire Limits? _____ Dist. No. _____
Owner's name and address Everett Chambers, 51A Oak St. Telephone _____
Lessee's name and address _____ Telephone _____
Contractor's name and address F.P. & C. H. Murray, Box 2297, So. Portland Telephone 799-1217
Architect _____ Specifications _____ Plans yes No. of sheets 1
Proposed use of building Hotel No. families _____
Last use _____ " No. families _____
Material brick No. stories _____ Heat _____ Style of roof _____ Roofing _____
Other buildings on same lot _____
Estimated cost \$ 5,000 Fee \$ 9.00

General Description of New Work

To make alterations to second floor as per plan

It is understood that this permit does not include installation of heating apparatus which is to be taken out separately by and in the name of the heating contractor. **PERMIT TO BE ISSUED TO F P & C H Murray**

Details of New Work

Is any plumbing involved in this work? yes Is any electrical work involved in this work? yes
Is connection to be made to public sewer? _____ If not, what is proposed for sewage? _____
Has septic tank notice been sent? _____ Form notice sent? _____
Height average grade to top of plate _____ Height average grade to highest point of roof _____
Size, front _____ depth _____ No. stories _____ solid or filled land? _____ earth or rock? _____
Material of foundation _____ Thickness, top _____ bottom _____ cellar _____
Kind of roof _____ Rise per foot _____ Roof covering _____
No. of chimneys _____ Material of chimneys _____ of lining _____ Kind of hear _____ fuel _____
Framing Lumber--Kind _____ Dressed or full size? _____ Corner posts _____ Sills _____
Size Girder _____ Columns under girders _____ Size _____ Max. on centers _____
Studs (outside walls and carrying partitions) 2x4-16" O. C. Bridging in every floor and flat roof span over 8 feet.
Joists and rafters: 1st floor _____, 2nd _____, 3rd _____, roof _____
On centers: 1st floor _____, 2nd _____, 3rd _____, roof _____
Maximum span: 1st floor _____, 2nd _____, 3rd _____, roof _____
If one story building with masonry walls, thickness of walls? _____ height? _____

If a Garage

No. cars now accommodated on same lot _____, to be accommodated _____ number commercial cars to be accommodated _____
Will automobile repairing be done other than minor repairs to cars habitually stored in the proposed building? _____

Miscellaneous

Will work require disturbing of any tree on a public street? no
Will there be in charge of the above work a person competent to see that the State and City requirements pertaining thereto are observed? yes

Everett Chambers
F P & C H Murray

APPROVED:

J. E. M.

CS 301

INSPECTION COPY

Signature of owner By: K. Murray

NOTES

5-16-67 Framing up
Need sprinklers in
new toilet + closet *JP*

5-18-67 Sprinklers
added O.K. *JP*

X

Permit No. 67/305
Location 514 Oak Street
Owner *Smith & Thacker*
Date of permit 5/18/67
Notif. closing-in
Inspn. closing-in
Final Notif.
Final Inspn.
Cert. of Occupancy issued
Sinking Out Notice
Form Check Notice

B3 BUSINESS ZONE



APPLICATION FOR PERMIT

Class of Building or Type of Structure 2nd Class
Portland, Maine, December 16, 1966

PERMIT ISSUED
DEC 20 1966
CITY OF PORTLAND

To the INSPECTOR OF BUILDINGS, PORTLAND, MAINE

The undersigned hereby applies for a permit to erect alter repair demolish install the following building structure equipment in accordance with the Laws of the State of Maine, the Building Code and Zoning Ordinance of the City of Portland, plans and specifications, if any, submitted herewith and the following specifications:

Location 55 Oak Street Within Fire Limits? 55 Oak St. Dist. No. 1
Owner's name and address Fletcher & Sons Everett Chambers Co., 55 Oak St. Telephone
Lessee's name and address Jackson Studio, 536 Congress St. Telephone
Contractor's name and address F. P. & C. H. Murray, P.O. Box 2297, So. Port. Telephone
Architect Specifications Plans yes No. of sheets 1
Proposed use of building Store(studio) and hotel No. families
Last use Restaurant and stores, hotel No. families
Material masonry No. stories 2-5 Heat Style of roof Roofing
Other buildings on same lot
Estimated cost \$6500. Fee \$14.00

General Description of New Work

To erect non-bearing partitions first floor and new T-bar ceiling
2x4 studs, 16" O.C., sheetrock

It is understood that this permit does not include installation of heating apparatus which is to be taken out separately by and in the name of the heating contractor. **PERMIT TO BE ISSUED TO** Murray

Details of New Work

Is any plumbing involved in this work? Is any electrical work involved in this work? yes
Is connection to be made to public sewer? If not, what is proposed for sewage?
Has septic tank notice been sent? Form notice sent?
Height average grade to top of plate Height average grade to highest point of roof
Size, front depth No. stories solid or filled land? earth or rock?
Material of foundation Thickness, top bottom cellar
Kind of roof Rise per foot Roof covering
No. of chimneys Material of chimneys of lining Kind of heat fuel
Framing Lumber—Kind Dressed or full size? Corner posts Sills
Size Girder Columns under girders Size Max. on centers
Studs (outside walls and carrying partitions) 2x4-16" O. C. Bridging in every floor and flat roof span over 8 feet.
Joists and rafters: 1st floor , 2nd , 3rd , roof
On centers: 1st floor , 2nd , 3rd , roof
Maximum span: 1st floor , 2nd , 3rd , roof
If one story building with masonry walls, thickness of walls? height?

If a Garage

No. cars now accommodated on same lot , to be accommodated number commercial cars to be accommodated
Will automobile repairing be done other than minor repairs to cars habitually stored in the proposed building?

APPROVED:

J. E. M. / letter

Miscellaneous

Will work require disturbing of any tree on a public street? no
Will there be in charge of the above work a person competent to see that the State and City requirements pertaining thereto are observed? yes

Jackson Studios
F P & C H Murray

CS 301

INSPECTION COPY

Signature of owner

By:

Edna C. Murray

NOTES

12-28-66 Drop out
 plastic ceiling tiles
 to be used. ~~FD~~
 70 Firestop pipe
 duct + small ceiling
 holes. ~~FD~~
 1-6-67 H.D. hally col.
 gone at bottom -
 Phoned John Heasine
 to replace
 Firestop OK. ~~FD~~
 1-16-67 New H.D.
 hally installed ~~FD~~

X

Permit No. 461 1270
 Location 55 Oak St.
 Owner ~~Edward Jackson~~
 Date of permit 11/20/66
 Notif. closing-in
 Inspn. closing-in
 Final Notif.
 Final Inspn.
 Cert. of Occupancy issued
 Staking Out Notice
 Form Check Notice

Plastic tile ceiling

CITY OF PORTLAND, MAINE
Application for Permit to Install Wires

Permit No. 55484

Issued

Portland, Maine Jan 3, 1966

To the City Electrician, Portland, Maine:

The undersigned hereby applies for a permit to install wires for the purpose of conducting electric current, in accordance with the laws of Maine, the Electrical Ordinance of the City of Portland, and the following specifications:

(This form must be completely filled out — Minimum Fee, \$1.00)

Owner's Name and Address JACKSON STUDIOS Tel.

Contractor's Name and Address Murray Bros. Tel.

Location 55 Oak St Use of Building Studio

Number of Families Apartments Stores Number of Stories

Description of Wiring: New Work Additions Alterations

Pipe Cable Metal Molding BX Cable Plug Molding (No. of feet)

No. Light Outlets Plugs 16 Light Circuits Plug Circuits

FIXTURES: No. 7 Light Switches 6 Fluor. or Strip Lighting (No. feet) 104

SERVICE: Pipe Cable Underground No. of Wires Size

METERS: Relocated Added Total No. Meters

MOTORS: Number Phase H. P. Amps Volts Starter

HEATING UNITS: Domestic (Oil) No. Motors Phase H.P.

Commercial (Oil) No. Motors Phase H.P.

Electric Heat (No. of Rooms)

APPLIANCES: No. Ranges Watts Brand Feeds (Size and No.)

Elec. Heaters Watts

Miscellaneous Watts Extra Cabinets or Panels

Transformers Air Conditioners (No. Units) Signs (No. Units)

Will commence 1966 Ready to cover in Jan 3, 1966 Inspection 1966

Amount of Fee \$ 2.45

Signed D. H. Murray

DO NOT WRITE BELOW THIS LINE

SERVICE METER GROUND

VISITS: 1 2 3 4 5 6

7 8 9 10 11 12

REMARKS:

INSPECTED BY J. W. H. (OVER)

LOCATION OAK ST 55

INSPECTION DATE 1/3/67

WORK COMPLETED 1/3/67

TOTAL NO. INSPECTIONS 1

REMARKS:

FEE FOR WIRING PERMITS EFFECTIVE JULY 31, 1963

WIRING

1 to 30 Outlets (including switches) \$ 2.00
31 to 60 Outlets (including switches) 3.00
Over 60 Outlets, each Outlet (including switches)05
(Each twelve feet or fraction thereof of fluorescent lighting or
any type of plug molding will be classed as one outlet).

SERVICES

Single Phase 2.00
Three Phase 4.00

MOTORS

Not exceeding 50 H.P. 3.00
Over 50 H.P. 4.00

HEATING UNITS

Domestic (Oil) 2.00
Commercial (Oil) 4.00
Electric Heat (Each Room)75

APPLIANCES

Ranges, Cooking Tops, Ovens, Water Heaters, Disposals, Dish-
washers, etc. — Each Unit 1.50

TEMPORARY WORK (limited to 6 months from date of permit)

Service, Single Phase 1.00
Service, Three Phase 2.00
Wiring, 1-50 Outlets 1.00
Wiring, each additional outlet over 5002
Circuits, Carnivals, Fairs, etc. 10.00

MISCELLANEOUS

Distribution Cabinet or Panel, per unit 1.00
Transformers, per unit 2.00
Air Conditioners, per unit 2.00

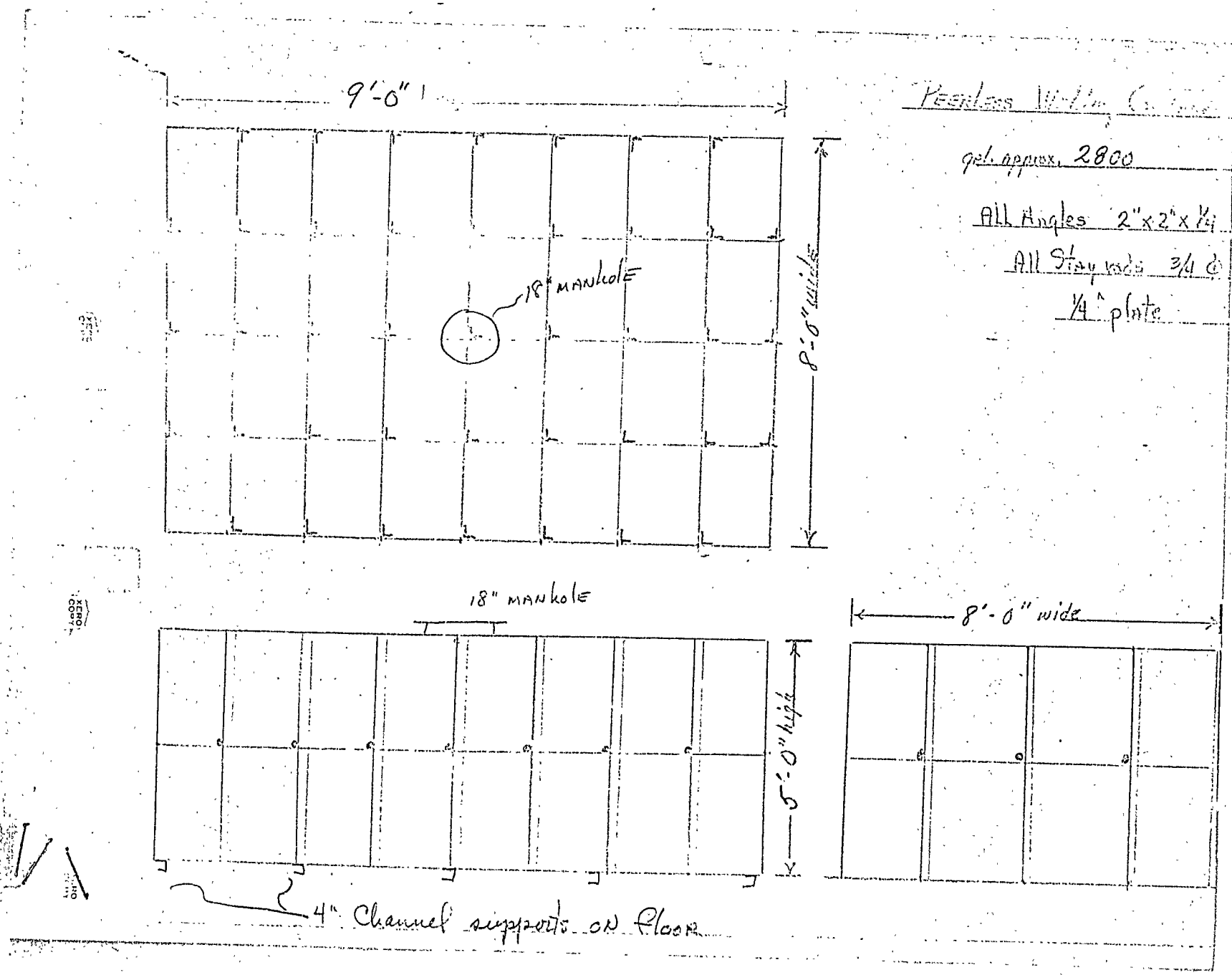

Free Ill

Everett Hill

Oak Ill

RANDALL & McALLISTER
(No. scale)

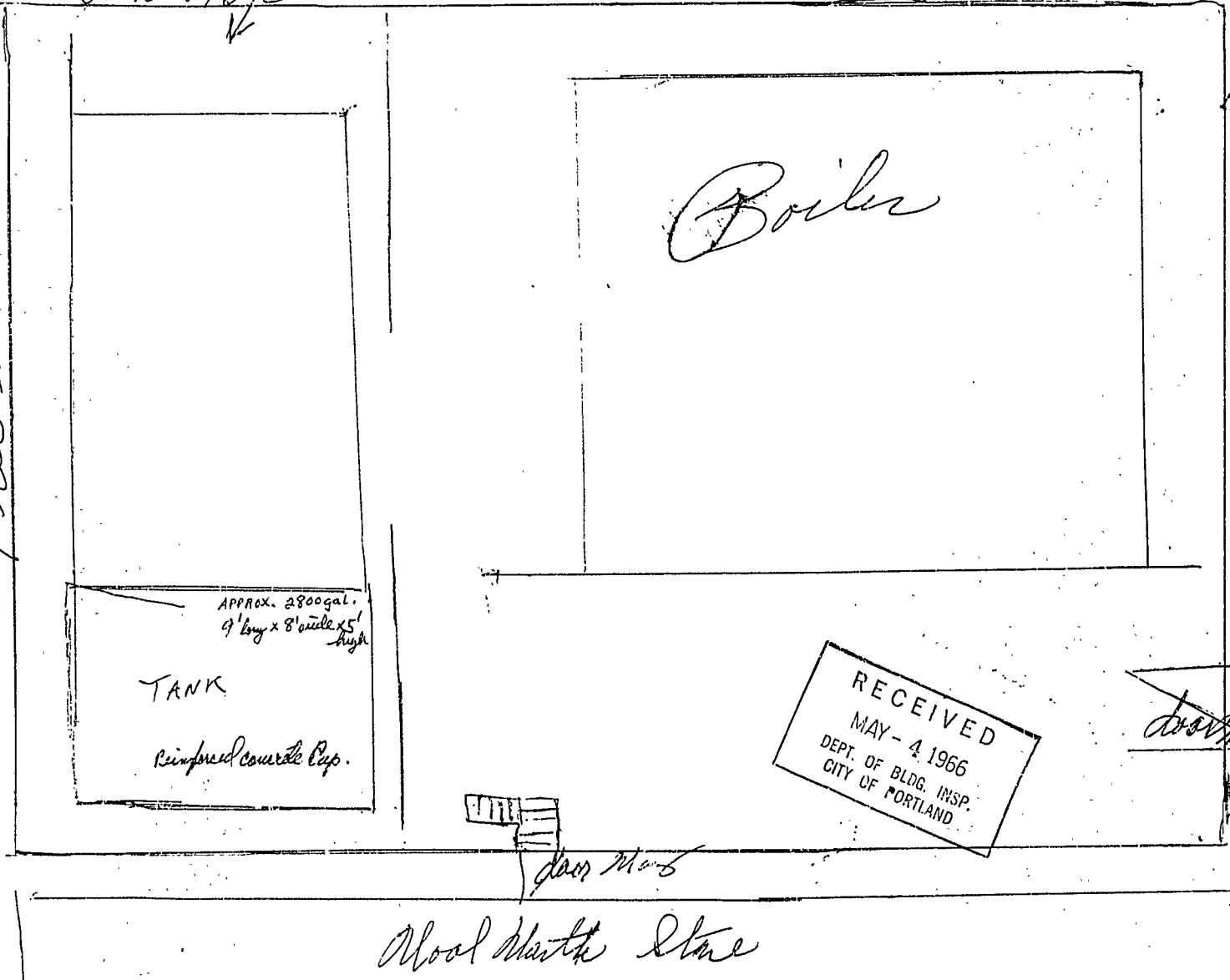

TANK

Reinforced concrete Pipe.

APPROX. 2800 gal.
9' long x 8' wide x 5' high

Boiler

WILL

dam No. 5

Moat North Lane

RECEIVED
MAY - 4 1966
DEPT. OF BLDG. INSP.
CITY OF PORTLAND

[Signature]

<i>Class of Building or Type of Structure</i>	Installation
OTHER THAN THAT OF A SINGLE UNITARY BUILDING OR STRUCTURE	

Portland, Maine, May 4, 1966

PERMIT ISSUED
00328
MAY 6 1966
CITY of PORTLAND

To the INSPECTOR OF BUILDINGS, PORTLAND, MAINE

The undersigned hereby applies for a permit to erect alter repair demolish install the following building structure equipment in accordance with the Laws of the State of Maine, the Building Code and Zoning Ordinance of the City of Portland, plans and specifications, if any, submitted herewith and the following specifications:

Location 51A, Oak St. Within Fire Limits? _____ Dist. No. _____
 Owner's name and address Everett Chambers Co., 51A Oak St. Telephone _____
 Lessee's name and address _____ Telephone _____
 Contractor's name and address Randall & McAllister, 84 Commercial St. Telephone 774-4554
 Architect _____ Specifications _____ Plans _____ No. of sheets _____
 Proposed use of building apt. & rooms- No. families _____
 Last use " No. families _____
 Material _____ No. stories _____ Heat _____ Style of roof _____ Roofing _____
 Other buildings on same lot _____
 Estimated cost \$ _____ Fee \$ 2.00

To install approx. 2800 gal. oil storage tank as per plan

vaulted by 8" solid concrete blocks- reinforced concrete cap on top

Sent to Fire Dept. 5/9/65

Rec'd from Fire Dept. 3/6/61

It is understood that this permit does not include installation of heating apparatus which is to be taken out separately by and in the name of the heating contractor. **PERMIT TO BE ISSUED TO** contractor

Is any plumbing involved in this work? Is any electrical work involved in this work?

Is connection to be made to public sewer? If not, what is proposed for sewage?

Has septic tank notice been sent? Form notice sent?

Height average grade to top of plate Height average grade to highest point of roof

Size, front depth No. stories solid or filled land? earth or rock?

Material of foundation Thickness, top bottom cellar

Kind of roof Rise per foot Roof covering

No. of chimneys Material of chimneys of lining Kind of heat fuel

Framing Lumber—Kind. Dressed or full size? Corner posts Sills

Size Girder Columns under girders Size Max. on centers

Studs (outside walls and carrying partitions) 2x4-16" O. C. Bridging in every floor and flat roof span over 8 feet.

Joists and rafters: 1st floor, 2nd, 3rd roof

On centers: 1st floor, 2nd, 3rd roof

Maximum span: 1st floor, 2nd, 3rd roof

If one story building with masonry walls, thickness of walls? height?

No. cars now accommodated on same lot....., to be accommodated.....number commercial cars to be accommodated.....
Will automobile repairing be done other than minor repairs to cars habitually stored in the proposed building?.....

APPROVED:

Joseph R. Castro
CHIEF OF FIRE DEPT.

CS 30

Miscellaneous

Will work require disturbing of any tree on a public street?.....
 Will there be in-charge of the above work a person competent to
 see that the State and City requirements pertaining thereto are
 observed? yes

Randall & McAllister

INSPECTION COPY

Signature of owner

By:

NOTES

6-1-66 Started - but
not working *Sh*

8-17-66 Completed *Sh*

X

Permit No. 66/38
 Location 518 Oak Street
 Owner Ernest Alvarado Co.
 Date of permit 7/6/66
 Notif. closing-in _____
 Inspn. closing-in _____
 Final Notif. _____
 Final Inspn. _____
 Cert. of Occupancy issued _____
 Staking Out Notice _____
 Form Check Notice _____



B3 BUSINESS ZONE

APPLICATION FOR PERMIT

Second Class

Class of Building or Type of Structure

Portland, Maine,

July 28 1965

PERMIT 1500700

JUL 29 1965

CITY OF PORTLAND

To the INSPECTOR OF BUILDINGS, PORTLAND, MAINE

The undersigned hereby applies for a permit to erect alter repair demolish install the following building structure equipment in accordance with the Laws of the State of Maine, the Building Code and Zoning Ordinance of the City of Portland, plans and specifications, if any, submitted herewith and the following specifications:

Location 55 Oak St. Within Fire Limits? _____ Dist. No. _____
Owner's name and address Dartmouth Real Estate Telephone _____
Lessee's name and address Beneficial Finance Co. 55 Oak St. Telephone _____
Contractor's name and address Haley's Metal Shop, 539 Elm St. Biddeford Me. Telephone _____
Architect _____ Specifications _____ Plans _____ No. of sheets _____
Proposed use of building Office No. families _____
Last use _____ No. families _____
Material brick No. stories 5 Heat _____ Style of roof _____ Roofing _____
Other buildings on same lot _____
Estimated cost \$ _____ Fee \$ 5.00

General Description of New Work

To install Air-Conditioning system for first floor only as per plan.

It is understood that this permit does not include installation of heating apparatus which is to be taken out separately by and in the name of the heating contractor. PERMIT TO BE ISSUED TO contractor

Details of New Work

Is any plumbing involved in this work? _____ Is any electrical work involved in this work? _____
Is connection to be made to public sewer? _____ If not, what is proposed for sewage? _____
Has septic tank notice been sent? _____ Form notice sent? _____
Height average grade to top of plate _____ Height average grade to highest point of roof _____
Size, front _____ depth _____ No. stories _____ solid or filled land? _____ earth or rock? _____
Material of foundation _____ Thickness, top _____ bottom _____ cellar _____
Kind of roof _____ Rise per foot _____ Roof covering _____
No. of chimneys _____ Material of chimneys _____ of lining _____ Kind of heat _____ fuel _____
Framing Lumber—Kind _____ Dressed or full size? _____ Corner posts _____ Sills _____
Size Girder _____ Columns under girders _____ Size _____ Max. on centers _____
Studs (outside walls and carrying partitions) 2x4-16" O. C. Bridging in every floor and flat roof span over 8 feet.
Joists and rafters: 1st floor _____, 2nd _____, 3rd _____, roof _____
On centers: 1st floor _____, 2nd _____, 3rd _____, roof _____
Maximum span: 1st floor _____, 2nd _____, 3rd _____, roof _____
If one story building with masonry walls, thickness of walls? _____ height? _____

If a Garage

No. cars now accommodated on same lot _____, to be accommodated _____ number commercial cars to be accommodated _____
Will automobile repairing be done other than minor repairs to cars habitually stored in the proposed building? _____

APPROVED:

J. E. M.

Miscellaneous

Will work require disturbing of any tree on a public street? no
Will there be in charge of the above work a person competent to see that the State and City requirements pertaining thereto are observed? yes

Haley's Metal Shop

CS 301

INSPECTION COPY

Signature of owner by: _____

B3 BUSINESS ZONE



APPLICATION FOR PERMIT

Class of Building or Type of Structure _____

Portland, Maine, June 15, 1965

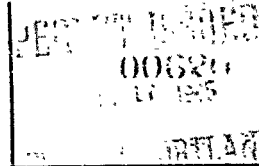

To the INSPECTOR OF BUILDINGS, PORTLAND, MAINE

The undersigned hereby applies for a permit to erect alter repair demolish install the following building structure equipment in accordance with the Laws of the State of Maine, the Building Code and Zoning Ordinance of the City of Portland, plans and specifications, if any, submitted herewith and the following specifications:

Location 49-55 Oak Street Within Fire Limits? _____ Dist. No. _____
Owner's name and address Dartmouth Real Estate Telephone _____
Lessee's name and address Central Yarn Shop, 75 Oak Street Telephone _____
Contractor's name and address M. B. Bourne & Son, 56 Cross St. Telephone 772-3907
Architect _____ Specifications _____ Plans yes No. of sheets 1
Proposed use of building Stores No. families _____
Last use " No. families _____
Material brick No. stories 5 Heat _____ Style of roof _____ Roofing _____
Other buildings on same lot _____
Estimated cost \$ _____ Fee \$ 5.00

General Description of New Work

To install sheet metal duct work for air conditioning and toilet ventilation as per plan

It is understood that this permit does not include installation of heating apparatus which is to be taken out separately by and in the name of the heating contractor. **PERMIT TO BE ISSUED TO** M. B. Bourne & Son

Details of New Work

Is any plumbing involved in this work? _____ Is any electrical work involved in this work? _____
Is connection to be made to public sewer? _____ If not, what is proposed for sewage? _____
Has septic tank notice been sent? _____ Form notice sent? _____
Height average grade to top of plate _____ Height average grade to highest point of roof _____
Size, front _____ depth _____ No. stories _____ solid or filled land? _____ earth or rock? _____
Material of foundation _____ Thickness, top _____ bottom _____ cellar _____
Kind of roof _____ Rise per foot _____ Roof covering _____
No. of chimneys _____ Material of chimneys _____ of lining _____ Kind of heat _____ fuel _____
Framing Lumber—Kind _____ Dressed or full size? _____ Corner posts _____ Sills _____
Size Girder _____ Columns under girders _____ Size _____ Max. on centers _____
Studs (outside walls and carrying partitions) 2x4-16" O. C. Bridging in every floor and flat roof span over 8 feet.
Joists and rafters: 1st floor _____, 2nd _____, 3rd _____, roof _____
On centers: 1st floor _____, 2nd _____, 3rd _____, roof _____
Maximum span: 1st floor _____, 2nd _____, 3rd _____, roof _____
If one story building with masonry walls, thickness of walls? _____ height? _____

If a Garage

No. cars now accommodated on same lot _____, to be accommodated _____ number commercial cars to be accommodated _____
Will automobile repairing be done other than minor repairs to cars habitually stored in the proposed building? _____

APPROVED:

Miscellaneous

Will work require disturbing of any tree on a public street? no
Will there be in charge of the above work a person competent to see that the State and City requirements pertaining thereto are observed? yes

Central Yarn Shop
M. B. Bourne & Son

CS 301

INSPECTION COPY

Signature of owner By: _____

Permit No. 651 630
Location 49-55 Oakville
Owner Central Home Group
Date of permit 6/11/76
Notif. closing-in
Inspn. closing-in
Final Notif.
Final Inspn.
Cert. of Occupancy issued
Sinking Out Notice
Form Check Notice

NOTES

6-28-65 Completed

X

WRITTEN CONSENT AND AGREEMENT RELATING TO A CERTAIN SIGN PROPOSED TO BE
ERECTED PROJECTING OVER A PUBLIC SIDEWALK FROM THE PREMISES
AT 55 Oak Street. IN PORTLAND, MAINE

EVERETT CHAMBERS COMPANY, being the owner of the
premises at 55 Oak Street. in Portland, Maine hereby gives
consent to the erection of a certain sign owned by Beneficial Finance Co.
projecting over the public sidewalk from said premises as described in
application to the Inspector of Buildings of Portland, Maine for a permit
to cover erection of said sign;

And in consideration of the issuance of said permit EVERETT
CHAMBERS COMPANY, owner of said premises, in event said sign
shall cease to serve the purpose for which it was erected or shall become
dangerous and in event the owner of said sign shall fail to remove said sign
or make it permanently safe in case the sign still serves the purpose for
which it was erected, hereby agrees for himself or itself, for his heirs, its
successors, and his or its assigns, to completely remove said sign within ten
days of notice from said Inspector of Buildings that said sign is in such
condition and of order from him to remove it.

In Witness whereof the owner of said premises has signed this
consent and agreement this Third day of June, 1965 .

Jack B. Conway
Witness

EVERETT CHAMBERS COMPANY
By: Arthur W. Mans
Treasurer

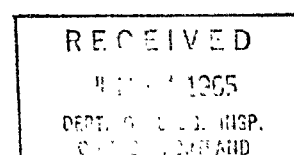



12 sq.ft. Und. Label. P₁ exiglass. Trade name on each

E3 BUSINESS ZONE

APPLICATION FOR PERMIT TO ERECT
SIGN OVER PUBLIC SIDEWALK OR STREET

PERMIT ISSUED

100585
JUN 8 1965

Portland, Maine, June 4, 1965 **CITY OF PORTLAND**

To the INSPECTOR OF BUILDINGS, PORTLAND, ME.

The undersigned hereby applies for a permit to erect the following described sign extending over a public sidewalk or street in accordance with the Building Code of the City of Portland, and the following specifications:

Location 55 Oak St. Within Fire Limits? Dist. No.
Owner of building to which sign is to be attached Everett Chambers Co. 51 Oak St.
Name and address of owner of sign Beneficial Finance Co. 55 Oak St.
Contractor's name and address Coyne Sign Co. 195 St. John St. Telephone 772-4144
When does contractor's bond expire? Dec. 31, 1965

Information Concerning Building **Steady Lighting**

No. stories 5 Material of wall to which sign is to be attached brick

Details of Sign and Connections

Building owner's consent and agreement filed with application yes
Electric? yes Vertical dimension after erection 3' Horizontal 4'
Weight 70 lbs. Will there be any hollow spaces? yes Any rigid frame? yes
Material of frame angleiron No. advertising faces 2 material plastic
No. rigid connections 2 Are they fastened directly to frame of sign? yes
No. through bolts Size Location, top or bottom
No. guys 4 material (3) cable Size 5/16-cable
(1) angleiron 1 1/2 x 3/16 angleiron
Minimum clear height above sidewalk or street 10'
Maximum projection into street 4' 6" Fee \$ 2.00

Signature of contractor by: [Signature]

INSPECTION COPY
H. E. M.

97201

Permit No. 65/585
Location 55 Oak Street
Owner Beneficial Loan Co.
Date of permit 6/8/65
Sign Contractor COYNE
Final Inspn. 6/25/65

NOTES

6/16/65 Sid. W. ...
6/19/65
made 8.9.9. Ship prop.
6/25/65 work done
888

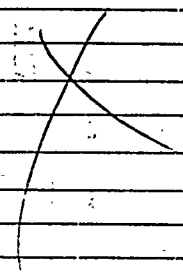

CITY OF PORTLAND, MAINE
Application for Permit to Install Wires

Permit No. 53939

Issued

Portland, Maine 6-2-65, 19

To the City Electrician, Portland, Maine:

The undersigned hereby applies for a permit to install wires for the purpose of conducting electric current, in accordance with the laws of Maine, the Electrical Ordinance of the City of Portland, and the following specifications:

(This form must be completely filled out - Minimum Fee, \$1.00)

Owner's Name and Address Everett Hotel 51 Oak St. Tel.

Contractor's Name and Address H. W. Cleveland Co. Tel. 722-5481

Location 55 Oak St. Use of Building

Number of Families Apartments Stores Number of Stories

Description of Wiring: New Work Additions Alterations

Pipe Cable Metal Molding BX Cable Plug Molding (No. of feet)

No. Light Outlets 7 Plugs 12 Light Circuits 3 Plug Circuits 3

FIXTURES: No. 7 Light Switches 4 Fluor. or Strip Lighting (No. feet) 48

SERVICE: Pipe Cable Underground No. of Wires Size

METERS: Relocated Added Total No. Meters

MOTORS: Number Phase H. P. Amps Volts Starter

HEATING UNITS: Domestic (Oil) No. Motors Phase H.P.

Commercial (Oil) No. Motors Phase H.P.

Electric Heat (No. of Rooms)

APPLIANCES: No. Ranges Watts Brand Feeds (Size and No.)

Elec. Heaters Watts

Miscellaneous Watts Extra Cabinets or Panels

Transformers Air Conditioners (No. Units) Signs (No. Units)

Will commence 6-1-65 Ready to cover in 6-2-1965 Inspection 19

Amount of Fee \$ 2.00

Signed H. W. Cleveland Co.

DO NOT WRITE BELOW THIS LINE

SERVICE METER GROUND

VISITS: 2 3 4 5 6

7 8 9 10 11 12

REMARKS:

INSPECTED BY F. W. Herbert

(OVER)

LOCATION OAK ST- 53
 INSPECTION DATE 6/7/65
 WORK COMPLETED 6/7/65
 TOTAL NO. INSPECTIONS 1
 REMARKS:

FEES FOR WIRING PERMITS EFFECTIVE JULY 31, 1963

WIRING

1 to 30 Outlets (including switches) \$ 2.00
 31 to 60 Outlets (including switches) 3.00
 Over 60 Outlets, each Outlet (including switches)05
 (Each twelve feet or fraction thereof of fluorescent lighting or
 any type of plug molding will be classed as one outlet).

SERVICES

Single Phase 2.00
 Three Phase 4.00

MOTORS

Not exceeding 50 H.P. 3.00
 Over 50 H.P. 4.00

HEATING UNITS

Domestic (Oil) 2.00
 Commercial (Oil) 4.00
 Electric Heat (Each Room)75

APPLIANCES

Ranges, Cooking Top, Ovens, Water Heaters, Disposals, Dish-
 washers, etc. — Each Unit 1.50

TEMPORARY WORK (Limited to 6 months from date of permit)

Service, Single Phase 1.00
 Service, Three Phase 2.00
 Wiring, 1-50 Outlets 1.00
 Wiring, each additional outlet over 5002
 Circuits, Carnivals, Fairs, etc. 10.00

MISCELLANEOUS

Distribution Cabinet or Panel, per unit 1.00
 Transformers, per unit 2.00
 Air Conditioners, per unit 2.00
 Signs, per unit 2.00

CITY OF PORTLAND, MAINE
Application for Permit to Install Wires

Permit No. 53938

Issued

Portland, Maine 6-2-65, 19

To the City Electrician, Portland, Maine:

The undersigned hereby applies for a permit to install wires for the purpose of conducting electric current, in accordance with the laws of Maine, the Electrical Ordinance of the City of Portland, and the following specifications:

(This form must be completely filled out - Minimum Fee, \$1.00)

Owner's Name and Address French Hotel - 510 2nd St. Tel.

Contractor's Name and Address L. W. Cleveland Co. Tel. 722-5481

Location 53 Oak St. Use of Building

Number of Families Apartments Stores Number of Stories

Description of Wiring: New Work Additions Alterations

Pipe Cable Metal Molding BX Cable Plug Molding (No. of feet)

No. Light Outlets 14 Plugs 6 Light Circuits 6 Plug Circuits 2

FIXTURES: No. 29 Light Switches Fluor. or Strip Lighting (No. feet) 56'

SERVICE: Pipe Cable Underground No. of Wires Size

METERS: Relocated Added Total No. Meters

MOTORS: Number Phase H. P. Amps Volts Starter

HEATING UNITS: Domestic (Oil) No. Motors Phase H.P.

Commercial (Oil) No. Motors Phase H.P.

Electric Heat (No. of Rooms)

APPLIANCES: No. Ranges Watts Brand Feeds (Size and No.)

Elec. Heaters Watts

Miscellaneous Watts Extra Cabinets or Panels

Transformers Air Conditioners (No. Units) Signs (No. Units)

Will commence 6-1-65 19 Ready to cover in 6-2-65 19 Inspection 19

Amount of Fee \$ 3.00

Signed L. W. Cleveland Co. -

L. W. Cleveland

DO NOT WRITE BELOW THIS LINE

SERVICE METER GROUND

VISITS: 1 2 3 4 5 6

7 8 9 10 11 12

REMARKS:

INSPECTED BY

F. W. Shubert

(OVER)

LOCATION CH K. ST. 53

INSPECTION DATE 4/7/65

WORK COMPLETED 6/2/65

TOTAL NO. INSPECTIONS

REMARKS:

FEES FOR WIRING PERMITS EFFECTIVE JULY 31, 1963

WIRING

1 to 30 Outlets (including switches) \$ 2.00
31 to 60 Outlets (including switches) 3.00
Over 60 Outlets, each Outlet (including switches)05
(Each twelve feet or fraction thereof of fluorescent lighting or
any type of plug molding will be charged as one outlet).

SERVICES

Single Phase 2.00
Three Phase 4.00

MOTORS

Not exceeding 50 H.P. 3.00
Over 50 H.P. 4.00

HEATING UNITS

Domestic (Oil) 2.00
Commercial (Oil) 4.00
Electric Heat (Each Room)75

APPLIANCES

Ranges, Cooking Tops, Ovens, Water Heaters, Disposals, Dish-
washers, etc. — Each Unit 1.50

TEMPORARY WORK (limited to 6 months from date of permit)

Service, Single Phase 1.00
Service, Three Phase 2.00
Wiring, 150 Outlets 1.00
Wiring, each additional outlet over 5002
Circuits, Conduits, Fairs, etc. 10.00

MISCELLANEOUS

Distribution Cabinet or Panel, per unit 1.00
Transformers, per unit 2.00



APPLICATION FOR AMENDMENT TO PERMIT

Amendment No. Second Class
Portland, Maine, May 12, 1965

PERMIT ISSUED

MAY 13 1965

CITY of PORTLAND

To the INSPECTOR OF BUILDINGS, PORTLAND, MAINE

The undersigned hereby applies for amendment to Permit No. 65/317 pertaining to the building or structure comprised in the original application in accordance with the Laws of the State of Maine, the Building Code and Zoning Ordinance of the City of Portland, plans and specifications, if any, submitted herewith, and the following specifications:

Location 53 Oak St. Within Fire Limits? Dist. No.
Owner's name and address Everett Chambers Inc, 51a Oak St. Telephone
Lessee's name and address Telephone
Contractor's name and address F.W. Cunningham & Sons 181 State St. Telephone
Architect Plans filed No. of sheets
Proposed use of building Apts. & Stores No. families
Last use " & Restaurant No. families
Increased cost of work 7000.00 Additional fee 14.00

Description of Proposed Work

To finish off one room, first floor for sales space, covered with plywood and sheetrock.

Details of New Work contractor

Is any plumbing involved in this work? Is any electrical work involved in this work?
Height average grade to top of plate Height average grade to highest point of roof
Size, front depth No. stories solid or filled land? earth or rock?
Material of foundation Thickness, top bottom cellar
Material of underpinning Height Thickness
Kind of roof Rise per foot Roof covering
No. of chimneys Material of chimneys of lining
Framing lumber—Kind Dressed or full size?
Corner posts Sills Girt or ledger board? Size
Girders Size Columns under girders Size Max. on centers
Studs (outside walls and carrying partitions) 2x4-16" C. Bridging in every floor and flat roof span over 8 feet.
Joists and rafters: 1st floor , 2nd , 3rd , roof
On centers: 1st floor , 2nd , 3rd , roof
Maximum span: 1st floor , 2nd , 3rd , roof

Approved:

G. E. M. W. / owner

Everett Chambers Inc.

F.W. Cunningham & Sons
Signature of Owner

Approved:

Albert J. Sears
Inspector of Building

INSPECTION COPY
CS-105



B3 BUSINESS ZONE

APPLICATION FOR PERMIT

Class of Building or Type of Structure Second ClassPortland, Maine,March 29, 1965PERMIT ISSUED
00317
APR 2 1965
CITY OF PORTLAND

To the INSPECTOR OF BUILDINGS, PORTLAND, MAINE

The undersigned hereby applies for a permit to erect alter repair demolish install the following building structure equipment in accordance with the Laws of the State of Maine, the Building Code and Zoning Ordinance of the City of Portland, plans and specifications, if any, submitted herewith and the following specifications:

Location 53 Oak St. Within Fire Limits? _____ Dist. No. _____
Owner's name and address Everett Chambers, Inc. 52 Oak St. Telephone _____
Lessee's name and address _____ Telephone _____
Contractor's name and address F.W. Cunningham & Sons 181 State St. Telephone 773-0246
Architect _____ Specifications _____ Plans yes No. of sheets 1
Proposed use of building Apts. & Stores No. families _____
Last use " & restaurant No. families _____
Material brick No. stories 5 Heat _____ Style of roof _____ Roofing _____
Other buildings on same lot _____
Estimated cost \$ 5500.00 Fee \$ 12.00

General Description of New Work

To erect (1)-non-bearing partition in Area #1 for office space.(see plan)
2x4 studs 16" o.c. covered with 1/2" sheetrock with vinyl covering(double stud wall)
To remove existing ceiling.
To install new suspended ceiling (see plan)

Permit Issued with Letter

It is understood that this permit does not include installation of heating apparatus which is to be taken out separately by and in the name of the heating contractor. PERMIT TO BE ISSUED TO contractor

Details of New Work

Is any plumbing involved in this work? _____ Is any electrical work involved in this work? _____
Is connection to be made to public sewer? _____ If not, what is proposed for sewage? _____
Has septic tank notice been sent? _____ Form notice sent? _____
Height average grade to top of plate _____ Height average grade to highest point of roof _____
Size, front _____ depth _____ No. stories _____ solid or filled land? _____ earth or rock? _____
Material of foundation _____ Thickness, top _____ bottom _____ cellar _____
Kind of roof _____ Rise per foot _____ Roof covering _____
No. of chimneys _____ Material of chimneys _____ of lining _____ Kind of heat _____ fuel _____
Framing Lumber—Kind _____ Dressed or full size? _____ Corner posts _____ Sills _____
Size Girder _____ Columns under girders _____ Size _____ Max. on centers _____
Studs (outside walls and carrying partitions) 2x4-16" O. C. Bridging in every floor and flat roof span over 8 feet.
Joists and rafters: 1st floor _____, 2nd _____, 3rd _____, roof _____
On centers: 1st floor _____, 2nd _____, 3rd _____, roof _____
Maximum span: 1st floor _____, 2nd _____, 3rd _____, roof _____
If one story building with masonry walls, thickness of walls? _____ height? _____

If a Garage

No. cars now accommodated on same lot _____, to be accommodated _____ number commercial cars to be accommodated _____
Will automobile repairing be done other than minor repairs to cars habitually stored in the proposed building? _____

APPROVED:

J. E. Mc W / letter

Miscellaneous

Will work require disturbing of any tree on a public street? no
Will there be in charge of the above work a person competent to see that the State and City requirements pertaining thereto are observed? yes

Everett Chambers Inc.

F W Cunningham & Sons

Signature of owner by: *Paul E. Reddon*

CS 301

INSPECTION COPY

NOTES

4-22-65 Wall up
to remove loose metal
ceiling before new
hanging ceiling *HO*
4-28-65 Ready to
close in. Sprinklers
left above & lowered
on left side *HO*
loan co office *HO*
6-7-65 Completed *HO*

X

Permit No. 65/31700
Location 53 Oak St
Owner Everett Anderson Inc.
Date of permit 4/2/65
Notif. closing in
Inspn. closing in
Final Notif.
Final Inspn.
Cert. of Occupancy issued
Sinking Out Notice
Form Check Notice



Plastic Face-16 sq. ft.
Und. Label. Each piece has trade name on it.
B3 BUSINESS ZONE

APPLICATION FOR PERMIT TO ERECT
SIGN OVER PUBLIC SIDEWALK OR STREET

PERMIT ISSUED
00892
AUG 1 1963
CITY of PORTLAND

Portland, Maine, July 30, 1963 19

To the INSPECTOR OF BUILDINGS, PORTLAND, ME.

The undersigned hereby applies for a permit to erect the following described sign extending over a public sidewalk or street in accordance with the Building Code of the City of Portland, and the following specifications:

Location 51a Oak St. Within Fire Limits? Dist. No.
Owner of building to which sign is to be attached Everett Chambers Co. 51a Oak St.
Name and address of owner of sign Everett Hotel, 51a Oak St.
Contractor's name and address Coyne Sign Co. 195 St. John St. Telephone 772-4114
When does contractor's bond expire? Dec. 31, 1963

Information Concerning Building

No. stories 5 Material of wall to which sign is to be attached brick

Details of Sign and Connections

Building owner's consent and agreement filed with application yes
Electric? yes Vertical dimension after erection 5'9" Horizontal 4'6"
Weight 125 lbs., Will there be any hollow spaces? yes Any rigid frame? yes
Material of frame angle iron No. advertising faces 2 material plastic
No. rigid connections 2 Are they fastened directly to frame of sign? yes
No. through bolts 1 Size 3/4" Location, top or bottom top
No. guys 5 material cable Size 5/16
Minimum clear height above sidewalk or street 18'
Maximum projection into street 45" 1'9"

INSPECTION COPY

J. E. M.

Signature of contractor

Joseph P. Coyne

Fee \$ 2.00

J. M.

9/12
Permit No. 63/894
Location 51a. Cole St.
Owner E. Smith Hotel
Date of permit 9/1/63
Sign Contractor
Final Inspn. 9/13/63

NOTES

8/13/63 Reading flow
shop in room 1
8/12/63 - Shop in room
made. E. S. D.
9/13/63 - Work done
E. S. D.

WRITTEN CONSENT AND AGREEMENT RELATING TO A CERTAIN SIGN PROPOSED TO BE
ERECTED PROJECTING OVER A PUBLIC SIDEWALK FROM THE PREMISES
AT Oak Street IN PORTLAND, MAINE

EVERETT CHAMBERS COMPANY, being the owner of the
premises at Oak Street, in Portland, Maine hereby gives
consent to the erection of a certain sign owned by Hotel Everett
projecting over the public sidewalk from said premises as described in
application to the Inspector of Buildings of Portland, Maine for a permit
to cover erection of said sign;

And in consideration of the issuance of said permit EVERETT CHAMBERS COMPANY, owner of said premises, in event said sign
shall cease to serve the purpose for which it was erected or shall become
dangerous and in event the owner of said sign shall fail to remove said sign
or make it permanently safe in case the sign still serves the purpose for
which it was erected, hereby agrees for himself or itself, for his heirs, its
successors, and his or its assigns, to completely remove said sign within ten
days of notice from said Inspector of Buildings that said sign is in such
condition and of order from him to remove it.

In Witness whereof the owner of said premises has signed this
consent and agreement this 29th day of July, 1963.

Jack B. Conway
Witness

EVERETT CHAMBERS COMPANY
By: Robert W. Means
Owner Treasurer

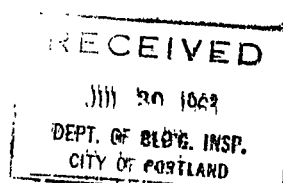



FILL IN AND SIGN WITH INK

APPLICATION FOR PERMIT FOR
HEATING, COOKING OR POWER EQUIPMENT

Portland, Maine, November 30 1962

PERMIT ISSUED
DEC 9 1962
01600

To the INSPECTOR OF BUILDINGS, PORTLAND, ME.

The undersigned hereby applies for a permit to install the following heating, cooking or power equipment in accordance with the Laws of Maine, the Building Code of the City of Portland, and the following specifications:

Location 51a Oak St. Use of Building Stores & Apts. No. Stories 5 New Building
Name and address of owner of appliance Fletcher Means, 95 Exchange St. Existing "
Installer's name and address Randall & McAllister 84 Commercial St. Telephone 4-4554

General Description of Work

To install Oil burner (replacement) central heating system.
steam heating system.

IF HEATER, OR POWER BOILER

Location of appliance Any burnable material in floor surface or beneath?
If so, how protected? Kind of fuel?
Minimum distance to burnable material, from top of appliance or casing top of furnace
From top of smoke pipe From front of appliance From sides or back of appliance
Size of chimney flue Other connections to same flue
If gas fired, how vented? Rated maximum demand per hour
Will sufficient fresh air be supplied to the appliance to insure proper and safe combustion?

IF OIL BURNER

Name and type of burner Sunray-gunttype Labelled by underwriters' laboratories? yes
Will operator be always in attendance? Does oil supply line feed from top or bottom of tank? bottom
Type of floor beneath burner concrete Size of vent pipe 2"
Location of oil storage outside underground Number and capacity of tanks 1000 existing
Low water shut off yes Make Watts No. 1000
Will all tanks be more than five feet from any flame? yes How many tanks enclosed?
Total capacity of any existing storage tanks for furnace burners

IF COOKING APPLIANCE

Location of appliance Any burnable material in floor surface or beneath?
If so, how protected? Height of Legs, if any
Skirting at bottom of appliance? Distance to combustible material from top of appliance?
From front of appliance From sides and back From top of smokepipe
Size of chimney flue Other connections to same flue
Is hood to be provided? If so, how vented? Forced or gravity?
If gas fired, how vented? Rated maximum demand per hour

MISCELLANEOUS EQUIPMENT OR SPECIAL INFORMATION

Amount of fee enclosed? 2.00 (\$2.00 for one heater, etc., \$1.00 additional for each additional heater, etc., in same building at same time.)

APPROVED:

OK. 11.30.62. J.M.

Will there be in charge of the above work a person competent to see that the State and City requirements pertaining thereto are observed? Yes

Randall & McAllister

CS 300

INSPECTION COPY

Signature of Installer by:

M. R. Kilgore

Permit No. 62/1600
Location 51a Oak St.
Owner Fletcher Means
Date of permit 12/3/62
Approved 12/4/62 [Signature]

NOTES

1	Valve	✓
2	Valve	✓
3	Line of Lead	✓
4	Pressure Regulator & Supports	✓
5	Sample Label	✓
6	Tank Control	✓
7	High Pressure Control	✓
8	Remedy Control	✓
9	Flame Support & Protection	✓
10	Valves in Supply Line	✓
11	Capacity of Tank	✓
12	Tank Rating & Supports	✓
13	Tank Pressure	✓
14	Oil Change	✓
15	Insulation Control	✓
16	Low Water Shut-off	✓

WRITTEN CONSENT AND AGREEMENT RELATING TO A CERTAIN SIGN PROPOSED TO BE
ERECTED PROJECTING OVER A PUBLIC SIDEWALK FROM THE PREMISES

AT 51 Oak St. IN PORTLAND, MAINE

EVERETT CHAMBERS COMPANY, being the owner of the
premises at 51 Oak St. in Portland, Maine hereby gives
consent to the erection of a certain sign owned by Sewing Machine Center
projecting over the public sidewalk from said premises as described in
application to the Inspector of Buildings of Portland, Maine for a permit
to cover erection of said sign;

And in consideration of the issuance of said permit EVERETT
CHAMBERS COMPANY, owner of said premises, in event said sign
shall cease to serve the purpose for which it was erected or shall become
dangerous and in event the owner of said sign shall fail to remove said sign
or make it permanently safe in case the sign still serves the purpose for
which it was erected, hereby agrees for himself or itself, for his heirs, its
successors, and his or its assigns, to completely remove said sign within ten
days of notice from said Inspector of Buildings that said sign is in such
condition and of order from him to remove it.

In Witness whereof the owner of said premises has signed this
consent and agreement this 11th day of September, 1962.

EVERETT CHAMBERS CO.

William P. Crossland
Witness

By Robert W. Meane, TREAS.
Owner

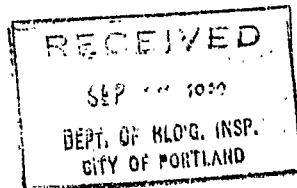



B3 BUSINESS ZONE

APPLICATION FOR PERMIT TO ERECT
SIGN OVER PUBLIC SIDEWALK OR STREETPERMIT ISSUED
01178
SEP 13 1962
CITY OF PORTLAND

Portland, Maine, September 13, 1962

To the INSPECTOR OF BUILDINGS, PORTLAND, ME.

The undersigned hereby applies for a permit to erect the following described sign extending over a public sidewalk or street in accordance with the Building Code of the City of Portland, and the following specifications:

Location 51 Oak St.

Within Fire Limits?

Dist. No.

Owner of building to which sign is to be attached Everett Chambers, 51a Oak St.

Name and address of owner of sign Sewing Machine Center, 51 Oak St.

Contractor's name and address Coyne Sign Co. 195 St. John St.

Telephone 2-4144

When does contractor's bond expire? Dec. 31, 1962

Information Concerning Building

No. stories 5 Material of wall to which sign is to be attached brick

Details of Sign and Connections

Building owner's consent and agreement filed with application yes

Electric? Vertical dimension after erection Horizontal

Weight 60 lbs., Will there be any hollow spaces? yes Any rigid frame? yes

Material of frame angle iron No. advertising faces 2 material metal

No. rigid connections 2 Are they fastened directly to frame of sign? yes

No. through bolts Size Location, top or bottom

No. guys 2 material (2) cable Size cable 5/16

(1) angle iron Size angle iron 1 1/2 x 3/16

Minimum clear height above sidewalk or street 10'

Maximum projection into street 4' 8" Fee \$ 2.00

Signature of contractor by J. S. Coyne

INSPECTION COPY

Approved by E. M.

F.M.

10/30

Permit No.

62/1178

Location

51 Oak St.

Owner

Sewing Machine Center

Date of permit

9/18/62

Sign Contractor

Final Inspn.

NOTES

10/18/62 - work done

ESP

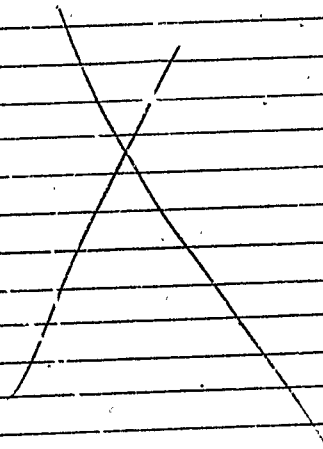

WRITTEN CONSENT AND AGREEMENT RELATING TO A CERTAIN SIGN PROPOSED TO BE

ERECTED PROJECTING OVER A PUBLIC SIDEWALK FROM THE PREMISES

AT 49 Oak Street IN PORTLAND, MAINE

Everett Chambers Co., being the owner of the premises at 49 Oak Street in Portland, Maine hereby gives consent to the erection of a certain sign owned by Rita's Costume Jewelry projecting over the public sidewalk from said premises as described in application to the Inspector of Buildings of Portland, Maine for a permit to cover erection of said sign;

And in consideration of the issuance of said permit Everett Chambers Co., owner of said premises, in event said sign shall cease to serve the purpose for which it was erected or shall become dangerous and in event the owner of said sign shall fail to remove said sign or make it permanently safe in case the sign still serves the purpose for which it was erected, hereby agrees for himself or itself, for his heirs, its successors, and his or its assigns, to completely remove said sign within ten days of notice from said Inspector of Buildings that said sign is in such condition and of order from him to remove it.

In Witness whereof the owner of said premises has signed this consent and agreement this 25th day of April, 1962.

J. J. Coyne
Witness

Edrett Hotel Elizabeth Hamon
Owner

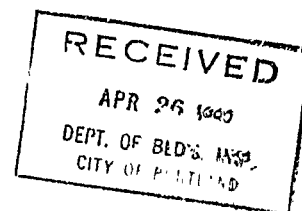



B3 BUSINESS ZONE
APPLICATION FOR PERMIT TO ERECT
SIGN OVER PUBLIC SIDEWALK OR STREET

PERMIT ISSUED
00412
MAY 2 1962
CITY OF PORTLAND

Portland, Maine, April 26, 1962 19

To the INSPECTOR OF BUILDINGS, PORTLAND, ME.

The undersigned hereby applies for a permit to erect the following described sign extending over a public sidewalk or street in accordance with the Building Code of the City of Portland, and the following specifications:

Location 49 Oak St. Within Fire Limits? Dist. No.

Owner of building to which sign is to be attached Everett Chambers, 51a Oak St.

Name and address of owner of sign Rita's Costume Jewelry, 49 Oak St.

Contractor's name and address Coyne Sign Company, 195 St. John St. Telephone 2-4144

When does contractor's bond expire? Dec. 31, 1962

Information Concerning Building

No. stories 5 Material of wall to which sign is to be attached brick no lighting.

Details of Sign and Connections

Building owner's consent and agreement filed with application yes

Electric? yes Vertical dimension after erection 5'0" Horizontal 4'

Weight 60 lbs., Will there be any hollow space? yes Any rigid frame? yes

Material of frame angleiron No. advertising faces 2, material metal

No. rigid connections 2 Are they fastened directly to frame of sign? yes

No. through bolts no, Size , Location, top or bottom

No. guys 2, material cable & angleiron Size cable-5/16
angleiron 1/2x1/2x3/16

Minimum clear height above sidewalk or street 10'

Maximum projection into street 4'6" Fee \$ 2.00

Signature of contractor by: J. H. Coyne

INSPECTION COPY

Jeff. G. E. No.

73M

5/14
621 412
Permit No. _____
Location 49 Oak St. _____
Owner Rita's Costume jewelry _____
Date of permit 5/3/62 _____
Sign Contractor COYNE _____
Final Inspn. 5/14/62 _____

NOTES

5/14/62 - Work done
E. S. S.



B3 BUSINESS ZONE

APPLICATION FOR PERMIT TO ERECT
SIGN OVER PUBLIC SIDEWALK OR STREET

PERMIT ISSUED
01379
SEP 22 1960
CITY of PORTLAND

Portland, Maine, Sept. 15, 1960 19

To the INSPECTOR OF BUILDINGS, PORTLAND, ME.

The undersigned hereby applies for a permit to erect the following described sign extending over a public sidewalk or street in accordance with the Building Code of the City of Portland, and the following specifications:

Location 47-53 Oak St. Within Fire Limits? _____ Dist. No. _____
Owner of building to which sign is to be attached Everett Chambers Co.
Name and address of owner of sign 47-53 Oak St.
Contractor's name and address United Neon 74 Elm St. Telephone 2-0695
When does contractor's bond expire? Dec. 31, 1960

Information Concerning Building

No. stories 5 Material of wall to which sign is to be attached brick

Details of Sign and Connections

Building owner's consent and agreement filed with application _____
Electric? yes Vertical dimension after erection 18'9" Horizontal 30"
Weight 250 lbs., Will there be any hollow spaces? yes Any rigid frame? yes
Material of frame angle iron No. advertising faces 2, material plastif
No. rigid connections 4 Are they fastened directly to frame of sign? yes
No. through bolts 1, Size 3/4", Location, top or bottom top
No. guys 4, material angle iron & cable, Size 2x2x1/2"
Minimum clear height above sidewalk or street 14 1/2'
Maximum projection into street 4' Fee \$ 2.00

Signature of contractor United Neon Display Corporation

INSPECTION COPY

F. MacM

112
#145
Permit No. 6011379
Location 47-53 Oak St.
Owner Everett Chapman Co.
Date of permit 9/22/60
Sign Contractor
Final Inspn. 12/2/60

NOTES

10/12/60 - M.D. work
started 8:1
12/2/60 - work done,
M.D. shop inspection
made. E. S. S.

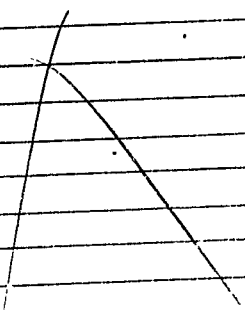

WRITTEN CONSENT AND AGREEMENT RELATING TO A CERTAIN SIGN PROPOSED TO BE
ERECTED PROJECTING OVER A PUBLIC SIDEWALK FROM THE PREMISES
AT 47-53 OAK IN PORTLAND, MAINE

EVERETT CHAMBERS COMPANY, being the owner of the
premises at 47-53 OAK ST. in Portland, Maine hereby gives
consent to the erection of a certain sign owned by EVERETT CHAMBERS CO.
projecting over the public sidewalk from said premises as described in
application to the Inspector of Buildings of Portland, Maine for a permit
to cover erection of said sign;

And in consideration of the issuance of said permit _____
EVERETT CHAMBERS COMPANY, owner of said premises, in event said sign
shall cease to serve the purpose for which it was erected or shall become
dangerous and in event the owner of said sign shall fail to remove said sign
or make it permanently safe in case the sign still serves the purpose for
which it was erected, hereby agrees for himself or itself, for his heirs, its
successors, and his or its assigns, to completely remove said sign within ten
days of notice from said Inspector of Buildings that said sign is in such
condition and of order from him to remove it.

In Witness whereof the owner of said premises has signed this
consent and agreement this 7th day of SEPTEMBER, 1964.

Perley C. Pulverto
Witness

EVERETT CHAMBERS COMPANY
Wm. W. Means
Owner
REASURER

PERMIT
NUMBER 7461

Date Issued 4/24/59
PORTLAND PLUMBING
INSPECTOR

By *[Signature]*
APPROVED FIRST INSPECTION

Date *[Signature]*
By *[Signature]*
APPROVED FINAL INSPECTION

Date *[Signature]*
By *[Signature]*

TYPE OF BUILDING
☐ COMMERCIAL
☐ RESIDENTIAL

☐ SINGLE
☐ MULTI FAMILY

☐ NEW CONSTRUCTION
☐ REMODELING

PERMIT TO INSTALL PLUMBING

Address: 51A Oak St.

Installation For:

Owner of Bldg.: Everett H. Chamberlain

Owner's Address: 20151 1st St. N. Astoria

Plumber: E. Cunningham Co. Date: 4/24/59

NEW	REP'L	PROPOSED INSTALLATIONS	NUMBER	FEE
		SINKS		
		LAVATORIES		
		TOILETS		
		BATH TUBS		
		SHOWERS		
		DRAINS		
		HOT WATER TANKS	3	
		TANKLESS WATER HEATERS	3	
		GARBAGE GRINDERS		
		SEPTIC TANKS		
		HOUSE SEWERS		
		ROOF LEADERS (conn. to house drain)		
1		water coolers	3	3.00
			3	3.00
			Total	

STATEMENT OF ELEVATOR TESTS

PORTLAND, MAINE, December 23, 1958

I, George L. Ward

as an employee of Otis Elevator Company

, have personally supervised the installation or alterations to the elevator, hatchways and enclosures at 51a Oak Street as permitted under Building Permit _____, and have personally supervised tests of loading capacity and of all brakes, interlocking and all other safety devices, and I do here state that, according to my best knowledge and belief, the elevator will safely carry the maximum rated loading and all brakes, interlocking and other safety devices are in satisfactory condition.

(Signature)

PORTLAND, MAINE, Geo. L. Ward

STATE OF MAINE

CUMBERLAND, SS:

Personally appeared the above named George L. Ward and made oath the statements by him subscribed are true.

APPLICANT'S COPY

John D. Tolson
Notary Public Justice of the Peace



APPLICATION FOR ELEVATOR PERMIT

Portland, Maine, September 3, 1958

PERMIT ISSUED

01221
SEP 11 1958

CITY of PORTLAND

To the INSPECTOR OF BUILDINGS, Portland, Me.

The undersigned hereby applies for a permit to install 1 elevator in accordance with the Laws of the State of Maine, the Building Code of the City of Portland, plans and specifications submitted herewith, and the following specifications:

Location 51A Oak St. Ward _____ Within Fire Limits? yes Dist. No. 1
Owner's name and address Everett Chambers, Inc., 51A Oak St.
Elevator contractor's name and address Otis Elevator Co., 550 Forest Ave. Telephone 3-8058
Plans filed as part of application yes No. sheets 1
Last use of building Apartments and stores No. families _____
Proposed use of building " No. families _____
Material of outside walls of building brick, interior frame wood and plaster
No. of stories 5 Style of roof flat No. of existing elevators in building 1
Remarks _____ Fee \$ 2.00

To install 1-passenger elevator

Details of Proposed Work

Extent of work by elevator contractor install elevator
Extent of work by owner shaftway
Type of Elevator passenger, in new or existing shaftway in new
Shaftway enclosed or open enclosed No. elevator stops 5
Capacity of elevator 1200 lbs., Speed in feet per minute 100'
Material of cables steel No. and size of hoisting cables 3- 1/2" ✓
Location of machinery overhead Material of supports steel, of guides steel
Minimum diameter of sheaves 20" ✓ Minimum clearance counterweight and overhead beams 4 1/4" ✓
Minimum clearance above car at topmost floor level 4 1/4" ✓
Minimum clearance buffer plates and springs when car is at lowest floor level 13 and 1/8" ✓
Type of power Wick electric Type of machine No. 1 SWT
Will elevator be equipped with the following safety devices:—governor? yes, car safety? yes, electric brakes? yes, automatic terminal stops at top and bottom? yes, slack cable stops? no, safety floor stops? yes ✓

If Passenger Elevator

Passenger capacity? 9 people Area of platform 4'8" x 4' Material of enclosure steel
No. of entrances 1 Type of gates door type, interlocked yes automatic closing device? yes ✓
Will elevator be automatic or will operator be in attendance? automatic ✓
Will doors in shaftway enclosure be interlocked? yes ✓

If Freight Elevator

Area of platform _____ No. of sides enclosed _____ Height of enclosure _____
Will shaftway be enclosed? _____ Self-closing hatch gates? _____ Height? _____ Bi-parting doors? _____
No. outside entrances to shaftway? _____ Self-closing slatted gates? _____ Height? _____
Signature of elevator contractor By: George H. Ward Otis Elevator Co.

STATEMENT OF ELEVATOR TESTS

PORTLAND, MAINE, _____

I, _____
as an employee of _____, have personally supervised the installation or alterations to the elevator, hatchways and enclosures at _____ as permitted under Building Permit _____, and have personally supervised tests of loading capacity and of all brakes, interlocking and all other safety devices, and I do here state that, according to my best knowledge and belief, the elevator will safely carry the maximum rated loading and all brakes, interlocking and other safety devices are in satisfactory condition.

(Signature)

PORTLAND, MAINE, _____

STATE OF MAINE

CUMBERLAND, SS:

Personally appeared the above named _____ and made oath the statements by him subscribed are true.

INSPECTION COPY

Notary Public Justice of the Peace

✓
Permit No. 58/1221
Location 51A Oak St.
Owner Eberett Chambers Inc.
Date of permit 9/11/58
Elev. Cont. _____
Statement of tests rec'd _____
Final Notif. _____
Final Inspn. _____
Certificate issued _____

NOTES

12/30/58- Elevator all installed. -
Allen

X



APPLICATION FOR AMENDMENT TO PERMIT

Amendment No. #1

Portland, Maine, August 22, 1958

PERMIT ISSUED

AUG 22 1958

CITY of PORTLAND

To the INSPECTOR OF BUILDINGS, PORTLAND, MAINE

The undersigned hereby applies for amendment to Permit No. 58/1035 pertaining to the building or structure comprised in the original application in accordance with the Laws of the State of Maine, the Building Code and Zoning Ordinance of the City of Portland, plans and specifications, if any, submitted herewith, and the following specifications:

Location 51A Oak Street

Owner's name and address Everett Chambers Co., 51A Oak St. Within Fire Limits? yes Dist. No. 1

Lessee's name and address Telephone

Contractor's name and address F. W. Cunningham & Son, 181 State St. Telephone

Architect Telephone

Proposed use of building Apartments and stores Plans filed yes No. of sheets 1

Last use No. families

Increased cost of work No. families

Additional fee 50

Description of Proposed Work

To make a change in steel of elevator shaft as per plan

Details of New Work F. W. Cunningham & Son

Is any plumbing involved in this work? Is any electrical work involved in this work?
Height average grade to top of plate Height average grade to highest point of roof
Size, front depth No. stories solid or filled land? earth or rock?
Material of foundation Thickness, top bottom cellar
Material of underpinning Height Thickness
Kind of roof Rise per foot Roof covering of lining
No. of chimneys Material of chimneys
Framing lumber—Kind Dressed or full size?
Corner posts Sills Girt or ledger board Size
Girders Size Columns under girders Size Max. on centers
Studs (outside walls and carrying partitions) 2x4-16" O. C. Bridging in every floor and flat roof span over 8 feet.
Joists and rafters: 1st floor, 2nd, 3rd, roof
On centers: 1st floor, 2nd, 3rd, roof
Maximum span: 1st floor, 2nd, 3rd, roof

Approved:

INSPECTION COPY
CS. 105

O.K. - 8/22/58
agf

Signature of Owner
By: Everett Chambers Co.
F. W. Cunningham & Son

Approved: Warren Mellon
Inspector of Building



B3 BUSINESS ZONE

APPLICATION FOR PERMIT

Class of Building or Type of Structure Second ClassPortland, Maine, August 1, 1958

PERMIT ISSUED

01035

AUG 11 1958

CITY of PORTLAND

To the INSPECTOR OF BUILDINGS, PORTLAND, MAINE

The undersigned hereby applies for a permit to erect alter repair demolish install the following building structure equipment in accordance with the Laws of the State of Maine, the Building Code and Zoning Ordinance of the City of Portland, plans and specifications, if any, submitted herewith and the following specifications:

Location 51A Oak Street Within Fire Limits? yes Dist. No. 1
Owner's name and address Everett Chambers Co., 51A Oak St. Telephone _____
Lessee's name and address _____ Telephone _____
Contractor's name and address F. W. Cunningham & Son, 181 State St. Telephone _____
Architect _____ Specifications _____ Plans yes No. of sheets 4
Proposed use of building Apts. and stores No. families _____
Last use _____ " _____ No. families _____
Material brick No. stories 5 Heat _____ Style of roof _____ Roofing _____
Other buildings on same lot _____
Estimated cost \$ 10,000 Fee \$ 10.00

General Description of New Work

To remove existing elevator shaft and
To construct new elevator shaft as per plans

It is understood that this permit does not include installation of heating apparatus which is to be taken out separately by and in the name of the heating contractor. PERMIT TO BE ISSUED TO F. W. Cunningham & Son

Details of New Work

Is any plumbing involved in this work? _____ Is any electrical work involved in this work? _____
Is connection to be made to public sewer? _____ If not, what is proposed for sewage? _____
Has septic tank notice been sent? _____ Form notice sent? _____
Height average grade to top of plate _____ Height average grade to highest point of roof _____
Size, front _____ depth _____ No. stories _____ solid or filled land? _____ earth or rock? _____
Material of foundation _____ Thickness, top _____ bottom _____ cellar _____
Material of underpinning _____ Height _____ Thickness _____
Kind of roof _____ Rise per foot _____ Roof covering _____
No. of chimneys _____ Material of chimneys _____ of lining _____ Kind of heat _____ fuel _____
Framing Lumber-Kind _____ Dressed or full size? _____ Corner posts _____ Sills _____
Size Girder _____ Columns under girders _____ Size _____ Max. on centers _____
Kind and thickness of outside sheathing of exterior walls? _____
Studs (outside walls and carrying partitions) 2x4-16" O. C. Bridging in every floor and flat roof span over 8 feet.
Joists and rafters: 1st floor _____, 2nd _____, 3rd _____, roof _____
On centers: 1st floor _____, 2nd _____, 3rd _____, roof _____
Maximum span: 1st floor _____, 2nd _____, 3rd _____, roof _____
If one story building with masonry walls, thickness of walls? _____ height? _____

If a Garage

No. cars now accommodated on same lot _____, to be accommodated _____ number commercial cars to be accommodated _____
Will automobile repairing be done other than minor repairs to cars habitually stored in the proposed building? _____

APPROVED:

with letter by AGJ

Miscellaneous

Will work require disturbing of any tree on a public street? no
Will there be in charge of the above work a person competent to see that the State and City requirements pertaining thereto are observed? yes

Everett Chambers Co.
F. W. Cunningham & Son

INSPECTION COPY

Signature of owner By F. W. Cunningham & Son

NOTES

- Elevator doors - Allen B -
 - All of feathers to be
 - removed till material -
 - 2nd. walls, inside -
 - Clean glass panthers -

8/26/58 - No work started -
 Allen

9/16/58 - Work started -
 Allen

10/13/58 - Steel being put
 in place - Allen

11/3/58 - Getting ready
 for plaster walls at
 station - Allen

11/24/58 - Work progressing -
 Allen

12/9/58 - Shafway about
 done - Allen

12/30/58 - Elevator O.K. -
 Allen

Permit No. 58/1035
 Location 514 Cal. St.
 Owner Pacific Telephone
 Date of permit 8/11/58
 Notif. closing in
 Inspn. closing in
 Final Notif.
 Final Inspn.
 Cert. of Occupancy issued
 Sinking Out Notice
 Form Check Notice

[Empty lines for additional notes or signatures]

[Empty lines for additional notes, crossed out with a large X]