

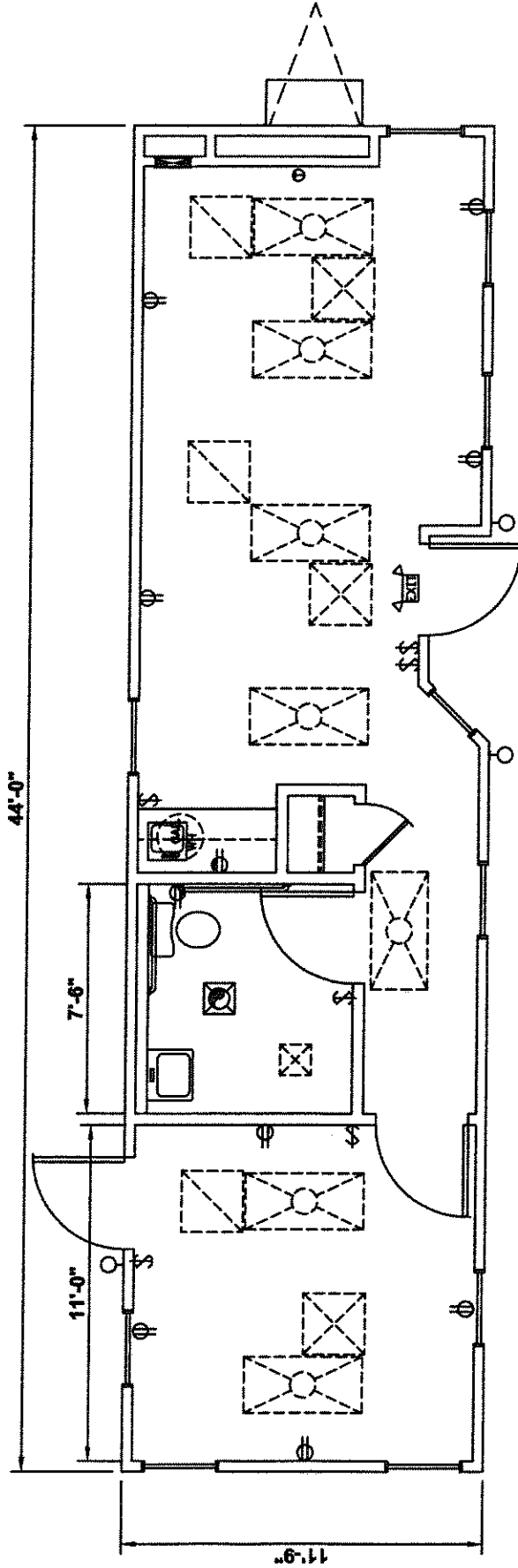

8211 Town Center Drive
 Baltimore, Maryland 21236-5997
800.782.1500
 WWW.WILLISCOT.COM

S04812

SALES OFFICE



Specifications

Size	Interior Finish	Electric	Exterior Finish/Frame
• 48' Long (including hitch)	• Large display/reception area	• Fluorescent ceiling lights	• Wood vertical siding
• 44' Box size	• Carpet floors	• 110/240 volt single phase electric	• Mansard
• 12' Wide nominal	• 2X2 grid ceiling	• 100 AMP breaker panel	• I-Beam outrigger frame
• 8' Ceiling height nominal	• Vinyl covered gyp walls	Windows/Doors	• Standard drip rail gutters
• Multi-section sizes are available	• Private office(s)	• Vertical slider windows	Heating and Cooling
		• French Doors inside and out	• Central A/C
			• Heat in A/C unit

Additional floor plans available. Floor plans and specifications may vary from those shown and are subject to in-stock availability.

DWN BY: MRW	SERIAL#:	REP:	CAD FILE:
SCALE: 3/16"=1'	DWG # A-1	DATE 01/01/10	REV # 0

THE USE OF THIS DRAWING FOR ANY MEANS OTHER THAN INTENDED IS STRICTLY PROHIBITED WITHOUT THE PRIOR WRITTEN CONSENT OF AN AUTHORIZED WILLIAMS SCOTSMAN REPRESENTATIVE.
 © 2010 Williams Scotsman, Inc. All Rights Reserved.