

DISPLAY THIS CARD ON PRINCIPAL FRONTAGE OF WORK



CITY OF PORTLAND BUILDING PERMIT



This is to certify that

TIMBERLAKE SHARON E /Down East Energy

Located at

81 OAKDALE ST

PERMIT ID: 2012-65637

CBL: 116 A027001

has permission to **install (2) 120 Gallon Propane tanks in rear**

provided that the person or persons, firm or corporation accepting this permit shall comply with all of the provisions of the Statutes of Maine and of the Ordinances of the City of Portland regulating the construction, maintenance and use of the buildings and structures, and of the application on file in the department.

Notification of inspection and written permission procured before this building or part thereof is lathed or otherwise closed-in. 48 HOUR NOTICE IS REQUIRED.

A final inspection must be completed by owner before this building or part thereof is occupied. If a certificate of occupancy is required, it must be procured prior to occupancy.

Fire Prevention Officer

 12/26/12

Code Enforcement Officer / Plan Reviewer

**THIS CARD MUST BE POSTED ON THE STREET SIDE OF THE PROPERTY
THERE IS A PENALTY FOR REMOVING THIS CARD**

BUILDING PERMIT INSPECTION PROCEDURES
Please call 874-8703 (ONLY)
or email: buildinginspections@portlandmaine.gov

With the issuance of this permit, the owner, builder or their designee is required to provide adequate notice to the city of Portland Inspections Services for the following inspections. Appointments must be requested 48 to 72 hours in advance of the required inspection. The inspection date will need to be confirmed by this office.

- **Please read the conditions of approval that is attached to this permit!! Contact this office if you have any questions.**
- **Permits expire in 6 months. If the project is not started or ceases for 6 months.**
- **If the inspection requirements are not followed as stated below additional fees may be incurred due to the issuance of a "Stop Work Order" and subsequent release to continue.**

REQUIRED INSPECTIONS:

Footings/Setbacks

Final Inspection

The project cannot move to the next phase prior to the required inspection and approval to continue, REGARDLESS OF THE NOTICE OF CIRCUMSTANCES.

IF THE PERMIT REQUIRES A CERTIFICATE OF OCCUPANCY, IT MUST BE PAID FOR AND ISSUED TO THE OWNER OR DESIGNEE BEFORE THE SPACE MAY BE OCCUPIED.

City of Portland, Maine - Building or Use Permit

389 Congress Street, 04101 Tel: (207) 874-8703, Fax: (207) 874-8716

Permit No: 201265637	Date Applied For: 12/17/2012	CBL: 116 A027001
--------------------------------	--	----------------------------

Location of Construction: 81 OAKDALE ST	Owner Name: TIMBERLAKE SHARON E	Owner Address: 81 OAKDALE ST	Phone:
Business Name:	Contractor Name: Down East Energy	Contractor Address: 172 Main Street South Portland	Phone (207) 799-5585
Lessee/Buyer's Name	Phone:	Permit Type: Tanks - Dwellings	

Proposed Use: Same: Single Family Home	Proposed Project Description: install (2) 120 Gallon Propane tanks in rear
--	--

Dept: Zoning	Status: Approved	Reviewer: Marge Schmuckal	Approval Date: 12/18/2012	Ok to Issue: <input checked="" type="checkbox"/>
Note:				
Dept: Building	Status: Approved w/Conditions	Reviewer: Jon Rioux	Approval Date: 12/26/2012	Ok to Issue: <input checked="" type="checkbox"/>
Note:				
1) A Carbon Monoxide (CO) alarm shall be installed in each area within or giving access to bedrooms. That detection must be powered by the electrical service (plug-in or hardwired) in the building and battery.				
Tanks shall be installed per NFPA 58				
Application approval based upon information provided by the applicant or design professional. Any deviation from approved plans requires separate review and approval prior to work.				

City of Portland, Maine - Building or Use Permit Application

389 Congress Street, 04101 Tel: (207) 874-8703, Fax: (207) 874-8716

Permit No: 2012-65637	Issue Date:	CBL: 116 A027001
---------------------------------	--------------------	----------------------------

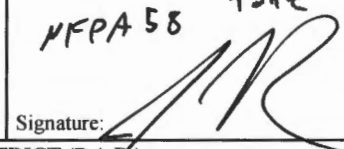
Location of Construction: 81 OAKDALE ST	Owner Name: TIMBERLAKE SHARON E	Owner Address: 81 OAKDALE ST	Phone:
Business Name:	Contractor Name: Down East Energy	Contractor Address: 172 Main Street South Portland	Phone: (207) 799-5585
Lessee/Buyer's Name	Phone:	Permit Type: Tanks - Dwellings	Zone: R5
Past Use: Single Family Home	Proposed Use: Single Family Home	Permit Fee: \$30.00	Cost of Work: \$1,000.00
Proposed Project Description: install (2) 120 Gallon Propane tanks in tank		FIRE DEPT: <input type="checkbox"/> Approved <input type="checkbox"/> Denied <input type="checkbox"/> N/A	INSPECTION: Use Group: MFPA 58 Type: Tank Signature: 
		PEDESTRIAN ACTIVITIES DISTRICT (P.A.D.) Action: <input type="checkbox"/> Approved <input type="checkbox"/> Approved w/Conditions <input type="checkbox"/> Denied Signature: _____ Date: _____	CEO District: 4

Permit Taken By: Idobson	Date Applied For: 12/17/2012	Zoning Approval
------------------------------------	--	------------------------

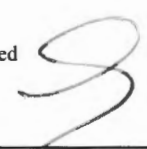
<ol style="list-style-type: none"> This permit application does not preclude the Applicant(s) from meeting applicable State and Federal Rules. Building permits do not include plumbing, septic or electrical work. Building permits are void if work is not started within six (6) months of the date of issuance. False information may invalidate a building permit and stop all work.. 	Special Zone or Reviews <input type="checkbox"/> Shoreland <input type="checkbox"/> Wetland <input type="checkbox"/> Flood Zone <input type="checkbox"/> Subdivision <input type="checkbox"/> Site Plan Maj <input type="checkbox"/> Minor <input type="checkbox"/> MM <input type="checkbox"/> Date: <i>ok</i> 12/18/12	Zoning Appeal <input type="checkbox"/> Variance <input type="checkbox"/> Miscellaneous <input type="checkbox"/> Conditional Use <input type="checkbox"/> Interpretation <input type="checkbox"/> Approved <input type="checkbox"/> Denied Date: _____	Historic Preservation <input checked="" type="checkbox"/> Not in District or Landmark <input type="checkbox"/> Does Not Require Review <input type="checkbox"/> Requires Review <input type="checkbox"/> Approved <input type="checkbox"/> Approved w/Conditions <input type="checkbox"/> Denied Date: 
---	--	---	--

CERTIFICATION

I hereby certify that I am the owner of record of the named property, or that the proposed work is authorized by the owner of record and that I have been authorized by the owner to make this application as his authorized agent and I agree to conform to all applicable laws of this jurisdiction. In addition, if a permit for work described in the application is issued, I certify that the code official's authorized representative shall have the authority to enter all areas covered by such permit at any reasonable hour to enforce the provision of the code(s) applicable to such permit.

SIGNATURE OF APPLICANT	ADDRESS	DATE	PHONE
RESPONSIBLE PERSON IN CHARGE OF WORK, TITLE		DATE	PHONE

2012-65637

FILL IN AND SIGN WITH INK



APPLICATION FOR PERMIT HEATING OR POWER EQUIPMENT

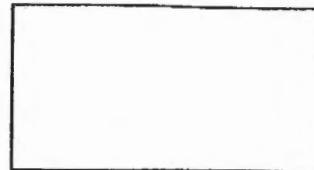

To the INSPECTOR OF BUILDINGS, PORTLAND, ME.

The undersigned hereby applies for a permit to install the following heating, cooking or power equipment in accordance with the Laws of Maine, the Building Code of the City of Portland, and the following specifications:

Location / CBL 116A027001 Use of Building Single Family Resident Date 12/17/2012
 Name and address of owner of appliance Sharon Timberlake
81 Oakdale St. Portland ME 04103
 Installer's name and address Downeast Energy
122 Main St. Portland ME 04106 Telephone 357-799-5555

Location of appliance:

- Basement
- Floor
- Attic
- Roof

Type of Fuel:

- Gas
- Oil
- Solid

Appliance Name:

Installed by others

U.L. Approved Yes No

Will appliance be installed in accordance with the manufacture's installation instructions? Yes No

IF NO Explain: _____

The Type of License of Installer:

- Master Plumber # _____
- Solid Fuel # _____
- Oil # _____
- Gas # PNT 1665
- Other _____

Type of Chimney:

- Masonry Lined
Factory built _____
- Metal
Factory Built U.L. Listing # _____
- Direct Vent
Type _____ UL# _____

Type of Fuel Tank

- Oil
- Gas

Size of Tank 120 gallon

Number of Tanks 2

Distance from Tank to Center of Flame 30 feet.

Cost of Work: \$ 94.00

Permit Fee: \$ _____

Approved

Approved with Conditions

Fire: _____

Ele.: _____

Bldg.: _____

See attached letter or requirement

Inspector's Signature

Date Approved

Signature of Installer

Steve Trudelle / Andrea Karass

White - Inspection

Yellow - File

Pink - Applicant's

Gold - Assessor's Copy

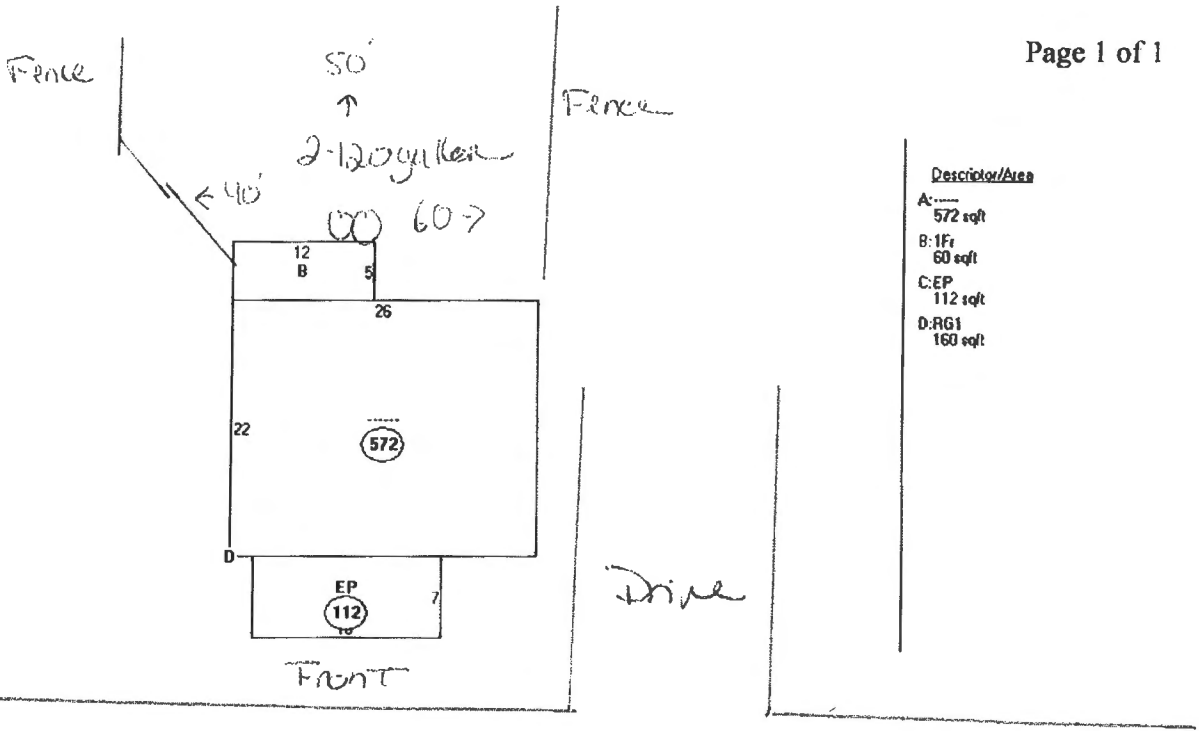

Assessor's Office | 359 Congress Street | Portland, Maine 04101 | Room 115 | (207) 874-8486

[City Home](#) [Departments](#) [City Council](#) [E-Services](#) [Calendar](#) [Jobs](#)

This page contains a detailed description of the Parcel ID you selected. Press the **New Search** button at the bottom of the screen to submit a new query.

Current Owner Information:

Services

[Applications](#)

[Doing Business](#)

[Maps](#)

[Tax Relief](#)

[Tax Roll](#)

[Q & A](#)

[browse city services a-z](#)

[browse facts and links a-z](#)



Best viewed at 600x600, with Internet Explorer

CBL 116 A027001
Land Use Type SINGLE FAMILY
Property Location 81 OAKDALE ST
Owner Information TIMBERLAKE SHARON E
 81 OAKDALE ST
 PORTLAND ME 04103
Book and Page 10074/215
Legal Description 116-A-27
 OAKDALE ST 79-81
Acres 2905 SF
 0.0667

Current Assessed Valuation:

TAX ACCT NO. 16200 **OWNER OF RECORD AS OF APRIL 2012**
 TIMBERLAKE SHARON E
LAND VALUE \$82,900.00 81 OAKDALE ST
BUILDING VALUE \$103,100.00 PORTLAND ME 04103
HOMESTEAD EXEMPTION (\$10,000.00)
NET TAXABLE - REAL ESTATE \$176,000.00
TAX AMOUNT \$3,312.32

Any information concerning tax payments should be directed to the Treasury office at 874-8490 or e-mailed.

Building Information:

Building 1
Year Built 1924
Style/Structure Type OLD STYLE
Stories 2
Units 1
Bedrooms 3
Full Baths 1
Total Rooms 6
Attic UNFIN
Basement FULL
Square Feet 1204
[View Sketch](#) [View Map](#) [View Picture](#)



Outbuildings/Yard Improvements:

Building 1
Year Built 1960
Structure GARAGE-WD/CB
Size 10X16
Units 1
Grade C
Condition F

Sales Information:

Sale Date	Type	Price	Book/Page
5/1/1992	LAND + BUILDING	\$102,000.00	10074/215

[New Search](#)