

GENERAL NOTES

1: DRAWING NOTES:

CONTRACTOR TO FURNISH AND INSTALL ALL NOTED LABOR AND MATERIALS UNLESS OTHERWISE NOTED.

2: CODE COMPLIANCE:

ALL WORK SHALL CONFORM TO THE LATEST EDITION OF STATE, LOCAL AND OTHER CODES WHICH APPLY TO THIS PROJECT OR HAVE JURISDICTION.

3: COORDINATION:

IT IS THE RESPONSIBILITY OF THE CONTRACTOR TO COORDINATE ALL DISCIPLINES AND TRADES SO THAT ALL BUILDING SYSTEMS AND COMPONENTS CAN BE ASSEMBLED WITHOUT CONFLICTS. IN THE EVENT THAT THE CONSTRUCTION DOCUMENTS DEFINE CONDITIONS WHICH PROHIBIT, OR MAY PROHIBIT, SUCH ASSEMBLY, THE CONTRACTOR SHALL BRING TO THE ARCHITECTS ATTENTION, IN WRITING AND IN A TIMELY FASHION, SUCH CONDITION. THE CONTRACTOR SHALL NOT PROCEED WITH RELATED WORK WITHOUT A WRITTEN RESOLUTION CLARIFICATION FROM THE ARCHITECT.

THE CONTRACTOR AND HIS/her SUBCONTRACTORS SHALL BE RESPONSIBLE FOR PROVIDING MATERIALS AND SYSTEMS SHOWN IN THE CONSTRUCTION DOCUMENTS REGARDLESS OF WHERE THE INFORMATION IS LOCATED. WHERE COMPONENTS OF A SYSTEM ARE INDICATED THE CONTRACTOR SHALL BE RESPONSIBLE FOR PROVIDING ALL LABOR AND MATERIALS NECESSARY TO COMPLETE THE SYSTEM.

4: DISCREPANCIES & CLARIFICATIONS:

THIS PROJECT INVOLVES THE FIT UP OF AN EXISTING BUILDING. EXISTING DIMENSIONS SHOWN ON THE DRAWINGS ARE BELIEVED TO BE ACCURATE, BUT CANNOT BE GUARANTEED. MEASURE AND VERIFY DIMENSIONS IN FIELD PRIOR TO FABRICATION AND CONSTRUCTION. IT IS THE RESPONSIBILITY OF THE CONTRACTOR TO BRING TO THE ARCHITECTS ATTENTION, IN WRITING, ANY DISCREPANCIES OR AMBIGUITIES IN THE DRAWINGS AND/OR SPECIFICATIONS. THE CONTRACTOR SHALL NOT PROCEED WITH RELATED WORK WITHOUT A WRITTEN RESOLUTION OR CLARIFICATION FROM THE ARCHITECT.

5: LAYOUT:

UNLESS INDICATED OTHERWISE, CENTER WALL FRAMING AND PARTITION FRAMING ON COLUMN LINES. FLOOR PLAN DIMENSIONS ARE TO CENTER OF FRAMING, FACE OF CONCRETE, FACE OF CMU, OR FROM COLUMN CENTERLINES, UNLESS INDICATED OTHERWISE. DOORS AND WINDOWS ARE DIMENSIONED TO CENTERLINES UNLESS INDICATED OTHERWISE.

6: CENTERING:

UNLESS INDICATED OTHERWISE, CENTER BUILDING ELEMENTS WITHIN OR BETWEEN OTHER BUILDING ELEMENTS WHEN CONDITIONS OR THE DRAWINGS INDICATE OR IMPLY THAT SUCH IS THE INTENT, WHETHER OR NOT DIMENSIONS ARE INCLUDED

7: SYMMETRY:

WHERE CONDITIONS OR THE DRAWINGS INDICATE OR IMPLY THAT SYMMETRY IS INTENDED, INFORMATION PROVIDED AT ONE SIDE APPLIES EQUALLY TO BOTH SIDES, UNLESS CONDITIONS CLEARLY PRECLUDE SUCH APPLICATION.

8: ACCESSIBILITY:

ALL HANDICAPPED ACCESSIBLE BATHROOMS, GRAB BARS, AND DOOR OPENINGS SHALL MEET THE REQUIREMENTS OF TITLE 04-348, CHAPTER 5 OF THE MAINE HUMAN RIGHTS COMMISSION TITLE LATEST EDITION & THE DEPARTMENT OF JUSTICE ADA STANDARDS FOR ACCESSIBLE DESIGN.

9: DRAWING SCALES:

WORK FROM THE GIVEN DIMENSIONS ONLY. SCALE IS INDICATED ON THE DRAWINGS FOR CONVENIENCE ONLY. IT IS NOT INTENDED THAT INFORMATION BE DETERMINED BY SCALING THE DRAWINGS SINCE SOME ITEMS MAY NOT BE TO SCALE.

10: WATER-RESISTANT GWB:

INSTALL WATER-RESISTANT GYPSUM WALL BOARD IN ALL REST ROOMS & TOILET ROOMS OR AT ANY WALL WITH PLUMBING FIXTURES.

10A: HIGH IMPACT GWB:

INSTALL HIGH IMPACT GYPSUM WALL BOARD IN ALL STAIRWELLS

11: INTERIOR ELEVATIONS:

INTERIOR ELEVATIONS MAY BE REVERSED FROM AND/OR SIMILAR TO ACTUAL CONDITIONS. SEE FLOOR PLANS FOR WINDOW AND DOOR QUANTITIES AND LOCATIONS, FOR CASEWORK LAYOUTS, AND FOR MONITOR LOCATIONS.

12: BUILDING INSULATION:

PROVIDE AS INDICATED IN WALL SECTIONS AND IN ACCORDANCE WITH PARTITION TYPES, WHETHER OR NOT SHOWN IN DETAILS AND OTHER DRAWINGS. FOR CLARITY, INSULATION MAY NOT BE SHOWN IN SOME CASES, EVEN IF IT IS TO BE PROVIDED.

13: BLOCKING:

INSTALL BLOCKING BEHIND ALL SURFACE-APPLIED FIXTURES TRIM, CASEWORK, SHELVES, BRACKETS, TOILET ACCESSORIES, CHAIR RAILS, PICTURE RAILS, GRAB BARS, BASE MOLDINGS, AND AS OTHERWISE REQUIRED, WHEN SUCH ITEMS ARE APPLIED ON STUD WALLS.

14: PENETRATIONS AT STRUCTURAL MEMBERS:

BEFORE PENETRATING JOISTS, BEAMS OR OTHER STRUCTURAL MEMBERS, CONSULT WITH THE ARCHITECT.

15: DAMAGED WORK:

BUILDING OR SITE COMPONENTS WHICH ARE AFFECTED BY NEW WORK, DEMOLITION, OR WHICH MAY BE DAMAGED BY THE GENERAL CONTRACTOR OR ANY SUB-CONTRACTOR SHALL BE REPLACED OR RESTORED TO ORIGINAL CONDITION AND COLOR TO MEET THE APPROVAL OF THE ARCHITECT.

16: UTILITIES:

VERIFY THE SIZE AND LOCATION OF ALL UNDERGROUND UTILITIES AND REPORT ANY DISCREPANCIES TO THE ARCHITECT IN WRITING. DO NOT INTERFERE WITH WORK UNTIL THE DISCREPANCY HAS BEEN RESOLVED TO THE SATISFACTION OF THE ARCHITECT.

17: RATED CONSTRUCTION:

PROVIDE RATED CONSTRUCTION AS REQUIRED BY CODE, AS SPECIFIED, AND AS INDICATED ON DRAWINGS. IT IS THE RESPONSIBILITY OF THE CONTRACTOR TO PROVIDE AND INSTALL ALL COMPONENTS REQUIRED TO CREATE SUCH RATED CONSTRUCTION, REGARDLESS OF WHETHER OR NOT SUCH COMPONENTS ARE INDICATED. PROVIDE CONTINUITY OF SUCH RATED CONSTRUCTION AROUND AND BETWEEN SPACES, INCLUDING AT CHASES AND AT FLOORS, TO MAINTAIN COMPLETE SEPARATIONS, EVEN IF NOT SPECIFICALLY INDICATED.

18: SHOP DRAWINGS:

SUBMIT SHOP DRAWINGS TO THE ARCHITECT FOR REVIEW PRIOR TO FABRICATIONS. SUBMITTALS REQUIRED INCLUDE, BUT ARE NOT LIMITED TO, SHOP DRAWINGS FOR ALL PREFABRICATED CONCRETE, STEEL, MILLWORK & SIGNAGE, SAMPLES OF ALL PROPOSED PAINTS, METALS, WALL COVERINGS, LAMINATES, SOLID SURFACE MATERIALS, CERAMIC TILE, AND HARDWARE. SUBMIT MANUFACTURERS' DATA FOR ALL LIGHTING SYSTEMS, AND HARDWARE.

19: PERMITS:

THE GENERAL CONTRACTOR SHALL OBTAIN AND PAY FOR ANY BUILDING PERMITS REQUIRED AND CARRY ANY INSURANCE COVERAGES REQUIRED.

20: INTERIOR FINISHES:

ALL INTERIOR FINISHES AND FURNISHINGS ARE TO BE CLASS 'A' FIRE-RATED AND ARE TO COMPLY WITH SECTION 920.0 BOCA (INTERIOR FLAME SPREAD).

21: ELECTRICAL DESIGN:

REFER TO ELECTRICAL DRAWINGS AND SPECIFICATIONS

22: WASTE REMOVAL:

THE GENERAL CONTRACTOR SHALL DISPOSE OF ALL WASTE AND DEBRIS OFF THE PREMISES.

23: LANDLORD COORDINATION:

THE GENERAL CONTRACTOR MUST COORDINATE WITH THE BUILDING OWNER ALL ACTIVITIES INCLUDING BUT NOT LIMITED TO WORK WHICH WILL GENERATE EXCESSIVE NOISE AND MODIFICATION TO UTILITIES. WORK MUST NOT INTERFERE WITH EXISTING SMOKE DETECTORS, ALARMS OR BUILDING SYSTEM MANAGEMENT.

24: TEMPORARY FACILITIES:

PROVIDE ALL TEMPORARY FACILITIES AND SERVICES, CONSTRUCTION AND SUPPORT FACILITIES, AND SECURITY AND PROTECTION AS NEEDED TO PROTECT NEW AND EXISTING CONSTRUCTION FOR THE DURATION OF A COMPLETE INSTALLATION.

25: FINAL CLEANING:

EMPLOY EXPERIENCED WORKERS FOR FINAL CLEANING. CLEAN EACH SURFACE TO THE CONDITION EXPECTED IN A COMMERCIAL BUILDING CLEANING PROGRAM.

26: MANUFACTURERS INSTRUCTIONS:

ALL MATERIALS & EQUIPMENT SHALL BE INSTALLED ACCORDING TO MANUFACTURER'S SPECIFICATIONS.

27: GUARANTEE:

GUARANTEE: ALL MATERIALS AND WORKMANSHIP SHALL BE GUARANTEED FOR A PERIOD OF ONE YEAR FROM THE DATE OF FINAL ACCEPTANCE UNLESS OTHERWISE SPECIFIED FOR A LONGER PERIOD OF TIME ON A CERTAIN ITEM.

28: ASBESTOS:

ALL MATERIAL USED FOR THE CONSTRUCTION OF THIS PROJECT, WHETHER BUILDING MATERIALS OR APPURTENANCES, SHALL BE NON-ASBESTOS CONTAINING MATERIAL.

29: HAZARDOUS FUMES:

THE GENERAL CONTRACTOR SHALL CONFIRM THAT ALL MATERIAL AND FINISHES SPECIFIED AND THEIR FABRICATION OR INSTALLATION WILL NOT RELEASE FUMES OR AROMAS DURING CONSTRUCTION WHICH MAY BE A HAZARD OR NUISANCE TO PERSONNEL.

30: PEST CONTROL:

SEAL AND CAULK AROUND ALL PENETRATIONS, CRACKS AND CREVICES AND ANY OPENINGS CAPABLE OF HARBORING INSECTS/RODENTS.

31: EXPOSED UTILITIES:

ALL EXPOSED UTILITY WIRES AND PIPES (ELECTRICAL, PLUMBING, ETC.) SHALL BE INSTALLED IN A WAY THAT DOES NOT OBSTRUCT OR PREVENT THE CLEANING OF FLOORS, WALLS, AND CEILING AREAS. THEY SHALL BE INSTALLED A MINIMUM OF 6" OFF FLOORS AND 1" OFF WALLS, CEILINGS AND ADJACENT PIPES.

32. OWNER SUPPLIED EQUIPMENT:

EQUIPMENT SUPPLIED BY THE OWNER AND INSTALLED BY THE GENERAL CONTRACTOR. EQUIPMENT INFORMATION AND SPECIFICATIONS ARE TO BE THE MOST CURRENT AVAILABLE AT THE TIME OF DOCUMENTATION PREPARATION. THE GENERAL CONTRACTOR SHALL BE RESPONSIBLE FOR VERIFYING WITH THE OWNER THE EXACT DIMENSIONS AND EQUIPMENT CONNECTION REQUIREMENTS (INCLUDING ELECTRICAL CIRCUIT REQUIREMENTS) OF EQUIPMENT TO BE SUPPLIED. THE GENERAL CONTRACTOR SHALL MAKE ALL FINAL CONNECTIONS AS NOTED ON THE DRAWINGS. INSTALL THE SET UP IN WORKING ORDER, CHECK WARRANTIES, TEST AND NOT VOID WARRANTIES. THE GENERAL CONTRACTOR SHALL COORDINATE WITH THE OWNER DELIVERY, STORAGE AND INSTALLATION OF ALL OWNER SUPPLIED EQUIPMENT. THE GENERAL CONTRACTOR SHALL STORE EQUIPMENT IF REQUESTED BY THE OWNER UNTIL INSTALLATION. SEE DRAWINGS FOR OTHER OWNER SUPPLIED/GENERAL CONTRACTOR INSTALLED ITEMS.

33: FIRE PROTECTION NOTE:

EXISTING SPRINKLERHEADS, ALARM SYSTEM AND DETECTORS ARE TO BE MODIFIED TO CONFORM WITH THE PROPOSED PLAN. COORDINATE WITH THE ARCHITECT. ANY MODIFICATION OR LOCATIONS WHERE EXISTING SYSTEMS ARE AFFECTED BY THE NEW DESIGN.

34: SOILS AT FOOTINGS:

REPORT THE LOCATION OF ALL UNSUITABLE SOILS AND MATERIALS BELOW ANTICIPATED LEVEL OF FOOTING TO THE ARCHITECT PRIOR TO THE SETTING OF FORMS.

35: ACCESS PANELS:

CONTRACTOR IS RESPONSIBLE FOR COORDINATING QUANTITY AND LOCATION OF ALL REQUIRED ACCESS PANELS FOR ALL MEP CONTROLS, CLEANOUTS, DAMPERS, PULL BOXES, ETC.

36: EXISTING HAZARDOUS MATERIALS

ALL HAZARDOUS MATERIALS INCLUDING BUT NOT LIMITED TO ASBESTOS AND LEAD PAINT ARE TO BE HANDLED, ENCAPSULATED, ABATED AND DISPOSED OF IN ACCORDANCE WITH ANY AND ALL FEDERAL, STATE AND LOCAL REQUIREMENTS AND REGULATIONS.

37: INDUSTRY STANDARDS:

ALL WORK SHALL BE PERFORMED IN ACCORDANCE WITH INDUSTRY STANDARDS. STANDARDS INCLUDE BUT ARE NOT LIMITED TO THE FOLLOWING:

- AAMA AMERICAN ARCHITECTURAL MANUFACTURERS ASSOCIATION
- ACI AMERICAN CONCRETE INSTITUTE
- ANSI AMERICAN NATIONAL STANDARDS INSTITUTE
- ASTM AMERICAN SOCIETY FOR TESTS AND MATERIALS
- AWI ARCHITECTURAL WOODWORK INSTITUTE
- "CUSTOM GRADE"
- AWS AMERICAN WELDING SOCIETY
- IGMA INSULATING GLASS MANUFACTURERS ALLIANCE
- NAAMM NATIONAL ASSOCIATION OF ARCHITECTURAL METAL MANUFACTURERS
- NRCA NATIONAL ROOFING CONTRACTORS ASSOCIATION
- NTCA NATIONAL TILE CONTRACTORS ASSOCIATION
- SMACNA SHEET METAL AND AIR CONDITIONING NATIONAL ASSOCIATION
- WDMA WINDOW AND DOOR MANUFACTURERS ASSOCIATION

ABBREVIATIONS

A	AC AIR CONDITIONING	L	LAB LABORATORY
AD ACT	AD ACUSTICAL CEILING TILE	LAM LAMINATED	
ADAAG AREA DRAIN	AD AMERICANS WITH DISABILITIES ACT	LB POUND	
ADD ACCESSIBILITY'S GUIDELINES	AD ADDITIONAL	LH LEFT-HAND	
AFF ABOVE FINISHED FLOOR	AD ABOVE FINISHED FLOOR	LCC LEAD COATED COPPER	
AHU AIR HANDLING UNIT	AD ARCHITECT/ARCHITECTURAL	M	MACH MACHINERY
AL ALUMINUM	AD ACUSTIC WALL PANEL	MAS MASONRY	
ARCH ARCHITECT/ARCHITECTURAL	AD ACUSTIC WALL PANEL	MAT MATERIAL	
AWP ABOVE FINISHED FLOOR	AD ACUSTIC WALL PANEL	MAX MAXIMUM	
B	B.B.G.C. BASE BUILDING GENERAL CONTRACTOR	MDO MEDIUM-DENSITY OVERLAY	
BL BUILDING LINE	AD ACUSTIC WALL PANEL	MECH MECHANICAL	
BLDG BUILDING	AD ACUSTIC WALL PANEL	MEMB MEMBRANE	
BLDG BLOCKING	AD ACUSTIC WALL PANEL	MEZ MEZZANINE	
BSMT BASEMENT	AD ACUSTIC WALL PANEL	MFR MANUFACTURER	
BETW BETWEEN	AD ACUSTIC WALL PANEL	MISC MISCELLANEOUS	
BO BY OTHERS	AD ACUSTIC WALL PANEL	MO MOUNTED	
C	COURSE (MASONRY)	MTL METAL	
CER CERAMIC	AD ACUSTIC WALL PANEL	MB MARKER BOARD	
CG CORNER GUARD	AD ACUSTIC WALL PANEL	N	NORTH
CH CONTROL JOINT	AD ACUSTIC WALL PANEL	N NUMBER	
CJ CENTER LINE	AD ACUSTIC WALL PANEL	NIC NOT IN CONTACT	
CLG CEILING	AD ACUSTIC WALL PANEL	NOM NOMINAL DIMENSION	
CMU CONCRETE MASONRY UNIT	AD ACUSTIC WALL PANEL	NTS NOT TO SCALE	
CO CLEAN OUT	AD ACUSTIC WALL PANEL	O	ON/OVER
COL COLUMN	AD ACUSTIC WALL PANEL	OD ON CENTER	
COND CONCRETE CONDITION	AD ACUSTIC WALL PANEL	OD OUTSIDE DIAMETER/OUTSIDE DIMENSION	
CONN CONNECTION	AD ACUSTIC WALL PANEL	OFF OFFICE	
CONST CONSTRUCTION	AD ACUSTIC WALL PANEL	OPEN OPENING	
CONT CONTINUOUS	AD ACUSTIC WALL PANEL	OPP OPPOSITE	
CORR CORROSION	AD ACUSTIC WALL PANEL	OSB ORIENTED STRAND BOARD	
CT CERAMIC TILE	AD ACUSTIC WALL PANEL	OZ OUNCE	
CUH CABINET UNIT HEATER	AD ACUSTIC WALL PANEL	P	PURCHASED BY OWNER INSTALLED BY CONTRACTOR
D	DBL DOUBLE	PBOIBC PURCHASED BY OWNER INSTALLED BY CONTRACTOR	
DIA DIAMETER	AD ACUSTIC WALL PANEL	PRECAST PRECAST	
DIFF DIFFUSER	AD ACUSTIC WALL PANEL	PL PLASTIC LAMINATE	
DN DOWN	AD ACUSTIC WALL PANEL	PAIR PAIR	
DRY DRY	AD ACUSTIC WALL PANEL	PRE FAB PREFABRICATE	
DSP DRY STAND PIPE	AD ACUSTIC WALL PANEL	PRIV PRIVACY	
DWG DRAWING	AD ACUSTIC WALL PANEL	PRIM PRIMED	
E	EAST	PSF POUNDS PER SQUARE FOOT	
EA EACH	AD ACUSTIC WALL PANEL	PSI POUNDS PER SQUARE INCH	
ELEV ELEVATION	AD ACUSTIC WALL PANEL	PTD PAINTED	
ELEC ELECTRICAL	AD ACUSTIC WALL PANEL	PTN PARTITION	
ELEV ELEVATOR	AD ACUSTIC WALL PANEL	PVC POLYVINYL CHLORIDE	
ENTR ENTRANCE	AD ACUSTIC WALL PANEL	PWD PLYWOOD	
EQ EQUAL	AD ACUSTIC WALL PANEL	PT PRESSURE TREATED	
EQUI EQUIPMENT	AD ACUSTIC WALL PANEL	PERF PERFORATED	
EXP EXPANSION	AD ACUSTIC WALL PANEL	Q	QUARRY TILE
EXPB EXPANSION BOLT	AD ACUSTIC WALL PANEL	QTR QUARTER	
EXT EXTERIOR	AD ACUSTIC WALL PANEL	R	RISER/RADIUS
EXTD EXTERIOR DIENE MONOMER	AD ACUSTIC WALL PANEL	RAD RADIUS	
EWC ELECTRIC WATER COOLER	AD ACUSTIC WALL PANEL	RBR RUBBER BASE	
F	FAHRENHEIT	RCP REFLECTED CEILING PLAN	
FB FLAT BAR	AD ACUSTIC WALL PANEL	RDF ROOF DRAIN	
FC FIRE EXTINGUISHER AND CABINET	AD ACUSTIC WALL PANEL	REBAR REINFORCING BAR	
FD FLOOR DRAIN	AD ACUSTIC WALL PANEL	REF REFRIGERATOR	
FE FIRE EXTINGUISHER	AD ACUSTIC WALL PANEL	REINFORCED REINFORCED	
FEC FIRE EXTINGUISHER CABINET	AD ACUSTIC WALL PANEL	REQ REQUIRED	
FTWD FIRE TREATED WOOD	AD ACUSTIC WALL PANEL	RES RESILIENT	
FIN FINISH	AD ACUSTIC WALL PANEL	REV REVERSE	
FOB FACE OF BRICK	AD ACUSTIC WALL PANEL	RM ROOM	
FOC FACE OF CONCRETE	AD ACUSTIC WALL PANEL	RO ROUGH OPENING	
FOF FACE OF FINISH	AD ACUSTIC WALL PANEL	ROW RIGHT OF WAY	
FOS FACE OF STUDS	AD ACUSTIC WALL PANEL	S	SOUTH
FOV FACE OF VENT	AD ACUSTIC WALL PANEL	SCHED SCHEDULE	
FSS FIRE SUPPRESSION SYSTEM	AD ACUSTIC WALL PANEL	SF SQUARE FEET	
FTG FOOTING	AD ACUSTIC WALL PANEL	SIMILAR SIMILAR	
FRG FIBER REINFORCED GYPSUM	AD ACUSTIC WALL PANEL	SPEC SPECIFICATION	
FTR FIBER TREATMENT	AD ACUSTIC WALL PANEL	SQ SQUARE	
FH FUME HOOD	AD ACUSTIC WALL PANEL	SST STAINLESS STEEL	
G	GA GAUGE	STD STANDARD	
GALV GALVANIZED	AD ACUSTIC WALL PANEL	STD STEEL	
GB GRAB BAR	AD ACUSTIC WALL PANEL	STR STRUCTURE/STRUCTURAL	
GENR GENERAL CONTRACTOR	AD ACUSTIC WALL PANEL	SUS SUSPENSION	
GFI GROUND-FAULT INTERRUPTER	AD ACUSTIC WALL PANEL	T	TONGUE&GROOVE
GLAM GLASS/LAZING/GLAZED	AD ACUSTIC WALL PANEL	T&G TONGUE&GROOVE	
GND GROUND	AD ACUSTIC WALL PANEL	THK THICK	
GWB GYPSUM WALL BOARD	AD ACUSTIC WALL BOARD	TOD TOP OF DECK	
H	HOSE BIB	TOS TOP OF STEEL	
HC HANGING CABINET	AD ACUSTIC WALL PANEL	TV TYPICAL	
HM HOLLOW METAL	AD ACUSTIC WALL PANEL	TV TELEVISION	
HORIZ HORIZONTAL	AD ACUSTIC WALL PANEL	TB TACK BOARD	
HP HORSE POWER/HIGH POINT/HEAT PUMP	AD ACUSTIC WALL PANEL	TCC TOP OF CONCRETE	
HR HOUR	AD ACUSTIC WALL PANEL	U	UNDERWRITERS LABORATORIES, INC.
HW HOT WATER	AD ACUSTIC WALL PANEL	UL UNDERWRITERS LABORATORIES, INC.	
HVAC HEATING VENTILATION AIR CONDITIONING	AD ACUSTIC WALL PANEL	UV UNIT VENTILATION	
I	INSIDE DIMENSION/INSIDE DIAMETER	V VCT VINYL COMPOSITION TILE	
ID INCHES	AD ACUSTIC WALL PANEL	VERT VERTICAL	
INFO INFORMATION	AD ACUSTIC WALL PANEL	VIF VERIFY IN FIELD	
INSUL INSULATION	AD ACUSTIC WALL PANEL	VOL VOLUME	
J	JST JOIST	W	WEST
JT JOINT	AD ACUSTIC WALL PANEL	W/O WITHOUT	
K	KILN-DRIED	W/ WITH	
KIP 1000 POUNDS	AD ACUSTIC WALL PANEL	WF WOOD	
		WF WIDE FLANGE	
		WP WORK POINT	
		WT WEIGHT	

FIRESTOPPING DETAILS

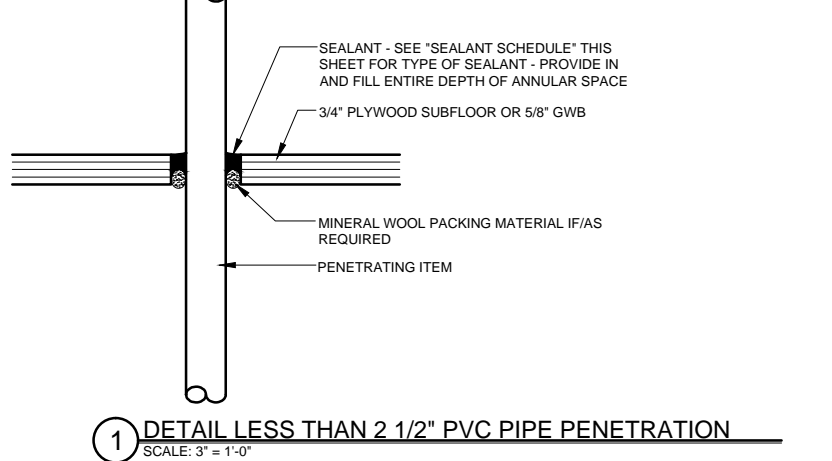
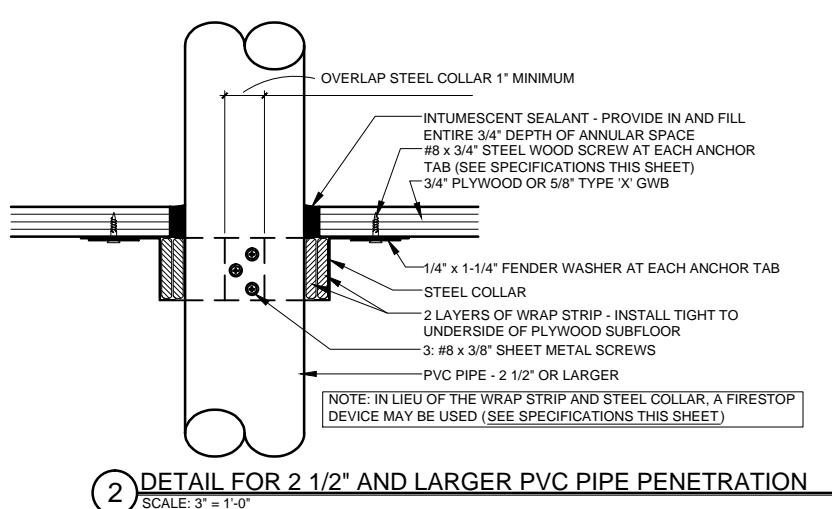

SPECIFICATIONS

WRAP STRIP: 1/4" THICK x 1 1/2" MINIMUM WIDTH INTUMESCENT MATERIAL WITH PLASTIC FILM FACING BOTH SIDES. TEMPORARILY SECURE WITH MASKING TAPE. SPECIFIED TECHNOLOGIES INC. (STI) "SpecSeal RED Wrap Strip" OR "SpecSeal BLU Wrap Strip" OR EQUAL.

STEEL COLLAR: WRAP STRIP MANUFACTURER'S STEEL COLLAR, FABRICATED FROM .016 INCH THICK GALVANIZED SHEET STEEL, WIDTH TO MATCH WRAP STRIP (1 1/2" MINIMUM), WITH 1 INCH x 2 INCH ANCHOR TABS AND RETAINER TABS. ANCHOR TABS TO BE SYMMETRICALLY OPPOSED AROUND COLLAR. PROVIDE 3 TABS FOR 2 1/2" AND 3" PIPE, PROVIDE 4 TABS FOR 4" PIPE.

INTUMESCENT SEALANT: ONE-PART, INTUMESCENT, LATEX ELASTOMER TESTED TO ASTM E 814. MINIMUM EXPANSION OF 3x AT 1000°F. 3M "FIRE BARRIER SEALANT CP 25WB" OR EQUAL.

FIRESTOP SEALANT: SINGLE COMPONENT NONCOMBUSTIBLE FIRE RATED SEALANT TESTED TO ASTM E 814. TESTED TO 3000°F. "BOSS 136 FIRESTOP/DRAFT SEALANT" MANUFACTURED BY ACCUMETRIC, LLC, OR EQUAL.

SEALANT SCHEDULE:

INTUMESCENT SEALANT: PROVIDE AT ALL PENETRATIONS THROUGH RATED CONSTRUCTION FOR PENETRATING ITEMS INCLUDING BUT NOT LIMITED TO: PVC PIPE; ROOF LEADER PIPES, GAS PIPES & LINES; SPRINKLER PIPES; ELECTRICAL & COMMUNICATIONS CABLES & WIRES; AND ALARM SYSTEM WIRES. DO NOT USE INTUMESCENT SEALANT AT DOMESTIC HOT WATER OR HYDRONIC HEATING SYSTEM PIPES.

FIRESTOP SEALANT: PROVIDE AT ALL PENETRATIONS THROUGH RATED CONSTRUCTION FOR PENETRATING ITEMS INCLUDING DOMESTIC HOT AND COLD WATER PIPES AND HYDRONIC HEATING SYSTEM PIPES.

NOTE:

FOR LOCATIONS OF RATED CONSTRUCTION, SEE ARCHITECTURAL FLOOR PLANS AND SECTIONS

WALL TYPE NOTES

- FIRE RATED WALLS TO EXTEND UP TO DECKING ABOVE THROUGH THE FLOOR / CEILING ASSEMBLY. AT FLUTED DECKING DRYWALL TO BE CUT TO AND EXTEND UP TO PROFILE OF DECK FLOOR WITH ALLOWANCE FOR DEFLECTION JOINT
- INSTALL WATER RESISTANT GYPSUM WALLBOARD IN ALL RESTROOMS AND TOILET ROOM WALLS AND CEILINGS, AND AT ANY WALL WITH PLUMBING FIXTURES
- WHEN TWO ADJACENT WALL TYPES HAVE DIFFERING NUMBERS OF LAYERS OF GWB, THE FINISHED FACE OF GWB MUST FORM ONE CONTINUOUS PLANE, ADJUST STUD PLANE LOCATION AS REQUIRED TO ACHIEVE THE CONTINUOUS PLANE
- HOLD BOTTOM OF GWB UP 1/2" FROM CONCRETE. PROVIDE SEALANT AT JOINT.
- ALL WALL TYPES WITH AN INSULATION COMPONENT TO BE ACOUSTICALLY SEALED
- PROVIDE ACOUSTICAL SEALANT AROUND ALL PENETRATING ELEMENTS IN WALLS AND CEILINGS (ELECTRICAL BOXES, DUCTS, PIPES, ETC)
- ALL NEW WALLS TO EXTEND TO DECK ABOVE WITH HEAD DEFLECTION SLIP TRACK (PROVIDE ACOUSTICAL SEALANT)

GRAPHIC DEPICTION		DESCRIPTION	
		<ul style="list-style-type: none"> - LAYER OF 5/8" GWB - RESILIENT CHANNEL - 3/8" MTL STUDS AT 16" O.C. - 3/2" SOUND BATT INSULATION - RESILIENT CHANNEL - LAYER OF 5/8" GWB 	
TYPE	FIRE RATING	UL NUMBER	STC RATING
NA	N/A	N/A	N/A

GRAPHIC DEPICTION		DESCRIPTION	
		<ul style="list-style-type: none"> - EXISTING GWB - EXISTING STUDS - 3/2" SOUND BATT INSULATION - RESILIENT CHANNEL - NEW LAYER OF 5/8" GWB 	
TYPE	FIRE RATING	UL NUMBER	STC RATING
EX	N/A	N/A	N/A

GRAPHIC DEPICTION		DESCRIPTION	
		<ul style="list-style-type: none"> - LAYER OF 5/8" TYPE	