

City of Portland, Maine - Building or Use Permit Application

389 Congress Street, 04101 Tel: (207) 874-8703, Fax: (207) 874-8716

Permit No: 08-1036	Issue Date: 8/20/08	CBL: 115 C012001
-----------------------	------------------------	---------------------

Location of Construction: 7 WASHBURN AVE	Owner Name: ROBB DEBORAH & BARRY MO	Owner Address: 7 WASHBURN AVE	Phone:
Business Name:	Contractor Name: Down East Energy	Contractor Address: 172 Main Street South Portland	Phone 2077995585
Lessee/Buyer's Name	Phone:	Permit Type: Tanks - Dwellings	Zone:

Past Use: Single Family Home	Proposed Use: Single Family Home - install (1) 57 gallon propane tank	Permit Fee: \$30.00	Cost of Work: \$30.00	CEO District: 2
Proposed Project Description: install (1) 57 gallon propane tank		FIRE DEPT: <input type="checkbox"/> Approved <input type="checkbox"/> Denied	INSPECTION: Use Group: R-3 Type: SB IMC 2003 NFPA-211 Signature: <i>CLW</i> 8/20/08	
		PEDESTRIAN ACTIVITIES DISTRICT (P.A.D.) Action: <input type="checkbox"/> Approved <input type="checkbox"/> Approved w/Conditions <input type="checkbox"/> Denied Signature: _____ Date: _____		

Permit Taken By: Idobson	Date Applied For: 08/20/2008	Zoning Approval
-----------------------------	---------------------------------	------------------------

- This permit application does not preclude the Applicant(s) from meeting applicable State and Federal Rules.
- Building permits do not include plumbing, septic or electrical work.
- Building permits are void if work is not started within six (6) months of the date of issuance. False information may invalidate a building permit and stop all work..

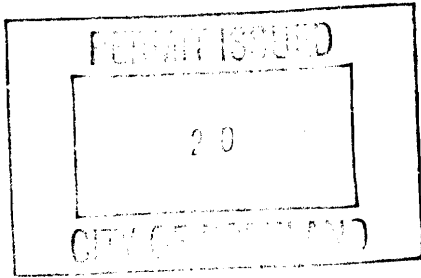

Special Zone or Reviews <input type="checkbox"/> Shoreland <input type="checkbox"/> Wetland <input type="checkbox"/> Flood Zone <input type="checkbox"/> Subdivision <input type="checkbox"/> Site Plan <i>OK</i> Maj <input type="checkbox"/> Minor <input type="checkbox"/> MM <input type="checkbox"/> Date: <i>8/20/08</i> <i>CLW</i>	Zoning Appeal <input type="checkbox"/> Variance <input type="checkbox"/> Miscellaneous <input type="checkbox"/> Conditional Use <input type="checkbox"/> Interpretation <input type="checkbox"/> Approved <input type="checkbox"/> Denied Date: _____	Historic Preservation <input checked="" type="checkbox"/> Not in District or Landmark <input type="checkbox"/> Does Not Require Review <input type="checkbox"/> Requires Review <input type="checkbox"/> Approved <input type="checkbox"/> Approved w/Conditions <input type="checkbox"/> Denied Date: <i>8/20/08</i> <i>CLW</i>
---	---	--

CERTIFICATION

I hereby certify that I am the owner of record of the named property, or that the proposed work is authorized by the owner of record and that I have been authorized by the owner to make this application as his authorized agent and I agree to conform to all applicable laws of this jurisdiction. In addition, if a permit for work described in the application is issued, I certify that the code official's authorized representative shall have the authority to enter all areas covered by such permit at any reasonable hour to enforce the provision of the code(s) applicable to such permit.

SIGNATURE OF APPLICANT	ADDRESS	DATE	PHONE
RESPONSIBLE PERSON IN CHARGE OF WORK, TITLE		DATE	PHONE



FILL IN AND SIGN WITH INK

APPLICATION FOR PERMIT HEATING OR POWER EQUIPMENT

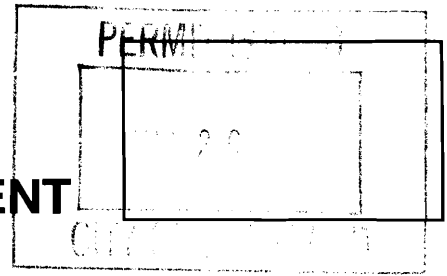

To the INSPECTOR OF BUILDINGS, PORTLAND, ME.

The undersigned hereby applies for a permit to install the following heating, cooking or power equipment in accordance with the Laws of Maine, the Building Code of the City of Portland, and the following specifications:

Location / CBL _____ Use of Building Private Date 8/20/08
 Name and address of owner of appliance Debra Rebb 7 Washburn Ave
 Installer's name and address Debra Rebb Energy 173 Main St Telephone 799-5585
South Portland

Location of appliance:

- Basement
- Attic
- Floor
- Roof

Type of Fuel:

- Gas
- Oil
- Solid

Appliance Name:

U.L. Approved Yes No

Will appliance be installed in accordance with the manufacture's installation instructions? Yes No

IF NO Explain: _____

The Type of License of Installer:

- Master Plumber # _____
- Solid Fuel # _____
- Oil # _____
- Gas # PNT 1445
- Other _____

Type of Chimney:

- Masonry Lined
Factory built _____
- Metal
Factory Built U.L. Listing # _____
- Direct Vent
Type _____ UL# _____

Type of Fuel Tank

- Oil
- Gas Propane

Size of Tank 57

Number of Tanks 1

Distance from Tank to Center of Flame _____ feet.

Cost of Work: \$ _____

Permit Fee: \$ 30

Approved

Fire: _____
 Ele.: _____
 Bldg.: _____

Approved with Conditions

- See attached letter or requirement

Chris M
 Inspector's Signature

8/20/08
 Date Approved

Signature of Installer Debra Rebb

City of Portland, Maine - Building or Use Permit

389 Congress Street, 04101 Tel: (207) 874-8703, Fax: (207) 874-8716

Permit No: 08-1036	Date Applied For: 08/20/2008	CBL: 115 C012001
------------------------------	--	----------------------------

Location of Construction: 7 WASHBURN AVE	Owner Name: ROBB DEBORAH & BARRY MO	Owner Address: 7 WASHBURN AVE	Phone:
Business Name:	Contractor Name: Down East Energy	Contractor Address: 172 Main Street South Portland	Phone (207) 799-5585
Lessee/Buyer's Name	Phone:	Permit Type: Tanks - Dwellings	

Proposed Use: Single Family Home - install (1) 57 gallon propane tank	Proposed Project Description: install (1) 57 gallon propane tank
---	--

Dept: Zoning	Status: Approved	Reviewer: Chris Hanson	Approval Date: 08/20/2008	Ok to Issue: <input checked="" type="checkbox"/>
Note:				
Dept: Building	Status: Approved with Conditions	Reviewer: Chris Hanson	Approval Date: 08/20/2008	Ok to Issue: <input checked="" type="checkbox"/>
Note:				
1) The appliance shall be installed in accordance with the IMC 2003 and NFPA 211				
2) Prior to installing the solid fuel appliance, the product information which includes the UL listing shall be submitted. The heating unit shall be installed per the Listing, NFPA 211, IMC 2003 and the manufacturers instructions.				
3) The installation must comply with the State of Maine Gas Regulations.				

DAY OF INSTALL
DATE
TIME

330620

APPOINTMENT		
DATE	8/29/08	TIME 9:00
SALES REP	<i>[Signature]</i>	

PROPANE INSTALLATION FORM

NAME:	DEBRA ROBB	ACCOUNT#	
ADDRESS:	7 WASHBURN AVE	PHONE#	
DIRECTIONS:	PORTLAND, ME		
272-3196		OIL CUSTOMER?	
QUOTE: (Y/N)		LABOR:	
		PART:	

JOB DESCRIPTION

WORKORDER#(S) _____ TICKETS _____

TANK SIZE	57		TRENCH REQ			TRENCH DUG BY			
HOT WORK	INST	HOOK	UNIT:	Cookstove			SHOP CUST	REQUIRE CONVERSION	
WALK SAFE	INSTALL LOCATION		KITCH	LVRM	BDRM	BATH	GAR	BASE	OTHER
**UNSAFE COND.	ASBESTOS	CONFINED	WATER	ANIMALS	ELECTRIC WIRES	OTHER *			
ELECTRIC GRD.	DESCRIPTION: <i>Cookstove</i> <i>Term Air BRD STYLE</i>								
CRAWL SPACE*									
LADDER WRK*									
REMOVAL REQUIRED	TOTAL BTU LOAD			FURTHEST APPLIANCE			20'		
PIPE SIZE	3/8	1/2	5/8	1/2BI	3/4BI	1BI	TRAC	PLASTIC	
VENTING REQUIRED	X			NOTES: ** (SIDING/TILE/ETC)					
PARTS/EQUIPMENT:				DISCUSSED W/ CUST:					
Run line into BSM + and up				SPECIAL TOOLS:					
				#TECHS					

Washburn

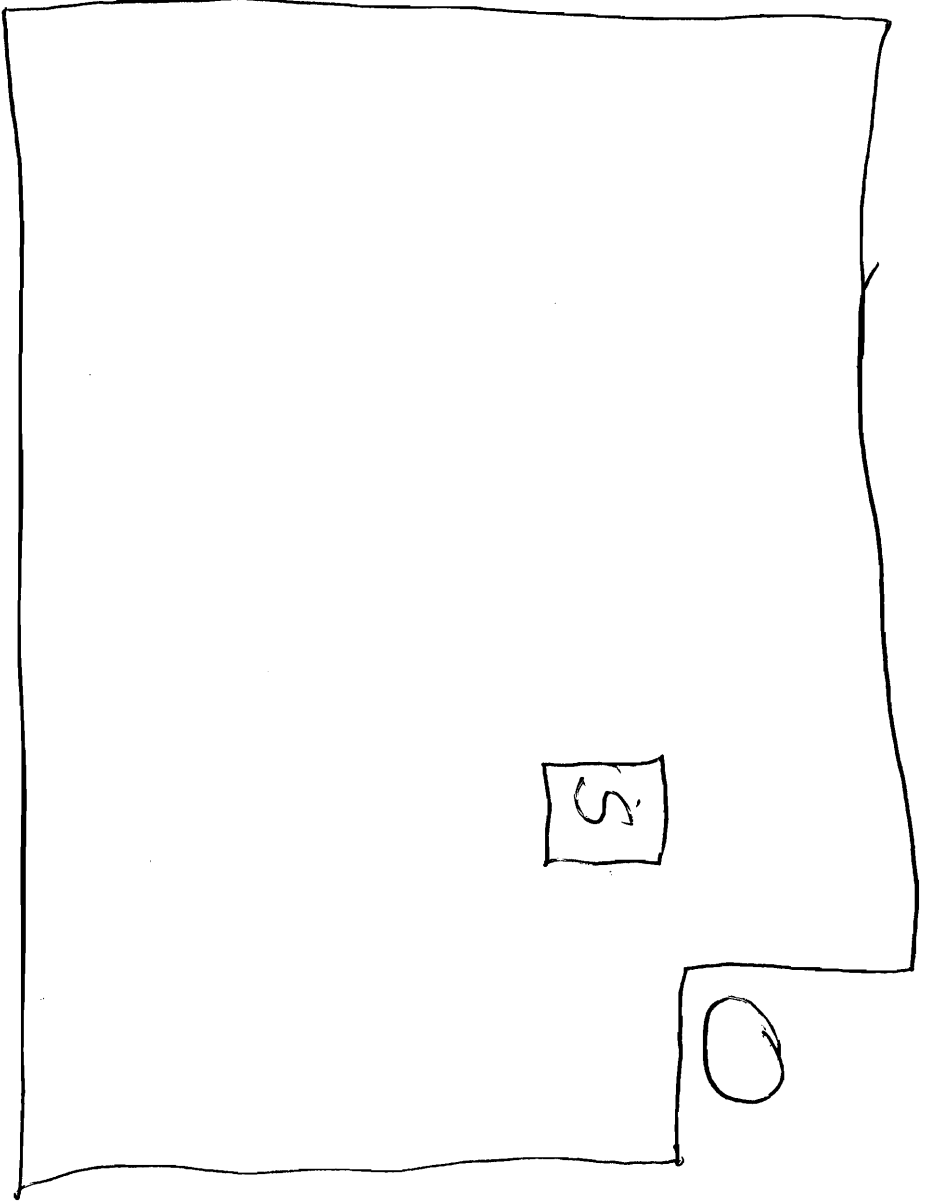

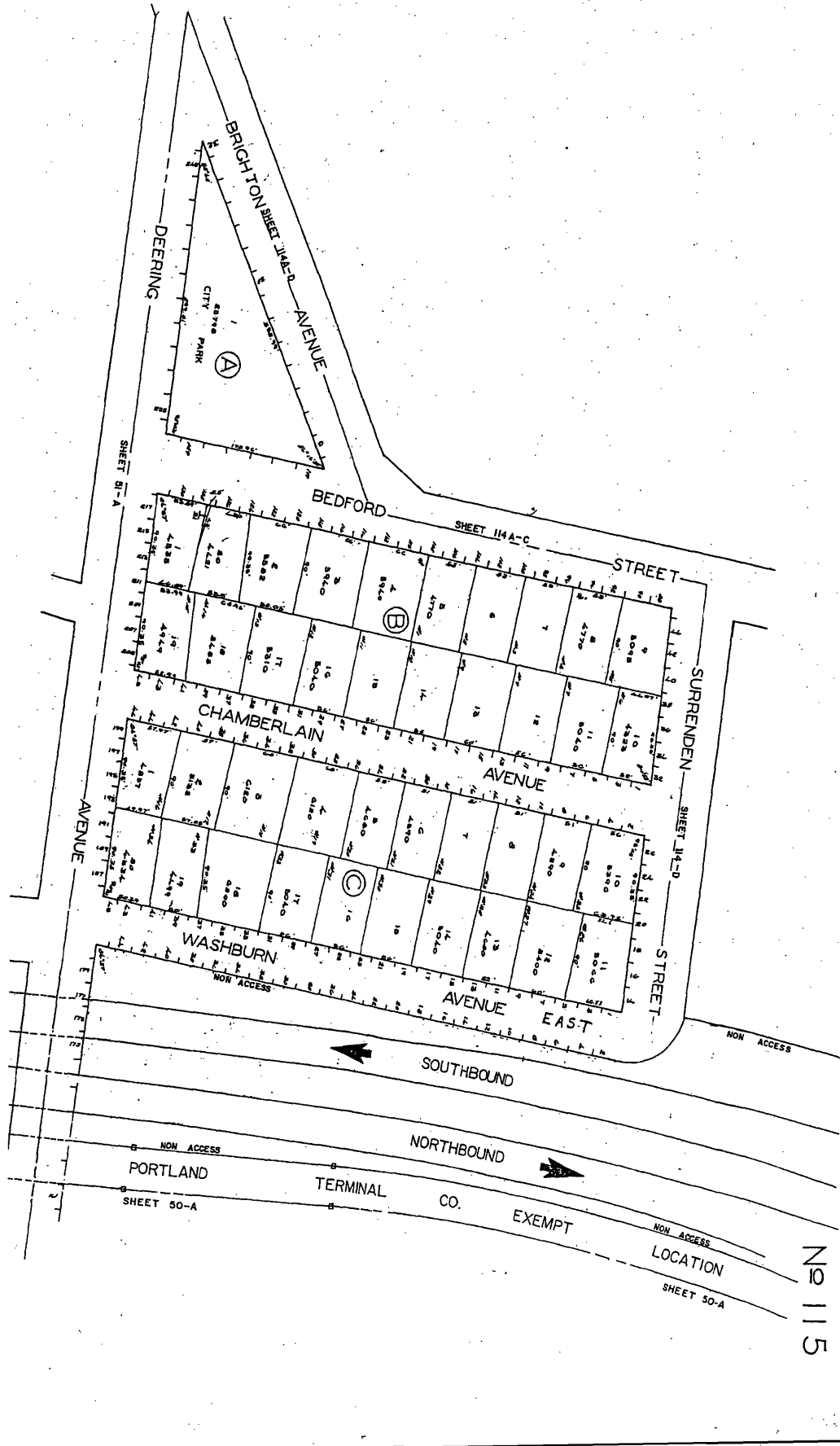

N 10 115