

DISPLAY THIS CARD ON PRINCIPAL FRONTAGE OF WORK



CITY OF PORTLAND BUILDING PERMIT

This is to certify that UNIVERSITY OF MAINE

Located At 23 BEDFORD

Job ID: 2011-02-433-ALT/COMM

CBL: 114 - A - G - 009 - 001 - - - -

has permission to interior Demo and rebuild demising wall

provided that the person or persons, firm or corporation accepting this permit shall comply with all of the provisions of the Statutes of Maine and of the Ordinances of the City of Portland regulating the construction, maintenance and use of the buildings and structures, and of the application on file in the department.

Notification of inspection and written permission procured before this building or part thereof is lathed or otherwise closed in. 48 HOUR NOTICE IS REQUIRED.

A final inspection must be completed by owner before this building or part thereof is occupied. If a certificate of occupancy is required, it must be

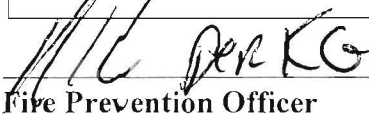
Fire Prevention Officer

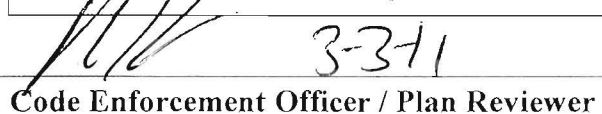
 3-311
Code Enforcement Officer / Plan Reviewer

THIS CARD MUST BE POSTED ON THE STREET SIDE OF THE PROPERTY.

PENALTY FOR REMOVING THIS CAR

BUILDING PERMIT INSPECTION PROCEDURES

Please call 874-8703 or 874-8693 (ONLY)

or email: buildinginspections@portlandmaine.gov

With the issuance of this permit, the owner, builder or their designee is required to provide adequate notice to the city of Portland Inspections Services for the following inspections. Appointments must be requested 48 to 72 hours in advance of the required inspection. The inspection date will need to be confirmed by this office.

- **Please read the conditions of approval that is attached to this permit!! Contact this office if you have any questions.**
- **Permits expire in 6 months. If the project is not started or ceases for 6 months.**
- **If the inspection requirements are not followed as stated below additional fees may be incurred due to the issuance of a "Stop Work Order" and subsequent release to continue.**

1. Close in Inspection before insulation and sheetrock
2. Final - Commercial

The project cannot move to the next phase prior to the required inspection and approval to continue, REGARDLESS OF THE NOTICE OF CIRCUMSTANCES.

IF THE PERMIT REQUIRES A CERTIFICATE OF OCCUPANCY, IT MUST BE PAID FOR AND ISSUED TO THE OWNER OR DESIGNEE BEFORE THE SPACE MAY BE OCCUPIED.



PORTLAND MAINE

Strengthening a Remarkable City, Building a Community for Life • www.portlandmaine.gov

Director of Planning and Urban Development
Penny St. Louis

Conditions of Approval:

Fire

1. All construction shall comply with City Code Chapter 10.
2. This permit is being approved on the basis of the plans submitted. Any deviation from the plans would require amendments and approval.
3. No means of egress shall be affected by this renovation.

Building

1. Application approval based upon information provided by applicant. Any deviation from approved plans requires separate review and approval prior to work.
2. By no means shall any egress exits be blocked during construction.
3. Separate permits are required for any electrical, plumbing, sprinkler, fire alarm, HVAC systems, heating appliances, including pellet/wood stoves, commercial hood exhaust systems and fuel tanks. Separate plans may need to be submitted for approval as a part of this process.

City of Portland, Maine - Building or Use Permit Application

389 Congress Street, 04101 Tel: (207) 874-8703, FAX: (207) 8716

Job No: 2011-02-433-ALTCOMM	Date Applied: 2/16/2011	CBL: 114 - A - G - 009 - 001 - - - - -	
Location of Construction: 23 BEDFORD	Owner Name: OF MAINE UNIVERSITY	Owner Address: 107 MAINE AVE BANGOR, ME - MAINE 04401	Phone:
Business Name: In Facilities Mgmt Bldg	Contractor Name:	Contractor Address:	Phone:
Lessee/Buyer's Name:	Phone:	Permit Type: BLDG - Building	Zone: B-2 & USM Overlay
Past Use: University	Proposed Use: Same: University – Interior work – 56 linear feet of wall	Cost of Work: 9000.00	CEO District:
		Fire Dept: <input checked="" type="checkbox"/> Approved <i>w/conditions</i> <input type="checkbox"/> Denied <input type="checkbox"/> N/A	Inspection: Use Group: Type:
		Signature: <i>Capt. R. Soutreau</i>	Signature:
Proposed Project Description: 25 Bedford St USM – interior alterations		Pedestrian Activities District (P.A.D.)	
Permit Taken By:		Zoning Approval	

1. This permit application does not preclude the Applicant(s) from meeting applicable State and Federal Rules.
2. Building Permits do not include plumbing, septic or electrical work.
3. Building permits are void if work is not started within six (6) months of the date of issuance. False informatin may invalidate a building permit and stop all work.

Special Zone or Reviews	Zoning Appeal	Historic Preservation
<input type="checkbox"/> Shoreland	<input type="checkbox"/> Variance	<input checked="" type="checkbox"/> Not in Dist or Landmark
<input type="checkbox"/> Wetlands	<input type="checkbox"/> Miscellaneous	<input type="checkbox"/> Does not Require Review
<input type="checkbox"/> Flood Zone	<input type="checkbox"/> Conditional Use	<input type="checkbox"/> Requires Review
<input type="checkbox"/> Subdivision	<input type="checkbox"/> Interpretation	<input type="checkbox"/> Approved
<input type="checkbox"/> Site Plan	<input type="checkbox"/> Approved	<input type="checkbox"/> Approved w/Conditions
<input type="checkbox"/> Maj <input type="checkbox"/> Min <input type="checkbox"/> MM	<input type="checkbox"/> Denied	<input type="checkbox"/> Denied
Date: <i>OK - [Signature]</i> 2/16/11	Date:	Date: <i>[Signature]</i>

CERTIFICATION

I hereby certify that I am the owner of record of the named property, or that the proposed work is authorized by the owner of record and that I have been authorized by the owner to make this application as his authorized agent and I agree to conform to all applicable laws of this jurisdiction. In addition, if a permit for work described in the application is issued, I certify that the code official's authorized representative shall have the authority to enter all areas covered by such permit at any reasonable hour to enforce the provision of the code(s) applicable to such permit.

SIGNATURE OF APPLICANT	ADDRESS	DATE	PHONE
RESPONSIBLE PERSON IN CHARGE OF WORK, TITLE		DATE	PHON

Job Summary Report
Job ID: 2011-02-433-ALTCOMM

Report generated on Feb 16, 2011 3:09:18 PM

Page 1

Job Type:	Adds/Alter Remodel Only Non-Res & NonHskp	Job Description:	25 Bedford St USM	Job Year:	2011
Building Job Status Code:	Initiate Plan Review	Pin Value:	669 <i>facilities</i>	Tenant Name:	
Job Application Date:		Public Building Flag:	N <i>incant</i>	Tenant Number:	
Estimated Value:	9,000	Square Footage:			
Related Parties:		OF UNIVERSITY		<i>Property Owner</i>	

Job Charges

Fee Code Description	Charge Amount	Permit Charge Adjustment	Net Charge Amount	Payment Date	Receipt Number	Payment Amount	Payment Adjustment Amount	Net Payment Amount	Outstanding Balance
----------------------	---------------	--------------------------	-------------------	--------------	----------------	----------------	---------------------------	--------------------	---------------------

Location ID: 16058

Location Details

Alternate Id	Parcel Number	Census Tract	GIS X	GIS Y	GIS Z	GIS Reference	Longitude	Latitude
G09170	114 A G 009 001		M				-70.27369	43.662983

Location Type	Subdivision Code	Subdivision Sub Code	Related Persons	Address(es)
1				23 BEDFORD STREET WEST

Location Use Code	Variance Code	Use Zone Code	Fire Zone Code	Inside Outside Code	District Code	General Location Code	Inspection Area Code	Jurisdiction Code
LITERARY & SCIENTIFIC INS		NOT APPLICABLE <i>B-2 & USM over Ag Zone</i>					DISTRCT 4	OAKDALE

Structure Details

Structure: Univ of Maine Office Warehouse

Occupancy Type Code:

Structure Type Code	Structure Status Type	Square Footage	Estimated Value	Address
Office & Professional Buildings	0			23 BEDFORD STREET WEST

Longitude	Latitude	GIS X	GIS Y	GIS Z	GIS Reference
-----------	----------	-------	-------	-------	---------------

User Defined Property	Value
-----------------------	-------

EMS	0
Fixtures-Fluorescent	0
Fixtures-Fluorescent	20
Receptacles	0

Job Summary Report
Job ID: 2011-02-433-ALTCOMM

Report generated on Feb 16, 2011 3:09:18 PM

User Defined Property	Value
Receptacles	20
Receptacles	100
Switches	0
Switches	100

Permit #: 20111317

Permit Data						
Location Id	Structure Description	Permit Status	Permit Description	Issue Date	Reissue Date	Expiration Date
16058	Univ of Maine Office Warehouse	Initialized	interior Demo and rebuild demising wall			

Inspection Details						
Inspection Id	Inspection Type	Inspection Result Status	Inspection Status Date	Scheduled Start Timestamp	Result Status Date	Final Inspection Flag

Fees Details								
Fee Code Description	Charge Amount	Permit Charge Adjustment	Permit Charge Adj Remark	Payment Date	Receipt Number	Payment Amount	Payment Adjustment Amount	Payment Adj Comment
Job Valuation Fees	\$110.00							

Permit #: 20111318

Permit Data						
Location Id	Structure Description	Permit Status	Permit Description	Issue Date	Reissue Date	Expiration Date
16058	Univ of Maine Office Warehouse	Initialized	USM			

Inspection Details						
Inspection Id	Inspection Type	Inspection Result Status	Inspection Status Date	Scheduled Start Timestamp	Result Status Date	Final Inspection Flag

Fees Details								
Fee Code Description	Charge Amount	Permit Charge Adjustment	Permit Charge Adj Remark	Payment Date	Receipt Number	Payment Amount	Payment Adjustment Amount	Payment Adj Comment
Electric Commercial Permit Fee	\$55.00							



General Building Permit Application

If you or the property owner owes real estate or personal property taxes or user charges on any property within the City, payment arrangements must be made before permits of any kind are accepted.

Location/Address of Construction: <u>25 BEDFORD ST, PORTLAND, ME</u>		
Total Square Footage of Proposed Structure/Area <u>56 linear feet of wall</u>		Square Footage of Lot
Tax Assessor's Chart, Block & Lot Chart# <u>114</u> Block# <u>AG</u> Lot# <u>9</u>	Applicant must be owner, Lessee or Buyer Name <u>UNIVERSITY of SOUTHERN MAINE</u> Address <u>25 Bedford ST</u> City, State & Zip <u>Portland ME 04104</u>	Telephone: <u>207-780-4742</u> cell <u>207-838-3202</u>
Lessee/DBA (If Applicable)	Owner (if different from Applicant) Name Address City, State & Zip	Cost Of Work: \$ <u>8500^{xx}</u> C of O Fee: \$ <u>75^{xx}</u> Total Fee: \$ <u>150^{xx}</u>
Current legal use (i.e. single family) <u>USM Facilities office + SHOP AREA</u> If vacant, what was the previous use? Proposed Specific use: <u>NO CHANGE</u> Is property part of a subdivision? <u>NA</u> If yes, please name <u>NA</u> Project description: <u>Demo and rebuild demising wall within existing Facilities Management work area, to include new electrical, metal studs and new vinyl/plaster ceiling</u>		
Contractor's name: <u>In-house Licensed Staff</u> Address: <u>same as above</u> City, State & Zip _____ Telephone: _____ Who should we contact when the permit is ready: <u>Nancy Theriault</u> Telephone: <u>cell 207-415-3113</u> Mailing address: <u>same as above</u> office <u>207-780-4177</u>		

Please submit all of the information outlined on the applicable Checklist. Failure to do so will result in the automatic denial of your permit.

In order to be sure the City fully understands the full scope of the project, the Planning and Development Department may request additional information prior to the issuance of a permit. For further information or to download copies of this form and other applications visit the Inspections Division on line at www.portlandmaine.gov, or stop by the Inspections Division office, room 315 City Hall or call 874-8703.

I hereby certify that I am the Owner of record of the named property, or that the owner of record authorizes the proposed work and that I have been authorized by the owner to make this application as his/her authorized agent. I agree to conform to all applicable laws of this jurisdiction. In addition, if a permit for work described in this application is issued, I certify that the Code Official's authorized representative shall have the authority to enter all areas covered by this permit at any reasonable hour to enforce the provisions of the codes applicable to this permit.

Signature: Nancy Theriault Date: 2-11-2011

This is not a permit; you may not commence ANY work until the permit is issued.

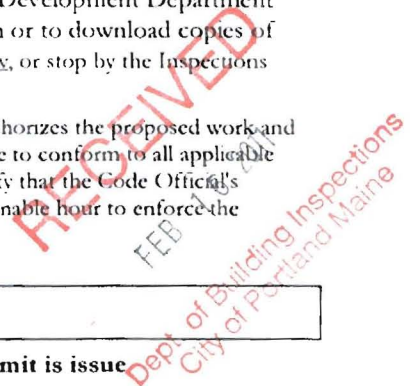

Facilities Management 25 Bedford Street, Portland Campus

Proposed new demising wall, ceiling, electrical

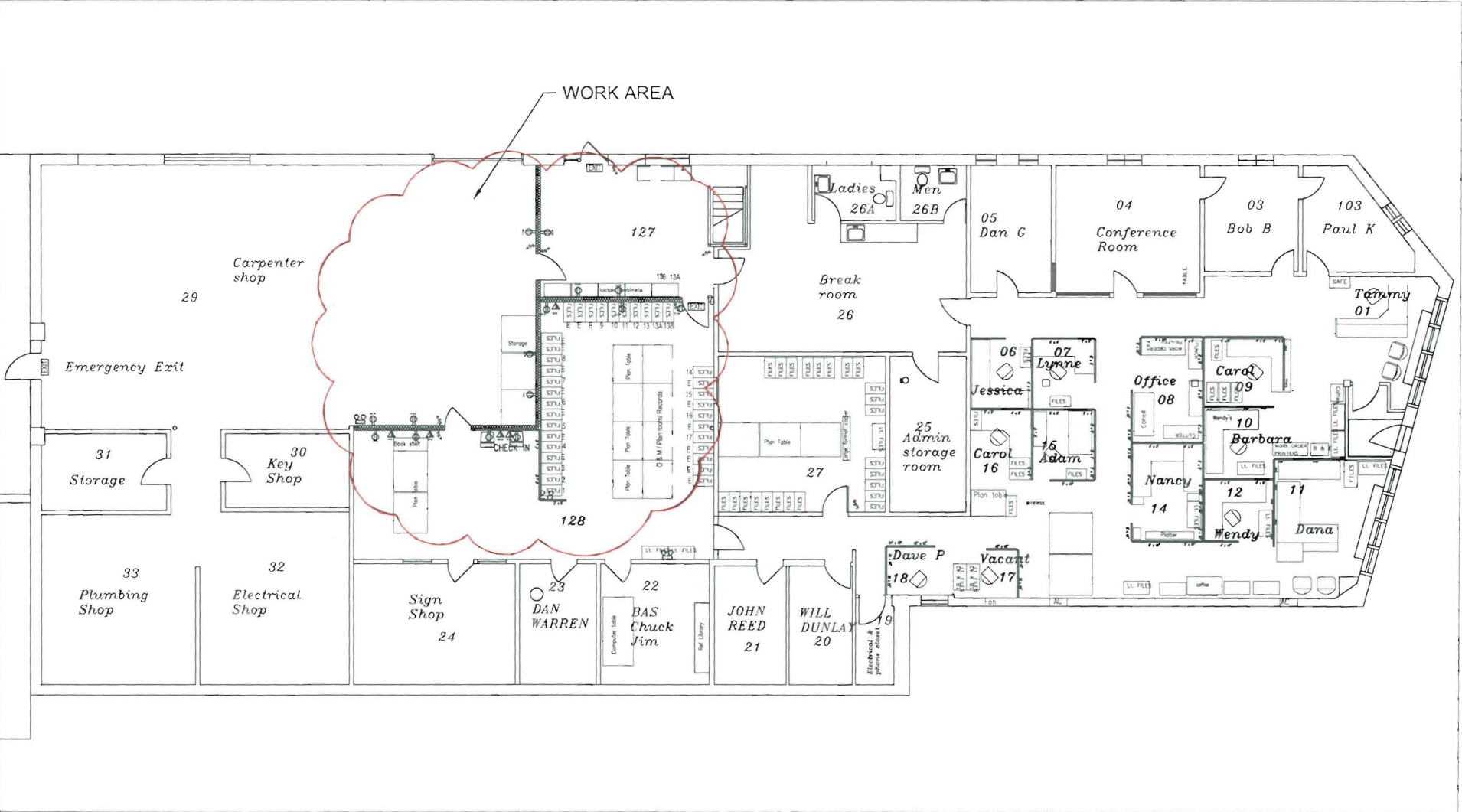





3-3-11

OK to close w

NLP

Still need above ceiling
insp

5-4-11 DWM/BR above ceiling Dan 671-1795

Provide Thermal barrier over paper faced insulation

6-9-11

Spoke w/ Tommy ~~do~~ do not need a thermal
Barrier. Insulation was an existing issue. DANP

will send me a letter stating their intentions
to sprinkle the building in near future and we
can address the issues then. NLP