

FIRST FLOOR LIGHTING PLAN  
SCALE: 1/8" = 1'-0"

| TITLE | CHARACTERISTICS                                       | VOLTS | WATTAGE | CA                                | LAMP             | ACCESSORIES/NOTES                |
|-------|---|-------|---------|-----------------------------------|------------------|----------------------------------|
| A     | Acrylic High Bay, 1000watt                            | 277V  | 1000    | 201 3.52 RW PFC IS 277 GEB        | (1) MH/ROTC      |                                  |
| B     | 2' x 4' Surface Mounted Fluor. Parabolic Troffer      | 277V  | 277     |                                   | (3) 30W T8       |                                  |
| C     | 4' x 8' Fluorescent General Purpose Parabolic Troffer | 277V  | 277     |                                   | (2) 30W T8       |                                  |
| D     | 4' x 8' Fluorescent General Purpose Parabolic Troffer | 277V  | 277     |                                   | (2) 30W T8       | Provide with Condemner's Datakit |
| E     | Decorative Wash-Pak, MH                               | 277V  | 277     | WASH TROFFER MODULE 277 PFC DGEET | (1) MH/ROTC      |                                  |
| F     | Decorative Wash-Pak, MH                               | 277V  | 277     | WASH TROFFER MODULE 277 PFC DGEET | (1) MH/ROTC      |                                  |
| G     | Decorative Wash-Pak, MH                               | 277V  | 277     | WASH TROFFER MODULE 277 PFC DGEET | (1) MH/ROTC      |                                  |
| H     | DELTELED  |       |         |                                   |                  |                                  |
| I     | WASH BRACKET, Fluorescent                             | 277V  | 277     | WASH 2'x 2'7" GEB10               | (2) 30W T8       | Provide with Condemner's Datakit |
| J     | WASH BRACKET, Fluorescent                             | 277V  | 277     | WASH 2'x 2'7" GEB10               | (2) 30W T8       | Provide with Condemner's Datakit |
| K     | Emergency Lighting Head                               | 12V   | 12      | E-117 & E-110                     | 12PAR38-14-E-130 |                                  |
| L     | Emergency Lighting Head                               | 12V   | 12      | E-117 & E-110                     | 12PAR38-14-E-130 |                                  |
| M     | Emergency Lighting Head                               | 12V   | 12      | E-117 & E-110                     | 12PAR38-14-E-130 |                                  |
| N     | Emergency Lighting Head                               | 12V   | 12      | E-117 & E-110                     | 12PAR38-14-E-130 |                                  |
| BP    | Battery Pack Emergency Lighting Unit                  | 277V  | 277     | DM 2 248 277 CW                   | (2) 30W T8       |                                  |
| X     | Exit Sign   | 120V  | 120     | LSM S V1 N 120271 EN N 30         | LED              |                                  |

PLAN KEY NOTES

1. MOUNT EMERGENCY LIGHTING FIXTURE 2'-0" AFF.
2. CONNECT NIGHT LIGHTS TO PENDING UP/NIGHTLIGHT CIRCUIT.
3. POWER EXIT SIGNS AND BATTERY PACKS FROM CIRCUIT IN PANELBOARD UP.
4. POWER DOCK LIGHTS FROM CONDUIT RECEIPTALS SHOWN ON DRAWING EAO.
5. PROVIDE PHOTOELECTRIC RELAY TO CONTROL DOCK COMPACT LIGHTS MOUNT ABOVE THE DOOR CHAIR/FACING NORTH.
6. REFER TO DRAWING "E-W" FOR REBAR/DOCK LIGHTING PLANS.
7. MOUNT EMERGENCY LIGHTING FIXTURE 15" AFF.
8. MOUNT EMERGENCY LIGHTING FIXTURE 6'-0" AFF.
9. MOUNT EMERGENCY LIGHTING FIXTURE 10'-0" AFF.

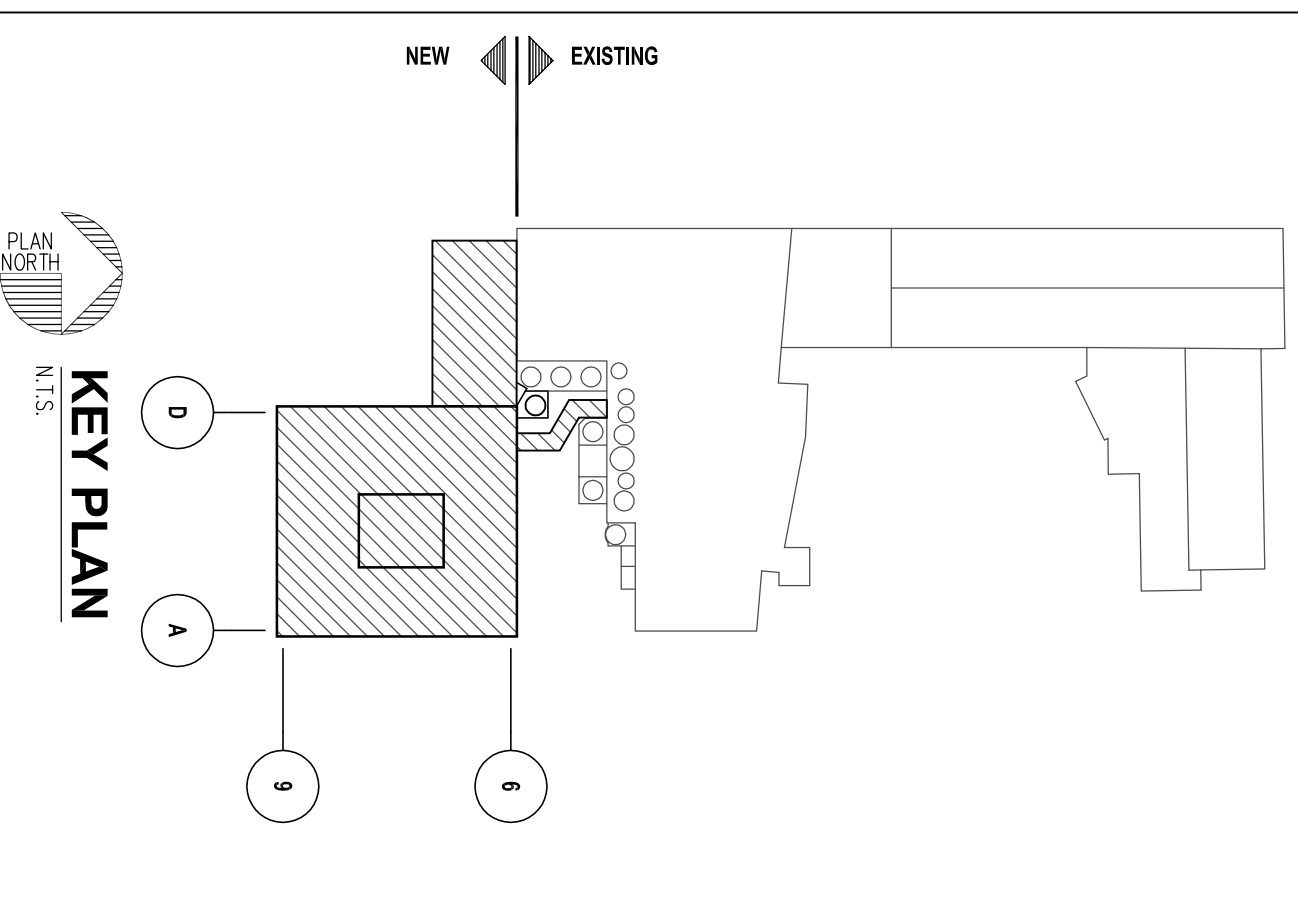

**FACILITIES DESIGN**

3904 Ashd Drive  
Columbia, Pennsylvania 17512  
Phone: (717) 285-9442  
Fax: (717) 285-3102  
Email: info@facilitiesdesign.com  
Web: www.facilitiesdesign.com

C.A. WALKER 20031118 F

Architectural Engineering  
Mechanical Engineering  
Electrical Engineering  
Fire Protection Engineering  
Energy Management  
Lighting Engineering  
Thermal Modeling  
Process Services  
Project Management  
Water Resources  
Master Planning  
Process Safety

This drawing and all information contained herein, remains the property of FACILITIES DESIGN, INC. No part of this drawing may be reproduced in whole or in part without the written consent of FACILITIES DESIGN, INC.

Do not scale drawing. Contractor shall be responsible for any discrepancies that may exist between this drawing and the actual conditions on site. Any discrepancies shall be reported to FACILITIES DESIGN, INC. prior to construction for resolution.

PROJECT NUMBER: 0167.00  
SCALE: AS SHOWN

DESIGNED BY: M.A.H.  
DRAWN BY: M.A.H.  
REC. BY: M.A.H.  
CHECKED BY: M.A.H.

PROJECT: NEW MILK COOLER

Oaklure DAIRY

384 FOREST AVENUE  
PORTLAND, MAINE 04101

DATE: MARCH 1, 2004

PROJECT NUMBER: 0167.00

DRAWING TITLE: FIRST FLOOR LIGHTING PLAN

DRAWING NUMBER: E300

REVISION: 0