

KEY NOTES:

BASEMENT PLAN:

D01 – EXISTING WOOD STAIR TO BE DEMOLISHED. PATCHUP ANY CONCRETE AND ASPHALT PENETRATIONS WITH MATCHING MATERIAL.

FIRST FLOOR PLAN:

D01 – EXISTING WOOD STAIR TO BE DEMOLISHED. PATCHUP ANY CONCRETE PENETRATIONS WITH MATCHING MATERIAL.

D02 – GUARDRAIL TO BE REFURBISHED. RE-INSTALLED PREVIOUSLY REMOVED EXISTING PART OF GUARDRAIL (OWNER TO PROVIDE). PROVIDE PIPE INSERT & WELD. GRIND WELDING & PAINT ENTIRE GUARDRAIL.

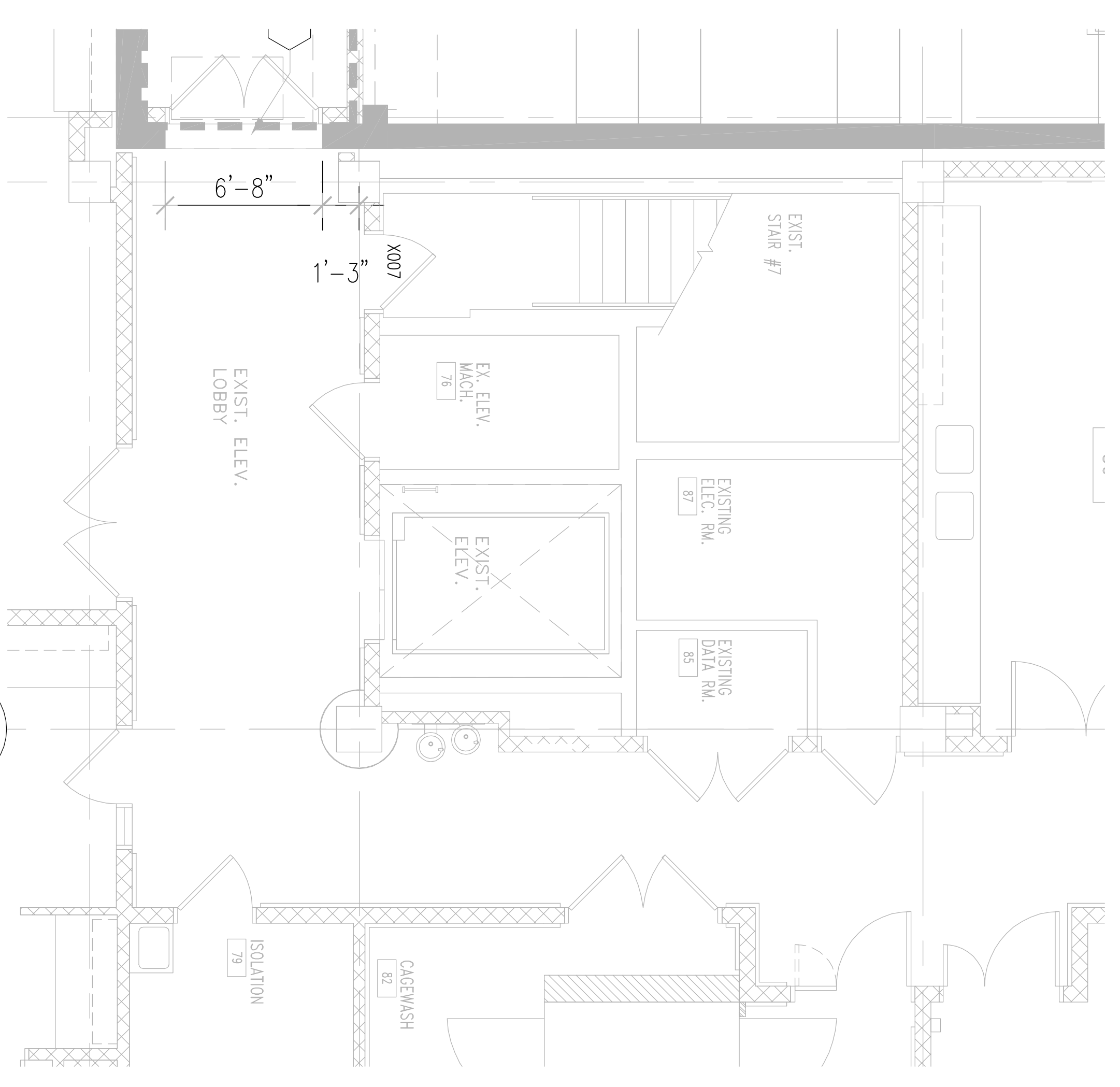
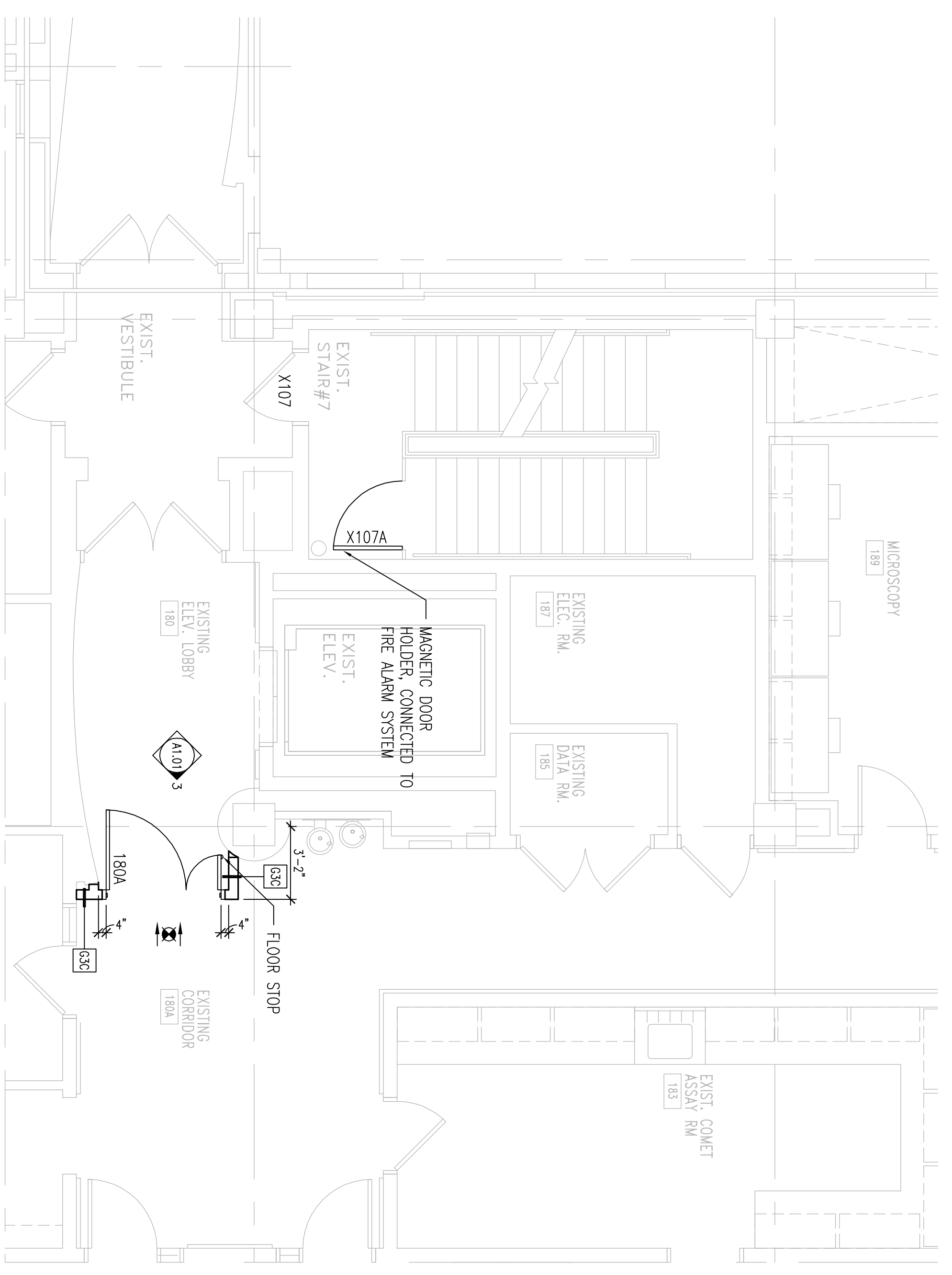
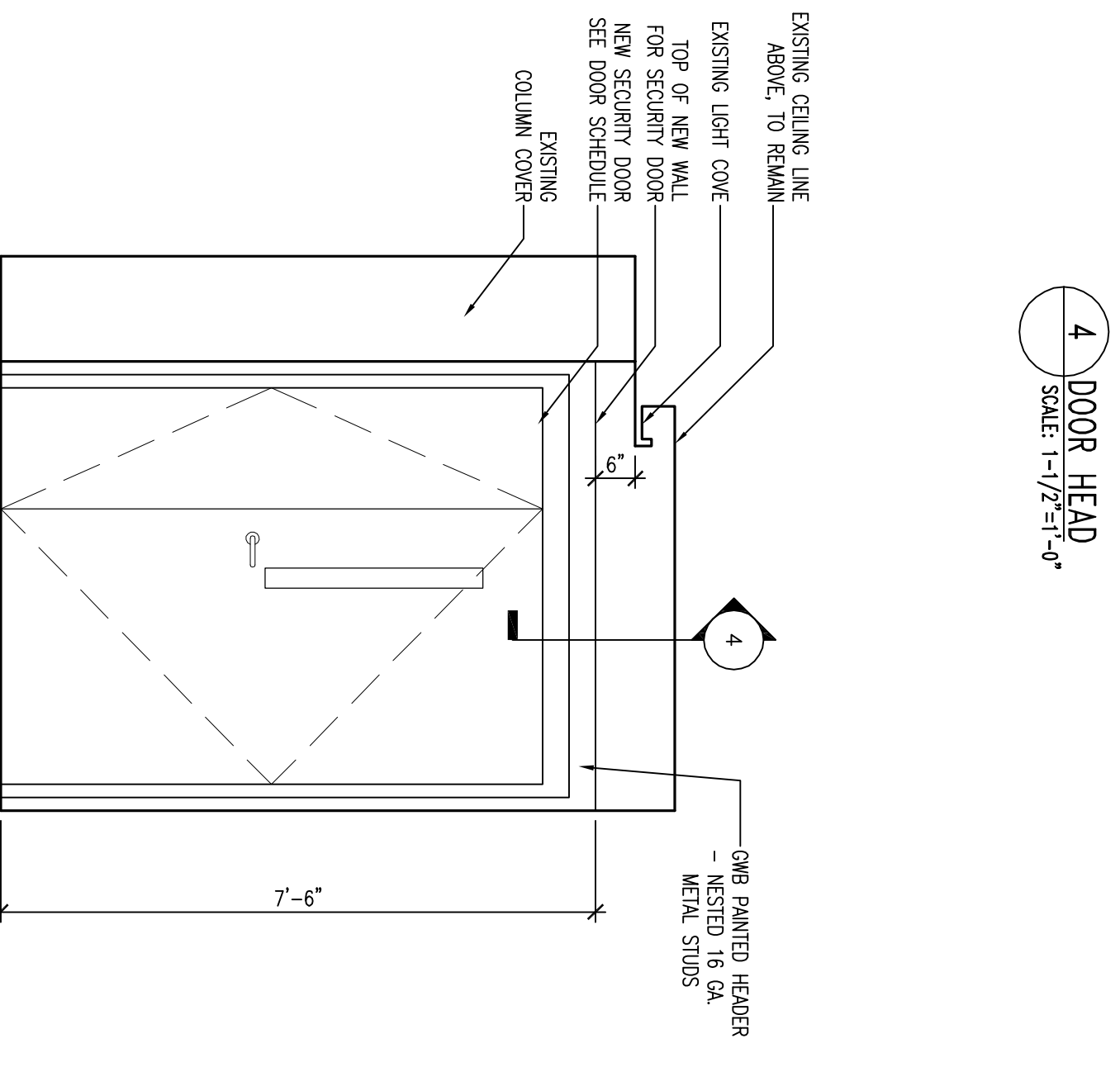
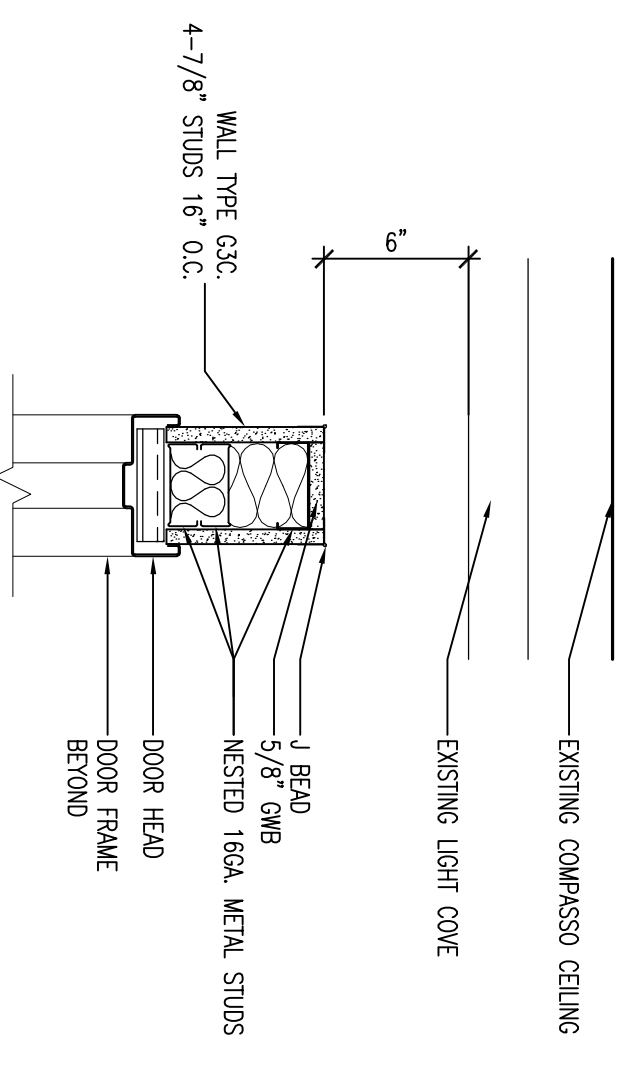
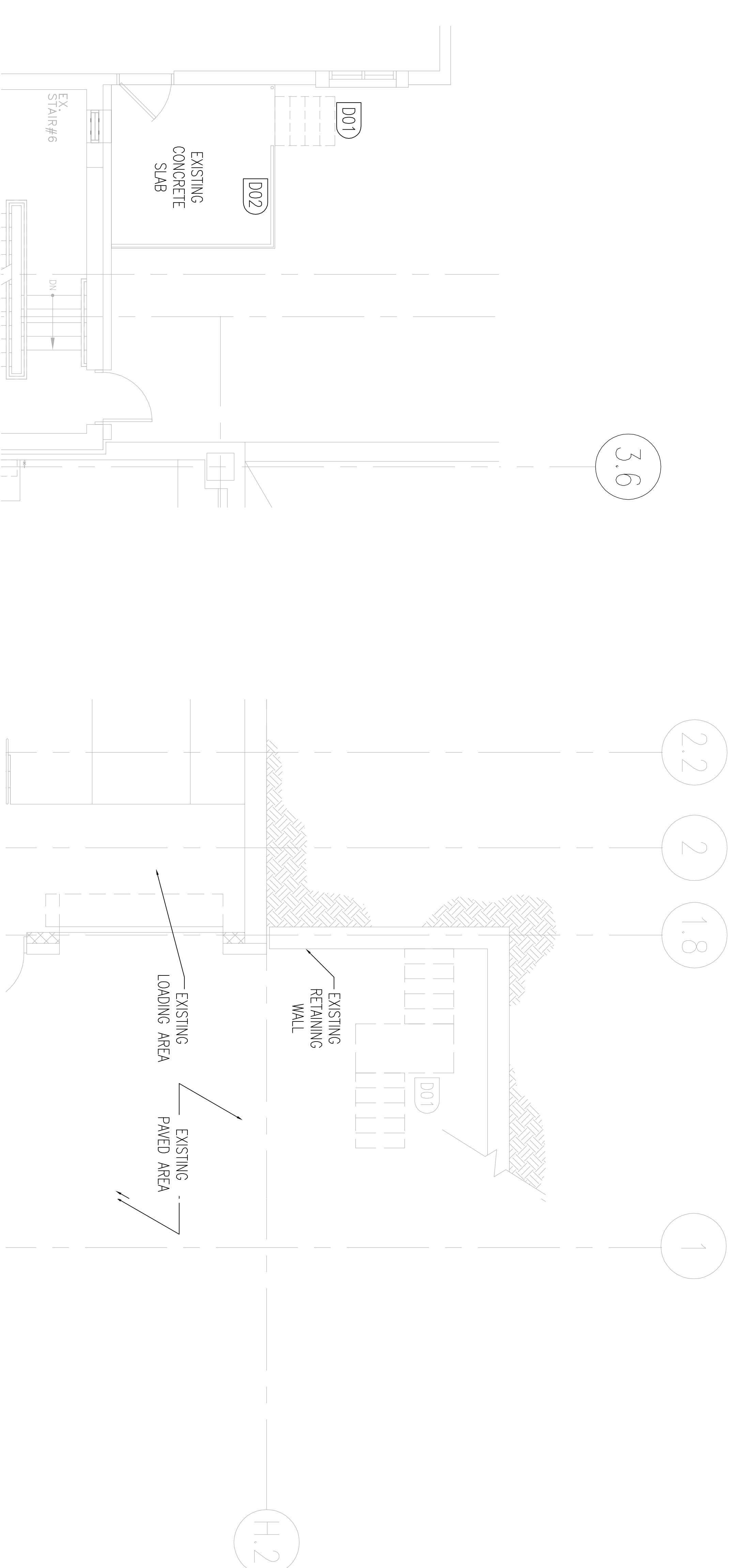

3 FIRST FLOOR ELEVATION AT NEW DOOR
SCALE: 1/2"=1'-0"

2 FIRST FLOOR PARTIAL PLAN
SCALE: 1/4"=1'-0"

1 BASEMENT PARTIAL PLAN
SCALE: 1/4"=1'-0"

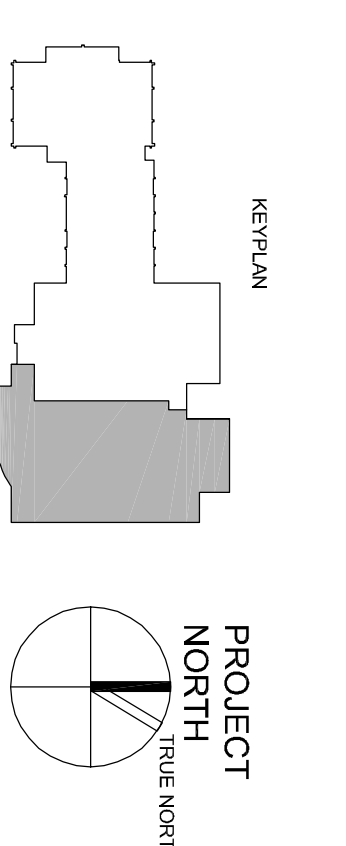

BASEMENT AND FIRST FLOOR PARTIAL PLANS

SCALE: 1/4" = 1'-0"

DRAWN BY	AJT
CHECKED BY	PROJ. ARCH / ENGR. LTD
PROJ. MGR.	RCH
JOB NO.	030493.10

© SWAINES, DAVEN & WISNER ASSOCIATES, INC. 2014

RESEARCH WING PHASE III FIT-OUT

UNIVERSITY OF SOUTHERN MAINE
79 FALMOUTH STREET
PORTLAND, MAINE

NO.	DATE	DESCRIPTION
06.21.06	ISSUED FOR CONSTRUCTION	
05.03.06	SCOPE REVISION	

ISSUES LOG

△ = QUANTITY CHANGE

OWNER REVIEW	DATE