







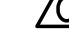
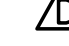

GENERAL SHEET NOTES

1. ALL ITEMS ON THIS SHEET ARE EXISTING UNLESS NOTED OTHERWISE.
2. COORDINATE REMOVALS WITH MECHANICAL, PLUMBING, ELECTRICAL AND STRUCTURAL DRAWINGS.
3. LECTURE HALL SEATING NOT SHOWN FOR CLARITY.

REMOVALS KEYNOTES (THIS SHEET ONLY)

-  REMOVE 2'-6"± HIGH x 10'-0"± LONG STEEL PIPE GUARDRAIL FLUSH TO CONCRETE.
-  REMOVE CARPET AND ADHESIVE.
-  REMOVE ACOUSTICAL CEILING TILES AND SUSPENSION SYSTEM.
-  REMOVE PORTION OF EPDM ROOF SYSTEM FOR STRUCTURAL MECHANICAL EQUIPMENT SUPPORT INSTALLATION. COORDINATE WITH DRAWING SF101 FOR LOCATION AND SIZE OF STRUCTURAL POSTS.
-  SAWCUT AND REMOVE 1'-8"± x 1'-8"± PORTION OF 1'-4"± THICK EXTERIOR MASONRY WALL FOR MECHANICAL DUCT WORK PENETRATION. COORDINATE WITH MECHANICAL DRAWINGS.
-  REMOVE MECHANICAL ROOF TOP EXHAUST FAN AND AIR INTAKE. EXISTING EQUIPMENT CURB TO REMAIN. COORDINATE WITH MECHANICAL REMOVALS DRAWING.
-  REMOVE PIPE HANGER. COORDINATE WITH MECHANICAL DRAWINGS.
-  SAWCUT AND REMOVE PORTION OF 4"± THICK CMU PARTITION FOR MECHANICAL DUCT PENETRATION. REFER TO INTERIOR ELEVATION 5/AD201. COORDINATE WITH MECHANICAL DRAWING M-101.
-  CORE DRILL 6"± DIAMETER HOLE THROUGH 4"± THICK CMU PARTITION FOR MECHANICAL PIPING PENETRATION. COORDINATE WITH MECHANICAL DRAWING M-101.
-  REMOVE 1'-10"± x 11"± MECHANICAL DUCT. COORDINATE WITH MECHANICAL REMOVALS DRAWING MD101.
-  SAWCUT AND REMOVE EXTERIOR MASONRY WALL FOR LINE-SET PIPING PENETRATION.

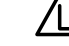
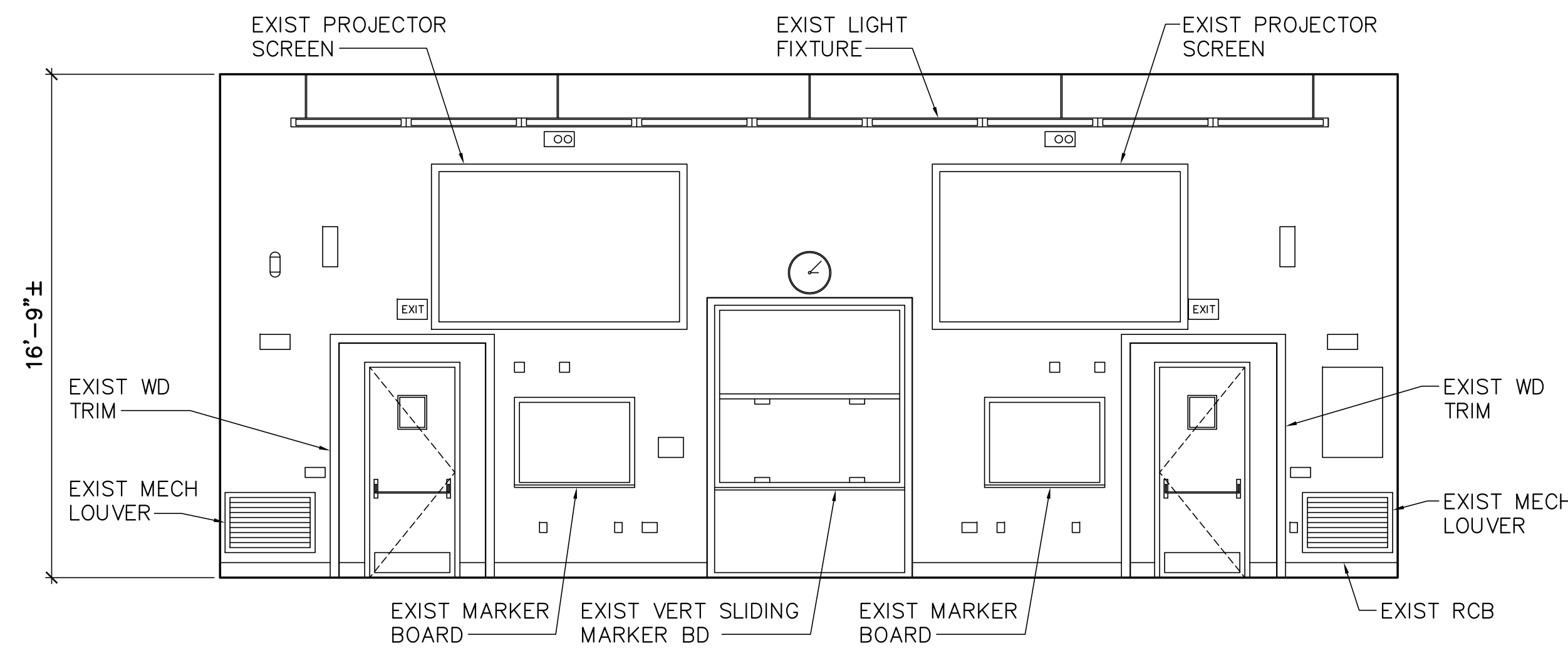

1 REMOVALS INTERIOR ELEVATION
AD101/AD201 SCALE: 1/4"=1'-0"

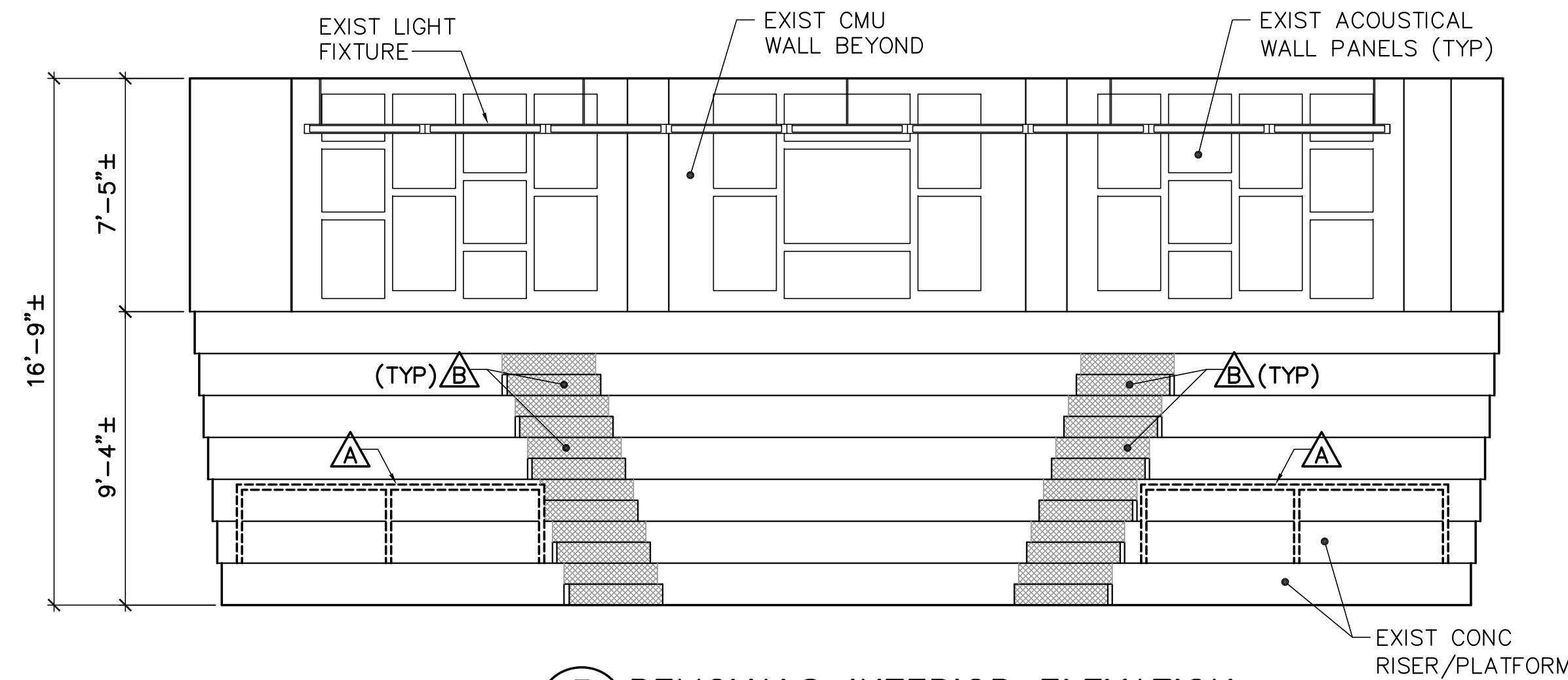

3 REMOVALS INTERIOR ELEVATION
AD101/AD201 SCALE: 1/4"=1'-0"

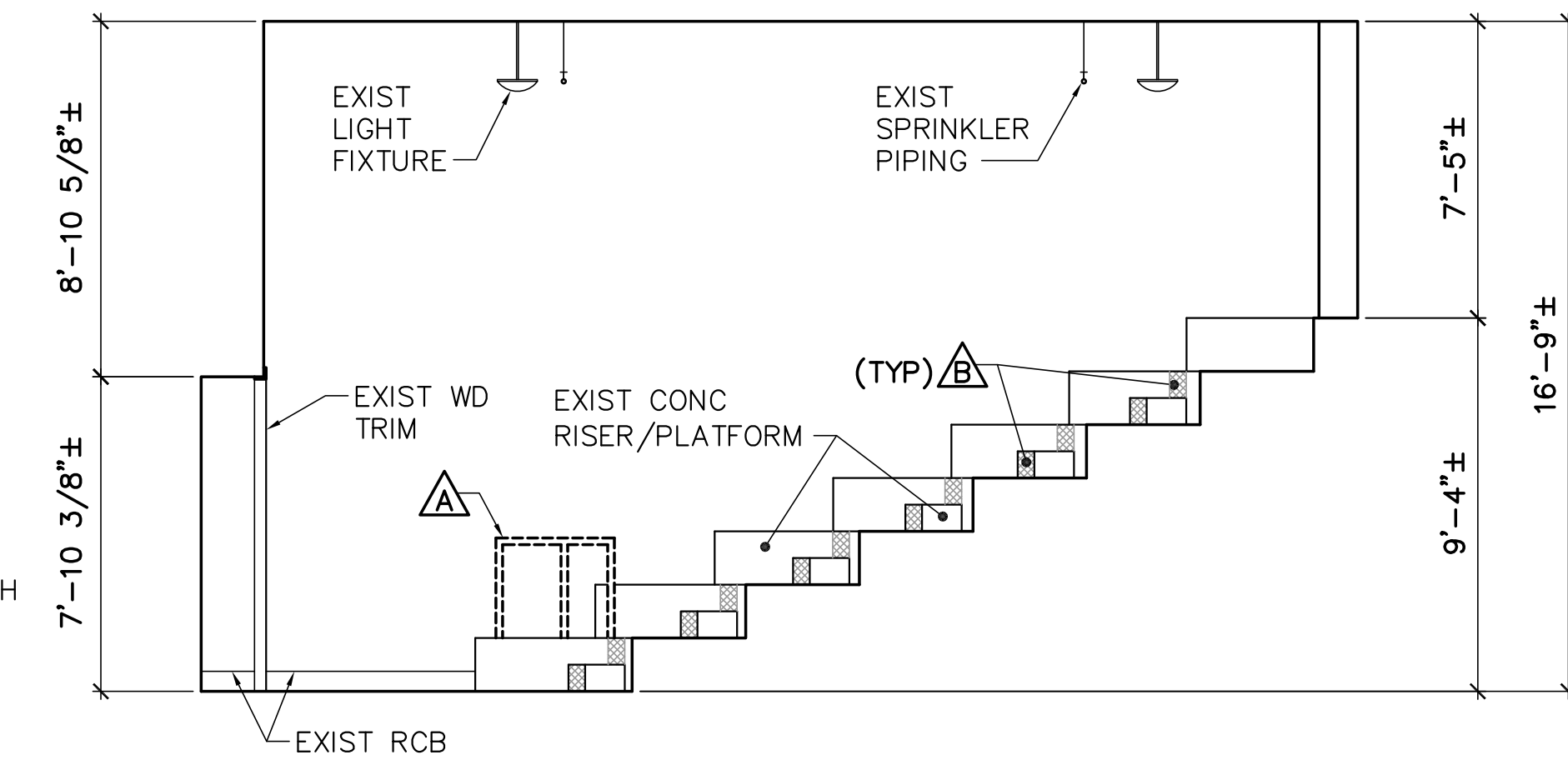

2 REMOVALS INTERIOR ELEVATION
AD101/AD201 SCALE: 1/4"=1'-0"

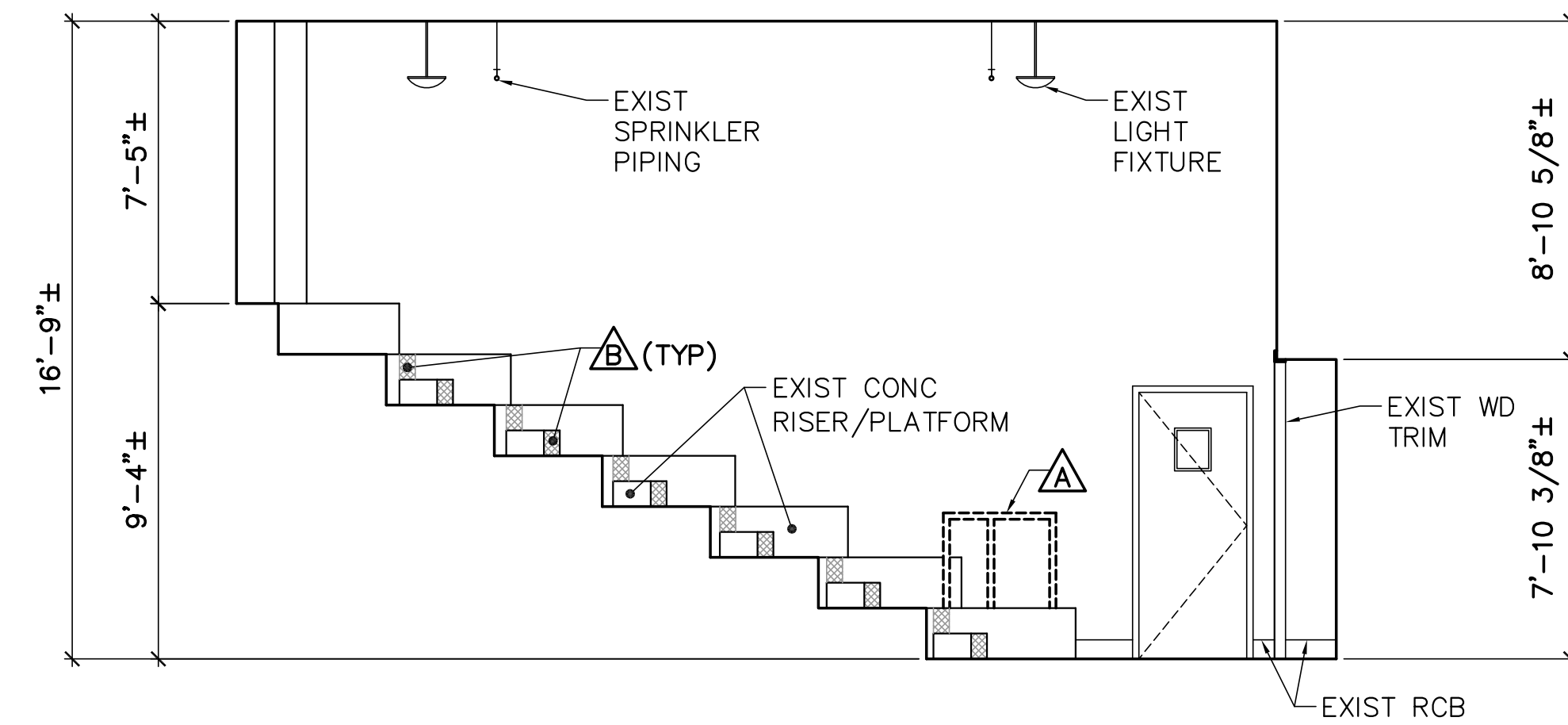

4 REMOVALS INTERIOR ELEVATION
AD101/AD201 SCALE: 1/4"=1'-0"

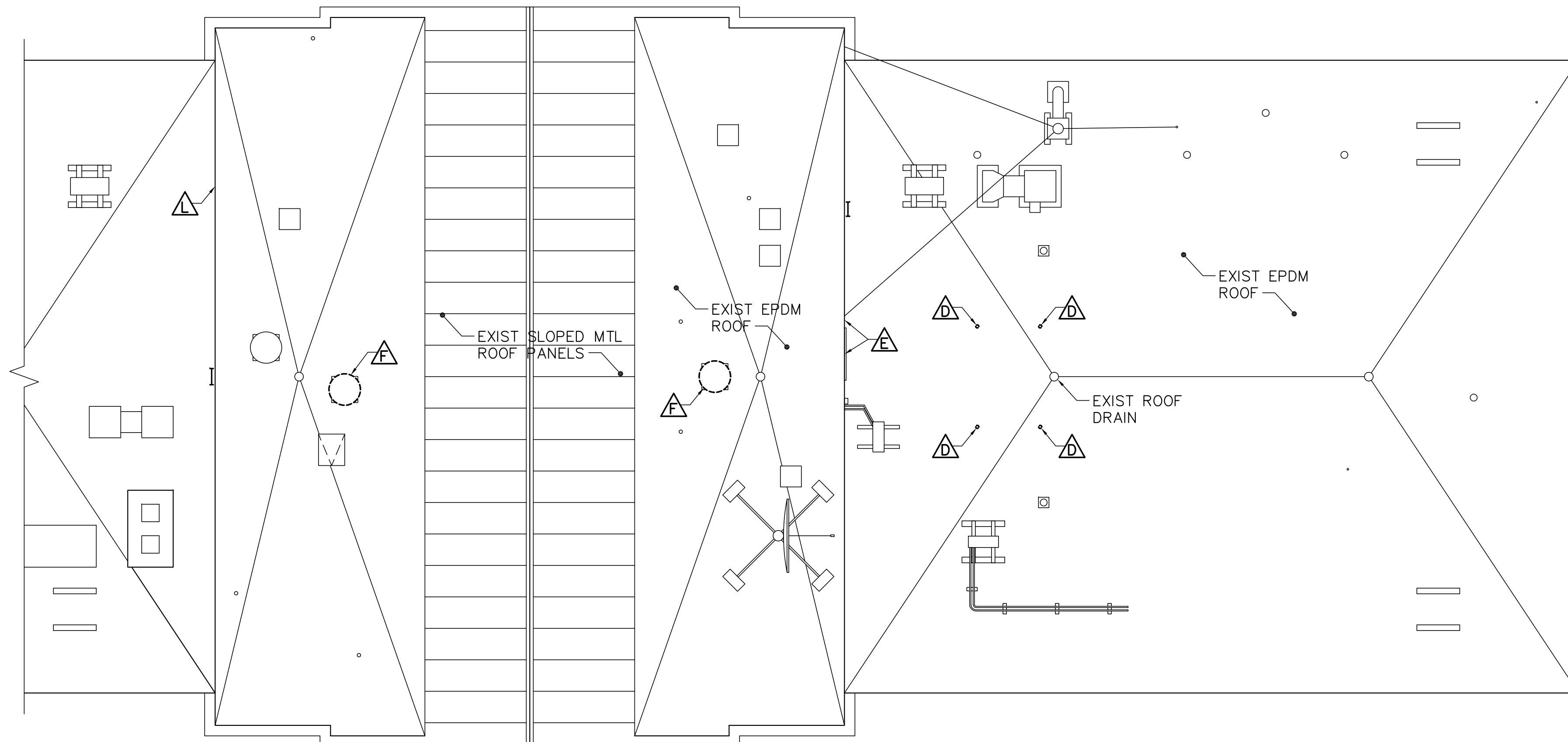

6 REMOVALS PARTIAL ROOF PLAN
AD201 SCALE: 1/8"=1'-0"

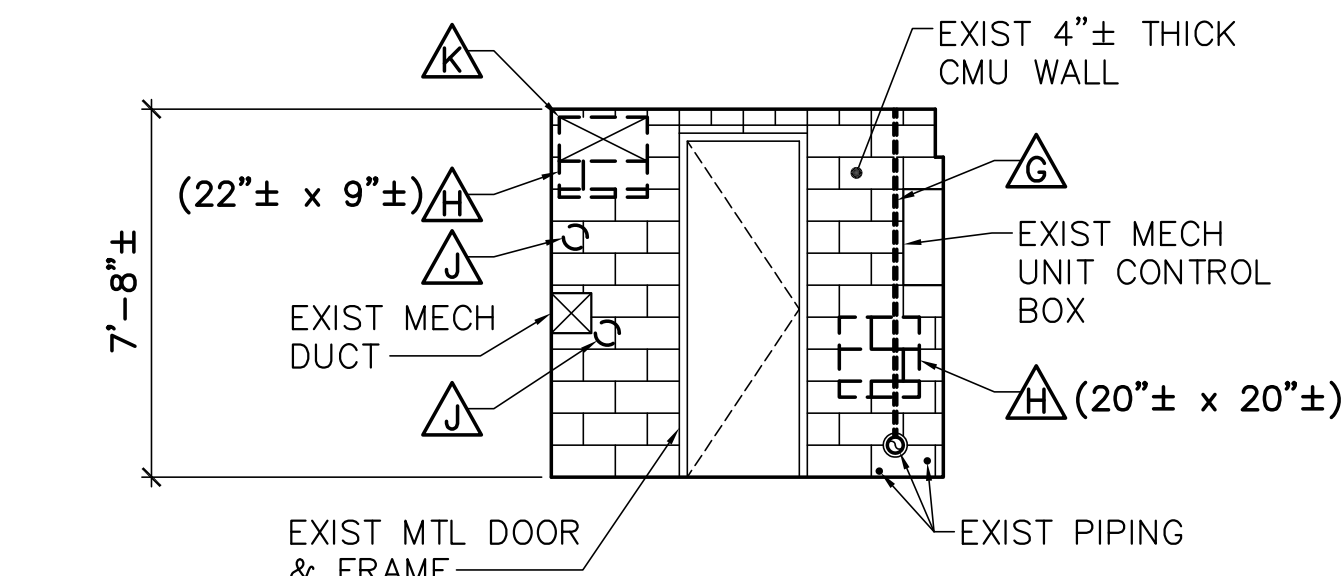

5 REMOVALS INTERIOR ELEVATION
AD101/AD201 SCALE: 1/4"=1'-0"

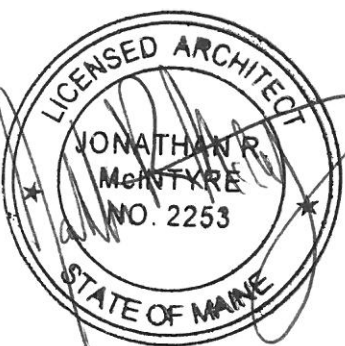
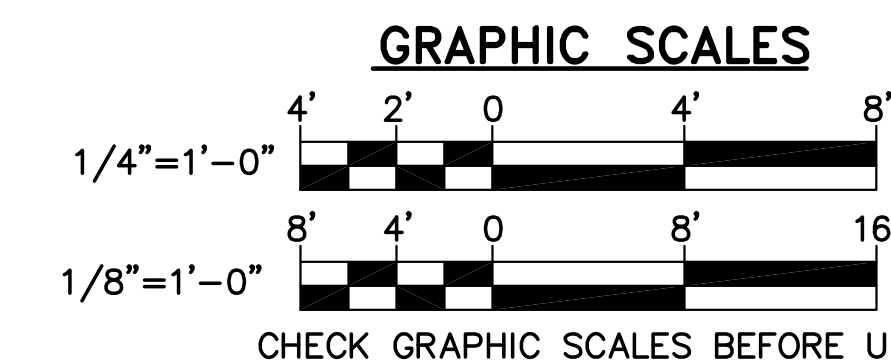

JMC
CRR
JMC
DESIGNED BY:
DRAWN BY:
CHECKED BY:
PROJECT:
21702.01

UNIVERSITY OF SOUTHERN MAINE
COLLEGE OF EDUCATION AND
HUMAN DEVELOPMENT
Portland, ME 04104

LECTURE HALL RENOVATION
AND UPGRADES
PAYSON SMITH HALL
96 Falmouth St. - Portland, Maine

REMOVALS
INTERIOR
ELEVATIONS
AND REMOVALS
ROOF PLAN

SCALE: AS NOTED
DATE: 01-09-18

DWG.: AD201

SHEET: 5 OF 17