

FLOORING NOTES

PREPARATION

- A. GENERAL: COMPLY WITH CRIS "CARPET INSTALLATION STANDARDS" AND WITH CARPET TILE MANUFACTURER'S WRITTEN INSTALLATION INSTRUCTIONS FOR PREPARING SUBSTRATES INDICATED TO RECEIVE CARPET TILE.
- B. USE TROWELABLE LEVELING AND PATCHING COMPOUNDS, ACCORDING TO MANUFACTURER'S WRITTEN INSTRUCTIONS, TO FILL CRACKS, HOLES, DEPRESSIONS, AND PROTRUSIONS IN SUBSTRATES. FILL OR LEVEL CRACKS, HOLES AND DEPRESSIONS 1/8 INCH WIDE OR WIDER, AND PROTRUSIONS MORE THAN 1/32 INCH UNLESS MORE STRINGENT REQUIREMENTS ARE REQUIRED BY MANUFACTURER'S WRITTEN INSTRUCTIONS.
- C. CONCRETE SUBSTRATES: REMOVE COATINGS, INCLUDING CURING COMPOUNDS, AND OTHER SUBSTANCES THAT ARE INCOMPATIBLE WITH ADHESIVES AND THAT CONTAIN SOAP, WAX, OIL, OR SILICONE, WITHOUT USING SOLVENTS. USE MECHANICAL METHODS RECOMMENDED IN WRITING BY ADHESIVE AND CARPET TILE MANUFACTURERS.
- D. BROOM AND VACUUM CLEAN SUBSTRATES TO BE COVERED IMMEDIATELY BEFORE INSTALLING CARPET TILE.

INSTALLATION

- A. GENERAL: COMPLY WITH CRIS "CRI CARPET INSTALLATION STANDARD" SECTION 18, MODULAR CARPET" AND WITH CARPET TILE MANUFACTURER'S WRITTEN INSTALLATION.
- B. INSTALLATION METHOD: AS RECOMMENDED IN WRITING BY CARPET TILE MANUFACTURER.
- C. MAINTAIN DYE-LOT INTEGRITY. DO NOT MIX DYE LOTS IN SAME AREA.
- D. MAINTAIN PILE-DIRECTION PATTERNS RECOMMENDED IN WRITING BY CARPET TILE MANUFACTURER.
- E. CUT AND FIT CARPET TILE TO BUTT TIGHTLY TO VERTICAL SURFACES, PERMANENT FIXTURES, AND BUILT-IN FURNITURE INCLUDING CABINETS, PIPES, OUTLETS, EDGINGS, THRESHOLDS, AND NOSINGS. BIND OR SEAL CUT EDGES AS RECOMMENDED BY CARPET TILE MANUFACTURER.
- F. EXTEND CARPET TILE INTO TOE SPACES, DOOR REVEALS, CLOSETS, OPEN-BOTTOMED OBSTRUCTIONS, REMOVABLE FLANGES, ALCOVES, AND SIMILAR OPENINGS.
- G. MAINTAIN REFERENCE MARKERS, HOLES, AND OPENINGS THAT ARE IN PLACE OR MARKED FOR FUTURE CUTTING BY REPEATING ON CARPET TILE AS MARKED ON SUBFLOOR. USE NONPERMANENT, NONSTAINING MARKING DEVICE.
- H. INSTALL PATTERN PARALLEL TO WALLS AND BORDERS.
- I. PERFORM THE FOLLOWING OPERATIONS IMMEDIATELY AFTER INSTALLING CARPET TILE.
 - 1. REMOVE EXCESS ADHESIVE AND OTHER SURFACE BLEMISHES USING CLEANER RECOMMENDED BY CARPET TILE MANUFACTURER.
 - 2. REMOVE YARNS THAT PROTRUDE FROM CARPET TILE SURFACE.
 - 3. VACUUM CARPET TILE USING COMMERCIAL MACHINE WITH FACE-BEATER ELEMENT.
 - B. PROTECT INSTALLED CARPET TILE TO COMPLY WITH CRIS "CARPET INSTALLATION STANDARD" SECTION 20, "PROTECTING INDOOR INSTALLATIONS."
 - C. PROTECT CARPET TILE AGAINST DAMAGE FROM CONSTRUCTION OPERATIONS AND PLACEMENT OF EQUIPMENT AND FIXTURES DURING THE REMAINDER OF CONSTRUCTION PERIOD. USE PROTECTION METHODS INDICATED OR RECOMMENDED IN WRITING BY CARPET TILE MANUFACTURER.

PAINT NOTES

PREPARATION

- A. COMPLY WITH MANUFACTURER'S WRITTEN INSTRUCTIONS AND RECOMMENDATIONS IN "MPI ARCHITECTURAL PAINTING SPECIFICATION MANUAL" APPLICABLE TO SUBSTRATES AND PAINT SYSTEMS INDICATED.
- B. REMOVE HARDWARE, COVERS, PLATES, AND SIMILAR ITEMS ALREADY IN PLACE THAT ARE REMOVABLE AND ARE NOT TO BE PAINTED. IF REMOVAL IS IMPRACTICAL OR IMPOSSIBLE BECAUSE OF SIZE OR WEIGHT OF ITEM, PROVIDE SURFACE-APPLIED PROTECTION BEFORE SURFACE PREPARATION AND PAINTING.
 - 1. AFTER COMPLETING PAINTING OPERATIONS, USE WORKERS SKILLED IN THE TRADES INVOLVED TO REINSTALL ITEMS THAT WERE REMOVED. REMOVE SURFACE-APPLIED PROTECTION IF ANY.
- C. CLEAN SUBSTRATES OF SUBSTANCES THAT COULD IMPAIR BOND OF PAINTS, INCLUDING DUST, DIRT, OIL, GREASE, AND INCOMPATIBLE PAINTS AND ENCAPSULANTS.
 - 1. REMOVE INCOMPATIBLE PRIMERS AND REPRIME SUBSTRATE WITH COMPATIBLE PRIMER OR APPLY TIE COAT AS REQUIRED TO PRODUCE PAINT SYSTEMS INDICATED.
- D. STEEL SUBSTRATES: REMOVE RUST, LOOSE MILL SCALE, AND SHOP PRIMER, IF ANY. CLEAN USING METHODS RECOMMENDED IN WRITING BY PAINT MANUFACTURER.
- E. SHOP-PRIMED STEEL SUBSTRATES: CLEAN FIELD WELDS, BOLTED CONNECTIONS, AND AREAS WHERE SHOP PAINT IS ABRADED. PAINT EXPOSED AREAS WITH THE SAME MATERIAL AS USED FOR SHOP PRIMING TO COMPLY WITH SSPC-PA 1 FOR TOUCHING UP SHOP-PRIMED SURFACES.
- F. GALVANIZED-METAL SUBSTRATES: REMOVE GREASE AND OIL RESIDUE FROM GALVANIZED SHEET METAL BY MECHANICAL METHODS TO PRODUCE CLEAN, LIGHTLY ETCHED SURFACES THAT PROMOTE ADHESION OF SUBSEQUENTLY APPLIED PAINTS. UNIFORMLY ABRASIVE GALVANIZED SURFACES WITH A PALM SANDER AND 60 GRIT ALUMINUM OXIDE SO SURFACE IS FREE OF OIL AND SURFACE CONTAMINANTS.
- G. WOOD SUBSTRATES:
 - 1. SCRAPE AND CLEAN KNOTS, AND APPLY COAT OF KNOT SEALER BEFORE APPLYING PRIMER.
 - 2. SAND SURFACES THAT WILL BE EXPOSED TO VIEW AND DUST OFF.
 - 3. PRIME EDGES, ENDS, FACES, UNDERSIDES, AND BACKSIDES OF WOOD.
 - 4. AFTER PRIMING, FILL HOLES AND IMPERFECTIONS IN THE FINISH SURFACES WITH PUTTY OR PLASTIC WOOD FILLER. SAND SMOOTH WHEN DRIED.
- H. COTTON OR CANVAS INSULATION COVERING SUBSTRATES: REMOVE DUST, DIRT, AND OTHER FOREIGN MATERIAL THAT MIGHT IMPAIR BOND OF PAINTS TO SUBSTRATES.

APPLICATION

- A. APPLY PAINTS ACCORDING TO MANUFACTURER'S WRITTEN INSTRUCTIONS AND TO RECOMMENDATIONS IN "MPI MANUAL".
 - 1. USE APPLICATORS AND TECHNIQUES SUITED FOR PAINT AND SUBSTRATE INDICATED.
 - 2. PAINT SURFACES BEHIND MOVABLE EQUIPMENT AND FURNITURES SAME AS SIMILAR EXPOSED SURFACES. BEFORE FINAL INSTALLATION, PAINT SURFACES BEHIND PERMANENTLY FIXED EQUIPMENT OR FURNITURE WITH PRIME COAT ONLY.
 - 3. PAINT FRONT AND BACKSIDES OF ACCESS PANELS, REMOVABLE OR HINGED COVERS, AND SIMILAR HINGED ITEMS TO MATCH EXPOSED SURFACES.
 - 4. DO NOT PAINT OVER LABELS OF INDEPENDENT TESTING AGENCIES OR EQUIPMENT NAME, IDENTIFICATION, PERFORMANCE RATING, OR NOMENCLATURE PLATES.
 - 5. PRIMERS SPECIFIED IN PAINTING SCHEDULES MAY BE OMITTED ON ITEMS THAT ARE FACTORY PRIMED OR FACTORY FINISHED IF ACCEPTABLE TO TOPCOAT MANUFACTURERS.
- B. TINTING: TINT PRIMER OF COLORS SUCH AS REDS, YELLOWS, AND ORANGES WITH A GRAY BASECOAT SYSTEM DESIGNED TO HELP PROVIDE COLOR COVERAGE.
 - 1. DO NOT TINT PRIME OR BASE COAT FOR MULTI-COLORED FINISHES.
- C. IF UNDERCOATS OR OTHER CONDITIONS SHOW THROUGH TOPCOAT, APPLY ADDITIONAL COATS UNTIL CURED FILM HAS A UNIFORM PAINT FINISH, COLOR, AND APPEARANCE. GIVE SPECIAL ATTENTION TO ENSURE EDGES, CORNERS, CREVICES, WELDS, AND EXPOSED FASTENERS RECEIVE A DRY FILM THICKNESS EQUIVALENT TO THAT OF FLAT SURFACES. WHEN USING COLORS SUCH AS RED, YELLOW OR ORANGE, AN EXTRA COAT OF FINISH MAY BE NECESSARY. NOTIFY ARCHITECT WHEN ADDITIONAL COATS DO NOT FIX THE PROBLEM.
- D. APPLY PAINTS TO PRODUCE SURFACE FILMS WITHOUT CLOUDINESS, SPOTTING, HOLIDAYS, LAPS, BRUSH MARKS, ROLLER TRACKING, RUNS, SAGS, ROPIENESS, OR OTHER SURFACE IMPERFECTIONS. CUT IN SHARP LINES AND COLOR BREAKS.
- E. PAINTING FIRE SUPPRESSION, PLUMBING, HVAC, ELECTRICAL, COMMUNICATION, AND ELECTRONIC SAFETY AND SECURITY WORK:
 - 1. PAINT THE FOLLOWING WORK WHERE EXPOSED IN EQUIPMENT ROOMS: NOT APPLICABLE.
 - A. EQUIPMENT, INCLUDING PANELBOARDS.
 - B. UNINSULATED METAL PIPING.
 - C. UNINSULATED PLASTIC PIPING.
 - D. PIPE HANGERS AND SUPPORTS.
 - E. METAL CONDUIT.
 - F. PLASTIC CONDUIT.
 - G. DUCT, EQUIPMENT, AND PIPE INSULATION HAVING COTTON OR CANVAS INSULATION COVERING OR OTHER PAINTABLE JACKET MATERIAL.
 - H. OTHER ITEMS AS DIRECTED BY ARCHITECT.
 - 2. PAINT PORTIONS OF INTERNAL SURFACES OF METAL DUCTS, WITHOUT LINER, BEHIND AIR INLETS AND OUTLETS THAT ARE VISIBLE FROM OCCUPIED SPACES.

CLEANING AND PROTECTION

- A. AT END OF EACH WORKDAY, REMOVE RUBBISH, EMPTY CANS, RAGS, AND OTHER DISCARDED MATERIALS FROM PROJECT SITE.
- B. AFTER COMPLETING PAINT APPLICATION, CLEAN SPATTERED SURFACES. REMOVE SPATTERED PAINTS BY WASHING, SCRAPING, OR OTHER METHODS. DO NOT SCRATCH OR DAMAGE ADJACENT FINISHED SURFACES.
- C. PROTECT WORK OF OTHER TRADES AGAINST DAMAGE FROM PAINT APPLICATION. CORRECT DAMAGE TO WORK OF OTHER TRADES BY CLEANING, REPAIRING, REPLACING, AND REFINISHING, AS APPROVED BY ARCHITECT, AND LEAVE IN AN UNDAMAGED CONDITION.
- D. AT COMPLETION OF CONSTRUCTION ACTIVITIES OF OTHER TRADES, TOUCH UP AND RESTORE DAMAGED OR DEFACED PAINTED SURFACES.

INTERIOR PAINTING SCHEDULE

- A. STEEL SUBSTRATES:
 - 1. LOW-ODOR/VOV LATEX SYSTEM:
 - A. PRIME COAT: PRIMER, RUST INHIBITIVE, WATER BASED.
 - B. INTERMEDIATE COAT: LATEX, INTERIOR, LOW ODOR/VOV, MATCHING TOPCOAT.
 - C. TOPCOAT: LATEX, INTERIOR, LOW ODOR/VOV, SEMI-GLOSS (MPI GLOSS LEVEL 5).
- B. GALVANIZED-METAL SUBSTRATES:
 - 1. LOW-ODOR/VOV LATEX SYSTEM:
 - A. PRIME COAT: PRIMER, RUST INHIBITIVE, WATER BASED.
 - B. INTERMEDIATE COAT: LATEX, INTERIOR, LOW ODOR/VOV, MATCHING TOPCOAT.
 - C. TOPCOAT: LATEX, INTERIOR, LOW ODOR/VOV, SEMI-GLOSS (MPI GLOSS LEVEL 5).
- C. WOOD SUBSTRATES: WOOD TRIM AND DOORS.
 - 1. LOW-ODOR/VOV LATEX SYSTEM:
 - A. PRIME COAT: PRIMER, LATEX, FOR INTERIOR WOOD.
 - B. INTERMEDIATE COAT: LATEX, INTERIOR, LOW ODOR/VOV, MATCHING TOPCOAT.
 - C. TOPCOAT: LATEX, INTERIOR, LOW ODOR/VOV, SEMI-GLOSS (MPI GLOSS LEVEL 5).
- D. GYPSUM BOARD SUBSTRATES:
 - 1. LOW-ODOR/VOV LATEX SYSTEM:
 - A. PRIME COAT: PRIMER SEALER, INTERIOR, LOW ODOR/VOV, ODOR/VOV, MATCHING TOPCOAT.
 - B. INTERMEDIATE COAT: LATEX, INTERIOR, INSTITUTIONAL LOW ODOR/VOV, FLAT (MPI GLOSS LEVEL 1) FOR CEILINGS.
 - C. TOPCOAT: LATEX, INTERIOR, INSTITUTIONAL LOW ODOR/VOV EGGSHELL (MPI GLOSS LEVEL 3) FOR WALLS.
- E. FIBERGLASS-FACED GYPSUM BOARD SUBSTRATES:
 - 1. LOW-ODOR/VOV LATEX SYSTEM:
 - A. PRIME COAT: HIGH-BUILD PRIMER/SEALER.
 - B. INTERMEDIATE COAT: LATEX, INTERIOR, INSTITUTIONAL LOW ODOR/VOV, MATCHING TOPCOAT.
 - C. TOPCOAT: LATEX, INTERIOR, INSTITUTIONAL LOW ODOR/VOV EGGSHELL (MPI GLOSS LEVEL 3).
- F. COTTON OR CANVAS AND ASJ INSULATION-COVERING SUBSTRATES: INCLUDING PIPE AND DUCT COVERINGS.
 - 1. LOW-ODOR/VOV LATEX SYSTEM:
 - A. PRIME COAT: PRIMER SEALER, INTERIOR, LOW ODOR/VOV.
 - B. INTERMEDIATE COAT: LATEX, INTERIOR, INSTITUTIONAL LOW ODOR/VOV, MATCHING TOPCOAT.
 - C. TOPCOAT: LATEX, INTERIOR, INSTITUTIONAL LOW ODOR/VOV, FLAT (MPI GLOSS LEVEL 1).

Room Finish Schedule									
WT	ROOM NAME	FLOOR	BASE MATL	WALLS				NOTES	
				N	S	E	W		
300A	Corridor	CPT-1	VCT-1	PT-1	PT-2	PT-2	PT-1		
300B	Office	CPT-1	VCT-1	PT-1	PT-1	PT-2	PT-1		
300C	Office	CPT-1	VCT-1	PT-1	PT-1	PT-1	PT-1		
300D	Office	CPT-1	VCT-1	PT-1	PT-1	PT-1	PT-1		
300E	Office	CPT-1	VCT-1	PT-1	PT-1	PT-1	PT-1		
301	Office	CPT-2	VCT-1	PT-3	PT-1	PT-1	PT-1		
301B	Office	CPT-2	VCT-1	PT-1	PT-1	PT-1	PT-1		
301C	Office	CPT-2	VCT-1	PT-1	PT-1	PT-1	PT-1		
301D	Office	CPT-2	VCT-1	PT-1	PT-1	PT-1	PT-1		
301F	Office	CPT-2	VCT-1	PT-1	PT-1	PT-1	PT-1		
302	Office	CPT-1	VCT-1	PT-2	PT-1	PT-1	PT-2		
302A	Office	CPT-1	VCT-1	PT-1	PT-1	PT-1	PT-1		
302B	Office	CPT-1	VCT-1	PT-1	PT-1	PT-1	PT-1		
302C	Office	CPT-1	VCT-1	PT-1	PT-1	PT-1	PT-1		
302D	Office	CPT-1	VCT-1	PT-1	PT-1	PT-1	PT-1		
302E	Office	CPT-1	VCT-1	PT-1	PT-1	PT-1	PT-1		
304AA	Office	CPT-3	VCT-1	PT-1	PT-1	PT-1	PT-5		
304C	Office	CPT-3	VCT-1	PT-1	PT-1	PT-1	PT-1		
304D	Office	CPT-3	VCT-1	PT-1	PT-1	PT-1	PT-1		
305B	Vestibule	SC-1	VCT-1	PT-1	PT-1	PT-1	PT-1		
305C	Lab	SC-1	VCT-1	PT-1	PT-1	PT-1	PT-1		

RE-PAIN ALL INTERIOR WINDOW FRAMES AND CASINGS
WINDOW TREATMENTS -- MECHOSYSTEMS ECOVEL SCREENS 1550 SERIES (3% OPEN) IN SILVER BIRCH 1569

FINISHES LEGEND

- CPT-1 INTERFACE SIDETRACK STRATOSPHERE/TRACK
- CPT-2 INTERFACE SIDETRACK STERLING/TRACK
- CPT-3 INTERFACE SIDETRACK DENIM/TRACK
- SC-1 SEALED CONCRETE
- PT-1 USM ICI EGRET SHERWIN WILLIAMS
- PT-2 USM SPRAY GREEN SHERWIN WILLIAMS
- PT-3 USM UNIVERSAL GRAY SHERWIN WILLIAMS
- PT-4 USM COSMOS SHERWIN WILLIAMS
- VCT-1 JOHNSONITE MEDIUM GRAY 28
- SLT-1 JOHNSONITE SLTC-XXX-F BLACK 40

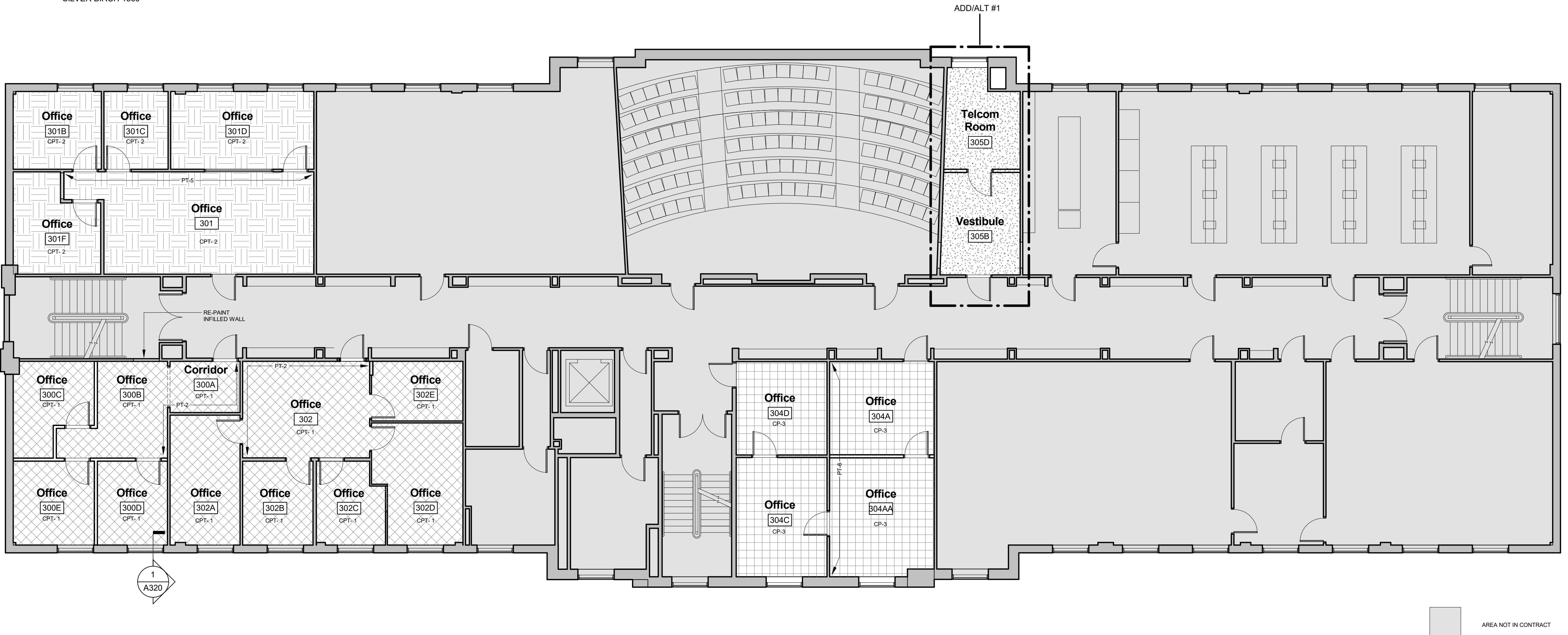

Level 3 - Finish Plan
1/8" = 1'-0"

AREA NOT IN CONTRACT