

Project Title
USM LUTHER BONNEY HALL 2ND FLOOR RENOVATION
Portland, Maine

Harriman Project No. 12677

Key Plan

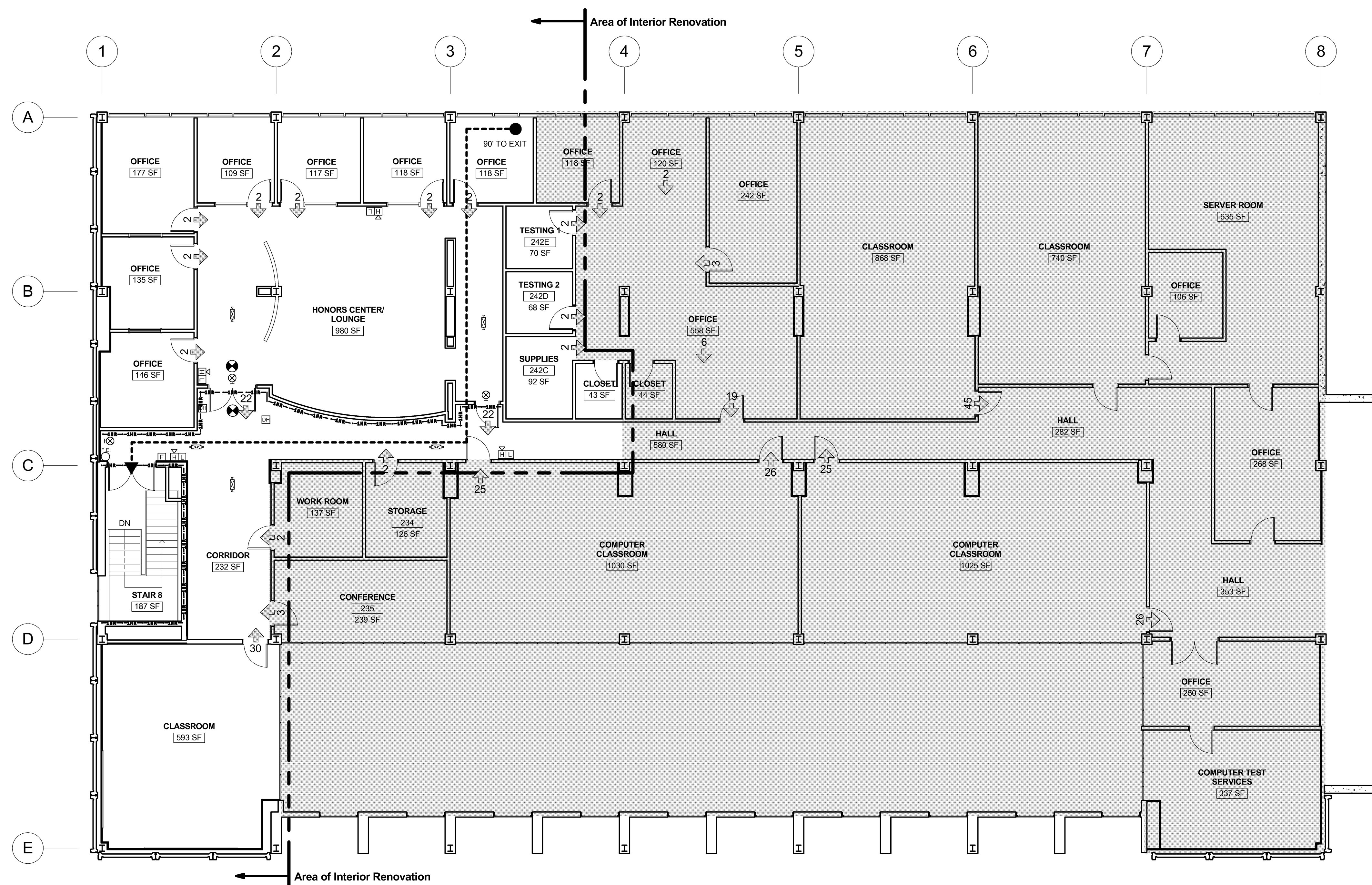

CODE PLAN LEGEND:

- ⊗ EXIT SIGN
- ☒ HORN / STROBE
- ☐ STROBE
- ☑ EMERGENCY LIGHT
- ☒ KNOX BOX
- ☐ FACP FIRE ALARM CONTROL PANEL
- ☉ SMOKE DETECTOR
- ☐ FIRE ALARM PULL STATION
- ☒ ELECTROMAGNETIC DOOR HOLDER
- ☑ MASTER FIRE BOX
- ↔ FIRE DEPT HOSE CONNECTION
- ☉ FIRE EXTINGUISHER
- ⓧ OCCUPANT LOAD

BUILDING DESIGN CODES:

- AMERICANS WITH DISABILITIES ACT (ADA 2010)
- NFPA 101 LIFE SAFETY CODE (2006)
- INTERNATIONAL BUILDING CODE (2009)
- INTERNATIONAL EXISTING BUILDING CODE (2009)
- INTERNATIONAL MECHANICAL CODE (2009)
- ASHRAE / IES STANDARD 90.1 - 2004
- NFPA 70 NATIONAL ELECTRIC CODE (2008)
- NFPA 13

OCCUPANCY CLASSIFICATION:

- NFPA: BUSINESS
- IBC: BUSINESS

CONSTRUCTION TYPE:

- NFPA: TYPE II (000)
- IBC: TYPE IIB

AREA:

- BASEMENT: 5,656 SF
- FIRST: 28,017 SF
- SECOND: 24,862 SF
- THIRD: 10,093 SF
- FOURTH: 8,138 SF
- FIFTH: 8,126 SF
- TOTAL: 82,892 SF
- AREA OF RENOVATION: 4,000 SF

FIRE SUPPRESSION:

NOTE: PROJECT AREA - UNSPRINKLED

OCCUPANT LOADS:

- OFFICE: 100 SF GROSS
- MECHANICAL: 300 SF GROSS
- STORAGE: 300 SF GROSS
- CLASSROOM: 20 SF NET
- ASSEMBLY (SEATING): 15 SF NET

MEANS OF EGRESS:

- MAX TRAVEL DISTANCE: 200 FT (NFPA)
- DEAD END CORRIDOR: 20 FT
- COMMON PATH OF TRAVEL: 75 FT OL<50
- 20 FT OL>50
- 44 IN OL>50
- MIN CORRIDOR WIDTH: 44 IN
- EXIT CAPACITY: 3"/OCCUPANT (VERTICAL)
2"/OCCUPANT (HORIZ)

Drawing Scales

1/8" = 1'-0"	

Issue Dates

Mark	Date	Description
...	10-15-12	ISSUED FOR BID
...	10-10-12	90% REVIEW
...	10-02-12	75% REVIEW

Drawing Status

Drawing Title

CODE PLAN	
PA / PE: MDL	Drawn By: ERP

Drawing Number
A02.1

1 CODE PLAN
SCALE: 1/8" = 1'-0"