

JOB#:

ITEM MANUFACTURING
 Barlo BarloMex Sub Other: _____

ITEM INSTALLATION
 Barlo BarloMex Sub Other: _____

ITEM SCOPE OF WORK
 ITEM D - MANUFACTURE & INSTALL FABRICATED ALUMINUM SIGN

Sign Area: 140 SF

GENERAL NOTES

1. ALL GRAPHICS FILES WILL BE SUPPLIED BY USM FACILITIES DEPT. AS VECTOR PDFS.
2. SIGN QUANTITIES TO BE VERIFIED BY FABRICATOR/INSTALLER WITH USM FACILITIES DEPT.
3. FABRICATOR/INSTALLER SHALL COORDINATE AND CONFIRM ALL SIGN LOCATIONS AND MOUNTING HEIGHTS WITH USM FACILITIES DEPT. AND DIGSAFE PRIOR TO ANY INSTALLATIONS.
4. FABRICATOR/INSTALLER SHALL SUBMIT SHOP DRAWINGS FOR REVIEW AND APPROVAL BY USM FACILITIES DEPT.
5. PRIOR TO FABRICATION, COLOR SAMPLES ON SPECIFIED SUBSTRATES SHALL BE SUBMITTED BY FABRICATOR/INSTALLER, REVIEWED, AND

COLORS

LETTERS

Copy: vinyl: GLOSS OPAQUE WHITE

USM + Logo: vinyl: OPAQUE SAPPHIRE BLUE 7725-37

BACKGROUND

POST

PAINTED USM BLUE - PMS 287

ALL REVEALS PAINTED BLACK

ALL COLORS ARE FOR REPRESENTATION ONLY. SEE ACTUAL SAMPLES FOR COLOR MATCH.

MANUFACTURING INFORMATION

ILL. Non-ILL Interior Exterior

Face Mat: ALUM Th:

Copy Mat: VINYL Depth:

Hardware:

SIGN GRAPHICS TO BE PROVIDED BY CUSTOMER

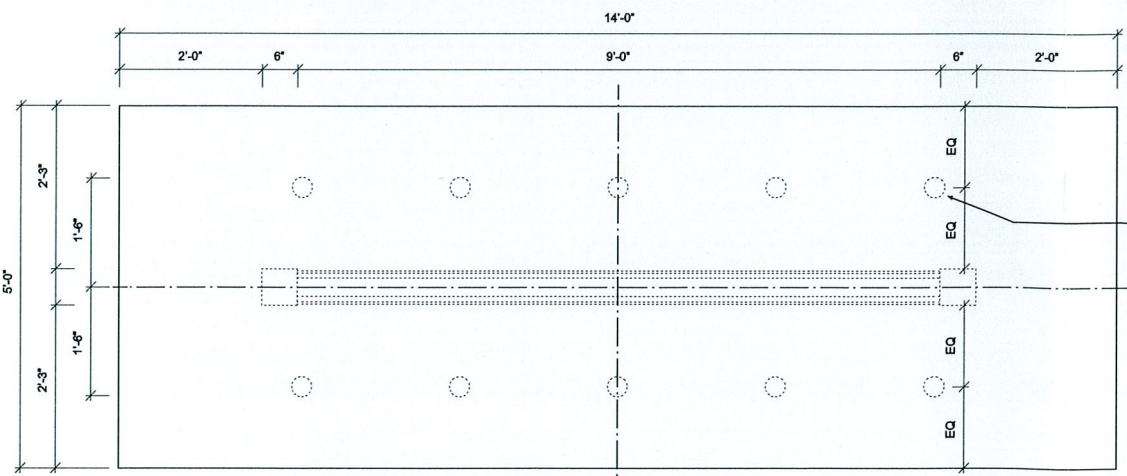
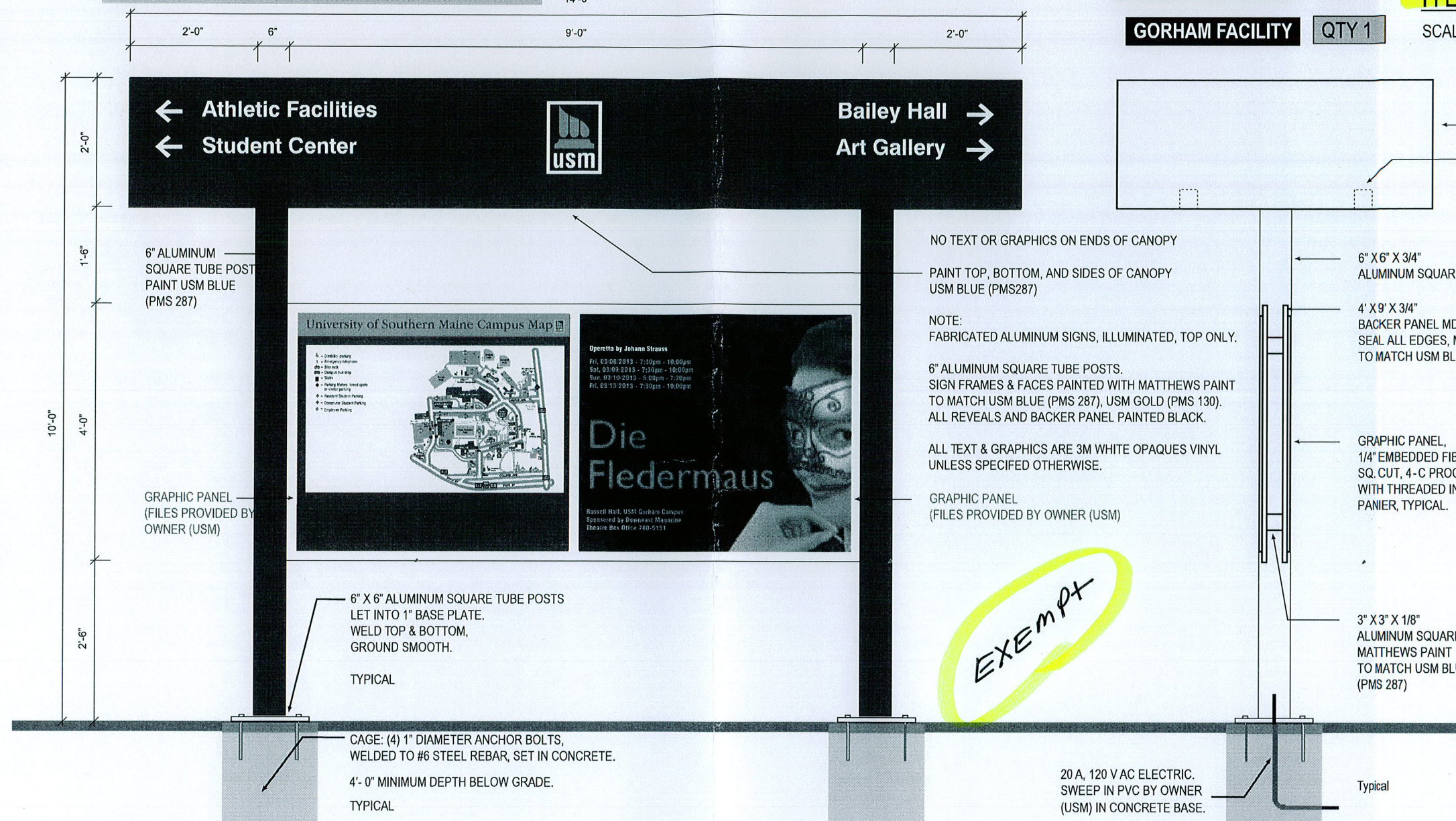

PLAN - Top View
 SCALE: 3/8"=1'-0"

PORTLAND FACILITY QTY 2

GORHAM FACILITY QTY 1

ITEM D - D/F KIOSK A

SCALE: 1/2"=1'-0"

NO TEXT OR GRAPHICS ON ENDS OF CANOPY

PAINT TOP, BOTTOM, AND SIDES OF CANOPY USM BLUE (PMS287)

NOTE:
 FABRICATED ALUMINUM SIGNS, ILLUMINATED, TOP ONLY.

6" ALUMINUM SQUARE TUBE POSTS.
 SIGN FRAMES & FACES PAINTED WITH MATTHEWS PAINT TO MATCH USM BLUE (PMS 287), USM GOLD (PMS 130). ALL REVEALS AND BACKER PANEL PAINTED BLACK.

ALL TEXT & GRAPHICS ARE 3M WHITE OPAQUES VINYL UNLESS SPECIFIED OTHERWISE.

GRAPHIC PANEL (FILES PROVIDED BY OWNER (USM))

20 A, 120 V AC ELECTRIC. SWEEP IN PVC BY OWNER (USM) IN CONCRETE BASE.

EXEMPT

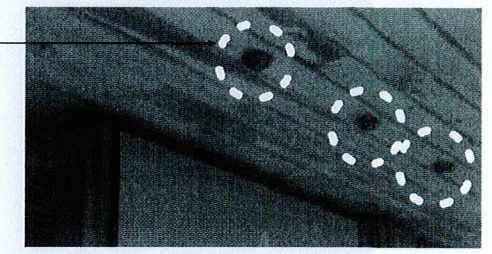
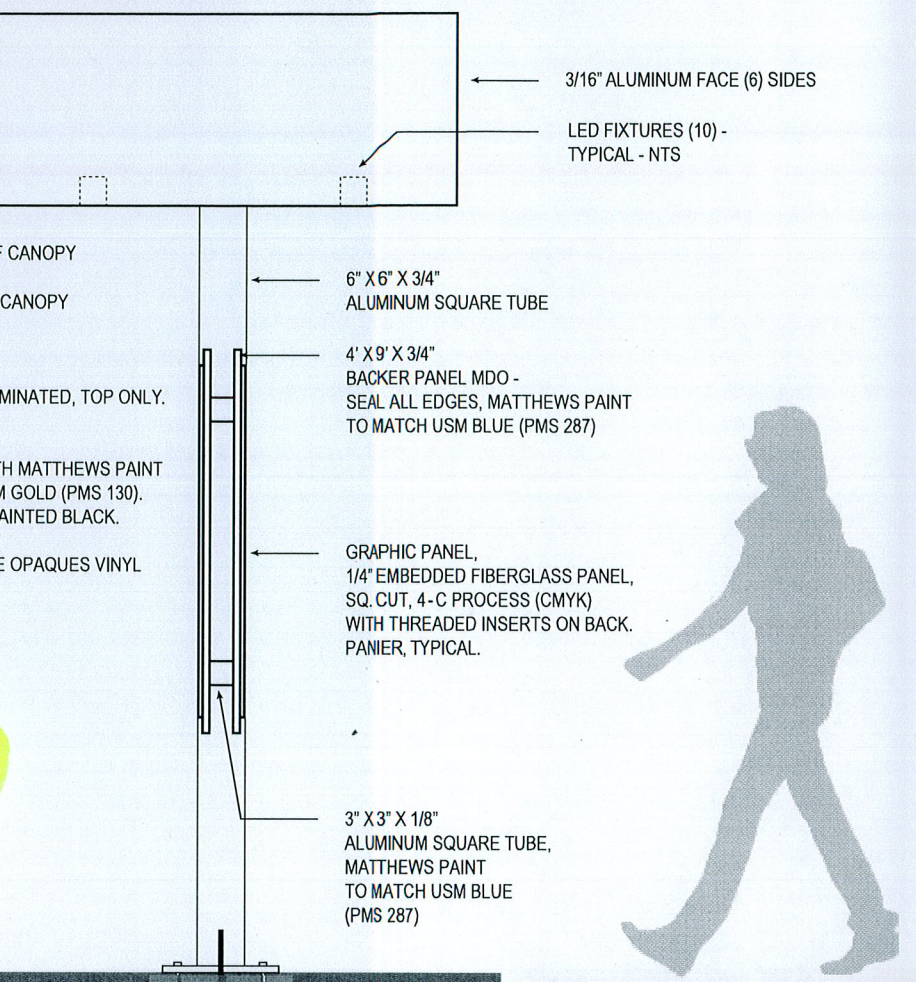

LED FIXTURES (10), TYPICAL -

ECO DOWNLIGHT LED, 2" EDLM - 1100 -1SERIES OR EQUIVALENT -

PROJECT APPROVAL - PRESALE		Job Name: University of Southern Maine	
Design:	Date:	Location: 96 Falmouth St Portland, ME 04104	
Sales:	Date:	Design Specifications Accepted By:	
Design:	Date:	Client:	Drawn By: NM
Estimating:	Date:	Landlord:	Sales Rep: MALT
Engineering:	Date:	Date: 7/24/13	
Sales:	Date:	© COPYRIGHT 2013 THE BARLO GROUP	
Production:	Date:	THIS DESIGN CONCEPT IS THE PROPERTY OF THE BARLO GROUP, ALL PRODUCTION AND DUPLICATION RIGHTS ARE RESERVED BY THE BARLO GROUP. THIS PRINT IS DESIGNED FOR YOUR PERSONAL USE AND IS NOT TO BE USED OUTSIDE YOUR ORGANIZATION OR EXHIBITED IN ANY FASHION.	
Installation:	Date:		

REVISIONS

Date	Comment

TIME SUMMARY

0-Art/Eng. _____	5-Neon _____
Arte/Ingenieria	Neon
1-Pat/Vin. _____	6-Finish _____
Patrones/Vinyl	Acabado
2-Let. Fab. _____	7-Paint _____
Letras Fabricacion	Pintura
3-Screen _____	8-Install _____
Pantalla	Instalacion
4-Met. Fab. _____	9-Misc. _____
Fabricacion	Mislaneos

BARLO SIGNS

158 Greeley St., Hudson, NH 03051
 (603) 882-2638 Fax (603) 882-7680
 For Service: 800-227-5674

File Name: Univ So ME 130711478 CO 7-24

B-13-07-11478 SHEET: 6.0

JOB#:

SIGN GRAPHICS TO BE PROVIDED BY CUSTOMER

PORTLAND FACILITY QTY 1

ITEM E - KIOSK B
SCALE: 1/2"=1'-0"

ITEM MANUFACTURING	
Barlo <u>BarloMex</u> Sub Other: _____	
ITEM INSTALLATION	
<u>Barlo</u> BarloMex Sub Other: _____	
ITEM SCOPE OF WORK	
ITEM E - MANUFACTURE & INSTALL FABRICATED ALUMINUM SIGN	
Sign Area: 28.5 SF	
GENERAL NOTES	
1. ALL GRAPHICS FILES WILL BE SUPPLIED BY USM FACILITIES DEPT. AS VECTOR PDFS.	
2. SIGN QUANTITIES TO BE VERIFIED BY FABRICATOR/INSTALLER WITH USM FACILITIES DEPT.	
3. FABRICATOR/INSTALLER SHALL COORDINATE AND CONFIRM ALL SIGN LOCATIONS AND MOUNTING HEIGHTS WITH USM FACILITIES DEPT. AND DIGSAFE PRIOR TO ANY INSTALLATIONS.	
4. FABRICATOR/INSTALLER SHALL SUBMIT SHOP DRAWINGS FOR REVIEW AND APPROVAL BY USM FACILITIES DEPT.	
5. PRIOR TO FABRICATION, COLOR SAMPLES ON SPECIFIED SUBSTRATES SHALL BE SUBMITTED BY FABRICATOR/INSTALLER, REVIEWED, AND APPROVED IN FIELD BY USM FACILITIES DEPT.	
COLORS	
LETTERS	
Copy: vinyl: GLOSS OPAQUE WHITE	
USM + Logo: vinyl: OPAQUE SAPPHIRE BLUE 7725-37	
BACKGROUND	
ELEVATION - FRONT SIDE A AND C ARE THE SAME	
POST	
PAINTED USM BLUE - PMS 287	
ALL REVEALS PAINTED BLACK	
ALL COLORS ARE FOR REPRESENTATION ONLY. SEE ACTUAL SAMPLES FOR COLOR MATCH.	
MANUFACTURING INFORMATION	
<u>ILL.</u> Non-ILL Interior <u>Exterior</u>	
Face Mat: ALUM Th:	
Copy Mat: VINYL Depth:	
Hardware:	

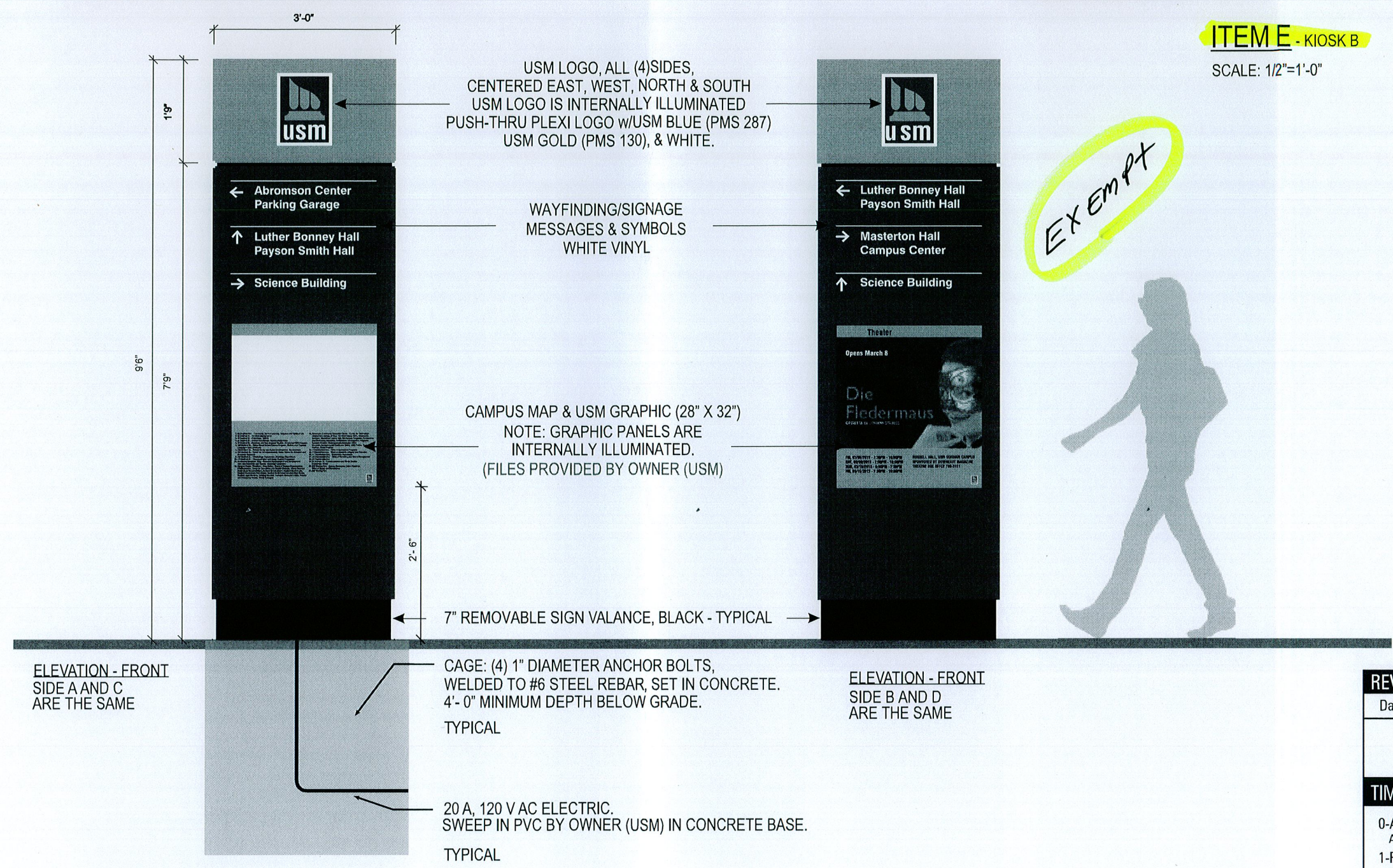

EXEMPT

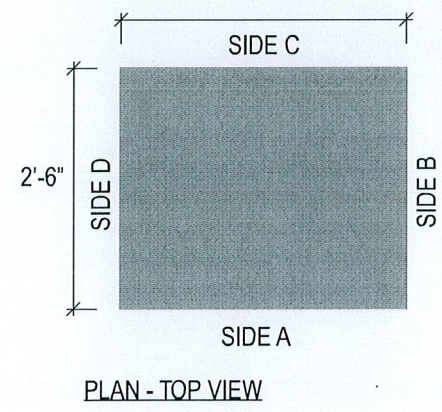
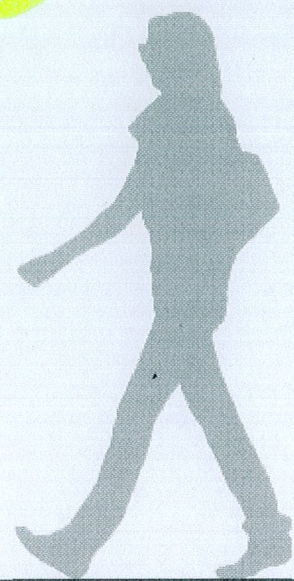

NOTE: FABRICATED ALUM. SIGNS, ILLUMINATED, (4) SIDES. 3/16" THICK (BLEED) ALUMINUM FACES, NO VISIBLE SEAMS ON RETURNS. SIGN FACES PAINTED w/ MATTHEWS PTM USM BLUE (PMS 287), USM GOLD (PMS 130). ALL REVEALS & VALANCE PAINTED BLACK.

ALL TEXT & GRAPHICS ARE WHITE VINYL UNLESS SPECIFIED OTHERWISE.

REVISIONS	
Date	Comment

TIME SUMMARY	
0-Art/Eng. _____	5-Neon _____
Arte/Ingenieria _____	Neon _____
1-Pat/Vin. _____	6-Finish _____
Patrones/Vinyl _____	Acabado _____
2-Let. Fab. _____	7-Paint _____
Letras Fabricacion _____	Pintura _____
3-Screen _____	8-Install _____
Pantalla _____	Instalacion _____
4-Met. Fab. _____	9-Misc. _____
Fabricacion _____	Mislaneos _____

PROJECT APPROVAL - PRESALE		Job Name: University of Southern Maine
Design: _____	Date: _____	Location: 96 Falmouth St Portland, ME 04104
Sales: _____	Date: _____	Design Specifications Accepted By:
PROJECT APPROVAL - PROD.		Client: _____
Design: _____	Date: _____	Landlord: _____
Estimating: _____	Date: _____	Drawn By: NM
Engineering: _____	Date: _____	Sales Rep: MALT
Sales: _____	Date: _____	Date: 7/24/13
Production: _____	Date: _____	© COPYRIGHT 2013 THE BARLO GROUP
Installation: _____	Date: _____	THIS DESIGN CONCEPT IS THE PROPERTY OF THE BARLO GROUP. ALL PRODUCTION AND DUPLICATION RIGHTS ARE RESERVED BY THE BARLO GROUP. THIS PRINT IS DESIGNED FOR YOUR PERSONAL USE AND IS NOT TO BE USED OUTSIDE YOUR ORGANIZATION OR EXHIBITED IN ANY FASHION.

BARLO SIGNS

158 Greeley St., Hudson, NH 03051
(603) 882-2638 Fax (603) 882-7680
For Service: 800-227-5674

File Name: Univ So ME 130711478 CO 7-24

B-13-07-11478 SHEET: 7.0