

**NOTES:**

1. SEE SHEET E-001 FOR LEGEND AND GENERAL NOTES.
2. LIGHTS SHOWN ON DEMO PLANS CAN BE RE-USED WHERE NEW LIGHTS OF THE SAME TYPE ARE SHOWN.
3. PROVIDE KEY SWITCH SKa. IT WILL CONTROL SOME EMERGENCY LIGHTS THAT WERE PREVIOUSLY CONTROLLED BY MOTION SENSOR. ALL WORK ASSOCIATED WITH THE ADDITION OF THIS KEY SWITCH, INCLUDING ALL WIRING, SHALL BE PRICED AS ALTERNATE #3.

**KEYED NOTES:**

- ① EXISTING FIXTURE TO BE CONTROLLED FROM NEW KEYED SWITCH SKa AND CIRCUIT EP1-5. DISCONNECT FROM EXISTING CIRCUIT AND MOTION CONTROL.
- ② CIRCUIT HV1A-1.
- ③ RELOCATED CONTROL UNIT.
- ④ EXTEND CIRCUIT FROM ELEVATOR #1 PIT.

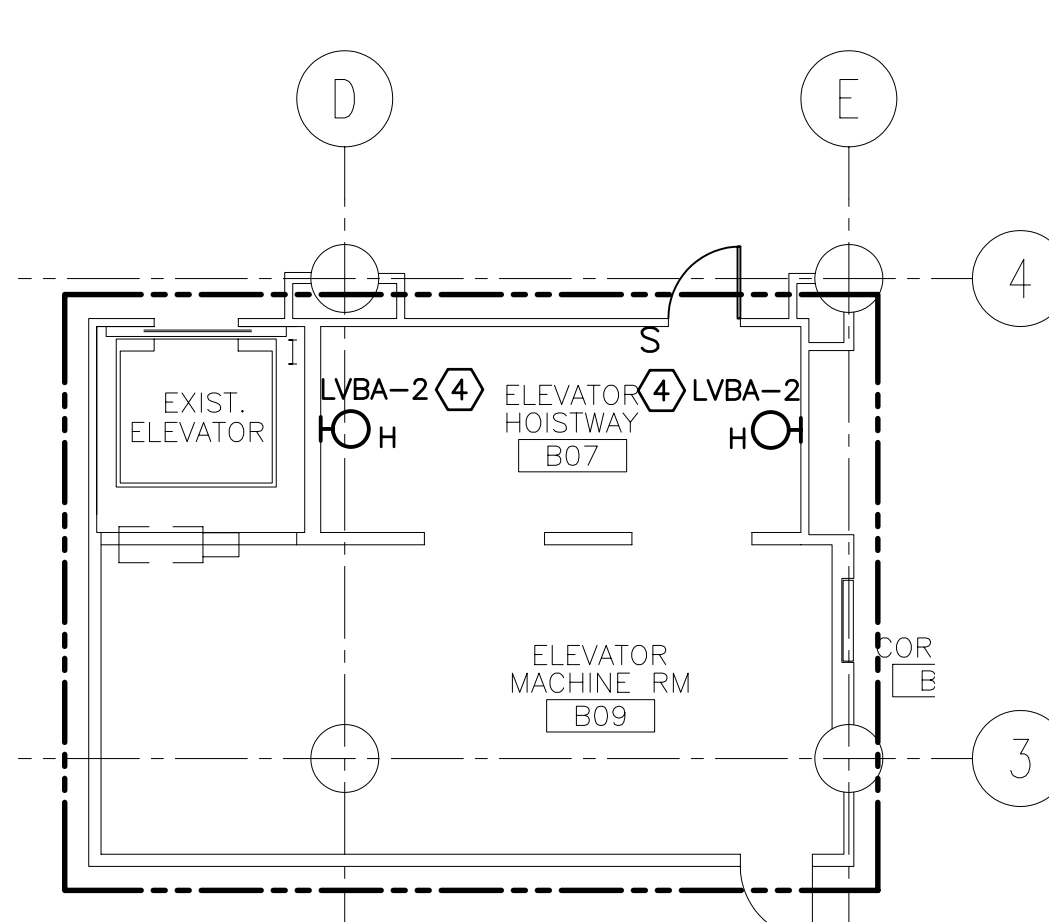
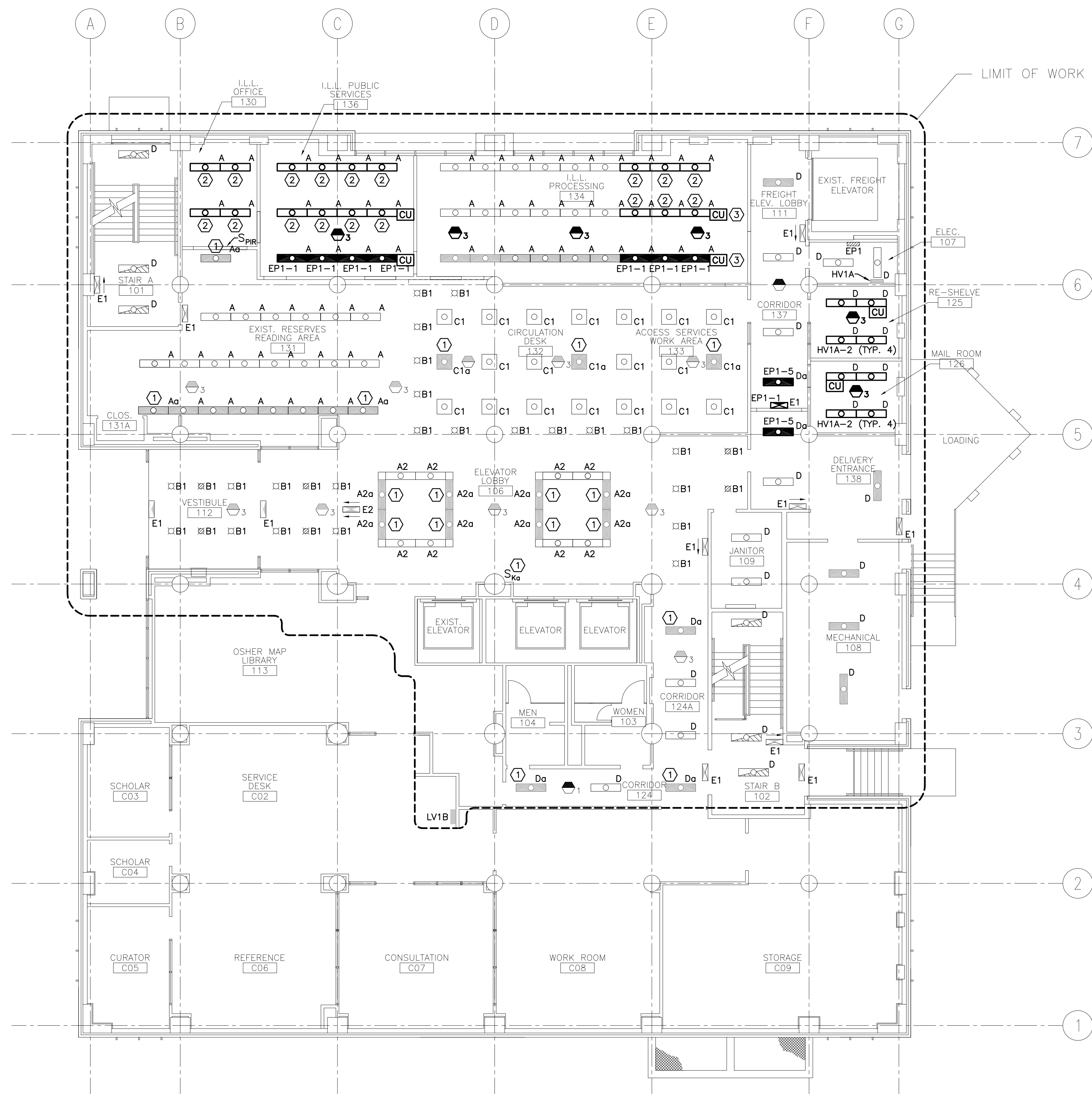

0	ISSUED FOR CONSTRUCTION	3-17-03
REV.	DESCRIPTION	DATE

**ISSUED FOR CONSTRUCTION**  
3-17-03

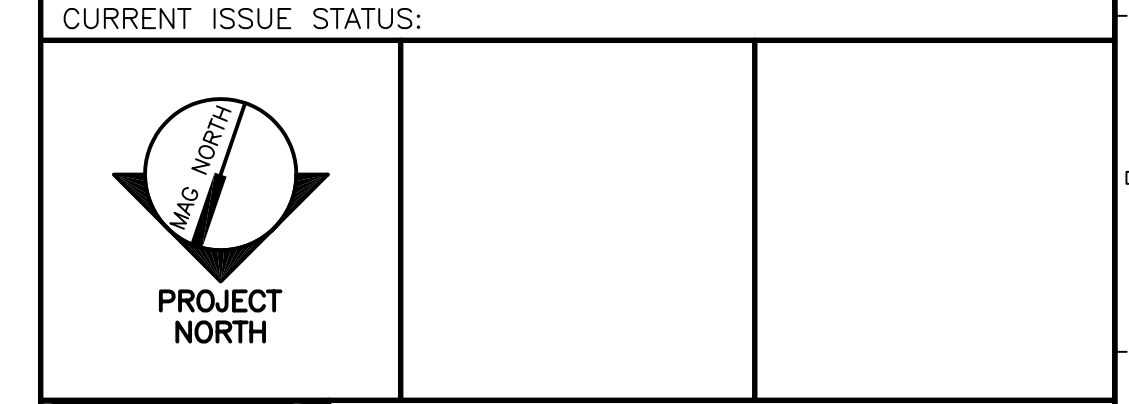

ARCHITECTURE ENGINEERING PLANNING  
SMRT  
144 Fore Street/P.O. Box 618  
Portland, Maine 04104  
tel. (207) 772-3846  
fax. (207) 772-1070

**GLICKMAN LIBRARY**  
UNIVERSITY OF SOUTHERN MAINE  
PORTLAND, MAINE

**FIRST FLOOR & BASEMENT LIGHTING PLAN**

SHEET TITLE:	1/8"=1'-0"	DATE:
PROJECT MANAGER:	SLB	GRAPHIC SCALE:
JOB CAP/DRAWN:	CTB/JAC	
A/E OF RECORD:	JPP	SHEET No.
SMRT CAD FILE:	EL101-99092	
PROJECT No.	99092	<b>EL101</b>

**A1** BASEMENT PART PLAN  
1/8"=1'-0"

**A5** FIRST FLOOR PLAN  
1/8"=1'-0"