

DISPLAY THIS CARD ON PRINCIPAL FRONTAGE OF WORK

CITY OF PORTLAND

BUILDING INSPECTION

PERMIT

Permit Number: 041180

Please Read
Application And
Notes, If Any,
Attached

This is to certify that Roberts Christopher & /Applicant

has permission to add Bedroom, Garage, Garden Shed

AT 379 Island Ave

090 N002001

provided that the person or persons who accept this permit shall comply with all of the provisions of the Statutes of the State and of the Ordinances of the City of Portland regulating the construction, maintenance and use of buildings and structures, and of the application on file in this department.

Apply to Public Works for street line and grade if nature of work requires such information.

Notification of inspection must be given and when permission is procured before this building or part thereof is occupied or otherwise closed-in. FOUR NOTICES REQUIRED.

A certificate of occupancy must be procured by owner before this building or part thereof is occupied.

OTHER REQUIRED APPROVALS

Fire Dept. _____

Health Dept. _____

Appeal Board _____

Department Name

Janine Bourke 9/8/04
Director - Building & Inspection Services

PENALTY FOR REMOVING THIS CARD

City of Portland, Maine - Building or Use Permit Application

389 Congress Street, 04101 Tel: (207) 874-8703, Fax: (207) 874-8716

Permit No: 04-1180	Issue Date:	CBL: 090 N002001
-----------------------	-------------	---------------------

Location of Construction: 379 Island Ave	Owner Name: Roberts Christopher &	Owner Address: 379 Island Ave	Phone:
Business Name:	Contractor Name: Applicant	Contractor Address: Portland	Phone:
Lessee/Buyer's Name	Phone:	Permit Type: Amendment to Single Family	Zone: IR-2

Past Use: Single Family Home	Proposed Use: <i>single family</i> Amendment to Permit #031424 - add Bedroom <i>Bedroom</i> Garage Garden Shed <i>Bedroom addition</i>	Permit Fee: \$156.00	Cost of Work: \$15,000.00	CEO District: 2
Proposed Project Description: add Bedroom <i>Bedroom</i> , Garage, Garden Shed <i>Bedroom Addition</i>		FIRE DEPT: <input type="checkbox"/> Approved <input type="checkbox"/> Denied INSPECTION: Use Group: <i>R3</i> Type: <i>5B</i> <i>BOCA 499</i> Signature: <i>JMB 9/9/04</i>		Signature:

PEDESTRIAN ACTIVITIES DISTRICT (P.A.D.)	
Action: <input type="checkbox"/> Approved <input type="checkbox"/> Approved w/Conditions <input type="checkbox"/> Denied	Signature: _____ Date: _____

Permit Taken By: Idobson	Date Applied For: 08/17/2004	Zoning Approval
-----------------------------	---------------------------------	------------------------

1. This permit application does not preclude the Applicant(s) from meeting applicable State and Federal Rules. 2. Building permits do not include plumbing, septic or electrical work. 3. Building permits are void if work is not started within six (6) months of the date of issuance. False information may invalidate a building permit and stop all work..	Special Zone or Reviews <input type="checkbox"/> Shoreland <input type="checkbox"/> Wetland <input type="checkbox"/> Flood Zone <input type="checkbox"/> Subdivision <input type="checkbox"/> Site Plan Maj <input type="checkbox"/> Minor <input type="checkbox"/> MM <input type="checkbox"/> Date: <i>JMB 9/9/04</i>	Zoning Appeal <input type="checkbox"/> Variance <input type="checkbox"/> Miscellaneous <input type="checkbox"/> Conditional Use <input type="checkbox"/> Interpretation <input type="checkbox"/> Approved <input type="checkbox"/> Denied Date: _____	Historic Reservation <input type="checkbox"/> Not in District or Landmark <input checked="" type="checkbox"/> Does Not Require Review <input type="checkbox"/> Requires Review <input type="checkbox"/> Approved <input type="checkbox"/> Approved w/Conditions <input type="checkbox"/> Denied Date: <i>JMB</i>
	<i>approved</i> <i>same conditions as orig permit #03-1424</i>		

CERTIFICATION

I hereby certify that I am the owner of record of the named property, or that the proposed work is authorized by the owner of record and that I have been authorized by the owner to make this application as his authorized agent and I agree to conform to all applicable laws of this jurisdiction. In addition, if a permit for work described in the application is issued, I certify that the code official's authorized representative shall have the authority to enter all areas covered by such permit at any reasonable hour to enforce the provision of the code(s) applicable to such permit.

SIGNATURE OF APPLICANT ADDRESS DATE PHONE

RESPONSIBLE PERSON IN CHARGE OF WORK, TITLE DATE PHONE

City of Portland, Maine - Building or Use Permit

389 Congress Street, 04101 Tel: (207) 874-8703, Fax: (207) 874-8716

Permit No: 04-1180	Date Applied For: 08/17/2004	CBL: 090 N002001
------------------------------	--	----------------------------

Location of Construction: 379 Island Ave	Owner Name: Roberts Christopher &	Owner Address: 379 Island Ave	Phone:
Business Name:	Contractor Name: Applicant	Contractor Address: Portland	Phone:
Lessee/Buyer's Name	Phone:	Permit Type: Amendment to Single Family	

Proposed Use: Single Family Amend Permit #031424 - add Bathroom, Garage Addition, Garden Shed	Proposed Project Description: Amend permit W3-1424 add Bathroom, Garage Addition, Garden Shed
---	---

Dept: Zoning	Status: Approved	Reviewer: Jeanine Bourke	Approval Date: 09/09/2004
Note: 9/8/04 left vm w/Chris R. To clarify the plans. 9/9 spoke w/ Chris R. Ok to issue			Ok to Issue: <input type="checkbox"/>
<ol style="list-style-type: none"> 1) The existing garage is remaining in the same footprint, rotted sills replaced and new gable roof on existing walls. 2) This is NOT an approval for an additional dwelling unit. You SHALL NOT add any additional kitchen equipment including, but not limited to items such as stoves, microwaves, refrigerators, or kitchen sinks, etc. Without special approvals. 3) This property shall remain a single family dwelling. Any change of use shall require a separate permit application for review and approval. 4) This permit is being approved on the basis of plans submitted. Any deviations shall require a separate approval before starting that work. 			

Dept: Building	Status: Approved	Reviewer: Jeanine Bourke	Approval Date: 09/09/2004
Note:			Ok to Issue: <input type="checkbox"/>
<ol style="list-style-type: none"> 1) Permit approved based on the plans submitted and reviewed w/owner/contractor, with additional information as agreed on and as noted on plans. 2) Separate permits are required for any electrical, plumbing, or heating. 			

All Purpose Building Permit Application

If you or the property owner owes **real estate** or personal property **taxes** or **user charges** on any property within the City, payment arrangements must be made **before** permits of any kind are accepted.

Location/Address of Construction: <u>374 Island Ave</u>		
Total Square Footage of Proposed Structure		Square Footage of Lot
Tax Assessor's Chart, Block & Lot Chart# <u>90</u> Block# <u>N</u> Lot# <u>2</u>		Owner: <u>CHRISTOPHER ROBERTS</u> Telephone: <u>766-5819</u>
Lessee/Buyer's Name (If Applicable)	Applicant name, address & telephone: <u>CHRISTOPHER ROBERTS</u> <u>766-5819</u>	cost Of Work: \$ <u>15,000</u> Fee: \$ <u>156.00/100</u>
<p><u>Amend</u></p> <p style="text-align: right;">NOV 9 1 5</p>		
Who should we contact when the permit is ready: <u>C. ROBERTS (766 5819)</u> Mailing address: <u>374 ISLAND AVE</u> <u>PEAKS ISLAND ME 09108</u>		
We will contact you by phone when the permit is ready . You must come in and pick up the permit and review the requirements before starting any work, with a Plan Reviewer. A stop work order will be issued and a \$100.00 fee if any work starts before the permit is picked up, PHONE:		

IF THE REQUIRED INFORMATION IS NOT INCLUDED IN THE SUBMISSIONS THE PERMIT WILL BE AUTOMATICALLY DENIED AT THE DISCRETION OF THE BUILDING/PLANNING DEPARTMENT, WE MAY REQUIRE ADDITIONAL INFORMATION IN ORDER TO APPROVE THIS PERMIT.

I hereby certify that I am the Owner of record of the named property, or that the owner of record authorizes the proposed work and that I have been authorized by the owner to make this application as his/her authorized agent. I agree to conform to all applicable laws of this jurisdiction. In addition, if a permit for work described in this application is issued, I certify that the Code Official's authorized representative shall have the authority to enter all areas covered by this permit at any reasonable hour to enforce the provisions of the codes applicable to this permit.

Signature of applicant: *Christopher Roberts* Date: 08/16/04

This is NOT a permit, you may not commence ANY work until the permit is issued. If you are in a Historic District you may be subject to additional permitting and fees with the Planning Department on the 4th floor of City Hall

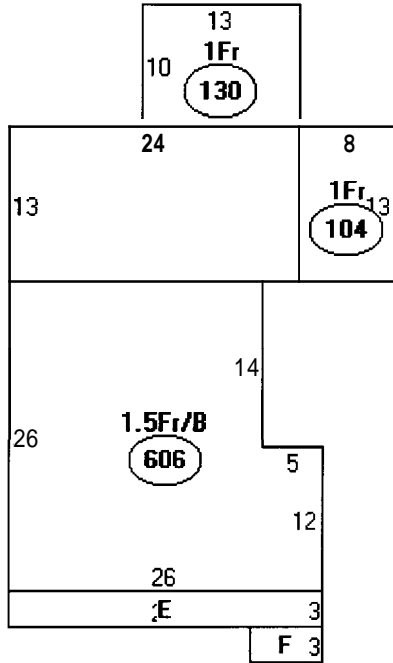

Descriptor/Area

- A: 1.5Fr/B
606 sqft
- B: 1Fr
312 sqft
- C: 1Fr
130 sqft
- D: 1Fr
104 sqft
- E: 1Fr/B
78 sqft
- F: EP
18 sqft

1,248

Correction
9/8/04 Previous expansion
03-1424
42%

1,248 SF
x 80%

998.4

Originally 416 SF Expansion
130 New expansion

546 SF

$\frac{546}{998.4} > 55\%$
OK