

C:\Users\CAD\Dropbox\Projects\Gorrill-Palmer\2970 - Marginal Way Bangor Savings\DWG\2970-GRADING.dwg - 6/29/2015 2:01 PM

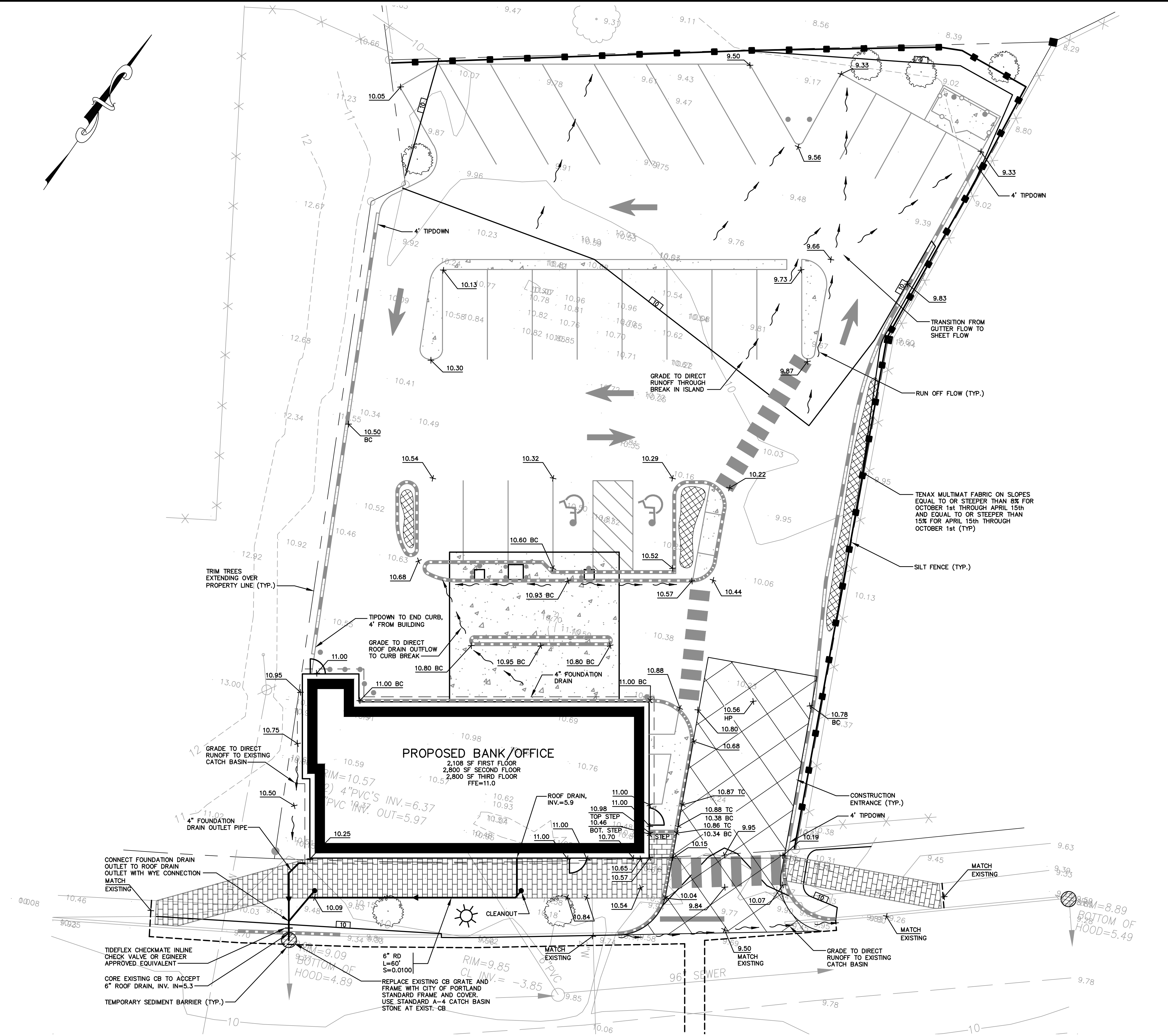

NOTE: THIS PLAN SET IS ISSUED FOR PERMITTING PURPOSES AND SHALL NOT BE USED FOR CONSTRUCTION.

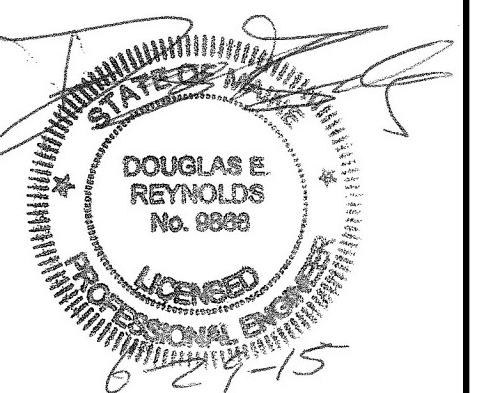
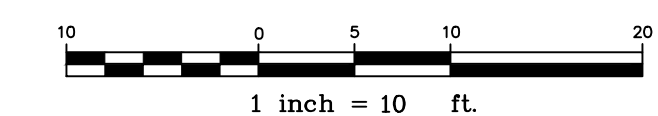

Rev.	Date	Revision

Issued For	Date	By
RESPONSE TO CITY COMMENTS	6/29/15	DER
PRICING	6/05/15	AMP
SITE PLAN REVIEW	5/13/15	AMP
CLIENT REVIEW	4/13/15	AMP

Design: AMP Draft: CG Date: DEC 2014
 Checked: AMP Scale: 1"=10' Job No.: 2970
 File Name: 2970-GRADING.dwg
 This plan shall not be modified without written permission from Gorrill-Palmer Consulting Engineers, Inc.(GPCEI). Any alterations, authorized or otherwise, shall be at the user's sole risk and without liability to GPCEI.

GORRILL PALMER

Relationships. Responsiveness. Results.
www.gorrillpalmer.com
 207.657.6910

Drawing Name:	Grading, Drainage, and Erosion Control Plan
Project:	Bangor Savings Bank 20 Marginal Way, Portland, Maine
Client:	Bangor Savings Bank 99 Franklin Street, Bangor, Maine 04401

Drawing No.
C102