

**1 PROPOSED FURNITURE PLAN**  
1/8"=1'-0"

EXISTING FURNITURE  
POWER IN LOCATION

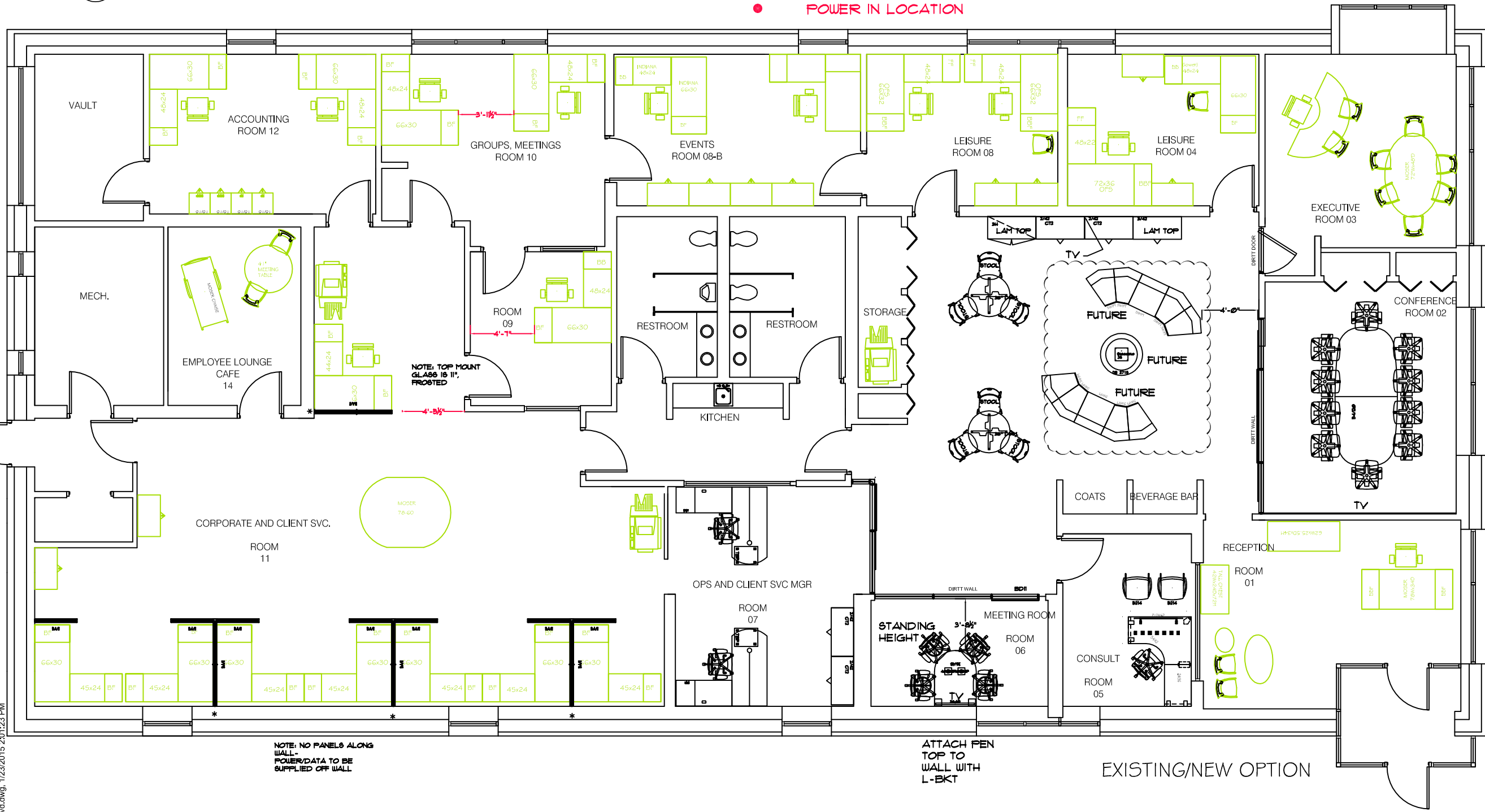

NOTE: NO PANELS ALONG WALL - POWER/DATA TO BE SUPPLIED OFF WALL

ATTACH PEN TOP TO WALL WITH L-BKT

EXISTING/NEW OPTION



141 MIDDLE STREET  
PORTLAND, ME 04101  
207-775-7100

HURLEY TRAVEL  
15 BAXTER BLVD  
PORTLAND, ME

SCALE  
1/8"=1'-0"

DATE  
12/17/13

DRAWN BY  
ALM

SALES  
SW

REVISIONS  
1/16/14  
1/17/14  
1/23/14  
10/2/14  
1/8/15  
1/9/15  
1/15/15  
1/20/15

FURNITURE PLAN

DWG NAME  
HURLEY TRAVEL BAXTER BLVD

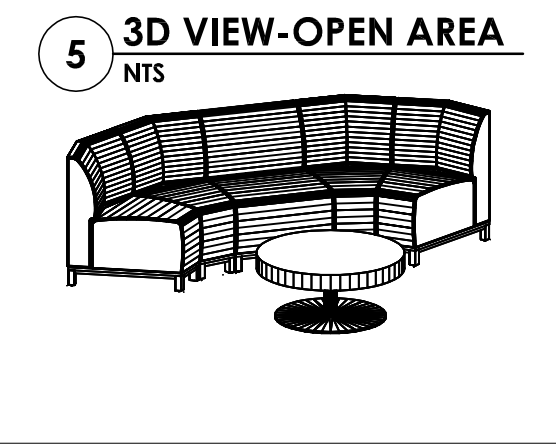
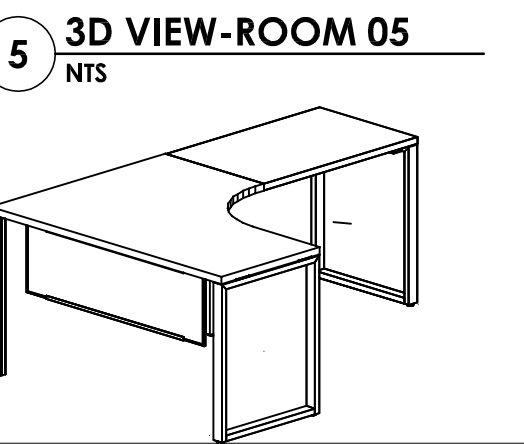
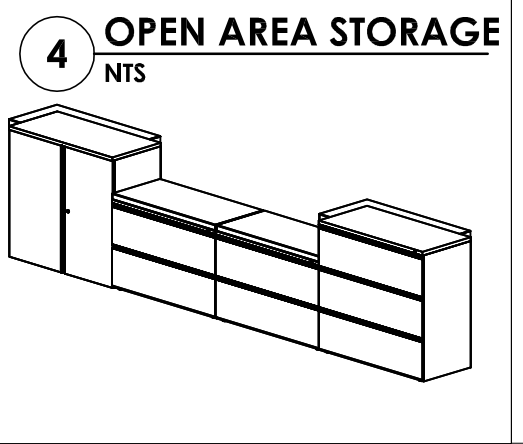
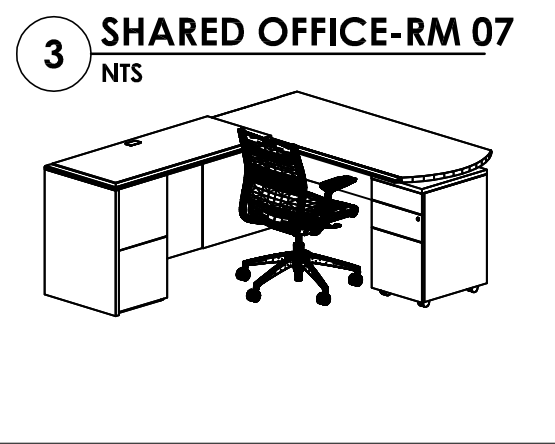
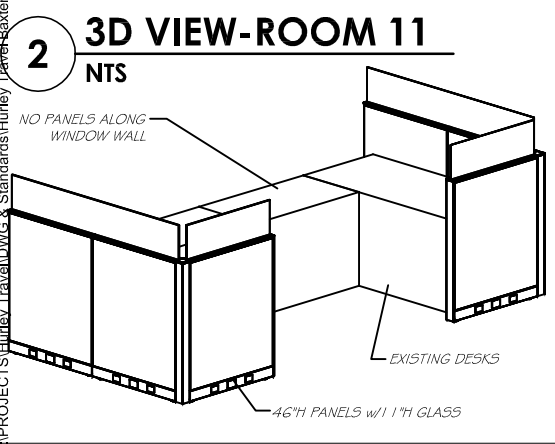

L:\PROJECTS\Hurley\_Travel\DWG & Standards\Hurley\_Travel\Baxter.dwg, 1/23/2015 2:01:23 PM