

3 Typical Platform Section and Railing
SCALE: 1/2" = 1'-0"

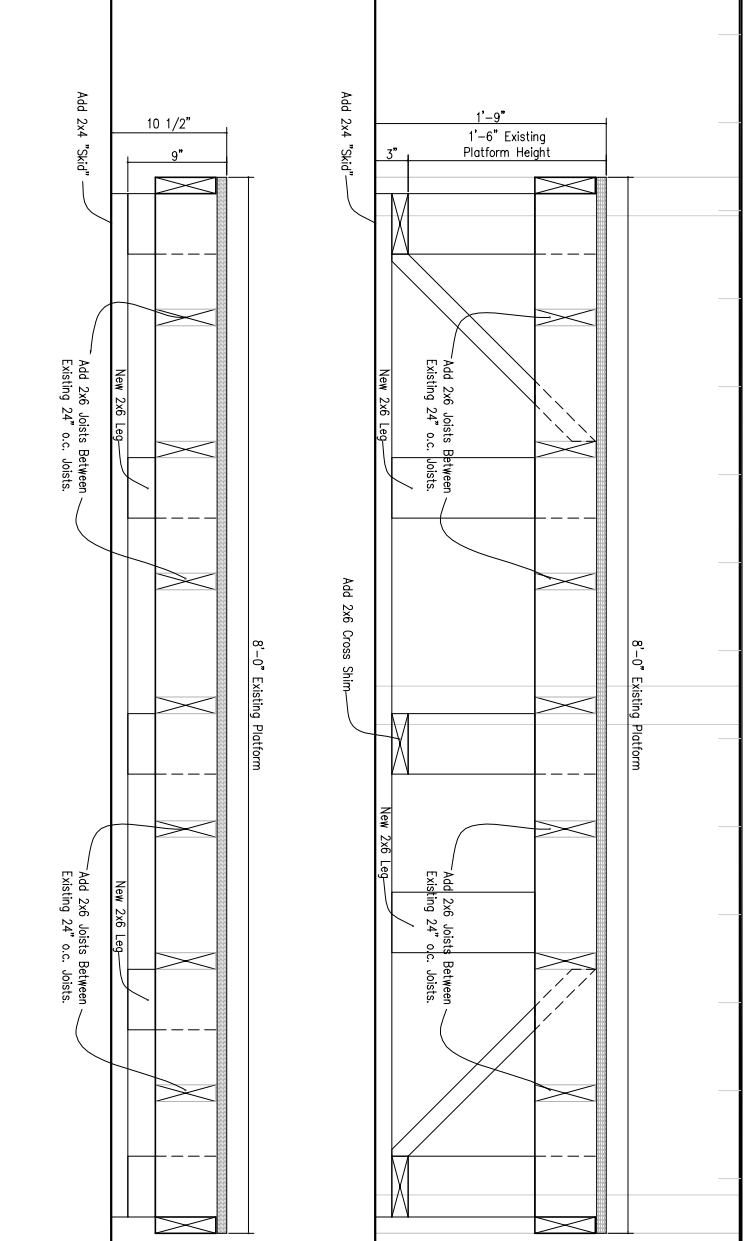
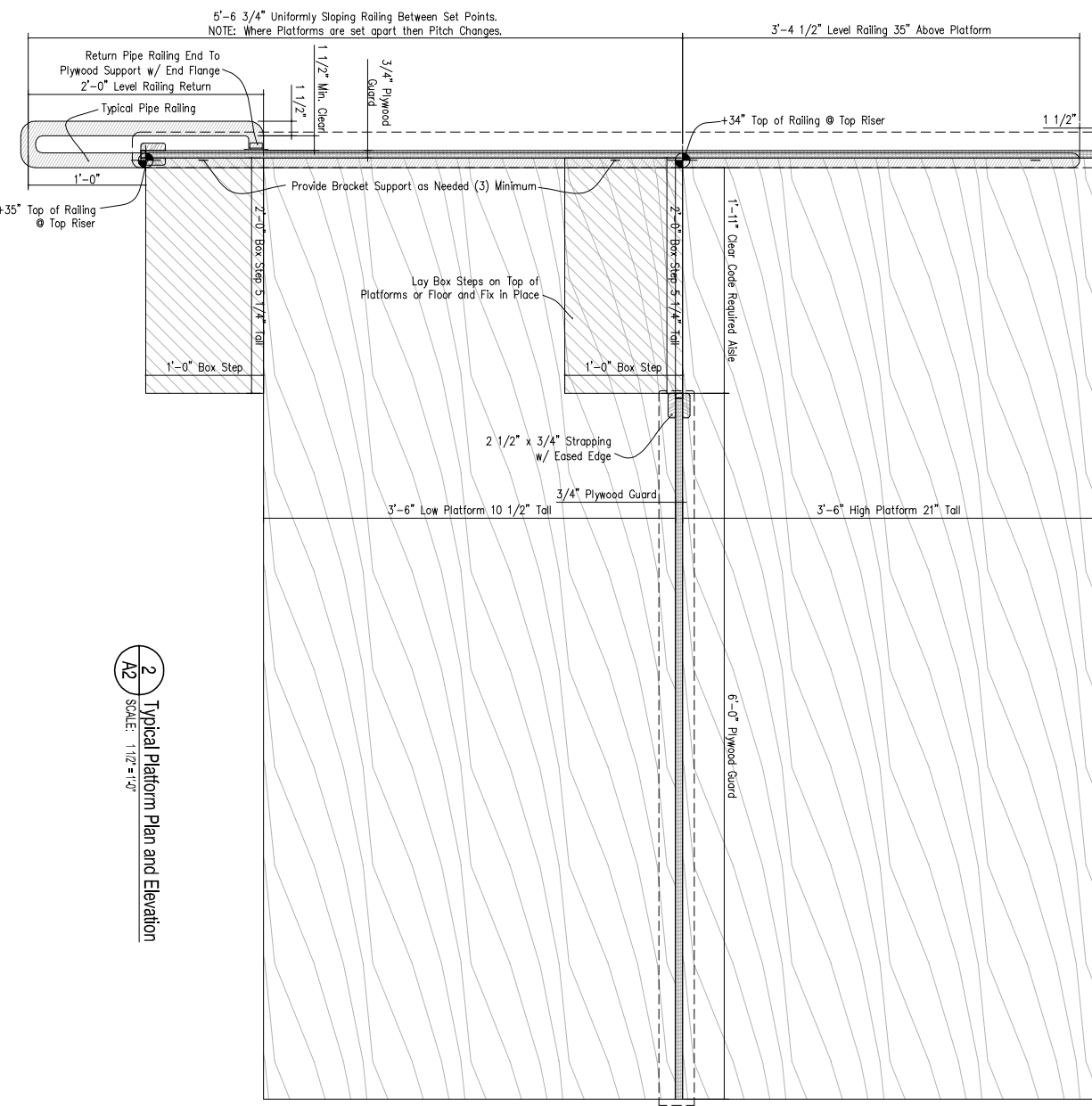
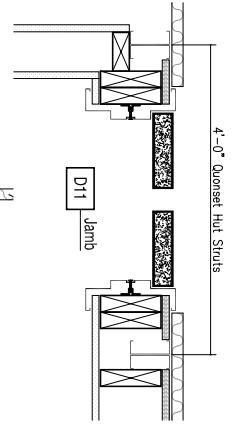
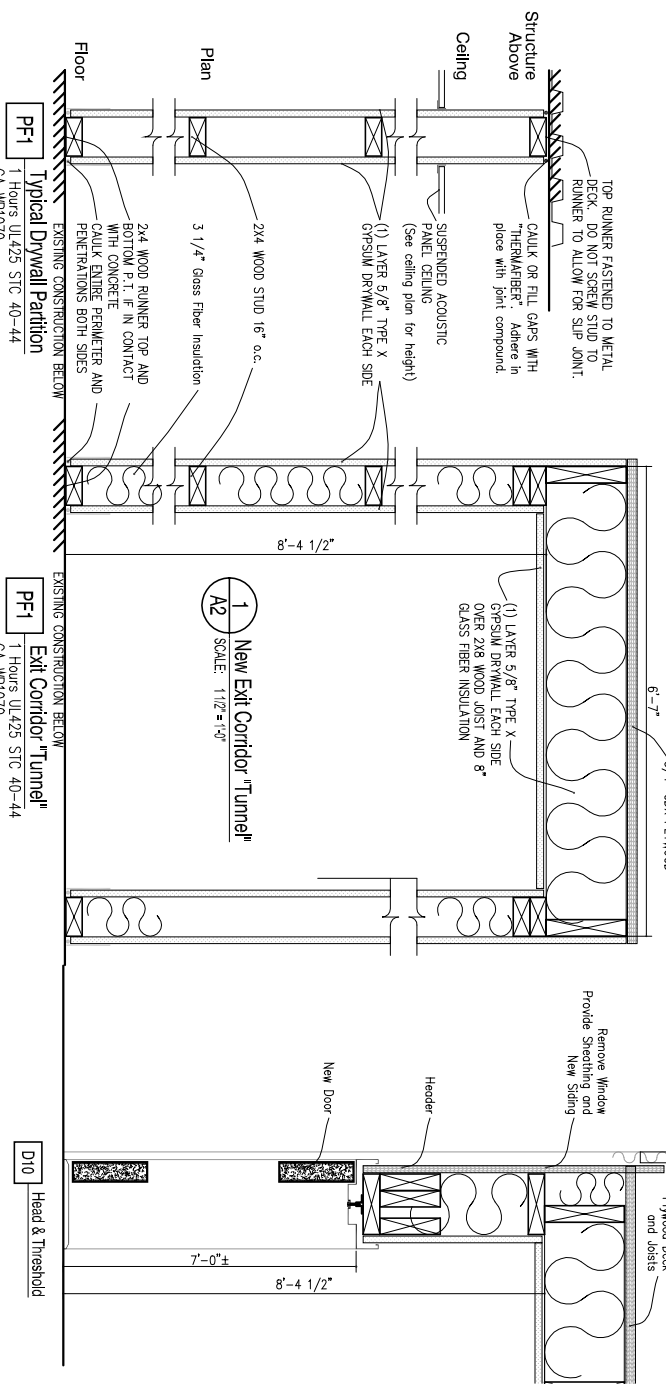
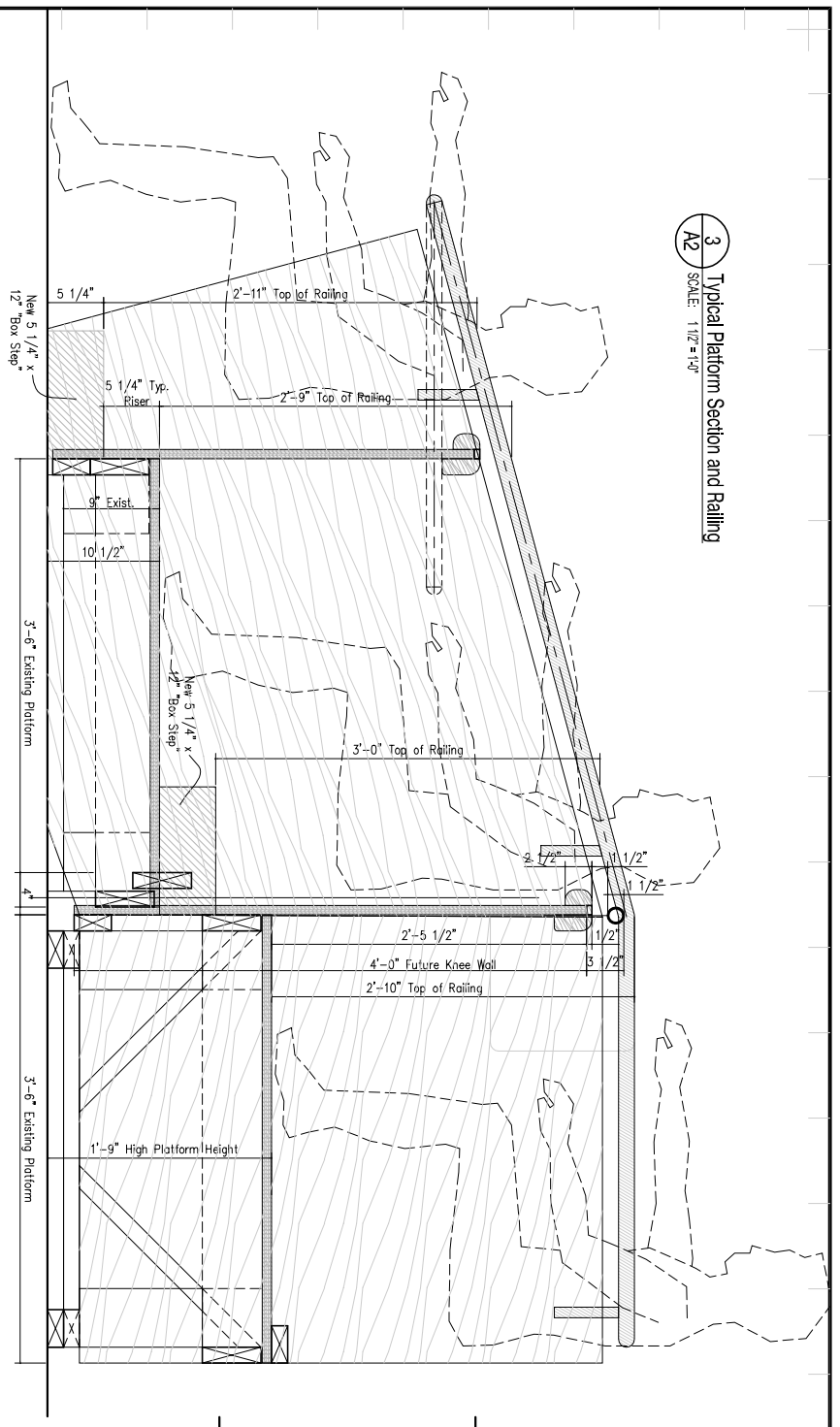

A2
sheet number

CONSTRUCTION SET

Lucid Stage Baxter Boulevard Extension, Portland ME		revision #/ date	Revision Reason
Platform and Miscellaneous Details		date	10-19-10
		drawn by	1/4" = 1'-0"



Clyde Blackwell Architect
Tel. (207) 871-9904
361 Ludlow Street, Portland ME 04102