

LEGEND

EXISTING	PROPOSED
--- PROPERTY LINE	--- LEASED PARKING BOUNDARY
--- ADJUTERS PROPERTY	--- CITY OF PORTLAND EASEMENT
--- EDGE OF PAVEMENT	--- CONTOUR
--- CURBS	--- SURFACE DRAINAGE DIRECTION
--- CHAIN LINK FENCE	--- PARKING PAVEMENT REPLACEMENT
--- LIGHT POLE	--- PARKING PAVEMENT OVERLAY
--- OVERHEAD UTILITY	--- PARKING FULL DEPTH CONSTRUCTION
--- OVERHEAD ELECTRICAL	--- CATCH BASIN PROTECTION WITH SILTBACK
--- CATCH BASIN	
--- POSSIBLE DRAIN MANHOLE	
--- UTILITY POLE	
--- UTILITY POLE W/ GUY WIRE SIGN	
--- CHAIN LINK FENCE	
--- BUILDING	
--- IRON PIPE OR ROD FOUND	
--- CONTOUR	
--- BUILDING	
--- EDGE OF GRAVEL	

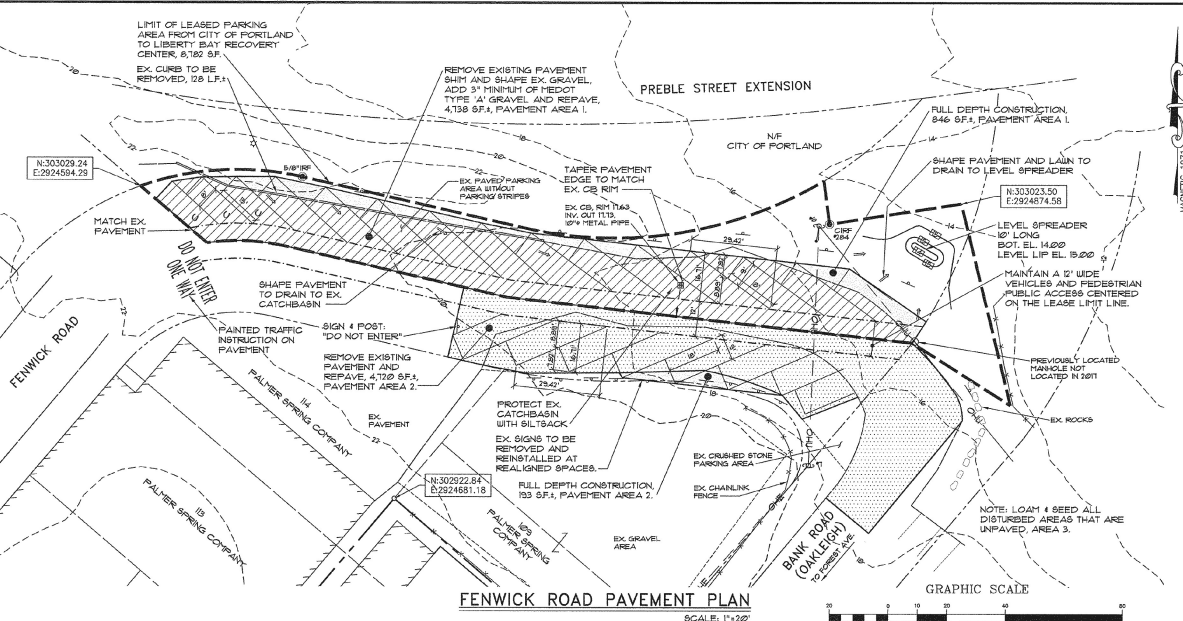

FENWICK ROAD PAVEMENT PLAN
SCALE: 1"=20'

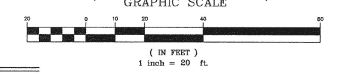

EROSION CONTROL NOTES

GENERAL:

- THE DRAWINGS DEPICT THE REQUIRED SOIL EROSION CONTROL MEASURES THE CONTRACTOR IS RESPONSIBLE FOR MAINTAINING THE CONSTRUCTION SITE IN SUCH A MANNER THAT:
 - SOIL EROSION IS KEPT TO A MINIMUM.
 - NO SEDIMENT LEAVES THE CONSTRUCTION SITE PROPER.
 - ALL POSSIBLE MEASURES ARE EMPLOYED TO PREVENT SEDIMENT FROM ENTERING DRAINAGE COURSES AND WETLANDS EVEN BEYOND THE DETAILS SHOWN ON THIS PLAN IF NECESSARY.
- ALL EROSION CONTROL MEASURES SHALL BE CONSTRUCTED AND MAINTAINED IN ACCORDANCE WITH THE MAINE EROSION AND SEDIMENT CONTROL BMPs PUBLISHED BY THE BUREAU OF LAND AND WATER QUALITY, MAINE DEPARTMENT OF ENVIRONMENTAL PROTECTION, OCTOBER 2004.
- THE CONTRACTOR IS RESPONSIBLE FOR ALL FINES RESULTING FROM EROSION OR SEDIMENTATION FROM THE SITE TO SURROUNDING PROPERTIES, WATERBODIES, OR WETLAND AS A RESULT OF THIS PROJECT.
- LOAM AND SEED ALL DISTURBED AREAS AS SOON AS POSSIBLE AFTER DISTURBANCE, BUT NO LONGER THAN 1 DAY. LOAM AND SEED ANY DISTURBED AREA WITHIN 15% OF WETLANDS OR WATERBODIES WITHIN 48 HOURS OR PRIOR TO AND STORE EVENT. USE WINTER SEED RATES AND SPECIFICATIONS IF APPROPRIATE.
- INSPECT SOIL EROSION MEASURES WEEKLY AND AFTER SIGNIFICANT STORM EVENTS. MAKE ALL NECESSARY REPAIRS TO FACILITIES AS SOON AS POSSIBLE, BUT NO LONGER THAN 2 DAYS. CLEAN AND RESET SILT FENCES AND STONE CHECK DAMS WHICH ACCUMULATE SEDIMENT AND DEBRIS.
- PROTECT AND STABILIZE ALL AREAS NOT SCHEDULED FOR EROSION PREVENTION OR STABILIZATION BUT THAT SHOW SIGNS OF EROSION. NOTIFY OWNER OF ANY SIGNIFICANT EROSION PROBLEMS.
- APPLY MULCH TO BARE SOILS WITHIN 7 DAYS OF INITIAL DISTURBANCE OF SOILS WITHIN 48 HOURS IF WITHIN 15% OF WETLAND OR WATERBODY, PRIOR TO ANY RAIN EVENT, OR PRIOR TO ANY WORK SHUTDOWN LASTING MORE THAN ONE DAY.
 - TEMPORARILY SEED WITHIN 7 DAYS ANY AREA WHICH WILL BE LEFT DISTURBED AND UNWORKED FOR MORE THAN 14 DAYS WITH THE TEMPORARY SEED MIX LISTED BELOW. IF AREA IS WITHIN 15% OF A WETLAND OR WATERBODY, SEED WITHIN 48 HOURS. PERMANENT SEED ANY AREA WHICH CAN BE LOADED AS SOON AS POSSIBLE WITH THE PERMANENT SEED MIX LISTED BELOW. DO NOT USE PERMANENT SEED MIX AFTER SEPTEMBER 15.
 - MULCH ALL AREAS SEEDED SO THAT SOIL IS NOT VISIBLE THROUGH THE MULCH REGARDLESS OF THE APPLICATION RATE. DURING THE GROWING SEASON (APRIL 15 - SEPT. 30) USE EROSION CONTROL MESH (OR MULCH AND NETTING) ON:
 - SIDE SLOPES OF GRASSSED WATERWAYS
 - SLOPES STEEPER THAN 15%
 - WITHIN 100 FT. OF STREAMS AND WETLANDS
 - BETWEEN OCT. 1 AND APRIL 14 USE EROSION CONTROL MESH (OR MULCH AND NETTING) ON:
 - SIDE SLOPES OF GRASSSED WATERWAYS
 - SLOPES STEEPER THAN 15%
- PLACE AND GRADE LOAM IN A REASONABLY UNIFORM MANNER. WORK LINE AND FERTILIZER INTO THE SOIL TO A DEPTH OF 4 INCHES WITH A DISC, SPRING TOOTH HARROW OR OTHER SUITABLE EQUIPMENT. CONTINUE TILLAGE UNTIL A REASONABLY UNIFORM SEED BED IS PREPARED. REMOVE FROM SURFACE ALL STONES LARGER THAN 2" AND ALL OTHER UNSUITABLE MATERIAL. LIME AND FERTILIZER SHOULD BE MIXED INTO SOIL PRIOR TO ROLLING EXCEPT IF INCLUDED IN HYDROSEED MIXTURE. PERMANENT STABILIZATION OF REVEGETATED AREAS IS CONSIDERED AS 30% CATCH.
 - ALL CATCH BASINS, NEW OR EXISTING, THAT MAY RECEIVE RUNOFF FROM DISTURBED AREAS MUST BE PROTECTED BY INSTALLING AND MAINTAINING SILT BACKS DURING CONSTRUCTION.

TOPSOIL:

- SUITABLE TOPSOIL BALSAGED FROM SITE OR SCREENED, LOOSE AND FRIABLE SANDY LOAM OR LOAM AS DEFINED BY THE USDA SOIL CONSERVATION SERVICE CLASSIFICATION SYSTEM, FREE FROM ADMIXTURE OF SUBSOIL, REFUSE, LARGE STONES, CLODS, ROOTS, WEEDS, HAZARDOUS OR OTHER UNDESIRABLE FOREIGN MATTER AS DETERMINED BY THE INSPECTING AUTHORITY. CONTRACTOR SHALL SUBMIT REPORTS OF LOAM TEST RESULTS PERFORMED BY AN INDEPENDENT TESTING LABORATORY FOR TOPSOIL FROM DIFFERENT SOURCES PRIOR TO PLACING. THE COST OF TESTING SHALL BE INCIDENTAL TO THE COST OF TOPSOIL. TOPSOIL SHALL MEET THE FOLLOWING SPECIFICATIONS:
 - MATERIAL:
 - SAND - 0.075 IN. TO 0.25 IN. DIAMETER (% BY VOLUME) 45 - 75
 - SILT - 0.075 IN. TO 0.250028 IN. DIAMETER (% BY VOLUME) 20 - 40
 - CLAY - LESS THAN 0.250028 IN. DIAMETER (% BY VOLUME) 5 - 5
 - ORGANICS (SHALL MEET THE REQUIREMENTS OF MDOT STANDARD SPECIFICATION 111.02. GREAT HULLS) (% BY VOLUME) 10 - 20
 - NUTRIENTS:
 - CALCIUM (CA) (% SATURATION) 60 - 80
 - MAGNESIUM (MG) (% SATURATION) 10 - 25
 - POTASSIUM (K) (% SATURATION) 21 - 32
 - PHOSPHORUS (P) (FOUND/ACRE) 10 - 40
 - PH 6.0 - 6.5
 - PERMEABILITY (INCHES PER HOUR) 3 - 10
 - MAXIMUM STONE SIZE (INCHES) 3/4

SEEDING:

- USE PERMANENT SEED MIXES AND RATES BETWEEN 5/15 AND 5/20. USE TEMPORARY SEED MIXES FOR PERIODS LESS THAN 10 MONTHS. IF USING TEMPORARY SEED MIXES AND RATES BETWEEN 10/1 AND 5/14, RE-SEED WITH PERMANENT SEED MIX AFTER 3/15.

PERMANENT SEED:

MDOT 111.02(a) METHOD NUMBER 3

TEMPORARY SEED:		
OATS	80.00 LBS/ACRE	4/01 - 5/14
ANNUAL RYEGRASS	40.00 LBS/ACRE	
WINTER RYE	40.00 LBS/ACRE	5/15 - 8/14
ANNUAL RYEGRASS	80.00 LBS/ACRE	5/15 - 8/14
WINTER RYE	12.00 LBS/ACRE	9/15 - 9/30
WINTER RYE (W/ MULCH COVER)	12.00 LBS/ACRE	10/01 - 3/31

LIME AND FERTILIZER:

- APPLY GROUND LIMESTONE (EQUIVALENT TO 50% CALCIUM PLUS MAGNESIUM OXIDE) AT A RATE OF 3 TONS PER ACRE (30 POUNDS PER 1000 SQUARE FEET). APPLY FERTILIZER (10-20-20) AT A RATE OF 800 POUNDS PER ACRE (18.4 POUNDS PER 1000 SQUARE FEET).

MULCH:

- STRAW OR HAY (ANCHORED) 10 - 90 LBS
- STRAW OR HAY (ANCHORED) 100 - 275 LBS
- BARBED OR CHOPPED 100 - 275 LBS
- JUTE MESH AS REQUIRED
- EXCLESOR MAT AS REQUIRED

- PROTECTED AREAS WINDY AREAS
- MODERATE TO HIGH VELOCITY AREAS 4 STEEP SLOPES

MULCH ANCHORING

- PEG AND TWINE LIQUID ASPHALT
- MULCH NETTING WOOD CELLULOSE FIBER
- CHEMICAL TACK

HOUSEKEEPING NOTES

THIS PROJECT IS LOCATED IN THE CASCO BAY WATERSHED. PROTECTION OF THE GROUNDWATER QUALITY IS ENSURED BY HAVING GOOD HOUSEKEEPING PRACTICES AND MAINTENANCE OF THE STORMWATER SYSTEMS. SPILL PREVENTION MUST BE INCORPORATED INTO THE PLAN. OWNERS AND ALL CONTRACTORS INVOLVED IN THE PROJECT SHOULD FOLLOW THE FOLLOWING STEPS.

SUBCONTRACTORS, LAND OWNER AND BUSINESS OCCUPANTS SHOULD BE MADE AWARE OF POSSIBLE GROUNDWATER AND SURFACE WATER CONTAMINATION BASED ON THEIR ACTIONS.

DURING CONSTRUCTION:

- FOLLOW THE EROSION CONTROL MEASURES OUTLINED ON THE PLANS.
- DEVELOP A WASTE HANDLING PROGRAM THAT IDENTIFIES POTENTIAL CONTAMINATES THAT COULD BE INTRODUCED TO THE AQUIFER. FOLLOW HAZARDOUS WASTE RULES IF ANY ITEMS USED ARE CONSIDERED A HAZARDOUS WASTE. IT IS CRITICAL TO THE SITE THAT UNCONTROLLED RELEASES BE PREVENTED.
- THIS SITE MAY REQUIRE DEWATERING OF TRENCHES. DURING CONSTRUCTION, MONITOR STORMWATER RUNOFF FROM THE EQUIPMENT AND GROUND AREAS TO MINIMIZE CONTAMINATION OF GROUNDWATER.
- THE SPILLING OF PRODUCTS SUCH AS SMALL ENGINE FUEL, CLEANING PRODUCTS AND PAINTS NEED TO BE CLEANED UP.
- IDENTIFY ANY PRODUCTS THAT IF SPILLED WILL CREATE CONTAMINATION OF THE GROUNDWATER.
- MAINTAIN A LIST OF THE MATERIALS AND KEEP THE MSDS SHEETS AVAILABLE TO ALL EMPLOYEES.
- OIL ABSORBENT PADS SHOULD BE USED WHILE RENEWING EQUIPMENT. KEEP ABSORBENT PADS AVAILABLE FOR USE IN CLEAN UP OF PETROLEUM.
- POST THE NAMES AND CONTACT INFORMATION FOR THE EMPLOYEE RESPONSIBLE FOR ENVIRONMENTAL MATTERS AND THE NAMES AND CONTACT INFORMATION OF COMPANIES TO BE CALLED IN THE EVENT OF A SPILL.
- POST CONSTRUCTION:
- CONTINUE TO FOLLOW ALL GUIDELINES OUTLINED FOR CONSTRUCTION.
- THE USE OF FERTILIZERS AND PESTICIDES SHOULD BE DONE CAUTIOUSLY AND IN ACCORDANCE WITH MANUFACTURERS RECOMMENDATIONS.
- THE MAINTENANCE OF THE LANDSCAPING AND PARKING LOTS SHOULD INCLUDE THE BEEPING OF THE PARKING LOTS AND REMOVAL OF THE MATERIALS THAT MAY CAUSE DISTURBANCE.
- AS PART OF EMPLOYEE TRAINING, INFORM EMPLOYEES OF THE PROCEDURES FOR RESPONSE TO ENVIRONMENTAL MATTERS.

PINKHAM & GREER CIVIL ENGINEERS
100 STATE ST., SUITE 200
PORTLAND, ME 04103
TEL: 603.771.1111
FAX: 603.771.1112

THOMAS G. GREER
REGISTERED PROFESSIONAL ENGINEER
NO. 11317
11/13/17

NO.	REVISION	DATE	DESCRIPTION
1	REVISED PER STAFF REVIEW	7/20/17	REV
2	REVISED PER STAFF REVIEW	7/20/17	REV
3	REVISED PER STAFF REVIEW	7/20/17	REV
4	REVISED PER STAFF REVIEW	7/20/17	REV

LIBERTY BAY RECOVERY CENTER
855 FOREST AVENUE
PORTLAND, ME 04103

SCALE: AS SHOWN
DATE: APRIL 10, 2017
PROJECT: 17123

DRN BY: RJS
DESIGN BY: TSG
CHECK BY: TSG

SITE IMPROVEMENTS
343 FOREST AVENUE
PORTLAND, MAINE

PARKING PLAN