

FOREST AVE.

DEERFIELD RD

FENWICK ROAD

ROAD

BANK OAKLEIGH

Note: Give grade for grading job B.5000
Make check 9-

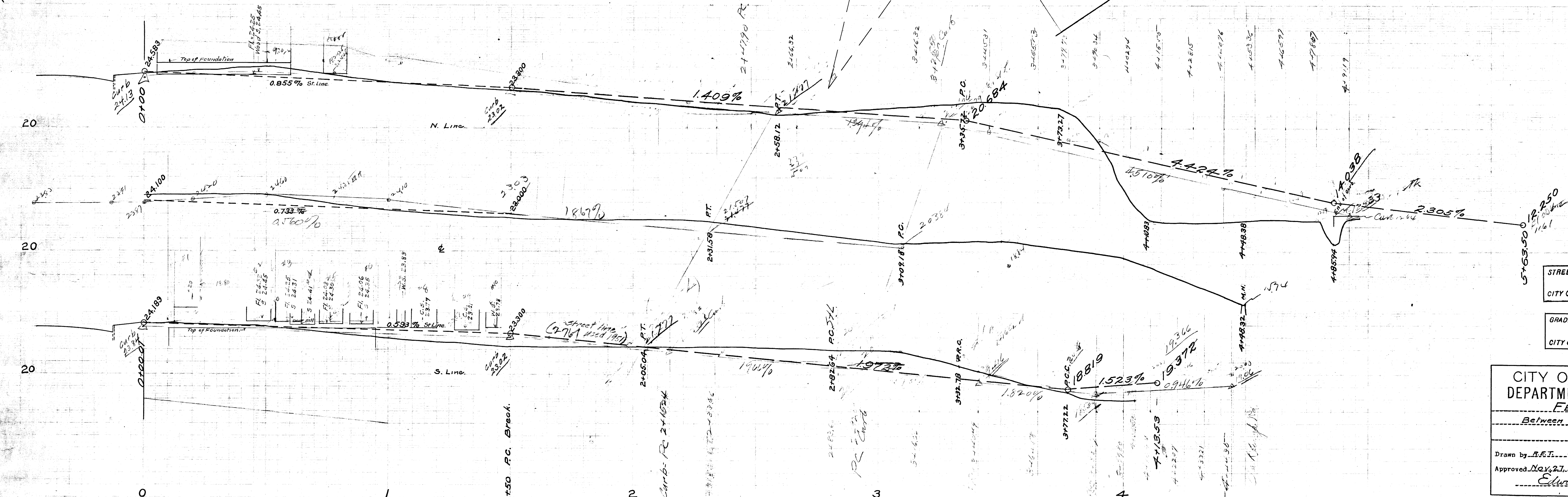

STREET ACCEPTED BY ORDER OF CITY COUNCIL,
PASSED DEC. 9, 1931.
CITY OF PORTLAND RECORDS, VOL. 57, PAGE 335.

GRADE ESTABLISHED BY ORDER OF CITY COUNCIL,
PASSED DEC. 9, 1931.
CITY OF PORTLAND RECORDS, VOL. 57, PAGE 336.

CITY OF PORTLAND, ME.
DEPARTMENT OF PUBLIC WORKS.
FENWICK ROAD
Between Forest Ave & Oakleigh Road
Scale 1" = 20 ft.
Drawn by R.E.T. Traced by R.E.T. Directed by S.H.M.
Approved Nov. 27, 1931.
Edward M. Hunt
City Engineer

255
12