

**1**  
A1.3 **KITCHEN PLAN**  
SCALE: 1/4" = 1'-0"

**EQUIPMENT SCHEDULE**

MK.	QTY	DESCRIPTION
1	2	UTILITY CART
2	5	SHELVING UNIT
3	2	HAND SINK
4	1	SINK, 3-COMPARTMENT
5	1	DISHWASHER, UNDERCOUNTER
6	1	MOP SINK CABINET
7	2	SHELVING UNIT
8	1	REFRIGERATOR, 2-SECTION
9	1	FREEZER, 2-SECTION
10	1	REFRIGERATOR, 2-SECTION
11	1	SHEET PAN RACK
12	1	EXHAUST HOOD
13	1	RANGE, 4-BURNER, 36"-GRIDDLE
14	1	FRYER DUMP STATION
15	1	FRYER, DEEP FAT
16	1	WORK TABLE WITH SINK
17	2	SHELVING UNIT
18	1	PLATE DISPENSER
19	1	HOT FOOD WELLS
20	2	FOOD PROTECTOR
21	1	COLD FOOD WELL
22	1	SINK, DROP-IN
23	1	HOT BEVERAGE DISPENSER
24	1	JUICE DISPENSER

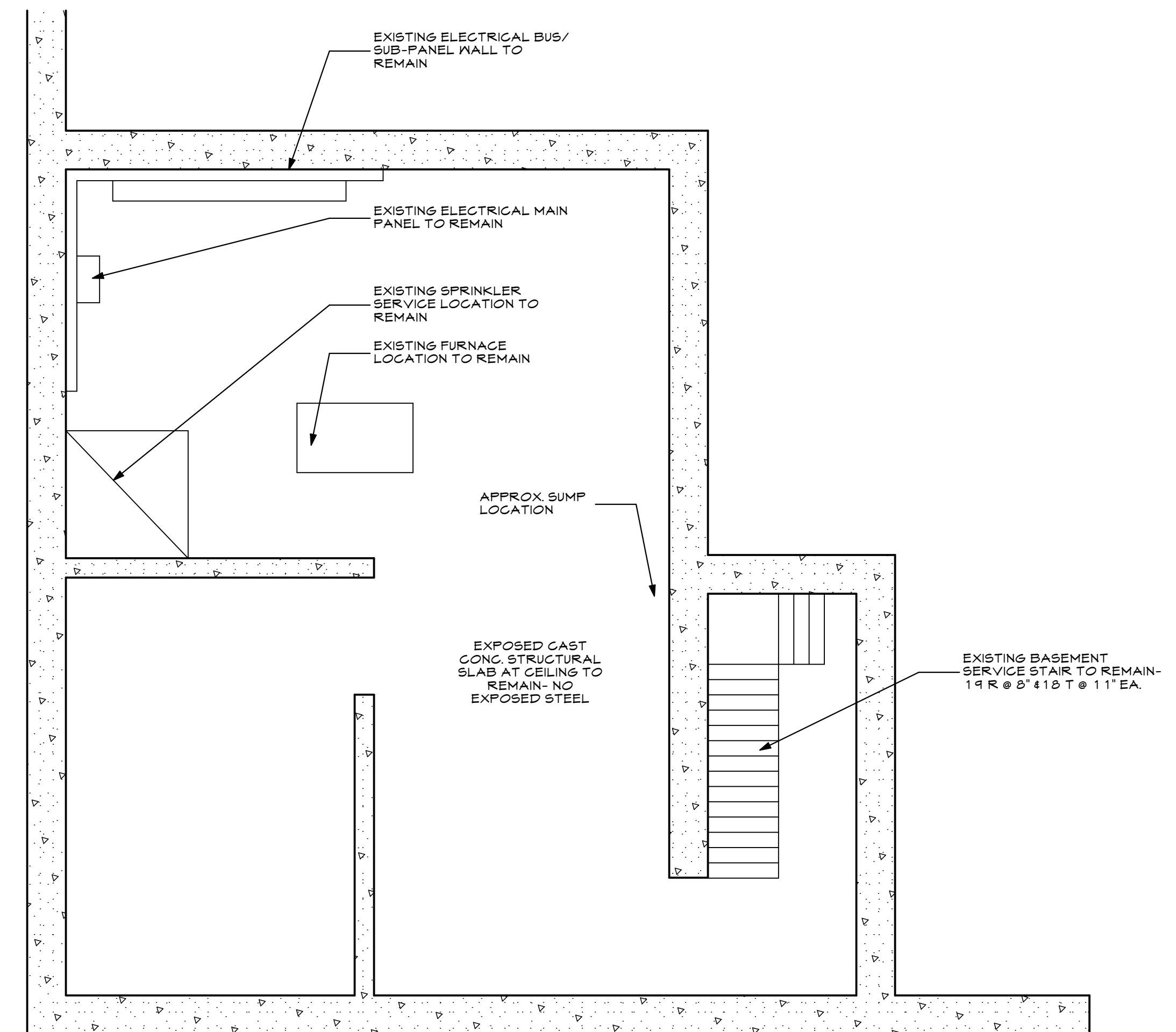

**2**  
A1.3 **BASEMENT PLAN**  
SCALE: 3/16" = 1'-0"  
**PERMIT SUBMITTAL 6.24.17**

**LIBERTY BAY**  
349 FOREST AVENUE PORTLAND, MAINE 04101

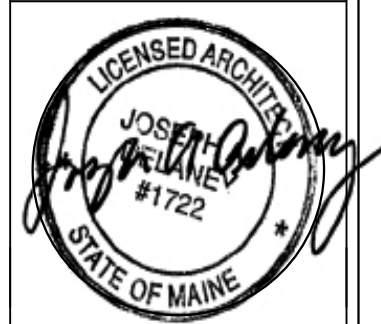

**WHIPPLE CALLENDER ARCHITECTS**

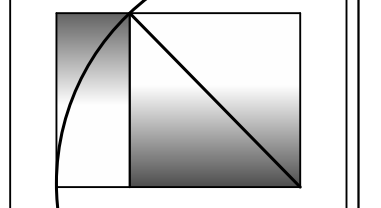

136 PLEASANT AVE.  
PORTLAND, ME 04103  
P 207.775.2696  
F 207.775.3631  
www.whipplecallender.com

MARK	DATE	DESCRIPTION
1	6.24.17	PERMIT SUBMITTAL SFMO
	7.17.17	REVISIONS

DATE: 7/17/17 SFMO APPLICATION SET  
CHECKED BY: JAD  
DRAWN BY: CLBC  
JOB: LIB 2017  
SHEET TITLE:

**KITCHEN PLAN**

**A1.3**