

DISPLAY THIS CARD ON PRINCIPAL FRONTAGE OF WORK



CITY OF PORTLAND BUILDING PERMIT

This is to certify that **WILLIAM C MCMURRAY**

Located At **11 DEERFIELD RD**

Job ID: **2012-10-5245-ALTR**

CBE: **112-A-012-001**

has permission to 1st floor bathroom addition/new deck/patio provided that the person or persons, firm or corporation accepting this permit shall comply with all of the provisions of the Statues of Maine and of the Ordinances of the City of Portland regulating the construction, maintenance and use of the buildings and structures, and of the application on file in the department.

Notification of inspection and written permission procured before this building or part thereof is lathed or otherwise closed-in. 48 HOUR NOTICE IS REQUIRED.

A final inspection must be completed by owner before this building or part thereof is occupied. If a certificate of occupancy is required, it must be

Fire Prevention Officer

Code Enforcement Officer / Plan Reviewer

**THIS CARD MUST BE POSTED ON THE STREET SIDE OF THE PROPERTY
PENALTY FOR REMOVING THIS CARD**

BUILDING PERMIT INSPECTION PROCEDURES

Please call 874-8703 or 874-8693 (ONLY)

or email: buildinginspections@portlandmaine.gov

With the issuance of this permit, the owner, builder or their designee is required to provide adequate notice to the city of Portland Inspections Services for the following inspections. Appointments must be requested 48 to 72 hours in advance of the required inspection. The inspection date will need to be confirmed by this office.

- **Please read the conditions of approval that is attached to this permit!! Contact this office if you have any questions.**
- **Permits expire in 6 months. If the project is not started or ceases for 6 months.**
- **If the inspection requirements are not followed as stated below additional fees may be incurred due to the issuance of a "Stop Work Order" and subsequent release to continue.**

Footings/Setbacks prior to pouring concrete

Close In Elec/Plmb/Frame prior to insulate or gyp

Final Inspection

The project cannot move to the next phase prior to the required inspection and approval to continue, REGARDLESS OF THE NOTICE OF CIRCUMSTANCES.

IF THE PERMIT REQUIRES A CERTIFICATE OF OCCUPANCY, IT MUST BE PAID FOR AND ISSUED TO THE OWNER OR DESIGNEE BEFORE THE SPACE MAY BE OCCUPIED.



PORTLAND MAINE

Strengthening a Remarkable City, Building a Community for Life • www.portlandmaine.gov

Director of Planning and Urban Development
Jeff Levine

Job ID: 2012-10-5245-ALTR

Located At: 11 DEERFIELD RD

CBL: 112- A-012-001

Conditions of Approval:

Zoning

1. This permit is being approved on the basis of plans submitted. Any deviations shall require a separate approval before starting that work.
2. As discussed during the review process, the property must be clearly identified prior to pouring concrete and compliance with the required setbacks must be established. Due to the proximity of the setbacks of the proposed addition, it may be required to be located by a surveyor.
3. This property shall remain a single family dwelling. Any change of use shall require a separate permit application for review and approval.

Building

City of Portland, Maine - Building or Use Permit Application

389 Congress Street, 04101 Tel: (207) 874-8703, FAX: (207) 8716

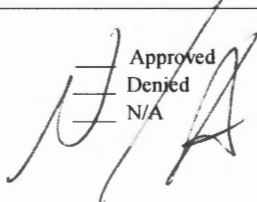
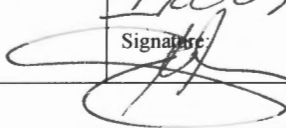
Job No: 2012-10-5245-ALTR	Date Applied: 10/23/2012 23	CBL: 112- A-012-001	
Location of Construction: 11 DEERFIELD RD	Owner Name: WILLIAM C MCMURRAY	Owner Address: 11 DEERFIELD RD PORTLAND, ME 04101	Phone:
Business Name:	Contractor Name: Peter B Rice & Co	Contractor Address: 94 Webster Rd., Freeport ME 04032	Phone: (207) 865-4061
Lessee/Buyer's Name:	Phone:	Permit Type: BLDG - Building	Zone: R-5
Past Use: Single family	Proposed Use: Same – single family – build one story bathroom addition (183 sf) & deck (323 sf)	Cost of Work: 50000.00	CEO District:
		Fire Dept: Approved Denied N/A	Inspection: Use Group: R-3 Type: SB TRC09
		Signature: 	Signature: 
Proposed Project Description: 1st floor bathroom addition/new deck/patio		Pedestrian Activities District (P.A.D.)	
Permit Taken By: Brad		Zoning Approval	

	Special Zone or Reviews	Zoning Appeal	Historic Preservation
1. This permit application does not preclude the Applicant(s) from meeting applicable State and Federal Rules. 2. Building Permits do not include plumbing, septic or electrical work. 3. Building permits are void if work is not started within six (6) months of the date of issuance. False informatin may invalidate a building permit and stop all work.	<input type="checkbox"/> Shoreland <input type="checkbox"/> Wetlands <input type="checkbox"/> Flood Zone <input type="checkbox"/> Subdivision <input type="checkbox"/> Site Plan <input type="checkbox"/> Maj <input type="checkbox"/> Min <input type="checkbox"/> MM	<input type="checkbox"/> Variance <input type="checkbox"/> Miscellaneous <input type="checkbox"/> Conditional Use <input type="checkbox"/> Interpretation <input type="checkbox"/> Approved <input type="checkbox"/> Denied	<input checked="" type="checkbox"/> Not in Dist or Landmark <input type="checkbox"/> Does not Require Review <input type="checkbox"/> Requires Review <input type="checkbox"/> Approved <input type="checkbox"/> Approved w/Conditions <input type="checkbox"/> Denied
	Date: OK w/cond. hwn 10/23/12	Date:	Date: ABU

CERTIFICATION

I hereby certify that I am the owner of record of the named property, or that the proposed work is authorized by the owner of record and that I have been authorized by the owner to make this application as his authorized agent and I agree to conform to all applicable laws of this jurisdiction. In addition, if a permit for work described in the appication is issued, I certify that the code official's authorized representative shall have the authority to enter all areas covered by such permit at any reasonable hour to enforce the provision of the code(s) applicable to such permit.

SIGNATURE OF APPLICANT	ADDRESS	DATE	PHONE
RESPONSIBLE PERSON IN CHARGE OF WORK, TITLE		DATE	PHONE

R-5 checked edge of property

Estimate 10/23/12



General Building Permit Application

If you or the property owner owes real estate or personal property taxes or user charges on any property within the City, payment arrangements must be made before permits of any kind are accepted.

2012-10-5245-ALTR

65

Location/Address of Construction: 11 Deerfield Road		
Total Square Footage of Proposed Structure/Area 400	Square Footage of Lot 5713	Number of Stories 1
Tax Assessor's Chart, Block & Lot Chart# Block# Lot# 112 A012 001	Applicant: (must be owner, lessee or buyer) Name William C. McMurray Address 11 Deerfield Rd. City, State & Zip Portland, ME 04101	Telephone:
Lessee/DBA RECEIVED OCT 22 2012 Dept. of Building Inspections City of Portland	Owner: (if different from applicant) Name Address City, State & Zip	Cost of Work: \$ 50,000 C of O Fee: \$ Historic Review: \$ Planning Amin.: \$ Total Fee: \$ 520
Current legal use (i.e. single family) <u>Single Family</u> Number of Residential Units <u>1</u> If vacant, what was the previous use? _____ Proposed Specific use: <u>Single Family Residential</u> Is property part of a subdivision? <u>No</u> If yes, please name _____ Project description: <u>1st Floor Bathroom addition, new deck / patio</u>		
Contractor's name: <u>Peter B. Rice & Co. Inc.</u>		Email: _____
Address: <u>94 Webster Road</u>		<u>pbr@peterricethebuild</u>
City, State & Zip <u>Freeport, ME 04032</u>		er.com
Who should we contact when the permit is ready: <u>Peter Rice</u>		Telephone: <u>865-4061</u>
Mailing address: <u>94 Webster Road, Freeport, ME 04032</u>		Telephone: <u>865-4061</u>

Please submit all of the information outlined on the applicable checklist. Failure to do so will result in the automatic denial of your permit.

In order to be sure the City fully understands the full scope of the project, the Planning and Development Department may request additional information prior to the issuance of a permit. For further information or to download copies of this form and other applications visit the Inspections Division on-line at www.portlandmaine.gov, or stop by the Inspections Division office, room 315 City Hall or call 874-8703.

and I hereby certify that I am the Owner of record of the named property, or that the owner of record authorizes the proposed work and that I have been authorized by the owner to make this application as his/her authorized agent. I agree to conform to all applicable laws of this jurisdiction. In addition, if a permit for work described in this application is issued, I certify that the Code Official's authorized representative shall have the authority to enter all areas covered by this permit at any reasonable hour to enforce the provisions of the codes applicable to this permit.

Signature: [Signature] Date: 10/22/12

This is not a permit; you may not commence ANY work until the permit is issued

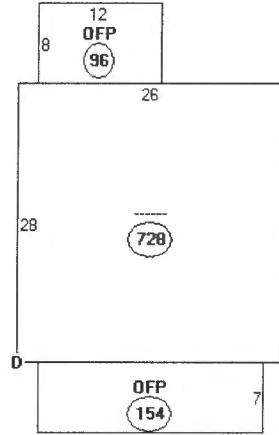
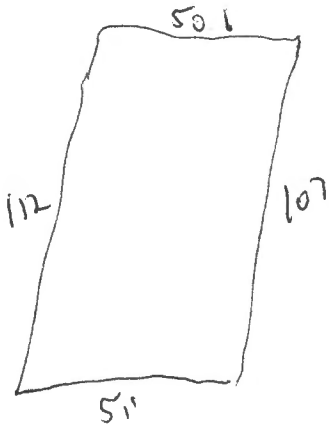

Descriptor/Area	
A: -----	728 sqft
B: OFP	96 sqft
C: OFP	154 sqft
D: RG1	216 sqft

R-5 zone

lot size, 5713 ϕ
 front - N/A
 rear - 20' min. - 21.25' scaled ϕ
 side - 15' by 8' - 8' on right side ϕ
~~25' by 12'~~ - 13.75' scaled on left ϕ
 lot coverage - $40\% = 2285.2 \phi$

existing - 216 garage
 882 house! porch
 506
 1604 ϕ ϕ

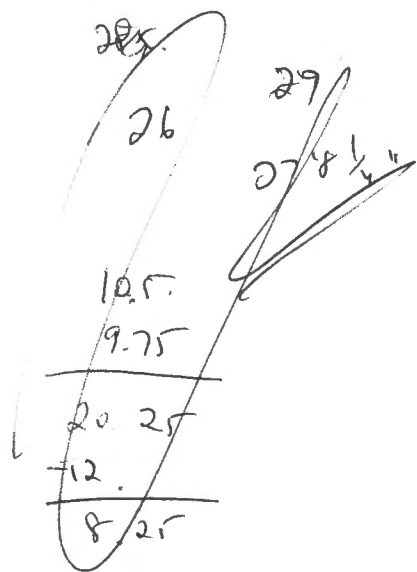

$$\begin{aligned}
 5 \times 2 &= 10 \\
 13.42 \times 12.875 &= 172.78 \\
 12.97 \times 22.5 &= 291.83 \\
 7 \times 4.5 &= 31.5 \\
 \hline
 &= 506.11
 \end{aligned}$$

RECEIVED
 OCT 22 2012
 Dept. of Building Inspections
 City of Portland Maine



PORTLAND MAINE

Strengthening a Remarkable City, Building a Community for Life • www.portlandmaine.gov

Receipts Details:

Tender Information: Check , Check Number: 19204

Tender Amount: 520.00

Receipt Header:

Cashier Id: bsaucier

Receipt Date: 10/23/2012

Receipt Number: 49522

Receipt Details:

Referance ID:	8480	Fee Type:	BP-Constr
Receipt Number:	0	Payment Date:	
Transaction Amount:	520.00	Charge Amount:	520.00
Job ID: Job ID: 2012-10-5245-ALTR - 1st floor bathroom addition/new deck/patio			
Additional Comments: 11 Deerfield			

Thank You for your Payment!

Engineered Material

WNP68-Z

HRC44

RECEIVED

OCT 22 2012

Dept. of Building Inspections
City of Portland Maine