

COORDINATE FINAL DEVICE  
 LOCATIONS WITH OWNER  
 PRIOR TO INSTALLATION.

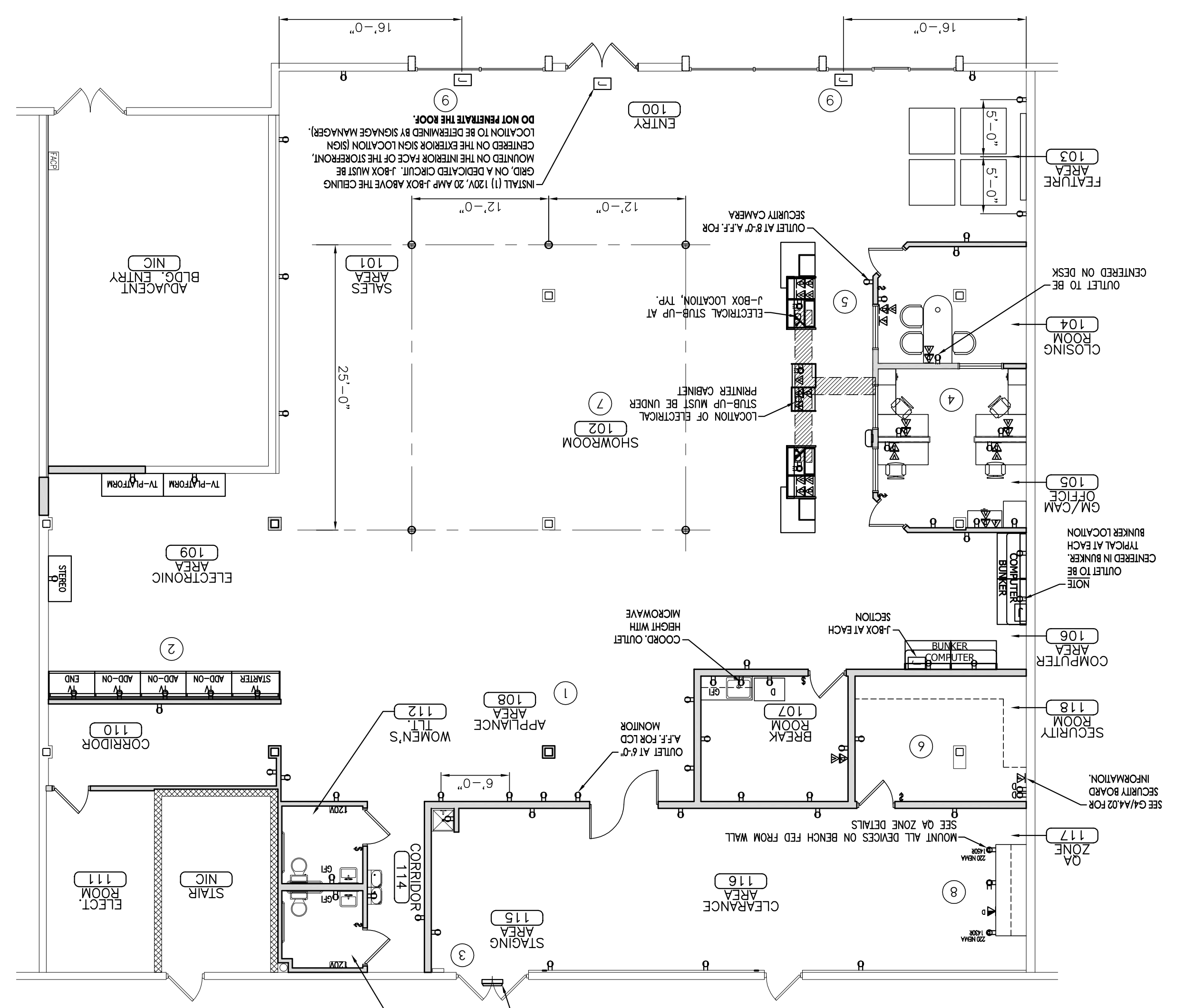

**ELECTRICAL PLAN KEY NOTES**

1. APPLIANCE AREA SHALL HAVE RECEPTAL AT EVERY 6'-0" OR CONTINUOUS PLUG MOLD. ALSO PROVIDE (3) CIRCUITS FOR APPLIANCE AREA.
2. PROVIDE (1) DUPLEX OUTLET FOR EVERY 4' ELECTRONICS PANEL. PROVIDE (4) CIRCUITS FOR THE ELECTRONICS AREA.
3. PROVIDE (2) 110V OUTLETS DEDICATED TO TELEPHONE AND ALARM SYSTEM NEAR THE ELECTRICAL PANEL. INSTALL APPROVED OVERHEAD LIGHTING WITH SWITCH. ALSO INSTALL A 150-200 WATT HALOGEN LIGHT (DUCK TO DIMM) NEAR THE OVERHEAD DOOR.
4. INSTALL (6) TELEPHONE JACKS, (6) COMPUTER OUTLETS, (6) SWITCH IN GM/CAM OFFICE. INSTALL (2) TELEPHONE JACKS, (2) COMPUTER OUTLET, (2) DUPLEX OUTLETS AND (1) LIGHT SWITCH IN THE CLOSING OFFICE. GM/CAM OFFICE SHALL ALSO HAVE A DOOR BELL RECEIVER AND MASTER CONTROL FROM ALARM. INSTALL (1) 100V DUPLEX OUTLET AT 8'-0" A.F.F. ON THE SHOWROOM SIDE OF OFFICES AT THE FURTHEST POINT FROM MAIN ENTRANCE FOR SECURITY CAMERA.
5. FOR EACH COUNTER SECTION - PROVIDE (2) TELEPHONE JACKS, (2) COMPUTER OUTLET AND (1) QUADRUPEL OUTLET. FOR CENTER SECTION - PROVIDE (1) TELEPHONE JACKS, (2) COMPUTER OUTLET (1) FAX AND (1) QUADRUPEL OUTLET. WIRES AND CABLES SHALL BE TRENCHED FROM THE OUTLET TO FLAT WIRE AS MANUFACTURED BY THE CONNECTIVITY WRITING SYSTEM INSTALLED UNDER CARPET TILE ONLY FOR REMODEL STORES. PROVIDE FLAT WIRE FOR ALL WIRING FOLLOW TO MANUFACTURER'S INSTALLATION INSTRUCTIONS AND FLAT WIRE AVAILABLE FROM NATIONAL CUSTOM - 770-441-1660
6. INSTALL (2) 12" X 48" LIGHT FIXTURE WITH SWITCH TO SECURITY ROOM. CENTER OUTLET ON DOOR ABOVE DOOR AT 96" A.F.F. FOR SECURITY ALARM PANEL.
7. PROVIDE (1) GFCI GROUNDED CIRCUIT AND LIGHT SWITCH PER RESTROOM.
8. PROVIDE CONNECTION TO HAND PREFERENCES AND WIRE WITH (2) #10 AND (1) #10 GND IN 2" C.
9. SEE DETAIL 55/44.00
10. INSTALL DOOR BELL RECEIVER AND MASTER CONTROL FOR ALARM BELLHOP CASHWARP. DOOR BELL ABOVE CEILING. NO MARKS INDICATE TWO NO. 12 CONDUCTORS. UNLESS OTHERWISE NOTED, NO GROUNDING CONDUCTORS ARE NOT INDICATED BY MARKS, BUT ARE REQUIRED.
11. MARKS ACROSS RACEWAY SPACES INDICATE THE NUMBER OF NO. 12 CONDUCTORS. UNLESS OTHERWISE NOTED, NO GROUNDING CONDUCTORS ARE NOT INDICATED BY MARKS, BUT ARE REQUIRED.
12. RACEWAY INSTALLED CONCEALED IN WALL OR ABOVE CEILING / CONCEALED BELOW FLOOR OR UNDERGROUND.
13. HILL-PHONE SWITCHES, AS NOTED.
14. FUSIBLE/NON-FUSED DISCONNECT SWITCH.
15. SINGLE-POLE, SINGLE-THROW TOGGLE SWITCH.
16. MOTOR RATED TOGGLE SWITCH.

**VOICE DATA CABLING NOTES**

1. CAM/OFFICE
  2. CLOSING OFFICE
  3. CASHWARP - EACH SECTION
  4. PRINTER/CENTER SECTION
  5. 5A BECHM
  6. BACK DOOR
  7. BREAK ROOM
  8. SHOW ROOM
  9. SECURITY BOARD
- NOTE: TWO SECTIONS FAX, CREDIT CARD & MODEM ARE ALL SAME LINE
- 1-VOICE 1-DATA 1-FAX  
 2-VOICE 2-DATA 1-FAX  
 6-VOICE 6-DATA 2-FAX

**ELECTRICAL DESIGN GUIDELINES:**

1. APPLIANCE AREA SHALL HAVE A DUPLEX RECEPTAL AT EVERY 6'-0" ON A MINIMUM OF 3 CIRCUITS.
2. PROVIDE (1) DUPLEX OUTLET FOR EACH 4' SECTION OF ELECTRONIC FUTURE. MAXIMUM 2 SECTIONS PER CIRCUIT. TYPICAL IS 4 CIRCUITS.
3. PROVIDE (2) 120V OUTLETS DEDICATED TO TELEPHONE AND ALARM SYSTEM NEAR THE ELECTRICAL PANELS.

**LEGEND NOTES**

1. UNLESS NOTED OTHERWISE, MOUNTING HEIGHT DIMENSIONS ARE TO THE CENTERLINE OF THE DEVICE OR OUTLET ABOVE GRADE OR FINISHED FLOOR.
2. DEDICATED PROVIDE "DEDICATED" LABEL ON COVERPLATE.
3. FOR THOSE RECEPTALS MOUNTED FLUSH IN THE FLOOR, PROVIDE HUBBELL #5174X48L QUAD DEVICE WITH CAPACITY FOR FOUR (4) CAT-5 JACKS - JACKS AND TELECOMM WIRING SHALL BE PROVIDED BY TEL/DATA VENDOR.

**ELECTRICAL GENERAL NOTES**

1. ALL RECEPTALS, JUNCTION BOXES, AND VOICE/DATA RECEPTALS SHALL BE MOUNTED 18" A.F.F. TO APPLIANCE AREA.
2. IF THE CONTRACTORS RESPONSIBILITY TO CONFIRM LOCATIONS OF ALL FLOOR CORES WITH OWNER.
3. ALL VOICE, DATA, AND ELECTRICAL COVER PLATES SHALL BE TIGHT AND SHALL BE MOUNTED STRAIGHT AND ALIGNED.
4. NEVER PLACE OUTLETS OR DEVICES BACK TO BACK AT OPPOSITE FACES OF THE WALL.
5. INSTALL TV COAXIAL CABLE AND HOOKUP (NIC), INSTALLED BY OWNER.
6. COMPUTER CABLE TO BE INSTALLED SHALL BE TWISTED PAIR CATEGORY #5 BY FIRE CODE.
7. ALL WIRING SHALL MEET APPLICABLE CODES.
8. FOR WIRING OF RECEPTALS, HOMEWERN CIRCUITS CAN DIFFERENT PHASES. IN NO CASE SHALL ANY ONE CONDUIT CONTAIN MORE THAN SIX (6) CURRENT CARRYING CONDUCTORS. FOR WIRING, UNLESS NOTED OTHERWISE, USE #12 PHASE, NEUTRAL, AND GROUNDING BY THE CIRCUITING. ELEVATION FOR MORE INFORMATION ON EXTERIOR SIGNAGE. PLEASE CONTACT ARON'S CONSTRUCTION PROJECT MANAGER.
9. INSTALL EMERGENCY LIGHTS AND EXIT SIGNS REQUIRED, INCLUDING SIGNAGE, IN ACCORDANCE WITH BUILDING CODE.
10. INSTALL (1) 20 AMP, 120V CIRCUIT PER EXTERIOR SIGNAGE. ELEVATION FOR MORE INFORMATION ON EXTERIOR SIGNAGE. PLEASE CONTACT ARON'S CONSTRUCTION PROJECT MANAGER.
11. INCLUDING SIGNAGE, IN ACCORDANCE WITH BUILDING CODE.
12. INSTALL TIMER FOR THE EXTERIOR SIGNAGE AT THE ELECTRICAL PANEL. ELECTRICAL CONTRACTOR TO SUPPLY AND INSTALL 24 HOUR DIAL MODEL #1101.
13. PROVIDE (1) GFCI GROUNDED CIRCUIT AND LIGHT SWITCH PER RESTROOM.
14. PROVIDE CONNECTION TO HAND PREFERENCES AND WIRE WITH (2) #10 AND (1) #10 GND IN 2" C.
15. SEE DETAIL 55/44.00
16. INSTALL DOOR BELL RECEIVER AND MASTER CONTROL FOR ALARM BELLHOP CASHWARP. DOOR BELL ABOVE CEILING. NO MARKS INDICATE TWO NO. 12 CONDUCTORS. UNLESS OTHERWISE NOTED, NO GROUNDING CONDUCTORS ARE NOT INDICATED BY MARKS, BUT ARE REQUIRED.
17. RACEWAY INSTALLED CONCEALED IN WALL OR ABOVE CEILING / CONCEALED BELOW FLOOR OR UNDERGROUND.
18. HILL-PHONE SWITCHES, AS NOTED.
19. FUSIBLE/NON-FUSED DISCONNECT SWITCH.
20. SINGLE-POLE, SINGLE-THROW TOGGLE SWITCH.
21. MOTOR RATED TOGGLE SWITCH.
22. TELEPHONE BACKBOARD
23. DUPLEX RECEPTAL NEMA TYPE 5-20R FLOOR OR WALL MOUNTED. WALL MOUNTED - CENTRALINE RECESS MOUNTED AT 18" AFF. UNLESS NOTED OTHERWISE.
24. DOUBLE-DUPLEX RECEPTAL NEMA TYPE 5-20R, FLOOR OR WALL MOUNTED - CENTRALINE RECESS MOUNTED AT 18" AFF. UNLESS NOTED OTHERWISE.
25. COUNTERTOP HEIGHT DUPLEX RECEPTAL. NEMA TYPE 5-20R, UNLESS NOTED OTHERWISE. A "CET" TAG INDICATES A GROUND UNLESS NOTED OTHERWISE. A "WPT" TAG INDICATES A GROUND TO BE IN A WEATHERPROOF ENCLOSURE.
26. SPECIAL PURPOSE RECEPTAL. NEMA CONFIGURATION AS INDICATED ON DRAWINGS.
27. 4" SQUARE OR ROUND (AS INDICATED) JUNCTION BOX SURFACE OR RECESS MOUNTED AT HEIGHT INDICATED ON DRAWINGS. TELECOMM SECURITY, ETC. AS NOTED ON DRAWINGS. IF IN FINISHED AREA, INSTALL RECESS. WITH COVER, IF IN UNFINISHED AREA, INSTALL SURFACE MOUNTED WITH COVER. PROVIDE NEMA 3R TYPE, IF IN EXTERIOR OR WET AREA.
28. POWER PANEL WITH VOLTAGE, AMPERE, AIC RATING, BREAKERS, AND MOUNTING AS INDICATED ON ONE LINES AND PANEL BOARD SCHEDULES.
29. VOICE OR DATA OR FAX OUTLET CENTRALINE RECESS MOUNTED AT 18" AFF WITH 3/4" CONDUIT ROUTED UP WALL, AND SHIMMERED OUT ABOVE CEILING WITH INSULATED THROUGH CONNECTORS. ALL TELEPHONE CEILING WITH INSULATED THROUGH CONNECTORS.
30. INSTALLED BY OWNER OR HIS SELECTED VENDOR.
31. SPEAKER DATA BOX CENTRALINE RECESS MOUNTED AS INDICATED WITH 3/4" CONDUIT ROUTED UP WALL, AND SURGERED OUT ABOVE CEILING WITH INSULATED THROUGH CONNECTORS.
32. ALL SPEAKER CABLES FINISHED AND INSTALLED BY OWNER OR OWNER'S SELECTED VENDOR.
33. DOOR BELL
34. DOOR CHIME
35. COMPUTER OUTLET
36. FAX JACK, MODEM JACK

**LEGEND**

SYMBOL	DESCRIPTION
X-1,3,5	ARMORING INDICATES HOMERUN, X-1, -3, AND 5 ADVANTAGE TO HOMERUN ARMORING INDICATES HOMERUN TO PANEL X, 1, 3, AND 5
—	MARKS ACROSS RACEWAY SPACES INDICATE THE NUMBER OF NO. 12 CONDUCTORS. UNLESS OTHERWISE NOTED, NO GROUNDING CONDUCTORS ARE NOT INDICATED BY MARKS, BUT ARE REQUIRED.
—	RACEWAY INSTALLED CONCEALED IN WALL OR ABOVE CEILING / CONCEALED BELOW FLOOR OR UNDERGROUND.
—	HILL-PHONE SWITCHES, AS NOTED.
—	FUSIBLE/NON-FUSED DISCONNECT SWITCH.
—	SINGLE-POLE, SINGLE-THROW TOGGLE SWITCH.
—	MOTOR RATED TOGGLE SWITCH.
—	TELEPHONE BACKBOARD
—	DUPLEX RECEPTAL NEMA TYPE 5-20R FLOOR OR WALL MOUNTED. WALL MOUNTED - CENTRALINE RECESS MOUNTED AT 18" AFF. UNLESS NOTED OTHERWISE.
—	DOUBLE-DUPLEX RECEPTAL NEMA TYPE 5-20R, FLOOR OR WALL MOUNTED - CENTRALINE RECESS MOUNTED AT 18" AFF. UNLESS NOTED OTHERWISE.
—	COUNTERTOP HEIGHT DUPLEX RECEPTAL. NEMA TYPE 5-20R, UNLESS NOTED OTHERWISE. A "CET" TAG INDICATES A GROUND UNLESS NOTED OTHERWISE. A "WPT" TAG INDICATES A GROUND TO BE IN A WEATHERPROOF ENCLOSURE.
—	SPECIAL PURPOSE RECEPTAL. NEMA CONFIGURATION AS INDICATED ON DRAWINGS.
—	4" SQUARE OR ROUND (AS INDICATED) JUNCTION BOX SURFACE OR RECESS MOUNTED AT HEIGHT INDICATED ON DRAWINGS. TELECOMM SECURITY, ETC. AS NOTED ON DRAWINGS. IF IN FINISHED AREA, INSTALL RECESS. WITH COVER, IF IN UNFINISHED AREA, INSTALL SURFACE MOUNTED WITH COVER. PROVIDE NEMA 3R TYPE, IF IN EXTERIOR OR WET AREA.
—	POWER PANEL WITH VOLTAGE, AMPERE, AIC RATING, BREAKERS, AND MOUNTING AS INDICATED ON ONE LINES AND PANEL BOARD SCHEDULES.
—	VOICE OR DATA OR FAX OUTLET CENTRALINE RECESS MOUNTED AT 18" AFF WITH 3/4" CONDUIT ROUTED UP WALL, AND SHIMMERED OUT ABOVE CEILING WITH INSULATED THROUGH CONNECTORS. ALL TELEPHONE CEILING WITH INSULATED THROUGH CONNECTORS.
—	INSTALLED BY OWNER OR HIS SELECTED VENDOR.
—	SPEAKER DATA BOX CENTRALINE RECESS MOUNTED AS INDICATED WITH 3/4" CONDUIT ROUTED UP WALL, AND SURGERED OUT ABOVE CEILING WITH INSULATED THROUGH CONNECTORS.
—	ALL SPEAKER CABLES FINISHED AND INSTALLED BY OWNER OR OWNER'S SELECTED VENDOR.
—	DOOR BELL
—	DOOR CHIME
—	COMPUTER OUTLET
—	FAX JACK, MODEM JACK

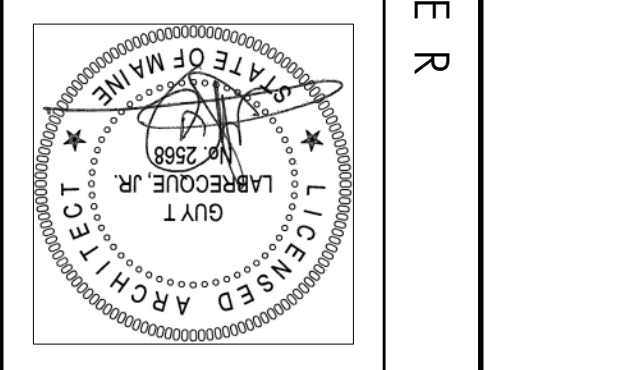

**CWS ARCHITECTS**  
 ARCHITECTURE | INTERIOR DESIGN  
 434 CUMBERLAND AVENUE  
 PORTLAND, ME 04101  
 PHONE: 207 774 4441  
 WWW.CWSARCH.COM

**OWNER**  
**ARON'S FIT-UP STORE # : F0810**  
 449 FOREST AVE.  
 PORTLAND, MAINE 04101

**PROJECT**  
**POWER AND SYSTEMS PLAN, NOTES AND LEGEND**  
 CWS PROJECT NUMBER: 15076

**DRAWING**

**REVISIONS**

NO.	DATE	DESCRIPTION
1	01/08/2016	ISSUED FOR CONSTRUCTION

SCALE: 1/8" = 1'-0"  
**E1.01**  
 DRAWING NUMBER