

Descriptor/Area

- A: 034 30960 sqft
- B: 082 16000 sqft
- C: ELEVATOR ELECTRIC PASNGR 54000 sqft
- D: OVERHEAD DR-WOOD/MTL 48 sqft
- E: CANOPY ONLY 4032 sqft
- F: BANK CANOPY-DRIVE IN 488 sqft
- G: BANK VAULT - NO DOOR 112 sqft
- H: BANK VAULT DR RECT \$ sqft
- I: BANK NT DEP CHUTE sqft
- J: BANK DR IN WINDOW sqft
- K: 2S 16000 sqft

UNIT 7A HAIR SALON	15
UNIT 7B INSURANCE COMPANY	
UNIT 6 LAUNDRY MAT	
UNIT 5 MAGIC NAILS	
200 LOBBY TO SECOND FLOOR	25 16000 200
UNIT 4 FURNITURE STORE	
UNIT 3 LEAPING LIZARDS	
UNIT 2 CVS	
110 UNIT 1 BANK	15 14960 136 10

18 0
26

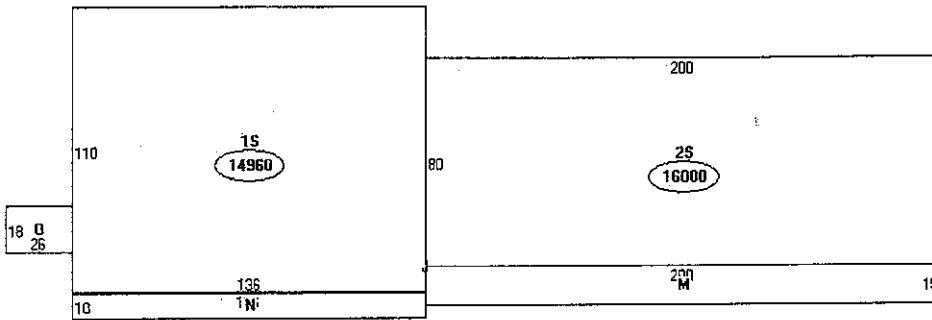

- Descriptor/Area**
- A: 034
30560 sqft
 - B: 062
16000 sqft
 - C: ELEVATOR ELECTRIC PASNGR
54000 sqft
 - D: OVERHEAD DR-WOOD/MTL
48 sqft
 - E: CANOPY ONLY
4032 sqft
 - F: BANK CANOPY-DRIVE IN
468 sqft
 - G: BANK VAULT - NO DOOR
112 sqft
 - H: BANK VAULT DR RECT \$
sqft
 - I: BANK NT DEP CHUTE
sqft
 - J: BANK DR IN WINDOW
sqft
 - K: 25
16000 sqft