

G.C. TO PROVIDE ADEQUATE:
 1. TEMPORARY WALL/ROOF BRACING
 2. PROVIDE SAFETY BARRICADING
 3. TEMPORARY WEATHER PROTECTION
 DURING ENTIRE DEMOLITION AND CONSTRUCTION OF NEW ADDITION.

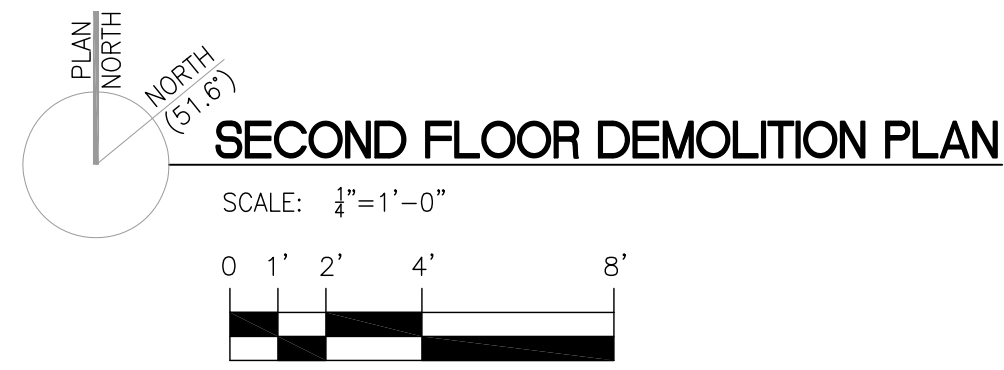

ALL CONDITIONS ARE DOCUMENTED AS EXISTING ON JANUARY 18, 2012. ALL DIMENSIONS TO BE FIELD VERIFIED

- ABBREVIATIONS:**
- AFF ABOVE FINISHED FLOOR
 - BO BOTTOM OF
 - CLG. CEILING
 - C. CENTERLINE
 - CONC. CONCRETE
 - DEMO DEMOLISH
 - DN. DOWN
 - GWB GYPSUM WALL BOARD
 - HTR. HEATER
 - MHT (APPARENT) MEAN HIGH TIDE
 - OD OUTSIDE DIAMETER
 - P. PROPERTY LINE
 - TO TOP OF
 - REF. REFRIGERATOR
 - ROW RIGHT OF WAY
 - WTR. WATER

- LEGEND:**
- EXISTING FRAMED WALL TO BE DEMOLISHED
 - EXISTING FRAMED WALL TO REMAIN
 - EXISTING MASONRY WALL TO REMAIN

ADDITIONS TO THE HOWARD YEE RESIDENCE
 120 BAXTER BOULEVARD, PORTLAND, MAINE 04101
 HOWARD YEE - OWNER

REVISIONS:

DATE: MARCH 10, 2015
 DRAWN BY: SPR
 SCALE: 0 1/4" = 1'-0" FULL SIZE PLOT
 DRAWING NAME: SECOND FLOOR DEMOLITION PLAN



SHEET:

D-2

SHEET: 3 OF: 10