



MANHOLE
103 DORTLAND
Book/Page
Tax Mod 111-A

2 STORY
WOOD FRAME

SITE BENCHMARK:
RIM OF MANHOLE = 27.26
ELEVATION OF PORTLAND DATUM
N.G.V.D. 1929

PLAZA LLC
14643/82
Burger King
SM ENTERPRISES LTD
111-A-16
449 FOREST AVE
LEASED LAND

DEVELOPMENT SUMMARY

BUILDING AREA	1,580 S.F.
PAVED AREA	4,256 S.F.
VEGETATED AREA	1,288 S.F.
TOTAL LAND AREA	9,828 S.F.
PARKING SPACES PROVIDED*	14
*PARKING SPACE REQUIREMENT BASED ON 100 S.F. OF FLOOR AREA NOT USED FOR STORAGE OR FLOOR PREPARATION	

FOREST AVENUE

PAVED PUBLIC WAY
OF VARIED WIDTH.

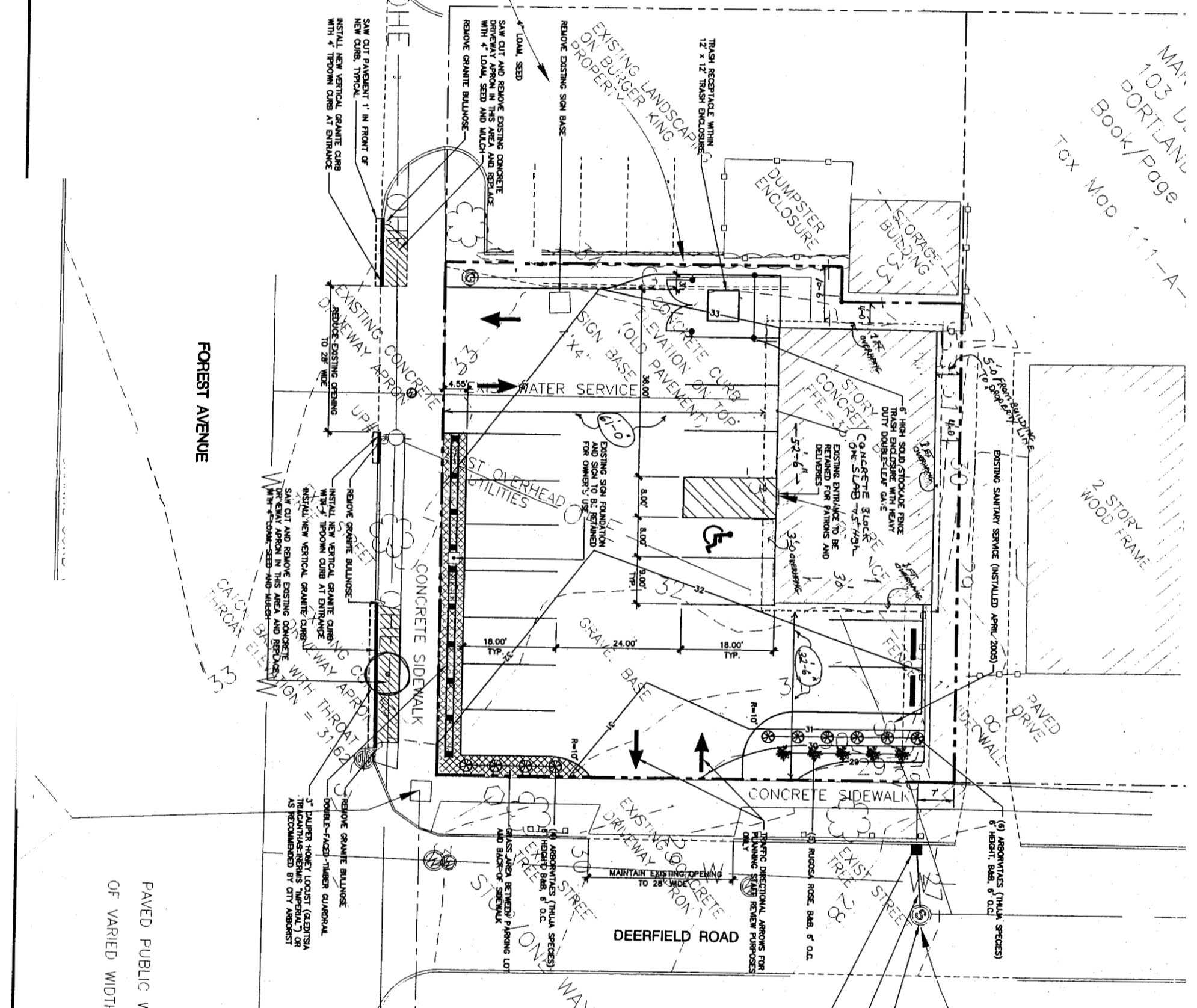

INSTALL NEW 4" PRECAST CONCRETE CATCH BASIN AND GRANITE CURB INLET STONE RAY EXISTING GRANITE CURB AS NECESSARY. CATCH BASIN, INLET STONE, FRAME AND COVER, STORM DRAIN PIPE AND OTHER INSTALLED MATERIAL SHALL BE IN ACCORDANCE WITH THE CITY'S REQUIREMENTS SHOWN IN THE TECHNICAL DESIGN STANDARDS AND GUIDELINES, INCLUDING BUT NOT LIMITED TO FIGURES I-6, I-7, I-8, I-9, I-10 AND I-11.

12" ROP STORM DRAIN
S=AIN 0.01 (TO BE DETERMINED BY CONTRACTOR)

CORE EXISTING MANHOLE ABOVE SHELF. DO NOT CONSTRUCT CHANNEL. INVERT TO BE DETERMINED IN THE FIELD.

REV.	BY	DATE	STATUS
C	SJB	07-13-08	ISSUED FOR CONDITIONS OF APPROVAL
B	SJB	06-20-08	ISSUED FOR PRELIMINARY PLAN APPROVAL
A	SJB	06-11-08	ISSUED FOR CONCEPTUAL PLAN APPROVAL

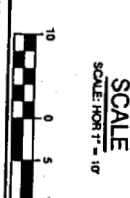

WENDALL M. FLETCHER
425 FOREST AVENUE

SITE PLAN

DESIGNER: SJB
DRAWN BY: JMT
CHECKED BY: SJB
DATE: 05-08-08
JOB NO: 97
SCALE: 1" = 10'
SHEET 1 OF 2

Aquation Engineering Services
2000 1st Street
Portland, ME 04103
Tel: 603.763.1111
Fax: 603.763.1112