

85-87 DEERFIELD ROAD



SHAMROCK

Fair cut # 920R - Half cut # 9202R - Third cut # 9203R - Fifth cut # 9205R



APPLICATION FOR PERMIT

B.O.C.A. USE GROUP
B.O.C.A. TYPE OF CONSTRUCTION
ZONING LOCATION PORTLAND, MAINE, July 29, 1982

PERMIT ISSUED

JUL 30 1982
00610

CITY OF PORTLAND

To the DIRECTOR OF BUILDING & INSPECTION SERVICES, PORTLAND, MAINE

The undersigned hereby applies for a permit to erect alter, repair, demolish, move or install the following building, structure, equipment or change use in accordance with the Laws of the State of Maine, the Portland B.O.C.A. Building Code and Zoning Ordinance of the C.ty of Portland with plans and specifications, if any, submitted herewith and the following specifications:

LOCATION 85 Deerfield Road Portland, Me. Fire District #1 [] #2 []
1 Owner's name and address Broda Loeb Telephone
2 Lessee's name and address Telephone
3 Contractor's name and address Maine Shawnee Step Auburn, Me. Telephone 7741833
4 Architect Specifications Plans No of sheets
Proposed use of building dwelling No. families
Last use No. families
Material No. stories Heat Style of roof Roofing
Other buildings on same lot
Estimated contractual cost \$1555,00 Fee \$ 20.00

FIELD INSPECTOR—Mr. GENERAL DESCRIPTION

This application is for: @ 775-5451 Left Side-Front Shawnee Step
Dwelling Ext. 234
Garage
Masonry Bldg.
Metal Bldg.
Alterations
Demolitions
Change of Use
Other

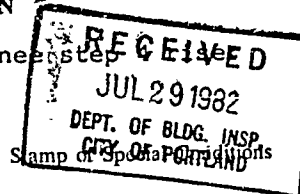

NOTE TO APPLICANT: Separate permits are required by the installers and subcontractors of heating, plumbing, electrical and mechanicals.

PERMIT IS TO BE ISSUED TO 1 [] 2 [] 3 [] 4 []
Other:

DETAILS OF NEW WORK

Is any plumbing involved in this work? Is any electrical work involved in this work?
Is connection to be made to public sewer? If not, what is proposed for sewage?
Has septic tank notice been sent? Form notice sent?
Height average grade to top of plate Height average grade to highest point of roof
Size, front depth No. stories solid or filled land? earth or rock?
Material of foundation Thickness, top bottom cellar
Kind of roof Rise per foot Roof covering
No. of chimneys Material of chimneys of lining Kind of heat fuel
Framing Lumber—Kind Dressed or full size? Corner posts Sills
Size Girder Columns under girders Size Max. on centers
Studs (outside walls and carrying partitions) 2x4-16" C C. Bridging in every floor and flat roof span over 8 feet.
Joists and rafters: 1st floor 2nd 3rd roof
On centers: 1st floor 2nd 3rd roof
Maximum span: 1st floor 2nd 3rd roof
If one story building with masonry walls, thickness of walls? height?

IF A GARAGE

No cars now accommodated on same lot, to be accommodated number commercial cars to be accommodated
Will automobile repairing be done other than minor repairs to cars habitually stored in the proposed building?

APPROVALS BY: DATE MISCELLANEOUS
BUILDING INSPECTION—PLAN EXAMINER Will work require disturbing of any tree on a public street?
ZONING: Will there be in charge of the above work a person competent
BUILDING CODE: to see that the State and City requirements pertaining thereto
Fire Dept.: are observed?
Health Dept.:
Others:

Signature of Applicant Lucille E. Hawley Phone #
Type Name of above Lucille E. Hawley 1 [] 2 [] 3 [] 4 []
Other
and Address

FIELD INSPECTOR'S COPY

[Signature]

CITY OF PORTLAND, MAINE
Application for Permit to Install Wires

Permit No. 58508
 Issued 7/17/70
 Portland, Maine Feb 17, 1970

To the City Electrician, Portland, Maine:

The undersigned hereby applies for a permit to install wires for the purpose of conducting electric current, in accordance with the laws of Maine, the Electrical Ordinance of the City of Portland, and the following specifications:

(This form must be completely filled out — Minimum Fee, \$1.00)

Owner's Name and Address Philip J. Goring Tel.
 Contractor's Name and Address Breggy Oil Tel.
 Location 25 Deerfield Rd. Use of Building Res
 Number of Families 1 Apartments Stores Number of Stories
 Description of Wiring: New Work Additions Alterations
Wiring of HP Burner + controls
 Pipe Cable Metal Molding BX Cable Plug Molding (No. of feet)
 No. Light Outlets Plugs Light Circuits Plug Circuits
 FIXTURES: No. Fluor. or Strip Lighting (No. feet)
 SERVICE: Pipe Cable Underground No. of Wires Size
 METERS: Relocated Added Total No. Meters
 MOTORS: Number 1 Phase 1 H. P. 1/8 Amps 3.0 Volts 115 Starter
 HEATING UNITS: Domestic (Oil) No. Motors Phase H.P.
 Commercial (Oil) No. Motors Phase H.P.
 Electric Heat (No. of Rooms)
 APPLIANCES: No. Ranges Watts Brand Feeds (Size and No.)
 Elec. Heaters Watts
 Miscellaneous Watts Extra Cabinets or Panels
 Transformers Air Conditioners (No. Units) Signs (No. Units)
 Will commence 19 Ready to cover in 19 Inspection 19
 Amount of Fee \$ 7.00 Signed Breggy Oil

DO NOT WRITE BELOW THIS LINE

SERVICE	METER	GROUND
VISITS: 1	2	3
4	5	6
7	8	9
10	11	12

REMARKS:

INSPECTED BY J.W. Hunter
 (OVER)

LOCATION *Deerfield Rd. 85*
 INSPECTION DATE *2/23/70*
 WORK COMPLETED *2/23/70*
 TOTAL NO. INSPECTIONS *1*
 REMARKS:

FEEES FOR WIRING PERMITS EFFECTIVE JULY 31, 1963

WIRING

1 to 30 Outlets \$ 2.00
 31 to 60 Outlets 3.00
 Over 60 Outlets, each Outlet05
 (Each twelve feet or fraction thereof of fluorescent lighting or
 any type of plug molding will be classed as one outlet).

SERVICES

Single Phase 2.00
 Three Phase 4.00

MOTORS

Not exceeding 50 H.P. 3.00
 Over 50 H.P. 4.00

HEATING UNITS

Domestic (Oil) 2.00
 Commercial (Oil) 4.00
 Electric Heat (Each Room)75

APPLIANCES

Ranges, Cooking Tops, Ovens, Water Heaters, Disposals, Built-in
 Dishwashers, Dryers, and any permanent built-in appliance — each
 unit 1.50

MISCELLANEOUS

1st priority Service, Single Phase 1.00
 Timmer Service, 7 1/2 H.P. 1.00



FILL IN AND SIGN WITH INK

APPLICATION FOR PERMIT FOR HEATING, COOKING OR POWER EQUIPMENT

Portland, Maine, February 17, 1970

PERMIT ISSUED 145 BY 802 CITY OF PORTLAND

To the INSPECTOR OF BUILDINGS, PORTLAND, ME.

The undersigned hereby applies for a permit to install the following heating, cooking or power equipment in accordance with the Laws of Maine, the Building Code of the City of Portland, and the following specifications:

Location 85 Deerfield Road Use of Building Dwelling No. Stories 2 New Building Existing " Name and address of owner of appliance Philip Jagolinger, 85 Deerfield Road Installer's name and address Eregey Oil Service, 84 Congress St. Telephone

General Description of Work

To install Oil-fired steam boiler(replacement)(2nd. floor.

IF HEATER, OR POWER BOILER

Location of appliance Basement Any burnable material in floor surface or beneath? none If so, how protected? Kind of fuel? oil Minimum distance to burnable material, from top of appliance or casing top of furnace 3' From top of smoke pipe 12" From front of appliance over 4' From sides or back of appliance over 3' Size of chimney flue 8x12 Other connections to same flue none If gas fired, how vented? Rated maximum demand per hour Will sufficient fresh air be supplied to the appliance to insure proper and safe combustion? yes

IF OIL BURNER

Name and type of burner Fuel-Chief-gunttype Labeled by underwriters' laboratories? yes Will operator be always in attendance? Does oil supply line feed from top or bottom of tank? bottom Type of floor beneath burner concrete Size of vent pipe 1 1/2" Location of oil storage basement Number and capacity of tanks 275 gal. existing Low water shut off yes Make WATTS No. Will all tanks be more than five feet from any flame? yes How many tanks enclosed? Total capacity of any existing storage tanks for furnace burners 2-275 gal.

IF COOKING APPLIANCE

Location of appliance Any burnable material in floor surface or beneath? If so, how protected? Height of Legs, if any Skirting at bottom of appliance? Distance to combustible material from top of appliance? From front of appliance From sides and back From top of smokepipe Size of chimney flue Other connections to same flue Is hood to be provided? If so, how vented? Forced or gravity? If gas fired, how vented? Rated maximum demand per hour

MISCELLANEOUS EQUIPMENT OR SPECIAL INFORMATION

Amount of fee enclosed? 2.00. (\$2.00 for one heater, etc., \$1.00 additional for each additional heater, etc., in same building at same time.)

APPROVED: 2/17/70 OR M.G.W.

Will there be in charge of the above work a person competent to see that the State and City requirements pertaining thereto are observed? yes

Eregey Oil Service

Signature of Installer by: [Signature]

CS 300

INSPECTION COPY

7m

85 Deerfield Rd.

Feb. 20, 1970

Breggy Oil Service
84 Congress Street

cc to: Philip Jagolinzer
85 Deerfield Road

Gentlemen:

Upon inspection of the above job on Feb. 20, 1970, the following omissions were found:

1. No red plate emergency switch installed at head of stairs.
2. Vent pipe too small, this pipe must be 1½" as per National Fire Protection Association, No. 31, Table I.

It is important that correction of these conditions be made before March 6, 1970, and notification be given this office of readiness for another inspection.

If additional information relative to the above is desired, please phone Inspector Malcolm Ward, at 774-8221, extension 234, any weekday but Saturday between 8:00 and 9:00 A. M..

Very truly yours,

Malcolm Ward

Building Inspection Department

MW:m



FILL IN COMPLETELY AND SIGN WITH INK

PERMIT ISSUED

APPLICATION FOR PERMIT FOR HEATING, COOKING OR POWER EQUIPMENT

AUG 30 1935

Portland, Maine, August 30, 1935

To the INSPECTOR OF BUILDINGS, PORTLAND, ME.

The undersigned hereby applies for a permit to install the following heating, cooking or power equipment in accordance with the Laws of Maine, the Building Code of the City of Portland, and the following specifications:

Location 85 Deerfield Road Use of Building Residence
Name and address of owner Mrs. Jennie Smith, 85 Deerfield Road Ward 8
Contractor's name and address Easternoil Inc., 135 Marginal Way Telephone 3-6495

General Description of Work

To install One Model A Easternoil Automatic Oil Burner and 275 gal. tank.

IF HEATER, POWER BOILER OR COOKING DEVICE

Is heater or source of heat to be in cellar? YES If not, which story Kind of Fuel oil
Material of supports of heater or equipment (concrete floor or what kind) concrete
Minimum distance to wood or combustible material, from top of boiler or casing top of furnace,
from top of smoke pipe, from front of heater, from sides or back of heater
Size of chimney flue Other connections to same flue

IF OIL BURNER

Name and type of burner Easternoil-gun type Labeled and approved by Underwriters' Laboratories YES
Will operator be always in attendance? no Type of oil feed (gravity or pressure) pressure
Location oil storage cellar No. and capacity of tanks one 275 gallon.
Will all tanks be more than seven feet from any flame? YES How many tanks fireproofed?

Amount of fee enclosed? \$1.00 (\$1.00 for one heater, etc., 50 cents additional for each additional heater, etc., in same building at same time.)

Signature of contractor EASTERNOIL INC.
By: [Signature]

INSPECTION COPY

NOTIFICATION REQUIRED BY LAW OR CLOSING IN BY PERMIT
CERTIFICATE OF OCCUPANCY REQUIREMENT IS WANTED

510513

Ward 8 Permit No. 35/1358
 Location 85 Deerfield Road
 Owner Mrs. Jennie Smith
 Date of permit 8/30/35
 Post Card sent 8/30/35
 Notif. for insp. none
 Approval Tag issued 10/15/35, C.M.
 Oil Burner Check List (date) 10/15/35

1. Kind of heat	<u>Steam</u>
2. Label	<u>✓</u>
3. Anti-siphon	<u>✓</u>
4. Oil storage	<u>✓</u>
5. Tank distance	<u>✓</u>
6. Vent pipe	<u>✓</u>
7. Fill pipe	<u>✓</u>
8. Gauge	<u>✓</u>
9. Rigidity	<u>✓</u>
10. Feed safety	<u>✓</u>
11. Pipe sizes and material	<u>✓</u>
12. Control valve	<u>✓</u>
13. Ash pit vent	<u>✓</u>
14. Temp. or pressure safety	<u>✓</u>
15. Instruction card	<u>✓</u>
16.	

NOTES

9/14/35, Could not get
in case



FILL IN COMPLETELY AND SIGN WITH INK

PERMIT ISSUED
Permit No. 1380

APPLICATION FOR PERMIT FOR HEATING, COOKING OR POWER EQUIPMENT

To the INSPECTOR OF BUILDINGS, PORTLAND, ME.

Portland, Maine, September 25, 1931

The undersigned hereby applies for a permit to install the following heating, cooking or power equipment in accordance with the Laws of Maine, the Building Code of the City of Portland, and the following specifications:

Location 85 Deerfield Road Use of Building Residence

Name and address of owner Mrs. S. J. Smith Ward 8

Contractor's name and address Ballard Oil & Equipment Co. of Maine Telephone R6223
124 High Street, Portland, Maine

General Description of Work

To install Oil burning equipment P.C. Unit

IF HEATER, POWER BOILER OR COOKING DEVICE 9/25/31 **CERTIFICATE OF OCCUPANCY REQUIREMENT IS WAIVED**

Is heater or source of heat to be in cellar? Yes If not, which story 1 Kind of floor Concrete **NOTIFICATION BEFORE LATENT FOR CLOSING IS WAIVED**

Material of supports of heater or equipment (concrete floor or what kind) Concrete

Minimum distance to wood or combustible material, from top of boiler or casing top of furnace, _____
from top of smoke pipe _____, from front of heater _____ from sides or back of heater _____

IF OIL BURNER

Name and type of burner #4 Quiet Ballard Jr. Labeled and approved by Underwriters' Laboratories? Yes

Will operator be always in attendance? No Type of oil feed (gravity or pressure) Pressure

Location oil storage Basement No. and capacity of tanks 1 - 275 gallons

Will all tanks be more than seven feet from any flame? Yes how many tanks fireproofed? None

Amount of fee enclosed \$1.00 (\$1.00 for one heater, etc., 50 cents additional for each additional heater, etc., in same building at same time.)

INSPECTION COPY

Signature of contractor Ballard Oil & Equipment Co.

E.P. Hacker OF MAINE. TREASURER

Ward 8 Permit No. 31/1880
Location 85 Thefield Road
Owner Mrs A J Smith
Date of permit 9/26/31
Notif. closing-in _____
Inspn. closing-in _____
Final Notif. 10/5/31
Final Inspn. 10/6/31
Cert. of Occupancy issued None

NOTES

10/6/31 - Installation
O.K. and certificate
of inspection left. Agd.

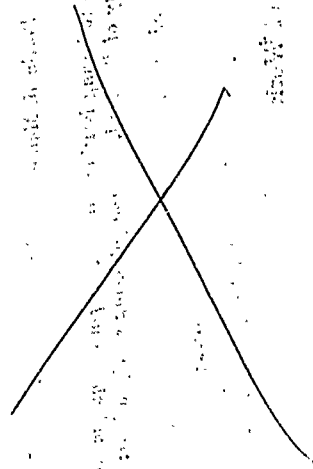

78 Deerfield Road

Garage for Mrs Jennie Smith
to be built by J.H. Jackson

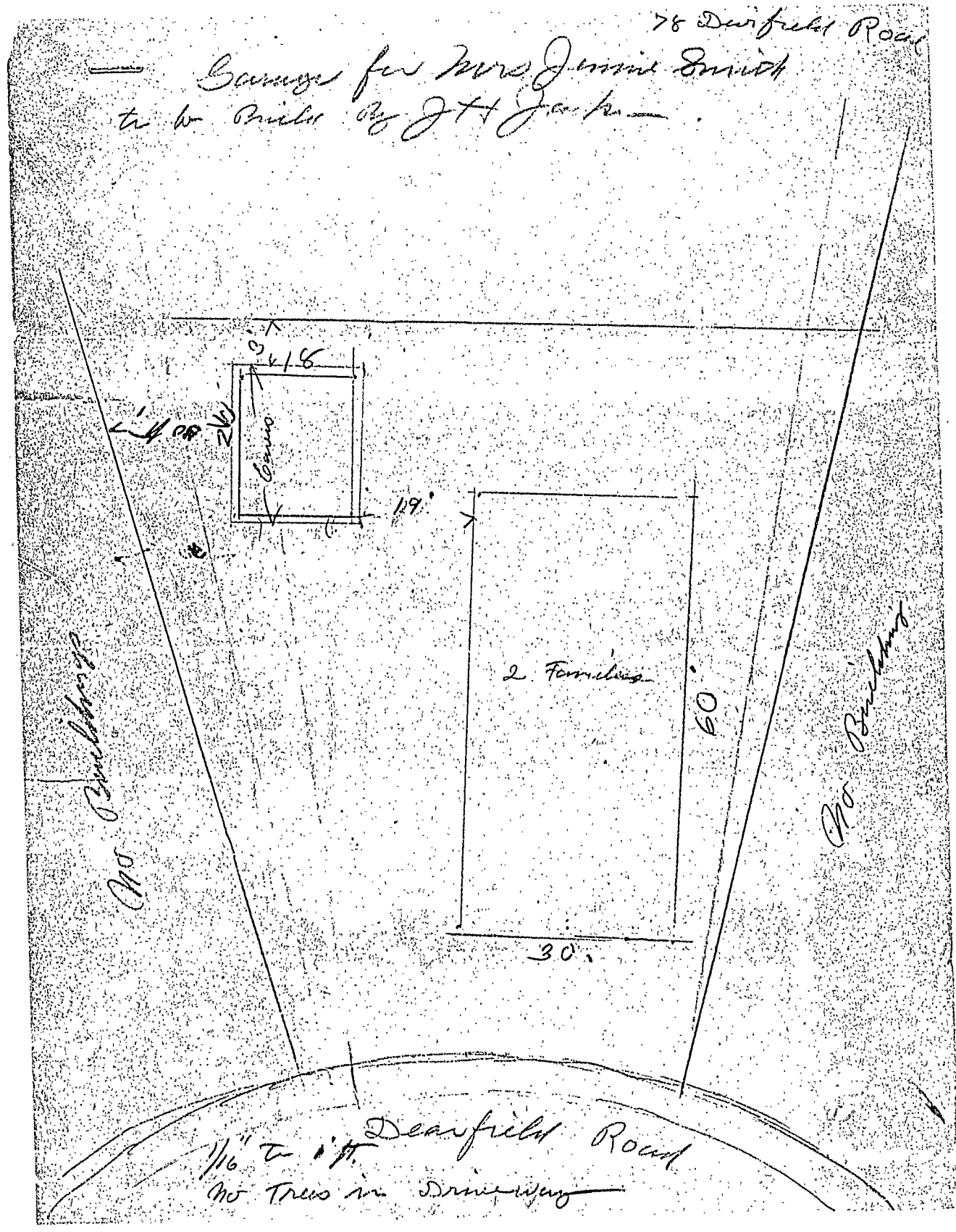

No Building

No Building

1/16 to 1/4 Deerfield Road
No Trees in Driveway



APPLICATION FOR PERMIT TO BUILD

CLASS BUILDING

To the INSPECTOR OF BUILDINGS, PORTLAND, ME., August 16, 1936 19

The undersigned hereby applies for a permit to build, according to the following specifications, the Laws of the State of Maine, and the Building Ordinance of the City of Portland.

Location 73 Deerfield Rd Ward 4 Within Fire Limits? no
 Owner's name and address? Mrs Joseph S. 102 Concord Street
 Contractor's name and address? J. J. Jackson, 25 North Street
 Architect's name and address? _____
 Proposed occupancy of building (purpose)? _____
 No. families? _____ apartments? _____ lodgers? _____
 Size, front? 19, depth? 20, No. stories? 1, height, average grade to highest point of roof? 13
 To be erected on solid or filled land? solid earth or rock? _____
 Material of foundation? concrete Thickness, top? _____ bottom? _____
 Material of underpinning? _____ over 4 ft. high? _____ thickness? _____
 Kind of roof (pitch, hip, etc.)? hip Kind of roofing? asphalt
 Kind of heat? no Material of chimney? _____, of lining? _____

Size of Framing Members

Corner posts? 4x4 Sills? 2x6 Rafters or roof beams? 2x4 on center? 10
 Material and size of columns under girders? no on center? _____
 Ledger board used? no Size? _____ Studs (outside walls and carrying partitions) 2 x 4 16" O. C.
 Girders 6" x 8" or larger. Bridging in every floor and flat roof span over 8 feet. Sills and corner posts will be all one piece in cross section.

Floor timbers: 1st floor concrete, 2nd _____, 3rd _____, 4th _____
 On centers: 1st floor _____, 2nd _____, 3rd _____, 4th _____
 Span: 1st floor _____, 2nd _____, 3rd _____, 4th _____

If 1st or 2nd Class Building

External walls } thickness { 1st story _____, 2nd story _____
 Party walls } { 1st story _____, 2nd story _____
 Material of cornice? _____ How fastened? _____

If Apartment, Tenement or Lodging House

Dimensions of lot? _____
 Descriptions of other buildings on lot? _____
 Clear distance to rear lot line? _____, to one side lot line? _____, to other side lot line? _____

If a Private Garage

No. cars now accommodated on lot? none Total number to be accommodated? 2
 Other buildings on same lot? dwelling 2 families
 Distance from nearest present building to proposed garage? 20 ft
All parts of garage, including eaves, will be at least 2 ft. from all lot lines.
 Garage will be at least 100 feet from nearest windows of adjoining property.
 Will there be a heating plant within building? no
 If so, how protected? _____

Miscellaneous

Will the above construction require the removal or disturbing of any shade tree on the public street? no
 Plans filed as part of this application? attached No. sheets? _____
 Estimated total cost \$ 600. Fee? 1.00

Signature of owner or authorized representative? _____

NOTIFICATION
 before
 PLACING OR CLOSING
 is
 WAIVED

at 421 Forest Ave

26
828

78 Deerfield Rd
Jennie Smith
Aug 17/26

~~10~~
~~8~~
26



APPLICATION FOR PERMIT TO BUILD

3rd CLASS BUILDING

YOU are responsible for compliance with the laws of the City of Portland, Maine, and the Building Ordinance of the City of Portland.

Application and Fee June 20, 1930 19

To the INSPECTOR OF BUILDINGS, PORTLAND, ME. Failure To Begin Work.

The undersigned hereby applies for a permit to build, according to the following specifications, the Laws of the State of Maine, and the Building Ordinance of the City of Portland:

Location 87 Beechfield Rd Ward 8 Within Fire Limits? no
 Owner's name and address? Mrs Jennie Smith, 42 Concord Street
 Contractor's name and address? J H Jackson, 25 Abbott Street
 Architect's name and address? _____
 Proposed occupancy of building (purpose)? dwelling
 No. families? 2 apartments? _____ lodgers? _____
 Size, front? 27, depth? 60 No. stories? 2 1/2, height, average grade to highest point of roof? 20
 To be erected on solid or filled land? solid earth or rock? _____
 Material of foundation? concrete Thickness, top? 12 bottom? 14
 Material of underpinning? brick over 4 ft. high? 2 1/2 in thickness? 3 in
 Kind of roof (pitch, hip, etc.)? pitch Kind of roofing? asphalt
 Kind of heat? stove Material of chimney? brick, of lining? tile

SIZE OF FRAMING MEMBERS

Corner posts? 4x5 Sills? 6x8 Rafters or roof beams? 2x6 on center? 24
 Material and size of columns under girders? 4 1/2 iron pipe on center? 8ft
 Ledger board used? no Size? _____ Studs (outside walls and carrying partitions) 2 x 4 16" O. C.
 Girders 6" x 8" or larger. Bridging in every floor and flat roof span over 8 feet. Sills and corner posts will be all one piece in cross section.
 Floor timbers: 1st floor 2x8, 2nd 2x8, 3rd 2x8 unfinished attic
 On centers: 1st floor 16, 2nd 16, 3rd 15, 4th _____
 Span: 1st floor not over 12ft, 2nd not over 12ft, 3rd not over 12ft, 4th _____

IF 1ST OR 2ND CLASS BUILDING

External walls } thickness { 1st story _____, 2nd story _____
 Party walls } thickness { 1st story _____, 2nd story _____
 Material of cornice? _____ How fastened? _____

IF APARTMENT, TENEMENT OR LODGING HOUSE

Dimensions of lot? _____
 Descriptions of other buildings on lot? _____
 Clear distance to rear lot line? _____, to one side lot line? _____, to other side lot line? _____

IF A PRIVATE GARAGE

No. cars to be accommodated? _____
 Other buildings on same lot? _____
 Distance from nearest present building to proposed garage? _____
All parts of garage, including eaves, will be at least 2 ft. from all lot lines.
 Garage will be at least _____ feet from nearest windows of adjoining property.
 Will there be a heating plant within building? _____
 If so, how protected? _____

MISCELLANEOUS

Will the above construction require the removal or disturbing of any shade tree on the public street? no
 Plans filed as part of this application? no No. sheets? _____
 Estimated total cost \$ 12,000. Fee? 1.00

Signature of owner or authorized representative? _____

8 ²⁶/₆₂₀

87 Deerfield St
Jennie Smith
June 22/26

8/3/26

9:15

8/4/26

~~Greentree~~

FILL IN AND SIGN WITH INK

950901



APPLICATION FOR PERMIT FOR HEATING, COOKING OR POWER EQUIPMENT

Portland, Maine,

PERMIT ISSUED
AUG 28 1995
CITY OF PORTLAND

To the INSPECTOR OF BUILDINGS, PORTLAND, ME. 28 August 1995

The undersigned hereby applies for a permit to install the following heating, cooking or power equipment in accordance with the Laws of Maine, the Building Code of the City of Portland, and the following specifications:

Location 85 Deerfield Rd Use of Building 2-fam No. Stories 2 New Building Existing " Name and address of owner of appliance Loeb Installer's name and address Buggy Oil Service, Inc. Telephone 772-4631 P.O. Box 1018 Portland, ME 04104

General Description of Work

To install Replace heating systems oil fired steams (2)

IF HEATER, OR POWER BOILER

Location of appliance basement (each) any burnable material in floor surface or beneath? no If so, how protected? Kind of fuel? #2 oil Minimum distance to burnable material, from top of appliance or casing top of furnace 4' From top of smoke pipe 2' From front of appliance 5' From sides or back of appliance 12" Size of chimney flue 8" Other connections to same flue no If gas-fired, how vented? Rated maximum demand per hour 135,000 Will sufficient fresh air be supplied to the appliance to insure proper and safe combustion? yes

IF OIL BURNER

Name and type of burner Beckatt Labelled by underwriters' laboratories? yes Will operator be always in attendance? no Does oil supply line feed from top or bottom of tank? bottom Type of floor beneath burner concrete Size of vent pipe 1 1/4" Location of oil storage basement Number and capacity of tanks 2 @ 275 Low water shut off yes Make McDonald Miller No. 67 Will all tanks be more than five feet from any flame? yes How many tanks enclosed? none Total capacity of any existing storage tanks for furnace burners 2 @ 275 each

IF COOKING APPLIANCE

Location of appliance Any burnable material in floor surface or beneath? If so, how protected? Height of Legs, if any Skirting at bottom of appliance? Distance to combustible material from top of appliance? From front of appliance From sides and back From top of smokenipe Size of chimney flue Other connections to same flue Is hood to be provided? If so, how vented? Forced or gravity? If gas fired, how vented? Rated maximum demand per hour

MISCELLANEOUS EQUIPMENT OR SPECIAL INFORMATION

George Cookson - Buggy Oil Master Oil Burner #5609

2 replacements @ 15.00 each

Amount of fee enclosed? 30.00

APPROVED:

[Signature]

Will there be in charge of the above work a person competent to see that the State and City requirements pertaining thereto are observed? yes

CS 300

FILE COPY

Signature of Installer

F. George Cookson
Buggy Oil Service

ELECTRICAL PERMIT

City of Portland, Me.



To the Chief Electrical Inspector, Portland Maine:
 The undersigned hereby applies for a permit to make electrical installations
 in accordance with the laws of Maine, the City of Portland Electrical Ordinance,
 National Electrical code and the following specification:

Date 15 Sept 95

Permit # 2459

LOCATION: 85 Deerfield Rd

OWNER Loeb, Broda ADDRESS _____

							TOTAL EACH FEE	
OUTLETS		Receptacles	Switches					.20
FIXTURES		(number of)						
		Incandescent	fluorescent					.20
		fluorescent strip						.20
SERVICES		Upgrade 60 - 100						
		Overhead		TTL AMPS TO	800	100	15.00	15.00
		Underground			800		15.00	
TEMPORARY SERV.								
		Overhead		AMPS OVER	800		25.00	
		Underground			800		25.00	
METERS		(number of)				X 2	1.00	2.00
MOTORS		(number of)					2.00	
RESID/COM		Electric units					1.00	
HEATING		oil/gas units					5.00	
APPLIANCES		Ranges	Cook Tops	Wall Ovens			2.00	
		Water heaters	Fans	Dryers			2.00	
Disposals		Dishwasher	Compactors	Others (denote)			2.00	
MISC: (number of)		Air Cond/win					3.00	
		Air Cond/cent					10.00	
		Signs					5.00	
		Pools					10.00	
		Alarms/res					5.00	
		Alarms/com					15.00	
		Heavy Duty					2.00	
		Outlets						
		Circus/Carnv					25.00	
		Alterations					5.00	
		Fire Repairs					15.00	
		E Lights					1.00	
		E Generators					20.00	
		Panels					4.00	
TRANSFER		0-25 Kva					5.00	
		25-200 Kva					8.00	
		Over 200 Kva					10.00	
							TOTAL AMOUNT DUE	
							MINIMUM FEE 25.00 25.00	

INSPECTION: Will be ready 9/21 12:00 or will call _____

CONTRACTORS NAME L & L Electric John LaBrecque
 ADDRESS 151 No. Gorham Rd Gorham, ME 04038
 TELEPHONE 892-6217
 MASTER LICENSE No. 2459
 LIMITED LICENSE No. _____

SIGNATURE OF CONTRACTOR
John LaBrecque



FILL IN AND SIGN WITH INK

950901

APPLICATION FOR PERMIT FOR HEATING, COOKING OR POWER EQUIPMENT

PERMIT ISSUED AUG 28 1995 CITY OF PORTLAND

Portland, Maine

To the INSPECTOR OF BUILDINGS, PORTLAND, ME.

28 August 1995

The undersigned hereby applies for a permit to install the following heating, cooking or power equipment in accordance with the Laws of Maine, the Building Code of the City of Portland, and the following specifications:

Location 85 Deerfield Rd Use of Building 2-fam No. Stories 2 New Building Existing " Name and address of owner of appliance Loeb Installer's name and address Breggy Oil Service, Inc. Telephone 772-4631 P.O. Box 1018 Portland, ME 04104

General Description of Work

To install Replace heating systems oil fired steams (2)

IF HEATER, OR POWER BOILER

Location of appliance basement (each) Any burnable material in floor surface or beneath? no If so, how protected? Kind of fuel? #2 oil Minimum distance to burnable material, from top of appliance or casing top of furnace 4' From top of smoke pipe 2' From front of appliance 5' From sides or back of appliance b=12" Size of chimney flue 8" Other connections to same flue no If gas fired, how vented? Rated maximum demand per hour 135,000 Will sufficient fresh air be supplied to the appliance to insure proper and safe combustion? Yes

IF OIL BURNER

Name and type of burner Beckett Labelled by underwriters' laboratories? Yes Will operator be always in attendance? no Does oil supply line feed from top or bottom of tank? bottom Type of floor beneath burner concrete Size of vent pipe 1 1/4" Location of oil storage basement Number and capacity of tanks 2 @ 275 Low water shut off yes Make McDonald Miller No. 67 Will all tanks be more than five feet from any flame? yes How many tanks enclosed? none Total capacity of any existing storage tanks for furnace burners 2 @ 275 each

IF COOKING APPLIANCE

Location of appliance Any burnable material in floor surface or beneath? If so, how protected? Height of Legs, if any Skirting at bottom of appliance? Distance to combustible material from top of appliance? From front of appliance From sides and back From top of smokepipe Size of chimney flue Other connections to same flue Is hood to be provided? If so, how vented? Forced or gravity? If gas fired, how vented? Rated maximum demand per hour

MISCELLANEOUS EQUIPMENT OR SPECIAL INFORMATION

George Cookson - Breggy Oil Master Oil Burner #5609

2 replacements @ 15.00 each

Amount of fee enclosed? 30.00

APPROVED:

Handwritten signature

Will there be in charge of the above installation a person competent to see that the State and City requirements are observed? Yes

- 1. 1 1/2" FILL PIPE
2. 1 1/4" VENT PIPE
3. Kind of heat
4. Burner rigidity & support
5. Name & Label
6. Remote control
7. High limit control
8. Main cut-off switch
9. Low water control
10. High limit control
11. Piping support & protection
12. Valves in supply lines
13. Capacity of tanks
14. Tank rigidity & support
15. Oil gauge
16. Restriction card
17. Oil leaks determination
18. Adequate venting
19. Sufficient space to connect
20. Thermal control switch

Signature of Installer

George Cookson Breggy Oil Service

CS 300

INSPECTION COPY

NOTES

0218 S 01A

Heating system
installed and
OK

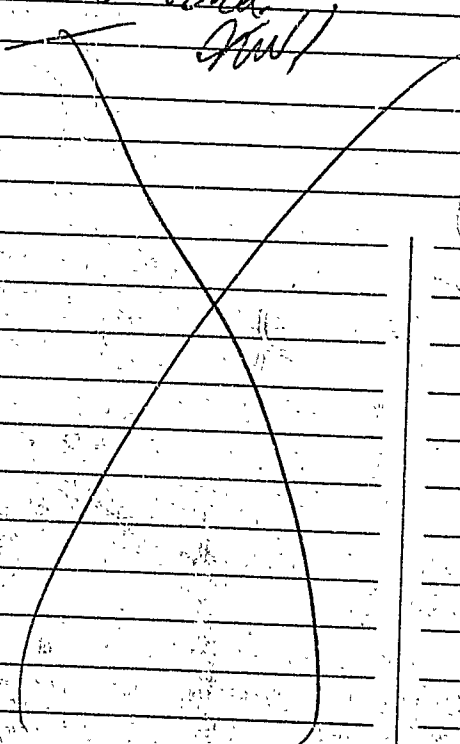

Permit No. _____

Location _____

Owner _____

Date of permit _____

Approved _____

1. 1 1/2" P.I.L. Pipe
2. 1/4" VENT PIPE
3. Kind of heat
4. Burner, rigidity & ...
5. Flame & Label
6. Remote control
7. High limit control
8. Main ...
9. ...

