



SUBSURFACE WASTEWATER DISPOSAL SYSTEM APPLICATION

C.P.M.

PROPERTY LOCATION

City, Town, or Plantation: PORTLAND, HOUSE ISLAND

Street or Road: 0 HOUSE ISLAND

Subdivision, Lot #: "HOUSE 2"

>>CAUTION: LPI APPROVAL R

Town/City: _____ Permit: _____

Date Permit Issued: / / Fee \$ _____

Date: 11/12/14

Reviewed for Code Compliance
Inspections Division
Approved with Conditions

OWNER/APPLICANT INFORMATION

Name (last, first, MI): MONA VINCENT

Owner Applicant

Mailing Address of Owner/Applicant: 16 RUNNING TIDE ROAD CAPE ELIZABETH

Daytime Tel. #: 240-216-4241

Local Plumbing Inspector Signature: _____

The Subsurface Wastewater Disposal System ~~shall not~~ be installed until a Permit is issued by the Local Plumbing Inspector. The Permit shall authorize the owner or installer to install the disposal system in accordance with this application and the Maine Subsurface Wastewater Disposal Rules.

Municipal Tax Map # 110 Lot # A0001

OWNER OR APPLICANT STATEMENT

I state and acknowledge that the information submitted is correct to the best of my knowledge and understand that any falsification is reason for the Department and/or Local Plumbing Inspector to deny a permit.

Monika M. Mulhern 10/20/14
Signature of Owner/Applicant Date
LPA INC.

CAUTION: INSPECTION REQUIRED

I have inspected the installation authorized above and found it to be in compliance with the Subsurface Wastewater Disposal Rules Application.

Local Plumbing Inspector Signature: _____ (1st) Date Approved: _____

Local Plumbing Inspector Signature: _____ (2nd) Date Approved: _____

PERMIT INFORMATION

TYPE OF APPLICATION

1. First Time System
 2. Replacement System
Type Replaced: UNKNOWN
Year Installed: UNKNOWN

3. Expanded System
 a. <25% Expansion
 b. >25% Expansion
 4. Experimental System
 5. Seasonal Conversion

THIS APPLICATION REQUIRES

1. No Rule Variance
 2. First Time System Variance
 a. Local Plumbing Inspector Approval
 b. State & Local Plumbing Inspector Approval
 3. Replacement System Variance
 a. Local Plumbing Inspector Approval
 b. State & Local Plumbing Inspector Approval
 4. Minimum Lot Size Variance
 5. Seasonal Conversion Permit

DISPOSAL SYSTEM COMPONENTS

1. Complete Non-Engineered System
 2. Primitive System (graywater & alt toilet)
 3. Alternative Toilet, specify: _____
 4. Non-Engineered Treatment Tank (only)
 5. Holding Tank, _____ gallons
 6. Non-Engineered Disposal Field (only)
 7. Separated Laundry System
 8. Complete Engineered System (2000gpd+)
 9. Engineered Treatment Tank (only)
 10. Engineered Disposal Field (only)
 11. Pre-treatment, specify: _____
 12. Miscellaneous components

SIZE OF PROPERTY

10.3 +/- SQ. FT. ACRES

SHORELAND ZONING

Yes No

DISPOSAL SYSTEM TO SERVE

1. Single Family Dwelling Unit, No. of Bedrooms: 4
 2. Multiple Family Dwelling, No of Units: _____
 3. Other: _____ (specify)

Current Use Seasonal Year Round Undeveloped

TYPE OF WATER SUPPLY

1. Drilled Well 2. Dug Well 3. Private
 4. Public 5. Other: _____

DESIGN DETAILS (SYSTEM LAYOUT SHOWN ON PAGE 3)

TREATMENT TANK

1. Concrete
 a. Regular b. Low Profile
 2. Plastic
 3. Other: _____

CAPACITY: 1000 GAL

DISPOSAL FIELD TYPE & SIZE

1. Stone Bed 2. Stone Trench
 3. Proprietary Device
 a. Cluster array c. Linear
 b. Regular d. H-20 loaded
 4. Other: _____

SIZE: 1344 sq. ft. lin. ft.
28 ELJEN GSF UNITS

GARBAGE DISPOSAL UNIT

1. No 2. Yes 3. Maybe

If Yes or Maybe, specify one below:

a. Multi-compartment tank
 b. _____ tanks in series
 c. Increase in tank capacity
 d. Filter on tank outlet

DESIGN FLOW

360 gallons per day
BASED ON:
 1. Table 4A (dwelling unit(s))
 2. Table 4C (other facilities)

SHOW CALCULATIONS for other facilities

4 BEDROOMS AT 90 GALLONS PER DAY EACH

SOIL DATA & DESIGN CLASS

PROFILE CONDITION: 4 / B

at Observation Hole # TP 2A
Depth: _____
of Most Limiting Soil Factor

DISPOSAL FIELD SIZING

1. Medium - 2.6 sq.ft./gpd
 2. Medium-Large - 3.3 sq.ft./gpd
 3. Large - 4.1 sq.ft./gpd
 4. Extra-Large - 5.0 sq.ft./gpd

EFFLUENT/EJECTOR PUMP

SEE SEPTIC TANK NOTE ON PAGE 3

1. Not required
 2. May be required
 3. Required

Specify only for engineered systems:
DOSE: _____ gallons

3. Section 4G (meter readings)
ATTACH WATER-METER DATA

LATITUDE AND LONGITUDE
at center of disposal area

Lat. 43 d 39 m 16 s
Lon. 70 d 12 m 28 s
If g.p.s., state margin of error

SITE EVALUATOR STATEMENT

I certify that on 10/11/14 (date) I completed a site evaluation on this property and state that the data reported is accurate and that the proposed system is in compliance with the Subsurface Wastewater Disposal Rules (10-144A CMR 241).

Albert Frick 163 10/10/14
Site Evaluator Signature SE # Date

ALBERT FRICK (207) 839-5563 ALBERT@ALBERTFRICK.COM
Site Evaluator Name Printed Telephone Number E-mail Address

ALBERT FRICK ASSOCIATES - 95A COUNTY ROAD ROAD GORHAM, MAINE 04038 - (207) 839-5563
Note: Changes to or deviations from the design should be confirmed with the Site Evaluator

SUBSURFACE WASTEWATER DISPOSAL SYSTEM APPLICATION

Maine Dept.
Division of H&E
(207) 297-
[unclear]



Town, City, Plantation
PORTLAND, HOUSE ISLAND

Street, Road, Subdivision
0 HOUSE ISLAND ("HOUSE 2")

Own:
VIN

SITE PLAN

Scale 1" = 100 Ft.
or as shown

SITE
(Att:
Atlas
Vari:

Reviewed for Code Compliance
Inspections Division
Approved with Conditions

Date: **11/12/14**

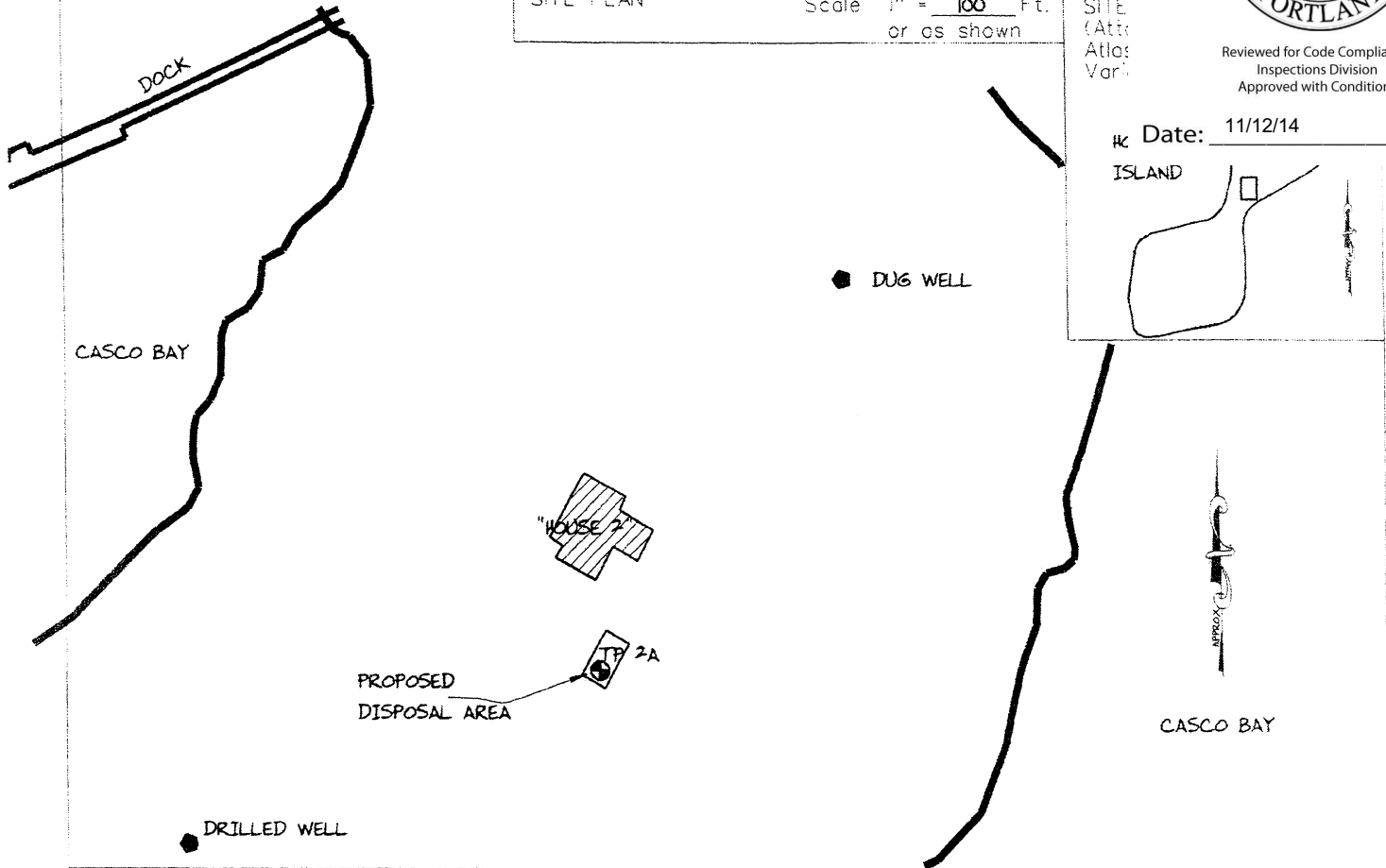

SOIL DESCRIPTION AND CLASSIFICATION (Location of Observation Holes Shown Above)

Observation Hole TP 2A Test Pit Boring
" Depth of Organic Horizon Above Mineral Soil

DEPTH BELOW MINERAL SOIL SURFACE (Inches)	Texture	Consistency	Color	Mottling
0			DARK	
	SANDY		BROWN	
10	LOAM			
	LOAMY	FRIABLE	DARK	NONE
20	SAND		YELLOWISH BROWN	EVIDENT
30	LOAMY SAND & SAND		YELLOWISH BROWN	
40				
50	LIMIT OF EXCAVATION			

Soil Classification: 4 B
Profile Condition %
Slope: _____ %
Limiting Factor: _____
 Ground Water
 Restrictive Layer
 Bedrock
 Pit Depth

Observation Hole _____ Test Pit Boring
" Depth of Organic Horizon Above Mineral Soil

DEPTH BELOW MINERAL SOIL SURFACE (Inches)	Texture	Consistency	Color	Mottling
0				
10				
20				
30				
40				
50				

Soil Classification: _____
Profile Condition %
Slope: _____ %
Limiting Factor: _____
 Ground Water
 Restrictive Layer
 Bedrock
 Pit Depth

Albert Frick
Site Evaluator Signature

163
SE

10/10/14
Date

Page 2 of 3
HHE-200 Rev. 10-02



SUBSURFACE WASTEWATER DISPOSAL SYSTEM APPLICATION

Maine
Division
(207)

Town, City, Plantation: **PORTLAND, HOUSE ISLAND**
 Street, Road, Subdivision: **0 HOUSE ISLAND ("HOUSE 2")**
 VINCE

Reviewed for Code Compliance
 Inspections Division
 Approved with Conditions

Date: 11/12/14

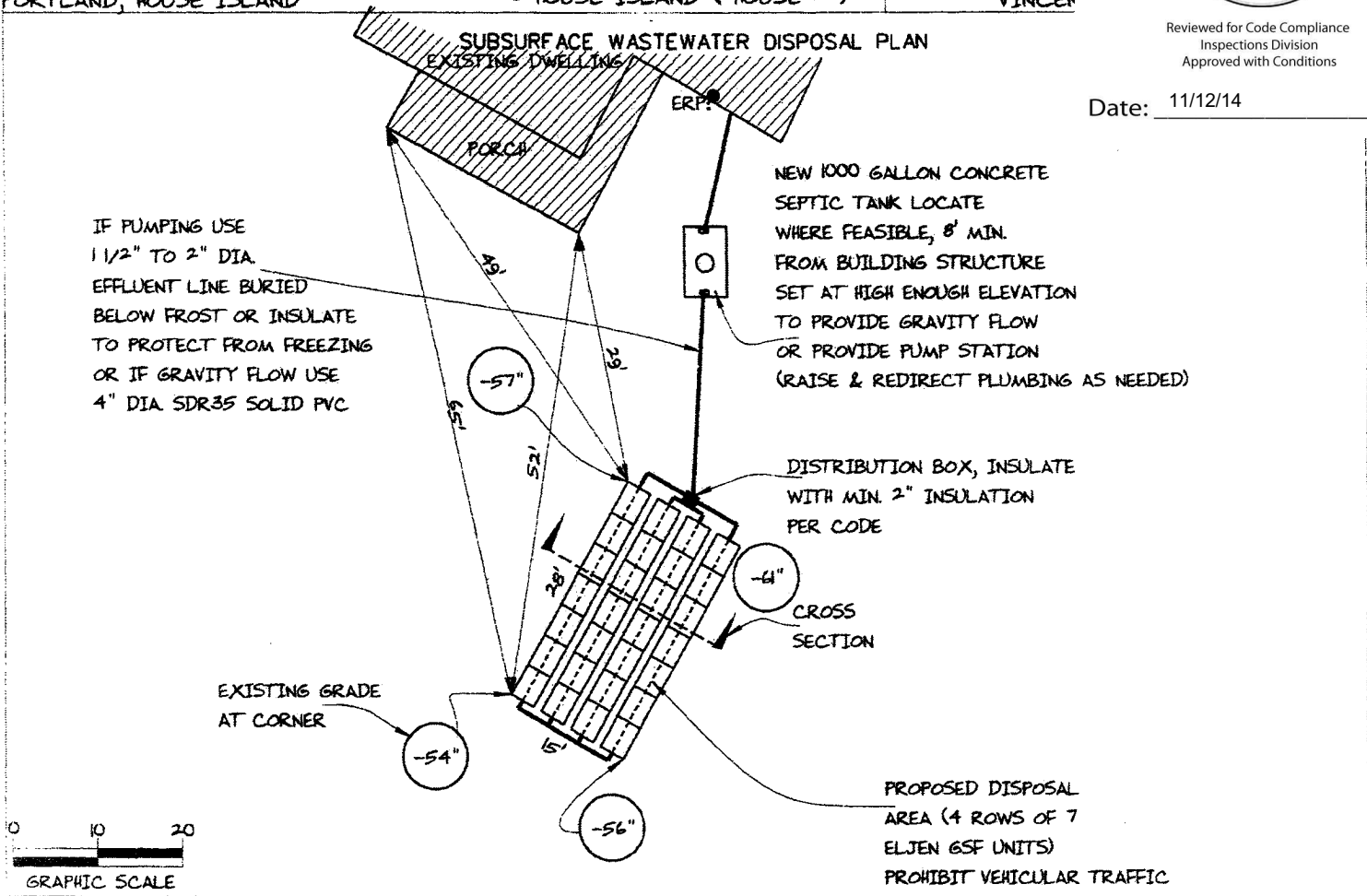

FILL REQUIREMENTS

Depth of Fill (Upslope) : 0"
 Depth of Fill (Downslope) : 0"
 DEPTHS AT CROSS-SECTION (shown below)

CONSTRUCTION ELEVATIONS

Finished Grade Elevation
 Top of Distribution Pipe or Proprietary Device
 Bottom of Disposal Area

SEE DETAIL BELOW
 ELEVATION REFERENCE POINT
 TOP OF GRANITE FOUNDATION
 Location & Description
 STONE AT BASEMENT WINDOW OPENING
 Reference Elevation is: 0.0' or 2.2' ABOVE GROUND LEVEL

DISPOSAL AREA CROSS SECTION

SCALE:
 VERTICAL: 1" = 5 FT
 HORIZONTAL: 1" = 5 FT

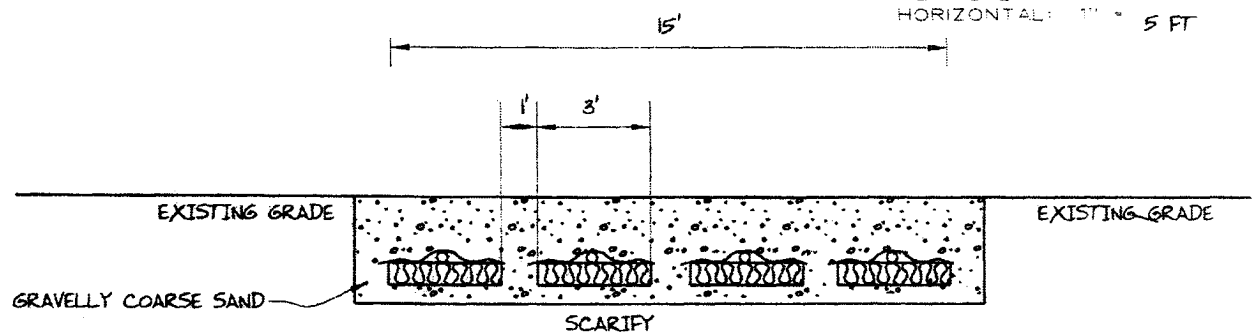

DEPTH BELOW ERP:

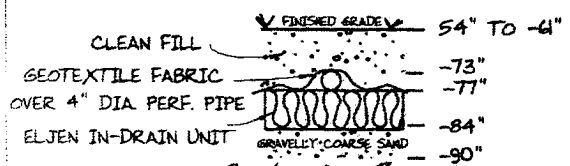

Albert Frick
 Site Evaluator Signature

163
 SE *

10/16/14
 Date