



109 B
F051

May 1st, 2012

City of Portland
Tammy Munson
Code Enforcement

RE: Septic System
Property Owner, Dana Bowdoin
Church Road, Cliff Island ME

This written statement is to certify that Bowdoin Excavation LLC scarified surface area for septic bed prior to the installation of Septic System on Church Street, Cliff Island ME per State of Maine Surface Waste Water Disposal Rules/Guidelines. As well as scarifying, Bowdoin Excavation LLC, stripped beneath entire fill area & near surface roots removing any large rocks. A small apple tree was removed and disposed of. Filter Fabric was placed per specified guidelines. D-Box installed and solid pipe connections installed. Area was loamed, seed and hayed per specs.

If you have any questions please do not hesitate to contact us @ 207-829-3160.

Respectfully,

Tricia Bowdoin
Office Manager



DEP FACT SHEET

Overboard Discharge System Abandonment Procedures and Abandonment Certification

Created: March 2004

Updated: October 2010

Contact: (207) 287-3901

What is an overboard discharge?

Overboard discharges: licenses and abandonment 06-096 CMR 596(8) (effective September 13, 2003) contains specific requirements for the proper abandonment of OBD treatment systems.

How do I abandon an overboard discharge system?

When an overboard discharge treatment system is not longer necessary or is replaced by an alternative treatment system, it must be properly abandoned within 90 days following successful installation of an alternative or abandonment of use as follows.

Wastewater remaining in the system must be discharged in accordance with the active or most recently expired license or permit or removed and disposed at a facility authorized by the Department to receive such wastes. The property owner must also perform the following, as applicable: Please check the appropriate boxes to indicate the task has been completed.

A. Mechanical OBDs.

- Mechanical treatment systems must be aerated until 24 hours before they are emptied. After the contents have settled, the supernatant liquid may be discharged through the chlorinator at a rate that does not exceed the design capacity of the chlorinator or the chlorine detention tanks. Wastewater containing settled solids may not be discharged to the water.
- The contents of the chlorinator may be emptied to the water no sooner than 30 minutes after last receiving wastewater. Any solids contained in the chlorinator may not be discharged to the water.
- Any tanks that contain untreated or primary treated wastewater, including but not limited to septic tanks and grease traps, may not be discharged directly or indirectly to the water.

B. Sandfilters.

- If the abandoned treatment system is a sandfilter with a capacity of less than 1,000 gallons per day, the chlorine contact tank must be removed and the hole filled with crushed gravel to serve as a dry well.
- If the capacity of the sandfilter is 1,000 gallons per day or greater, the down-gradient end of the sand filter must be excavated and the liner punctured sufficiently to allow rain water to drain.

C. All OBDs.

- All tanks including but not limited to, grease traps, septic tanks, mechanical treatment systems, pump stations and chlorinator tanks that are not utilized as part of an alternative method of waste water disposal must be disconnected and filled with soil or removed.
- Any exposed portion of the final effluent line must be removed and the remaining effluent pipe permanently sealed.
- The licensee must notify the Department of the abandonment of an OBD or installation of an alternative wastewater disposal system at least five (5) working days before commencing work. Written notification may be sent to the following address or you may call or e-mail OBD staff using the contact information below.

Overboard Discharge Program
OBD Abandonment
Department of Environmental Protection
State House Station 17
Augusta, ME 04333-0017
Bill Hinkel bill.hinkel@maine.gov 207-485-2281
Irene Saumur irene.saumur@maine.gov 207-485-2404

Once the OBD has been properly abandoned, complete this form, including the certification statement below, and mail to the Augusta DEP address provided above.

I certify under penalty of law that I am familiar with and understand the statutory requirements, CMR 06-096

596(8) (see below), for proper abandonment of overboard discharge systems as outlined above. I further

certify that the OBD system associated with Waste Discharge License #W N/A in _____,
(license number) (municipality)

Maine and located on property now or formerly owned by _____
(licensee) was

removed accordingly on 5/1/2012 I am aware there are significant penalties for improper
(date removed)
abandonment, removal and disposal of overboard discharge systems and their contents, including the possibility of fines and imprisonment.

*Contractor's Signature: Eric Bowdoin Date of Certification: 5.1.2012

*Contractor's Name: Eric Bowdoin Telephone Number: 829-3160

*Contractor's Name & Address: Bowdoin Excavation 24 Coniper Lane N. Yarmouth ME

* Alternatively, the signature may be the supervising authority such as a town official (usually the Local Plumbing Inspector or Code Enforcement Officer) or supervising representative from the sewer district. 04097

06-096 CMR 596(8):

8. **Abandonment of Overboard Discharge Systems.** When an overboard discharge treatment system is not longer necessary or is replaced by an alternative treatment system, it must be properly abandoned within 90 days as follows.

A. **Residual Wastewater.** Wastewater remaining in the system must be discharged in accordance with the active or most recently expired license or permit or removed and disposed at a facility authorized by the Department to receive such wastes. The property owner must also perform the following, as applicable.

- (1) Mechanical treatment systems must be aerated until 24 hours before they are emptied. After the contents have settled, the supernatant liquid may be discharged through the chlorinator at a rate that does not exceed the design capacity of the chlorinator or the chlorine detention tanks. Wastewater containing settled solids may not be discharged to the water.
- (2) The contents of the chlorinator may be emptied to the water no sooner than 30 minutes after last receiving wastewater. Any solids contained in the chlorinator may not be discharged to the water.
- (3) Any tanks that contain untreated or primary treated wastewater, including but not limited to septic tanks and grease traps, may not be discharged directly or indirectly to the water.

B. **Sand Filters.** If the abandoned treatment system is a sand filter with a capacity of less than 1000 gallons per day, the chlorine contact tank must be removed and the hole filled with crushed gravel to serve as a dry well. If the capacity of the sand filter is 1000 gallons per day or greater, the downgradient end of the sand filter must be excavated and the liner punctured sufficiently to allow rain water to drain.

C. **Tanks.** All tanks including but not limited to, grease traps, septic tanks, mechanical treatment systems, pump stations and chlorinator tanks that are not utilized as part of an alternative method of waste water disposal must be disconnected and filled with soil or removed.

D. **Effluent Pipe.** Any exposed portion of the final effluent line must be removed and the remaining effluent pipe permanently sealed.

E. **Notification.** The licensee must notify the Department in accordance with Section 6 (G) of this chapter.

SUBSURFACE WASTEWATER DISPOSAL SYSTEM APPLICATION

Department of Health & Human Services
 Division of Environmental Health
 (207) 287-5672 Fax: (207) 287-3165

Town, City, Plantation

Street, Road, Subdivision

Owner's Name

Portland: Cliff Island

515B Rear Church Rd.

Bowdoin, Dana

SITE PLAN

Scale 1" = 50 ft. or as shown

SITE LOCATION PLAN

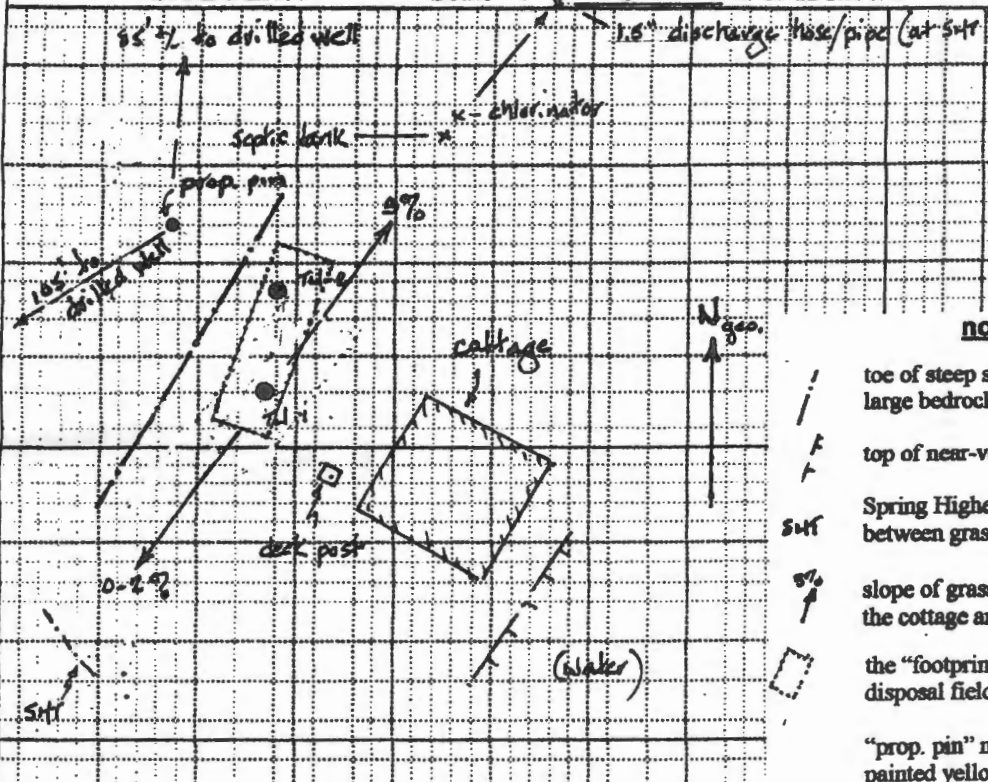

notes

- toe of steep slope... vegetated with loose, but rotted, large bedrock fragments and some exposed bedrock
- F- top of near-vertical rock face (13' from bldg.)
- SHT Spring Highest Tide ... marked by a sharp boundary between grass and rock or sand
- 5% slope of grassed surface in the rectangular area between the cottage and the steep slope to the northwest
- the "footprint" of a proposed 15'x 50' pipe in stone disposal field to serve a 3-bedroom structure
- "prop. pin" northwest of proposed field is a pipe painted yellow, located near a chlorinator

SOIL DESCRIPTION AND CLASSIFICATION (Location of Observation Holes Shown Above)

Observation Hole T1-1 Test Pit Boring
0.5 " Depth of Organic Horizon Above Mineral Soil

Depth Below Mineral Soil Surface (inches)	Texture	Consistency	Color	Mottling
0			10YR 5/2	
0-10	fine sandy loam	friable	v. dk grayish br.	old fill (?)
10-20			7.5YR 3/4	
20-30	loamy med. sand	loose	dk. br.	(none obsd.)
30-40				
40-50				(rebar refusal - bedrock - at 36")

Soil Classification	Slope	Limiting Factor	<input type="checkbox"/> Ground Water
<u>4</u> <u>IV</u>	<u>0-2%</u>	<u>36"</u>	<input type="checkbox"/> Restrictive Layer
Profile Condition			<input checked="" type="checkbox"/> Bedrock
			<input type="checkbox"/> Pit Depth

Observation Hole T1-2 Test Pit Boring
0.5 " Depth of Organic Horizon Above Mineral Soil

Depth Below Mineral Soil Surface (inches)	Texture	Consistency	Color	Mottling
0			7.5YR 3/4	
0-10	fine sandy loam	↑ friable	dk. br.	(none obsd.)
10-20	loamy sand	↓	10YR 5/4	
20-30			dk. yel. br.	
30-40				
40-50				

Soil Classification	Slope	Limiting Factor	<input type="checkbox"/> Ground Water
<u>4</u> <u>IV</u>	<u>3%</u>	<u>≥ 16"</u>	<input type="checkbox"/> Restrictive Layer
Profile Condition			<input type="checkbox"/> Bedrock
			<input checked="" type="checkbox"/> Pit Depth

Dana L. Lumb
 Site Evaluator Signature

248
 SE #

Nov. 21, 2011; Dec. 1, 2011
 Date

Dana Fax # 866-242-3971

Portland: Cliff Island

5153 Rear Church Rd.

Bowdoin, Dana

SUBSURFACE WASTEWATER DISPOSAL PLAN

SCALE: 1" = 20 FT.

construction notes:

- The system is to be installed following all requirements of the Maine Subsurface Waste Water Disposal Rules.
- Organic material (sod) should be stripped beneath the entire fill area. Near surface roots and large rocks should be removed. (The removal of any interfering trees might be considered.)
- Scarify soil surface before placing fill. Approximately 4" of fill should be mixed into the soil below the stone to create a "transitional horizon" (see Rules, section 11B.4., p. 88)
- A layer of filter fabric should be placed above the stone, as specified in the Rules, section 11F. 4, p.91.
- The d-box should have solid PVC pipe connections to each of the outer rows of distribution pipe.
- Final cover should consist of 6" of fill and 4" of loam. It should be raked, seeded, and mulched.

system location ties:

from ERP: 17' to S corner (-37") and 23' to E corner (-45")
 from location ref. (roofing nail in 6" white birch, 23" above grade) distances to the S and E corners should be measured before construction begins.

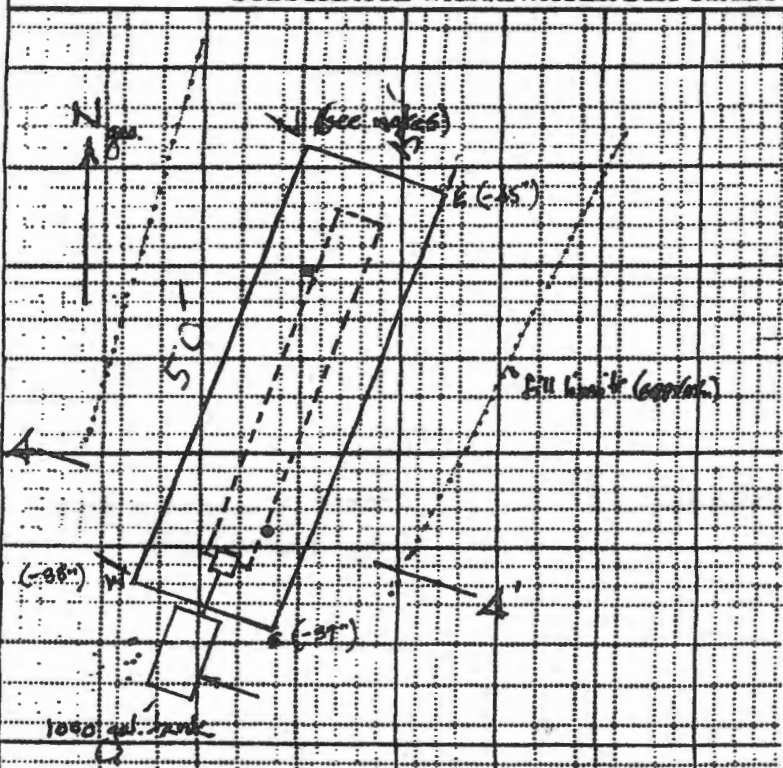

FILL REQUIREMENTS

CONSTRUCTION ELEVATIONS

ELEVATION REFERENCE POINT

Depth of Fill (Upslope) 30"
 Depth of Fill (Downslope) 36"

Finished Grade Elevation - 11"
 Top of Distribution Pipe or Proprietary Device - 21"
 Bottom of Disposal Area - 32"

Location & Description: Flagged wooden nail in deck post, 23" above grade
 Reference Elevation: 0"

DISPOSAL AREA CROSS SECTION

Scale

Horizontal 1" = 10 ft.
 Vertical 1" = 5 ft.

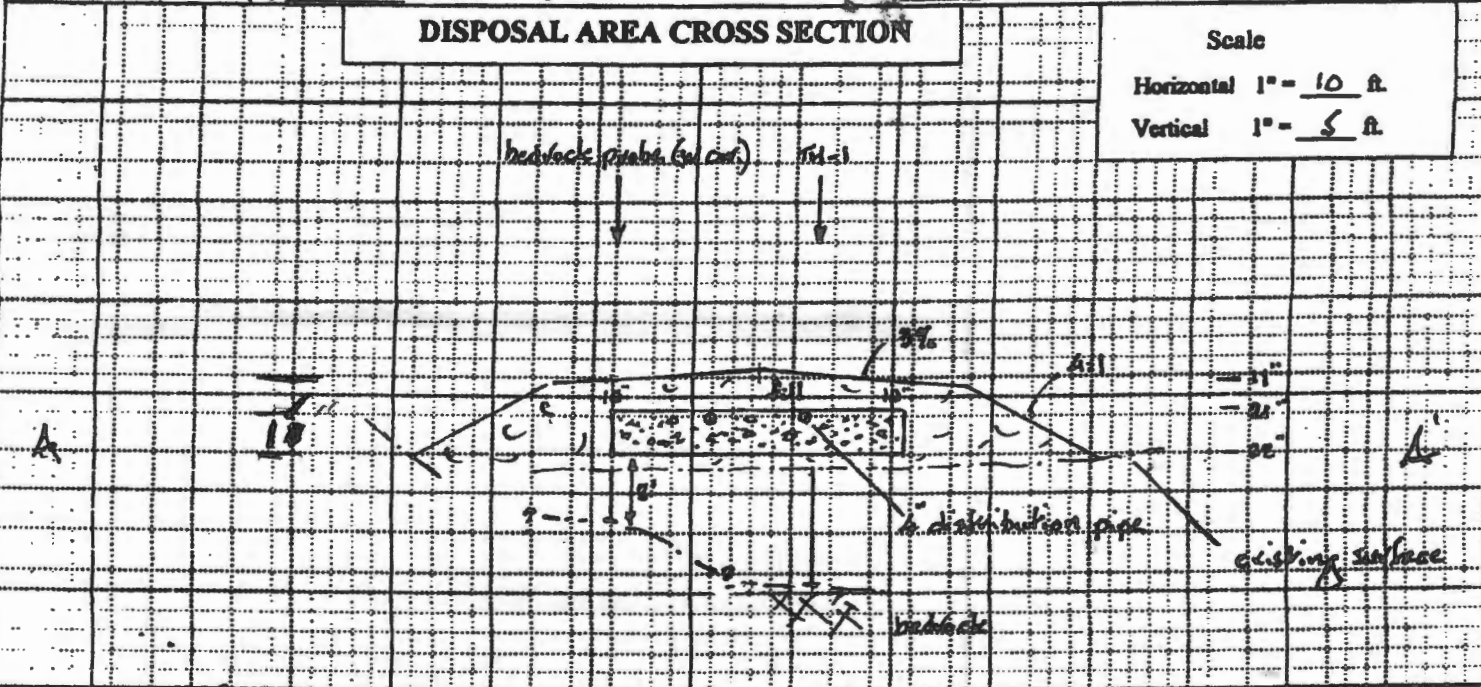

David W. Ludwig
 Site Evaluator Signature

248

SE #

Dec. 5, 2011

Date

DISPLAY THIS CARD IN PROMINENT FRONTAGE OF WORK



CITY OF PORTLAND

BUILDING PERMIT

Division of Community Development Bureau

Division of Community Development Bureau

Job ID: 20240100000000000000

Job ID: 20240100000000000000

This permit is issued for the proposed construction of a building. It is issued on the condition that the person or persons, firm or corporation accepting this permit shall comply with all of the provisions of the National Building Code and of the Ordinances of the City of Portland regulating the construction, maintenance and use of buildings and structures, and of the application on file in the department.

Not a permit for the proposed construction of a building. It is issued on the condition that the person or persons, firm or corporation accepting this permit shall comply with all of the provisions of the National Building Code and of the Ordinances of the City of Portland regulating the construction, maintenance and use of buildings and structures, and of the application on file in the department.

Fire Prevention Officer

Code Enforcement Officer - Plan Reviewer