

Note:

1. Attic/crawl space access by single hinged hatch/door 33" w x 30" h
2. Hinges placed on RHS so that door swings open into the attic area
3. Hatch sized to allow free 180 degree swing into crawl space
4. Hatch located in existing wall at top of existing stairs to second floor.

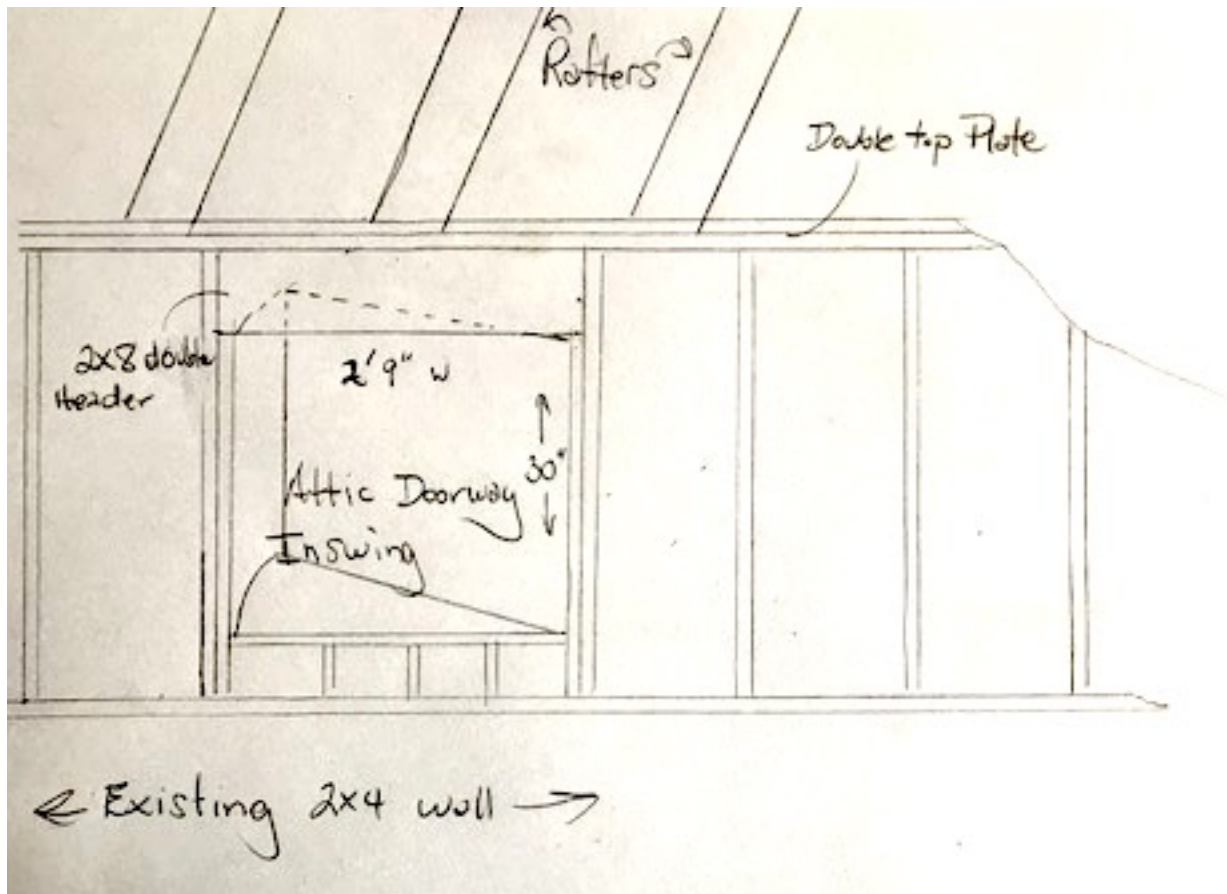

Drawing: Swift Addition Attic Access Detail

Date: July 10, 2017

Prepared by: W. Swift

Not to Scale