

**NEW INTERIOR PARTITION DETAILS:**

RE-USE EXISTING BEADED PANELLING AT "OUTSIDE"  
 2"x4" STUD WALL, 16" O.C., TYP. w/ R-11 BATT INSULATION  
 1/2" SHEETROCK AT "INSIDE"

4 1/2" NEW PARTITION WALLS: 2"x4" STUDS @ 16" O.C., TYPICAL, R-11 WITH FIBERGLASS BATT INSULATION FOR SOUND ATTENUATION

ALL EXISTING EXTERIOR WALLS BUILT WITH TRUE 2"x4" DIMENSIONAL LUMBER, TYP.

DOUBLE 2"x8" HEADERS, TYP. WITH RIGID INSULATION BETWEEN 2"x4" STUD/CRIPPLE FRAMING 16" O.C. w/ R-11 BATT INSULAT.

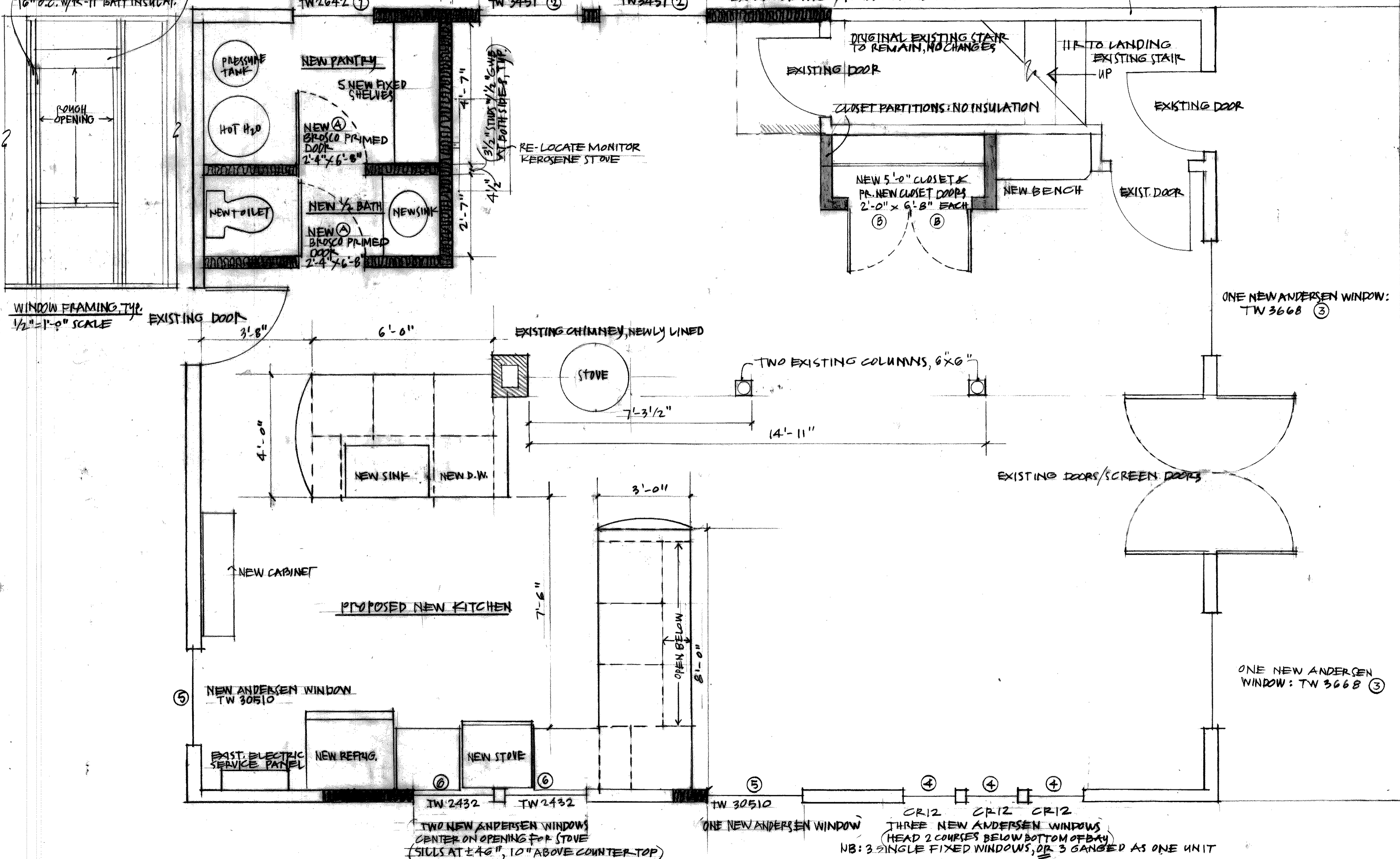

# MacVane Renovation

CASEY & HEATH MAC VANE HOUSE, 30 WHARF ROAD, CLIFF ISLAND ME 04019 (PORTLAND ASSESSOR'S MAP 109B, LOT D41)

MACVANE HOUSE RENOVATION PLAN  
 1/2" = 1'-0" SCALE  
 NOVEMBER 2015  
 CLIFF ISLAND, MAINE  
 REDHOUSE ARCHITECTS