

Scanned

109B B030

SUBSURFACE WASTEWATER DISPOSAL SYSTEM APPLICATION

Maine Department of Human Services
Division of Health Engineering, 10 SHS
(207) 287-5672 Fax: (207) 287-3165

PROPERTY LOCATION

City, Town, or Plantation: Cliff Island
Street or Road: Island Avenue
Subdivision, Lot #: Estate of David Th

>> CAUTION: PERMIT REQUIRED - ATTACH IN SPACE BELOW <<

06-6023
PORTLAND PERMIT # 10094 TOWN COPY

OWNER/APPLICANT INFORMATION

Name (last, first, MI): Thompson Donald Owner Applicant

Date Permit Issued: 11/21/06 \$ 1110.00 If Double Fee Charged
Jeanie Bouke L.P.I. # 07312
Local Plumbing Inspector Signature

Mailing Address of Owner/Applicant: 23 George Street
Gorham, Maine 04038

Daytime Tel. #: 892-2665

11-17-08 Extension granted
Municipal Tax Map # _____ Lot # _____ **JMB**

OWNER OR APPLICANT STATEMENT

I state and acknowledge that the information submitted is correct to the best of my knowledge and understand that any falsification is reason for the Department and/or Local Plumbing Inspector to deny a Permit.
Donald Thompson 11/3/06
Signature of Owner or Applicant Date

CAUTION: INSPECTION REQUIRED
I have inspected the installation authorized above and found it to be in compliance with the Subsurface Wastewater Disposal Rules Application.
(1st) date approved _____
Local Plumbing Inspector Signature _____ (2nd) date approved _____

PERMIT INFORMATION

TYPE OF APPLICATION
 1. First Time System
 2. Replacement System
Type replaced: overboard discharge
Year installed: 1987
 3. Expanded System
 a. Minor Expansion
 b. Major Expansion
 4. Experimental System
 5. Seasonal Conversion

THIS APPLICATION REQUIRES
 1. No Rule Variance
 2. First Time System Variance
 a. Local Plumbing Inspector Approval
 b. State & Local Plumbing Inspector Approval
 3. Replacement System Variance
 a. Local Plumbing Inspector Approval
 b. State & Local Plumbing Inspector Approval
 4. Minimum Lot Size Variance
 5. Seasonal Conversion Permit

DISPOSAL SYSTEM COMPONENTS
 1. Complete Non-engineered System
 2. Primitive System (graywater & alt. toilet)
 3. Alternative Toilet, specify: _____
 4. Non-engineered Treatment Tank (only)
 5. Holding Tank, _____ gallons
 6. Non-engineered Disposal Field (only)
 7. Separated Laundry System
 8. Complete Engineered System (2000 gpd or more)
 9. Engineered Treatment Tank (only)
 10. Engineered Disposal Field (only)
 11. Pre-treatment, specify: oxy-pro-1000
 12. Miscellaneous Components

SIZE OF PROPERTY
.5 +/- SQ. FT. ACRES

DISPOSAL SYSTEM TO SERVE
 1. Single Family Dwelling Unit, No. of Bedrooms: 4
 2. Multiple Family Dwelling, No. of Units: _____
 3. Other: _____ (specify)

TYPE OF WATER SUPPLY
 1. Drilled Well 2. Dug Well 3. Private
 4. Public 5. Other

SHORELAND ZONING
 Yes No

Current Use Seasonal Year Round Undeveloped

DESIGN DETAILS (SYSTEM LAYOUT SHOWN ON PAGE 3)

TREATMENT TANK
 1. Concrete
 a. Regular
 b. Low Profile
 2. Plastic
 3. Other: _____
CAPACITY: 1000 GAL

DISPOSAL FIELD TYPE & SIZE
 1. Stone Bed 2. Stone Trench
 3. Proprietary Device
 a. cluster array c. Linear
 b. regular load d. H-20 load
 4. Other: 5070 Pre-treatment
SIZE: 1188 sq. ft. lin. ft.

GARBAGE DISPOSAL UNIT
 1. No 2. Yes 3. Maybe
If Yes or Maybe, specify one below:
 a. multi-compartment tank
 b. _____ tanks in series
 c. increase in tank capacity
 d. Filter on Tank Outlet

DESIGN FLOW
360 gallons per day
BASED ON:
 1. Table 501.1 (dwelling unit(s))
 2. Table 501.2 (other facilities)
SHOW CALCULATIONS
--- for other facilities ---
4 Bedrooms @ 91 gpd = 360

SOIL DATA & DESIGN CLASS
PROFILE CONDITION DESIGN
2, 1, A, B, C, 1
at Observation Hole # TPA1
Depth 15 "
of Most Limiting Soil Factor

DISPOSAL FIELD SIZING
 1. Small—2.0 sq. ft. / gpd
 2. Medium—2.6 sq. ft. / gpd
 3. Medium—Large 3.3 sq. ft. / gpd
 4. Large—4.1 sq. ft. / gpd
 5. Extra Large—5.0 sq. ft. / gpd

EFFLUENT/EJECTOR PUMP
 1. Not Required
 2. May Be Required
 3. Required
Specify only for engineered systems:
DOSE: _____ gallons

LATITUDE AND LONGITUDE
at center of disposal area
Lat. 40 d 10 m 00 s
Lon. 43 d 42 m 00 s
If g.p.s. state margin of error: _____

SITE EVALUATOR STATEMENT

I certify that on September 20, 2005 I completed a site evaluation on this property and state that the data reported are accurate and that the proposed system is in compliance with the State of Maine Subsurface Wastewater Disposal Rules (10-144A CMR 241).
John M. Toothaker # 1347 September 20 - 2005
Site Evaluator Signature SE # Date

NAME John M. Toothaker (207) 839-5746 looth@maine.rr.com
Site Evaluator Name Printed Telephone Number E-mail Address

Note: Changes to or deviations from the design should be confirmed with the Site Evaluator. HHE-200 Rev. 10/02

SUBSURFACE WASTEWATER DISPOSAL SYSTEM APPLICATION

Maine Department of Human Services
 Division of Health Engineering, 10 SHS
 (207) 287-5672 FAX (207) 287-3165

Town, City, Plantation
Cliff Island

Street, Road, Subdivision
Island Avenue

Owner or Applicant Name
Don Thompson

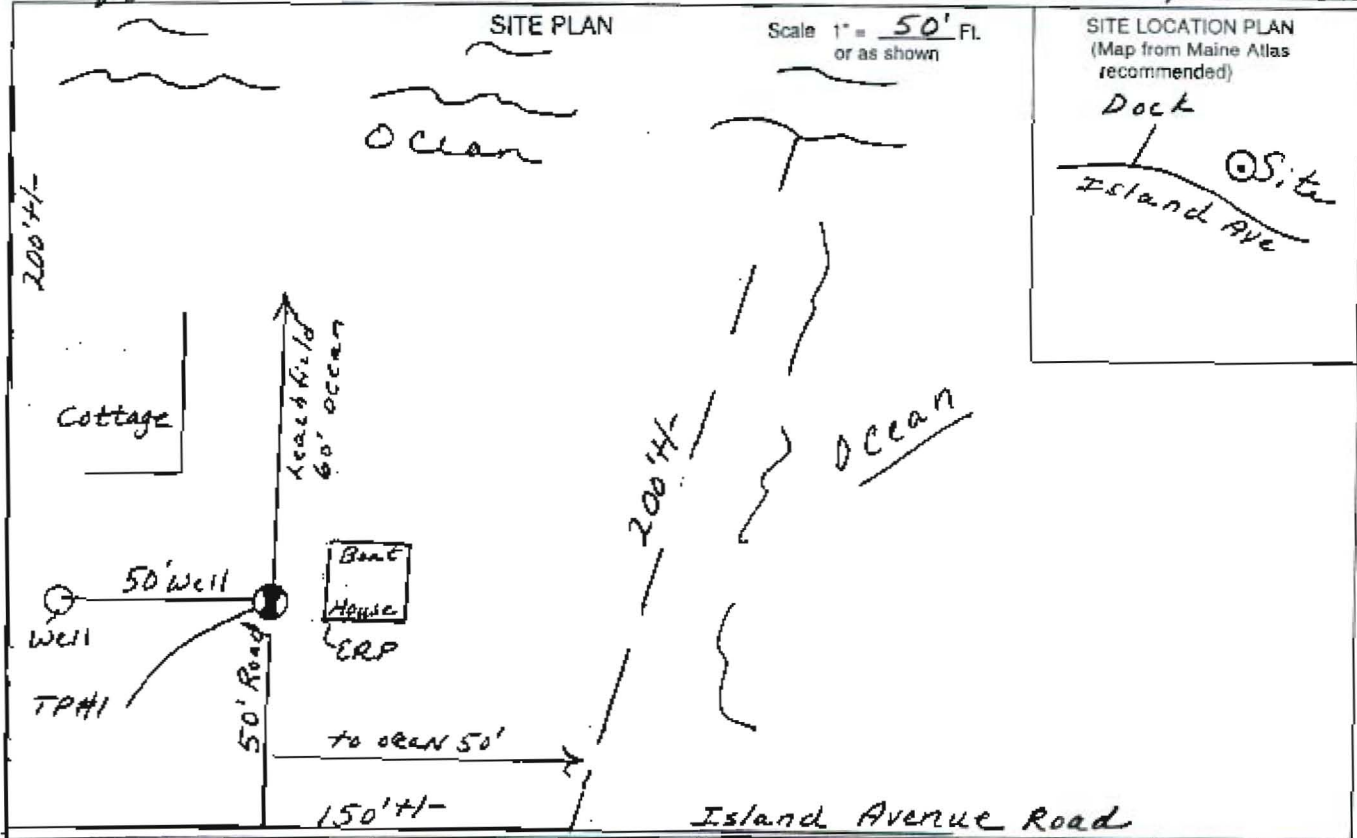

SOIL DESCRIPTION AND CLASSIFICATION (Location of Observation Holes Shown Above)

Observation Hole TP#1 Test pit Boring
0' L / 11" * Depth of Organic Horizon Above Mineral Soil

DEPTH BELOW MINERAL SOIL SURFACE (inches)	Texture	Consistency	Color	Mottling
0	Fine Sandy Loam	Friable	Brownish yellow	
10				
20				Few faint to C.D.
30	ledge			
40				
50				

Soil Classification 2 AUC Slope _____ %
 Profile Condition Limiting Factor LS
 Ground Water Restrictive Layer
 Bedrock
 Pit Depth

Observation Hole _____ Test pit Boring
 _____ * Depth of Organic Horizon Above Mineral Soil

DEPTH BELOW MINERAL SOIL SURFACE (inches)	Texture	Consistency	Color	Mottling
0				
10				
20				
30				
40				
50				

Soil Classification _____ Slope _____ %
 Profile Condition Limiting Factor _____
 Ground Water Restrictive Layer
 Bedrock
 Pit Depth

John M. Louthaker
 Site Evaluator Signature

347
 SE #

DATE Sept. 30, 2006
 Date

Estate of Donald Thompson

Scale 1" = 50'

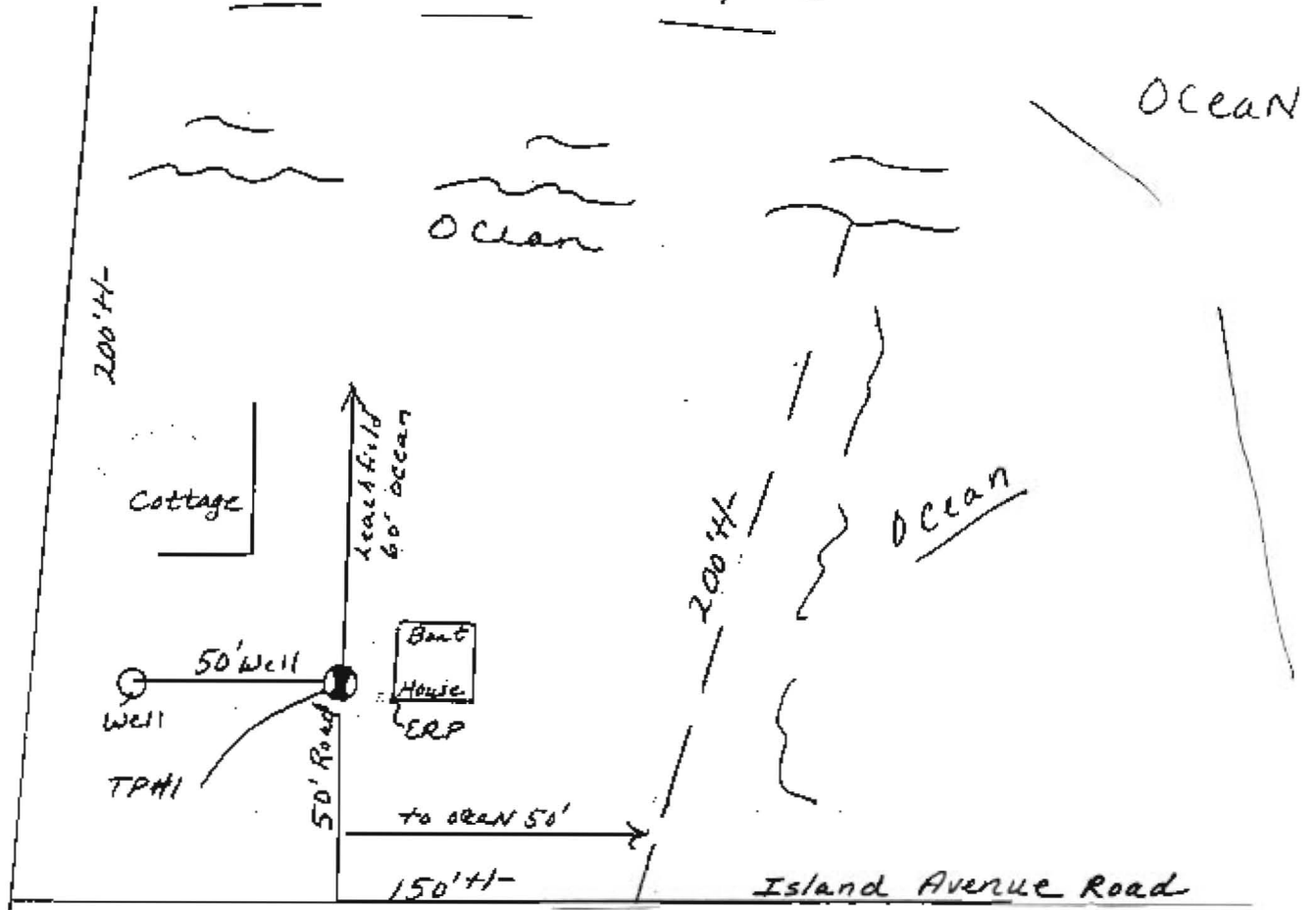

Island Ave ROAD

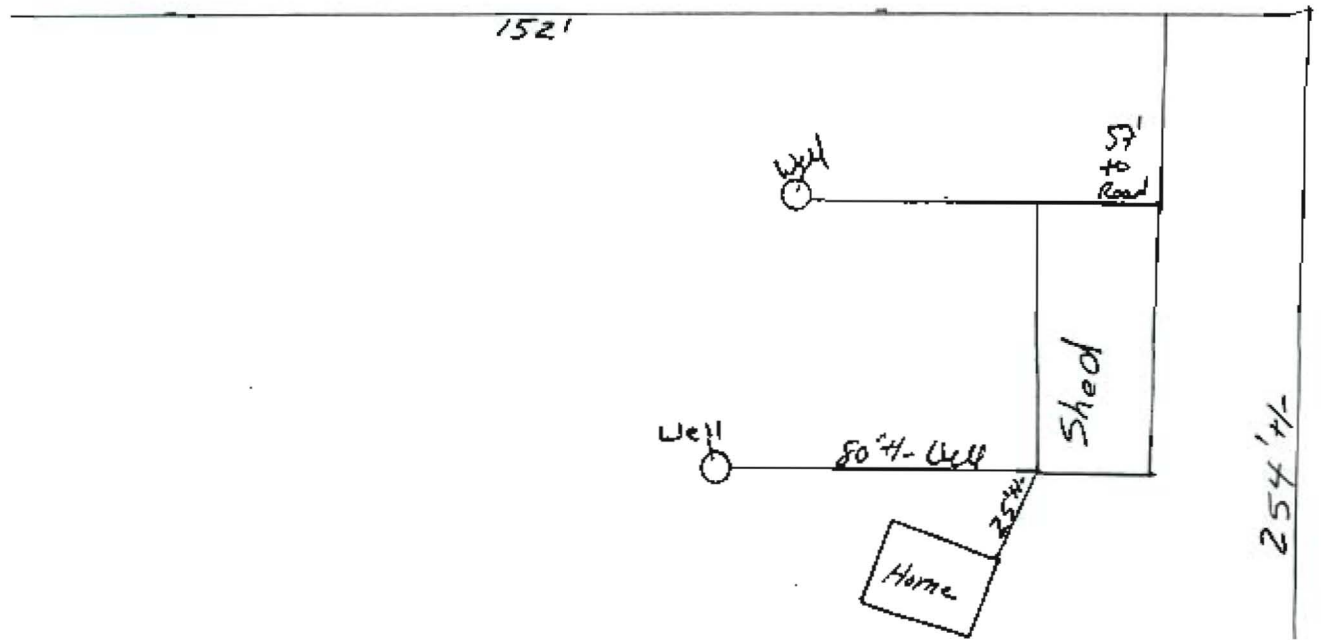

SUBSURFACE WASTEWATER DISPOSAL SYSTEM APPLICATION

Maine Department of Human Services
Division of Health Engineering, 10 SHS
(207) 287-5672 FAX (207) 287-3165

Town, City, Plantation
CLIFF ISLAND

Street, Road, Subdivision
ISLAND AVENUE

Owner or Applicant Name
DON THOMPSON

SUBSURFACE WASTEWATER DISPOSAL PLAN

Scale 1" = 10 FT.

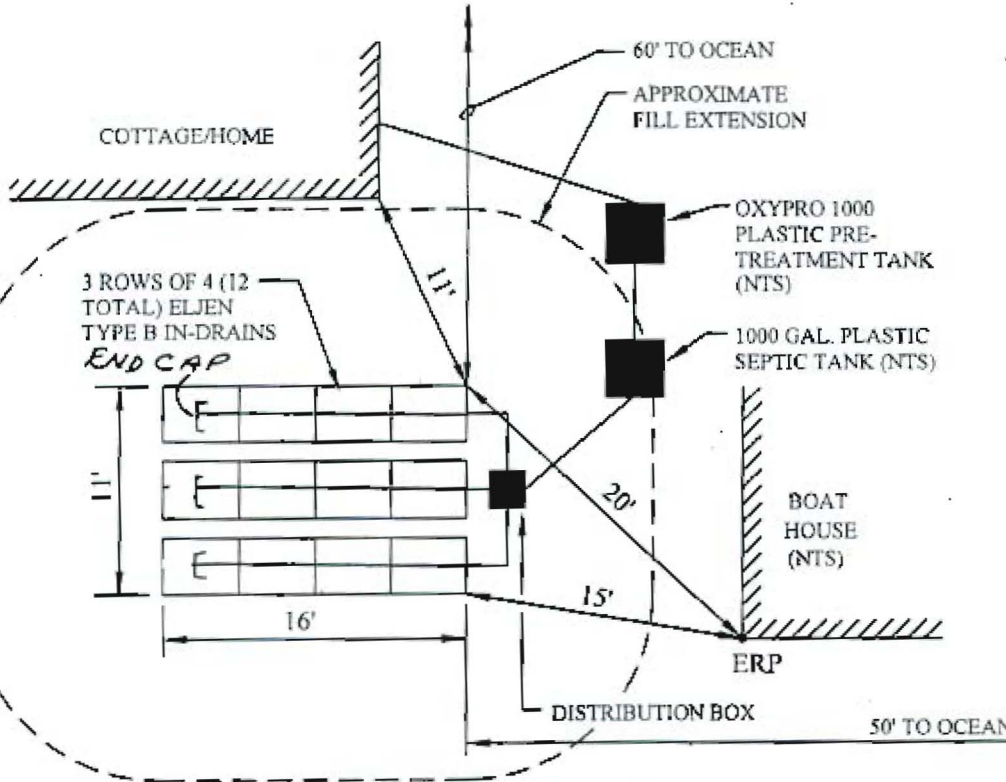

NOTES:

1. NTS= NOT TO SCALE
2. FOLLOW ALL REQUIREMENTS IN NOTES FOR TYPE-B ELJEN IN-DRAINS.

BACKFILL REQUIREMENTS

Depth of Fill (Upslope)

Depth of Fill (Downslope)

CONSTRUCTION ELEVATIONS

Finished Grade Elevation

Top of Distribution Pipe or Proprietary Device

Bottom of Disposal Area (Bottom of Stone)

ELEVATION REFERENCE POINT

Location & Description

Reference Elevation

DISPOSAL FIELD CROSS SECTION

SEE SHEET 4

John M. Lothake
Site Evaluator Signature

#347
SE #

September 30, 2004
Date

Town, City, Plantation
CLIFF ISLAND

Street, Road, Subdivision
ISLAND AVENUE

Owner or Applicant Name
DON THOMPSON

SCALE: 1"=5' HORIZ.
1"=5' VERT.

NOTES:

1. FILL REQUIREMENTS VARY GREATLY BECAUSE OF BED LOCATION. CONTRACTOR SHALL FIELD CHECK ALL SLOPES BEFORE DETERMINING ACTUAL FILL REQUIREMENTS.
2. NOTES ON PAGE OF ARE HEREBY MADE PART OF THIS HHE-200 FORM.
3. THE FIRST 12" DIRECTLY BENEATH THE IN-DRAINS SHALL BE MEDIUM TO COARSE TEXTURED SAND WITH AN EFFECTIVE SIZE OF 0.25 TO 2.0 mm. NO GREATER THAN 5% PASSING A #200 SIEVE AND NO PARTICLES LARGER THAN 3/4 INCH OR MATERIALS MEETING THE ASTM C-33 SPECIFICATION. CONCRETE OR WASHED SAND IS A RELIABLE CHOICE. SUITABILITY OF BANK RUN SAND OR SITE DISPOSAL AREA SOIL MUST BE VERIFIED.
4. ROTO-TILL ORIGINAL SURFACE THOROUGHLY IN ALL AREAS OF THE SYSTEM INCLUDING FILL EXTENSIONS BEFORE PLACING FILL. REMOVE ALL ORGANIC LAYER IN AREA OF SYSTEM.
5. ROWS SHOULD BE LEVEL WITH A TOLERANCE OF 1"/100 FT.
6. SECTION SHOWN IS BASED ON AN AVERAGE EXISTING GROUND SLOPE OF %.

FILL REQUIREMENTS AT SECTION:

DEPTH OF FILL (UPSLOPE) 27"-38"
DEPTH OF FILL (DOWNSLOPE) 27"-38"

CONSTRUCTION ELEVATIONS: ERP TOP OF STONE FOUNDATION 26" ABOVE GRADE
E.R.P. REFERENCE ELEVATION IS 0"

	ROW 1	ROW 2	ROW 3
FINISH GRADE	+2"	N/A	N/A
TOP OF DISTRIBUTION	-10"	N/A	N/A
BOTTOM OF IN-DRAINS	-21"	N/A	N/A

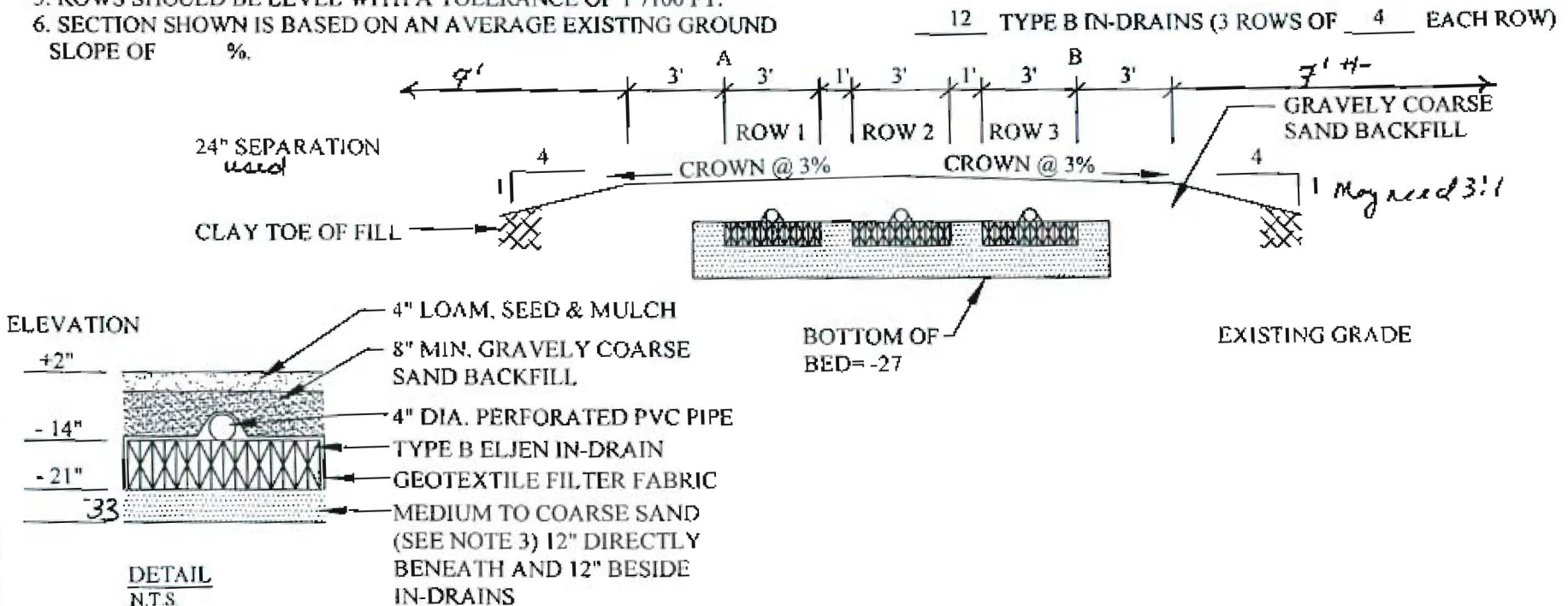

DETAIL
N.T.S.

John M. Tothala
Site Evaluator Signature

#347
SE #

Sept 30 - 2006
Date

General Notes

(attachment to form HHE-200)
< 1,000 gpd Septic System

4A
per John Toothaker

1. It is your right to get a second opinion if you don't agree with the professional opinion of Tooth & Associates.
2. Property information is from the owner or applicant and shall be correct and verified prior to signing this HHE-200 application.
3. All work shall be done per the Maine Subsurface Wastewater Disposal Rules dated 6/02 as amended.
4. All work shall be done only in dry conditions for disposal area.
5. No vehicular or equipment traffic to be allowed on disposal area. Construct disposal area outside the corner flags located in the field. Protect down slope area as well.
6. Backfill, if required, is to be gravelly coarse sand to coarse sand texture and to be free of foreign debris. If backfill is coarser than original soil, then mix top 4" of backfill and original soil with rototiller.
7. No neighboring wells are apparent (unless so indicated) within 100' of disposal area. Owner or applicant shall verify this prior to signing the HHE-200 application.
8. The disposal field stone shall be clean, uniform in size and free of fines, dusts, ashes, or clay. It shall be no smaller than ¼ inch and no larger than 2½ inches in size (per Section 805.2.3 of the Maine Subsurface Wastewater Rules).
9. Use minimum separation distances required (unless reduced by variance or special circumstance).
 - a. Wells with water usage of 2,000 or more gpd or public water supply wells:

Disposal fields:	300'
Septic Tanks and Holding Tanks:	100'
 - b. any well to disposal area: 100'
 - c. any well to septic tank 100'
 - d. septic tank or disposal area to lake, river, stream or brook: 100' for major watercourse
50' for minor watercourse
 - e. house to treatment tank: 8'
 - f. house to disposal area: 20'
 - g. all other separation distances, for less than 1,000 gpd per Maine Subsurface Wastewater Disposal Rules use Table 700.2.
10. Location of septic near a wetland may require a separate permit. As such, the owner or applicant prior to construction of the septic system shall hire a professional wetland scientist to evaluate adjacent wetlands and prepare needed permits.
11. Garbage disposals are not recommended and, if installed, are done so at the owner's risk. Follow Maine State Plumbing Code if installed.
12. Pump Stations shall be water tight to prevent infiltration of ground and surface water.
13. Pressure lines and force mains shall be flushed of any foreign material and pumps shall be checked for proper on/off cycle before being put into service.
14. Force mains, pump stations, and /or gravity piping subject to freezing shall be adequately insulated or installed below the frost line.



Maine Department of Health and Human Services

Maine Center for Disease Control and Prevention
286 Water Street, 3rd Floor
11 State House Station
Augusta, ME 04333-0011

Brenda M. Harvey,
Commissioner

John Elias Baldacci
Governor

Dora Anne Mills, MD, MPH
Public Health Director
Maine CDC Director

November 21, 2006

Estate of David Thompson
c/o Donald Thompson
22 George Street
Gorham, ME 04038

Subject: Approval, Replacement System Variance Request, Thompson Estate Property, Island Avenue, Cliff Island, Portland

Dear Mr. Thompson:

We have completed our review of an HHE-200 Form dated 09/30/06 by John M. Toothaker, S.E. for your property at Cliff Island. You are proposing to replace an overboard discharge, with a 1,000 gallon septic tank, one OxyPro 1000 treatment unit, and three rows of four Eljen In-Drains. The disposal area has been reduced in size by 50 percent pursuant to Table 603.1 of the Subsurface Wastewater Disposal Rules, relating to treated wastewater. The test pit log on page 2 has no slope information in it. Notes #2 and #6 were not completed, on page 4 of the application. The following variances to the Rules, CMR 241 are requested:

Variances within the authority of the Local Plumbing Inspector:

- 1. To install a treatment tank set back five feet from a full basement.
2. To install a disposal area set back ten feet from a full foundation.

Variances beyond the authority of the Local Plumbing Inspector:

- 1. To install a disposal area set back 50 feet from the owner's well and 50 feet from the normal high water mark of a major water body.

By copy of this letter we hereby authorize the Local Plumbing Inspector to issue a permit for the replacement system installation as proposed on the above referenced HHE-200 Form, with the following conditions:

- 1. Prior to issuance of a permit to install the system, the Site Evaluator shall provide the owner and the Local Plumbing Inspector with a revised page 2 and page 4 of the HHE-200 Form, containing the data noted above.

Please note, it is the Division's understanding that reducing the size of an Eljen In-Drain disposal area through use of an advanced treatment unit will violate Eljen's warranty conditions.

Work must be completed within two years of permit issue and you or your installer are responsible to notify the local plumbing inspector when you are ready for the necessary construction inspections. In all aspects beyond those noted in this letter the installation shall conform to the requirements of the Rules.

Because installation and owner maintenance has a significant effect on the working order of onsite sewage disposal systems, including their components, the Division makes no representation or guarantee as to the efficiency and/or operation of the system.

Should you or others have any questions, please feel free to contact me at 287-5695.

Sincerely,

Handwritten signature of James A. Jacobsen
James A. Jacobsen, Environmental Specialist IV
Subsurface Wastewater Program
Division of Environmental Health
e-mail: james.jacobsen@maine.gov

/jaj
xc: File
Jeanie Bourke, LPI
John Toothaker, SE via e-mail

RECEIVED

REPLACEMENT SYSTEM VARIANCE REQUEST

THE LIMITATIONS OF THE REPLACEMENT SYSTEM VARIANCE REQUEST

This form shall be attached to an application (HME-200) for the proposed replacement system which requires a variance to the Rules. The LPI shall review the Replacement System Variance Request on HME-200 and may approve the Request if all of the following requirements are met, and the variance(s) requested fall within the limits of LPI's authority.

NOV 03 2006

WASTEWATER & PLUMBING PROGRAM

1. The proposed design meets the definition of a Replacement System as defined in the Rules (Sec. 2005)
2. There will be no change in use of the structure except as authorized for minor expansions outside the shoreland zone of major waterbodies/courses.
3. The replacement system is determined by the Site Evaluator and LPI to be the most practical method to treat and dispose of the wastewater.
4. The BOD5 plus S.S. content of the wastewater is no greater than that of normal domestic effluent.

GENERAL INFORMATION Town of Cliff Island

Permit No. _____ Date Permit Issued _____

Property Owner's Name: Estate of David E. Thompson Tel. No.: 892-3665

System's Location: Island Avenue, Cliff Island

Property Owner's Address: 22 George Street, Gorham, Maine 04038

(if different from above)

SPECIFIC INSTRUCTIONS TO THE LOCAL PLUMBING INSPECTOR (LPI):

If any of the variances exceed your approval authority and/or do not meet all of the requirements listed under the Limitations Section above, then you are to send this Replacement System Variance Request, along with the Application, to the Department for review and approval consideration before issuing a Permit. (See reverse side for Comments Section and your signature.)

SITE EVALUATOR:

If after completing the Application, you find that a variance for the proposed replacement system is needed, complete the Replacement Variance Request with your signature on reverse side of form.

PROPERTY OWNER:

If it has been determined by the Site Evaluator that a variance to the Rules is required for the proposed replacement system. This variance request is due to physical limitations of the site and/or soil conditions. Both the Site Evaluator and the LPI have considered the site/soil restrictions and have concluded that a replacement system in total compliance with the Rules is not possible.

PROPERTY OWNER

I understand that the proposed system requires a variance to the Rules. Should the proposed system malfunction, I release all concerned provided they have performed their duties in a reasonable and proper manner, and I will promptly notify the Local Plumbing Inspector and make any corrections required by the Rules. By signing the variance request form, I acknowledge permission for representatives of the Department to enter onto the property to perform such duties as may be necessary to evaluate the variance request.

Donald H. Thompson Per Prop 10/19/05

SIGNATURE OF OWNER DATE

LOCAL PLUMBING INSPECTOR

I, Jeanie Bouke, the undersigned, have visited the above property and have determined to the best of my knowledge that it cannot be installed in compliance with the Rules. As a result of my review of the Replacement Variance Request, the Application, and my on-site investigation, I (check and complete either a or b):

a. approve, or (disapprove) the variance request based on my authority, to grant this variance. Note: If the LPI does not give his approval, he shall list his reasons for denial in Comments Section below and return to the applicant.

b. find that one or more of the requested Variances exceeds my approval authority as LPI. I do not recommend, or (do not recommend) the Department's approval of the variances. Note: If the LPI does not recommend the Department's approval, he shall state his reasons in Comments Section below as to why the proposed replacement system is not being recommended.

Comments:

Jeanie Bouke

LPI SIGNATURE

DEPT. OF BUILDING INSPECTION
CITY OF PORTLAND
OCT 17 2005
RECEIVED
DATE 11/3/06

Replacement System Variance Request

VARIANCE CATEGORY	LIMIT OF LPI'S APPROVAL AUTHORITY						VARIANCE REQUESTED TO:	
	Disposal Fields (total design flow)			Septic Tanks (total design flow)			Disposal Fields	Septic Tanks
From	Less than 1000 gpd	1000 to 2000 gpd	Over 2000 gpd	Less than 1000 gpd	1000 to 2000 gpd	Over 2000 gpd	To	To
SOILS								
Soil Profile	Ground Water Table			to 7"			inches	
Soil Condition	Restrictive Layer			to 7"			inches	
from HHE-200	Bedrock			to 12"			inches	
Owner's wells	100 down to 60 ft [a]	200 down to 100 ft	300 down to 150 ft	100 down to 50 ft [b]	100 down to 50 ft	100 down to 50 ft	50'	
Neighbor's wells	100 down to 60 ft [f]	200 down to 120 ft [f]	300 down to 180 ft [f]	100 down to 50 ft [f]	100 down to 75 ft [f]	100 down to 75 ft [f]		
Water supply line	10 ft	20 ft	25 ft [h]	10 ft	10 ft	10 ft [h]		
Water course, major - for replacements only, see Table 400.4 for major expansions	100 down to 60 ft [d]	200 down to 120 ft [d]	300 down to 180 ft [d]	100 down to 50 ft [b]	100 down to 50 ft	100 down to 50 ft	60' - ocean	50' - ocean
Water course, minor	50 down to 25 ft [e]	100 down to 50 ft [e]	150 down to 75 ft [e]	50 down to 25 ft [e]	50 down to 25 ft [e]	50 down to 25 ft [e]		
Drainage ditches	25 down to 12 ft	50 down to 25 ft	75 down to 35 ft	25 down to 12 ft	25 down to 12 ft	25 down to 12 ft		
Edge of fill extension -- Coastal wetlands, special freshwater wetlands, great ponds, rivers, streams	25 ft [e]	25 ft [e]	25 ft [e]	25 ft [e]	25 ft [e]	25 ft [e]		
Slopes greater than 3:1	10 ft [g]	18 ft [g]	25 ft [g]	N/A	N/A	N/A		
No full basement [e.g. slab, frost wall, columns]	15 down to 7 ft	30 down to 15 ft	40 down to 20 ft	8 down to 5 ft	14 down to 7 ft	20 down to 10 ft		
Full basement [below grade foundation]	20 down to 10 ft	30 down to 15 ft	40 down to 20 ft	8 down to 5 ft	14 down to 7 ft	20 down to 10 ft	10'	5'
Property lines	10 down to 5 ft [c]	18 down to 9 ft [c]	20 down to 10 ft [c]	10 down to 4 ft [c]	15 down to 7 ft [c]	20 down to 10 ft [c]		
Burial sites or graveyards, measured from the down toe of the fill extension	25 ft	25 ft	25 ft	25 ft	25 ft	25 ft		
OTHER								
1. Fill extension Grade - to 3:1 ✓								
2. 50% Reduction w/ pretreatment okay by Sweet Associates								
3.								

- Footnotes: [a.] Single-family well setbacks may be reduced as prescribed in Section 701.2.
 [b.] This distance may be reduced to 25 feet, if the septic or holding tank is tested in the plumbing inspector's presence and shown to be watertight or of monolithic construction.
 [c.] Additional setbacks may be needed to prevent fill material extensions from encroaching onto abutting property.
 [d.] Additional setbacks may be required by local Shoreland zoning.
 [e.] Natural Resource Protection Act requires a 25 feet setback, on slopes of less than 20%, from the edge of soil disturbance and 100 feet on slopes greater than 20%. See Chapter 15.
 [f.] May not be any closer to neighbors well than the existing disposal field or septic tank unless written permission is granted by the neighbor. This setback may be reduced for single family houses with Department approval. See Section 702.3.
 [g.] The fill extension shall reach the existing ground before the 3:1 slope or within 100 feet of the disposal field.
 [h.] See Section 1402.10 for special procedures when these minimum setbacks cannot be achieved.

John M. Touchette

SITE EVALUATOR'S SIGNATURE

Sept 30, 2005
DATE

FOR USE BY THE DEPARTMENT ONLY

The Department has reviewed the variance(s) and does does not give its approval. Any additional requirements, recommendations, or reasons for the Variance denial, are given in the attached letter.

James A. Jacobson ES IV
SIGNATURE OF THE DEPARTMENT

11/21/06
DATE

874-8716

SUBSURFACE WASTEWATER DISPOSAL SYSTEM APPLICATION

Maine Department of Human Services
Division of Health Engineering, 10 SHS
(207) 267-5672 FAX (207) 267-3165

Town, City, Plantation: Cliff Island Street, Road, Subdivision: Island Avenue Owner or Applicant Name: Don Thompson

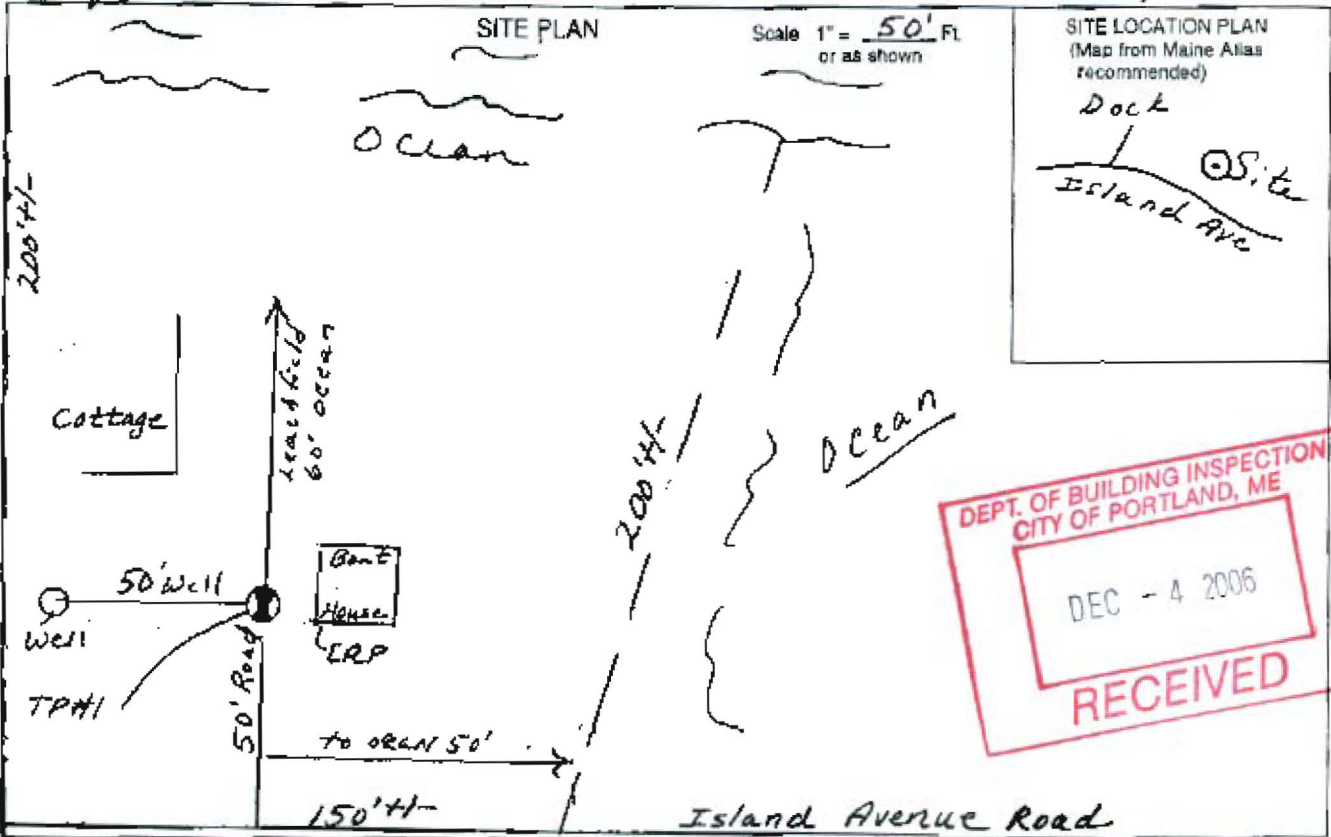

SOIL DESCRIPTION AND CLASSIFICATION (Location of Observation Holes Shown Above)

Observation Hole TP#1 Test pit Boring
0' L" * Depth of Organic Horizon Above Mineral Soil

Texture	Consistency	Color	Mottling
0-10 Fine Sandy Loam	Friable	Brownish yellow	
10-20			Few & fragments to C.D.
20-30			Ledge
30-40			
40-50			

Soil Classification: 2 AUC Profile: AUC Condition: 0-1 % Slope: 15 % Limiting Factor: 15 %

Ground Water
 Restrictive Layer
 Bedrock
 Pit Depth

Observation Hole _____ Test pit Boring
_____ * Depth of Organic Horizon Above Mineral Soil

Texture	Consistency	Color	Mottling
0-10			
10-20			
20-30			
30-40			
40-50			

Soil Classification: _____ Profile: _____ Condition: _____ % Slope: _____ % Limiting Factor: _____ %

Ground Water
 Restrictive Layer
 Bedrock
 Pit Depth

revised Nov 30 2006 jmd

John M. Loochaker
Site Evaluator Signature

347
SE #

DATE Sept. 30, 2006
Date

Town, City, Plantation
CLIFF ISLAND

Street, Road, Subdivision
ISLAND AVENUE

Owner or Applicant Name
DON THOMPSON

SCALE: 1"=5' HORIZ.
1"=5' VERT.

NOTES:

1. FILL REQUIREMENTS VARY GREATLY BECAUSE OF BED LOCATION. CONTRACTOR SHALL FIELD CHECK ALL SLOPES BEFORE DETERMINING ACTUAL FILL REQUIREMENTS.
2. NOTES ON PAGE 4A OF 4 ARE HEREBY MADE PART OF THIS HHE-200 FORM. *Revised No 30-2006*
3. THE FIRST 12" DIRECTLY BENEATH THE IN-DRAINS SHALL BE MEDIUM TO COARSE TEXTURED SAND WITH AN EFFECTIVE SIZE OF 0.25 TO 2.0 mm. NO GREATER THAN 5% PASSING A #200 SIEVE AND NO PARTICLES LARGER THAN 3/4 INCH OR MATERIALS MEETING THE ASTM C-33 SPECIFICATION. CONCRETE OR WASHED SAND IS A RELIABLE CHOICE. SUITABILITY OF BANK RUN SAND OR SITE DISPOSAL AREA SOIL MUST BE VERIFIED.
4. ROTO-TILL ORIGINAL SURFACE THOROUGHLY IN ALL AREAS OF THE SYSTEM INCLUDING FILL EXTENSIONS BEFORE PLACING FILL. REMOVE ALL ORGANIC LAYER IN AREA OF SYSTEM.
5. ROWS SHOULD BE LEVEL WITH A TOLERANCE OF 1"/100 FT.
6. SECTION SHOWN IS BASED ON AN AVERAGE EXISTING GROUND SLOPE OF 0%.

FILL REQUIREMENTS AT SECTION:

DEPTH OF FILL (UPSLOPE) 27"-38"
 DEPTH OF FILL (DOWNSLOPE) 27"-38"

CONSTRUCTION ELEVATIONS: ERP TOP OF STONE FOUNDATION 26" ABOVE GRADE
 E.R.P. REFERENCE ELEVATION IS 0"

	ROW 1	ROW 2	ROW 3
FINISH GRADE	+2"	N/A	N/A
TOP OF DISTRIBUTION	-10"	N/A	N/A
BOTTOM OF IN-DRAINS	-21"	N/A	N/A

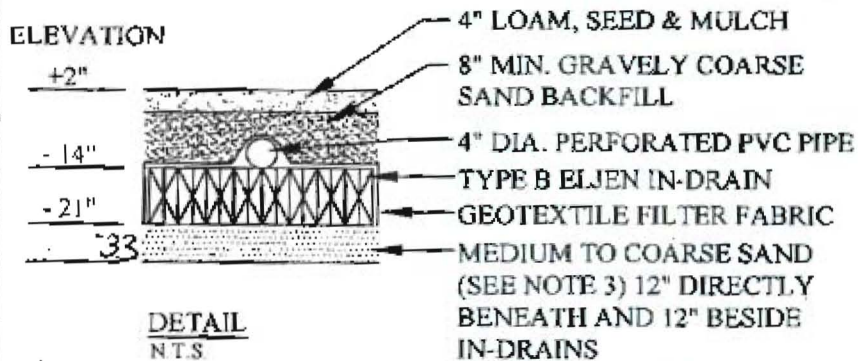
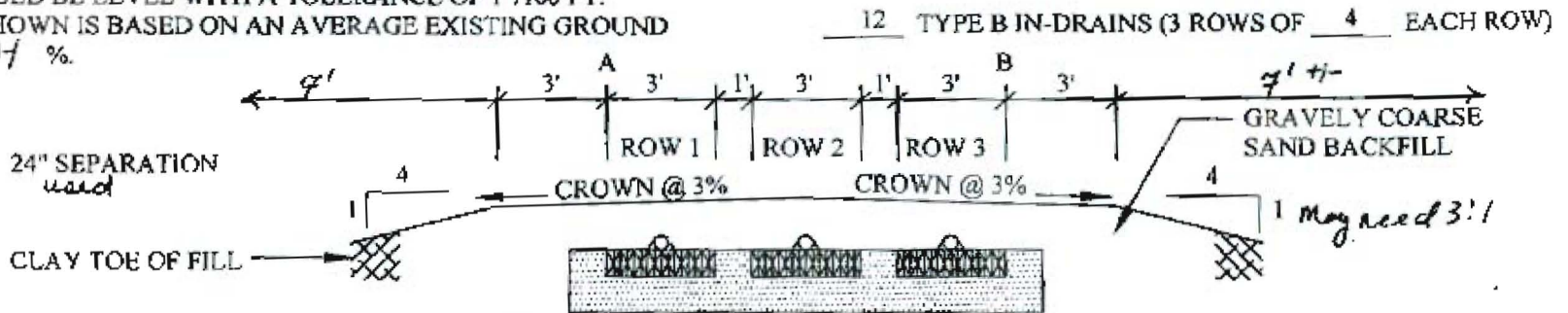

BOTTOM OF BED = -27



John M. Toostala
 Site Evaluator Signature

#347
 SE #

Sept 30 - 2006
 Date

DEC 04 '06 (TUE) 12:15 COMMUNICATION No. 16 PAGE 2

WAY77111 0007 46 0000 1001 1. 7



CITY OF PORTLAND, MAINE
Department of Building Inspections

10-17 2008

Received from Estate of David J. Thompson

Location of Work T-land Ave

Cost of Construction \$ _____

Permit Fee \$ 110

Building (I1) _____ Plumbing (I5) _____ Electrical (I2) _____ Site Plan (U2) _____

Other Sub Surface

CBL: 1072230

Check #: 108

Total Collected \$ 110

THIS IS NOT A PERMIT

No work is to be started until PERMIT CARD is actually posted upon the premises. Acceptance of fee is no guarantee that permit will be granted. PRESERVE THIS RECEIPT. In case permit cannot be granted the amount of the fee will be refunded upon return of the receipt less \$10.00 or 10% whichever is greater.

WHITE - Applicant's Copy
YELLOW - Office Copy
PINK - Permit Copy

MINOR REVISION (order of tank & treatment switched)

SUBSURFACE WASTEWATER DISPOSAL SYSTEM APPLICATION		Maine Department of Human Services Division of Health Engineering, 10 SHS (207) 287-5672 FAX (207) 287-3165
Town, City, Plantation CLIFF ISLAND	Street, Road, Subdivision ISLAND AVENUE	Owner or Applicant Name DONALD THOMPSON

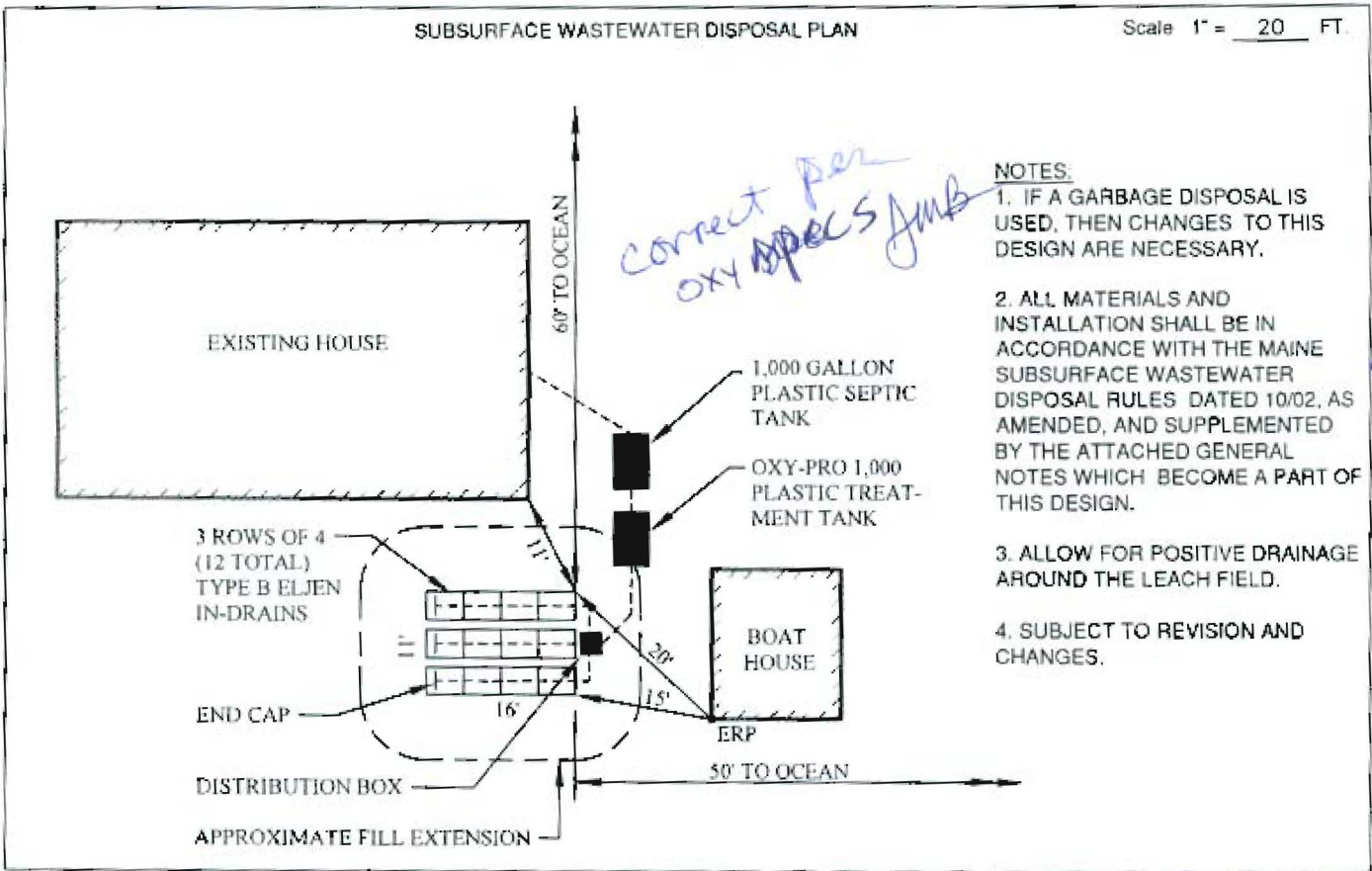

Permit # 2005-6021
109BB30

BACKFILL REQUIREMENTS	CONSTRUCTION ELEVATIONS	ELEVATION REFERENCE POINT
Depth of Fill (Upslope)	Finished Grade Elevation	Location & Description
Depth of Fill (Downslope)	Top of Distribution Pipe or Proprietary Device	Reference Elevation
	Bottom of Disposal Area (Bottom of Stone)	

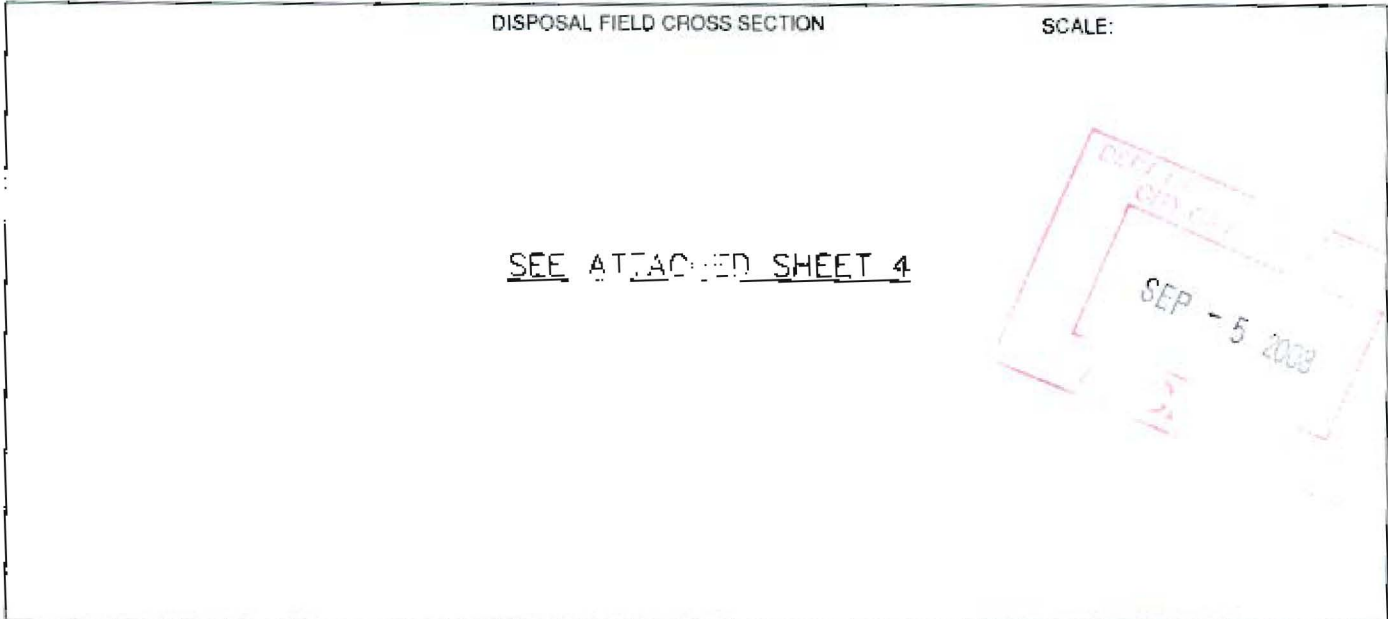

John M. Toothaker
Site Evaluator Signature

#347
SE #

Sept 4-08
Date
Revised

TOOTH & ASSOCIATES, L.L.C.

Soil Surveys, Septic Designs, Planning

347 Main Street Unit 1 B

Gorham, Maine 04038

Phone 207-839-5746 fax 207-839-5746

To: City of Portland Code office

From: Tooth & Assoc (John)

Date: 10-28-08

Fax #: 874-8716

Page 1 of: 2

Notes: Don Thompson

other piece of property

(Estate of Don Thompson)



Revision

SUBSURFACE WASTEWATER DISPOSAL SYSTEM APPLICATION

Maine Department of Human Services
Division of Health Engineering, 10 SHS
(207) 287-5672 FAX (207) 287-3165

Town, City, Plantation
CLIFF ISLAND

Street, Road, Subdivision
ISLAND AVENUE

Owner or Applicant Name
DONALD THOMPSON

SUBSURFACE WASTEWATER DISPOSAL PLAN

Scale 1" = 20 FT.

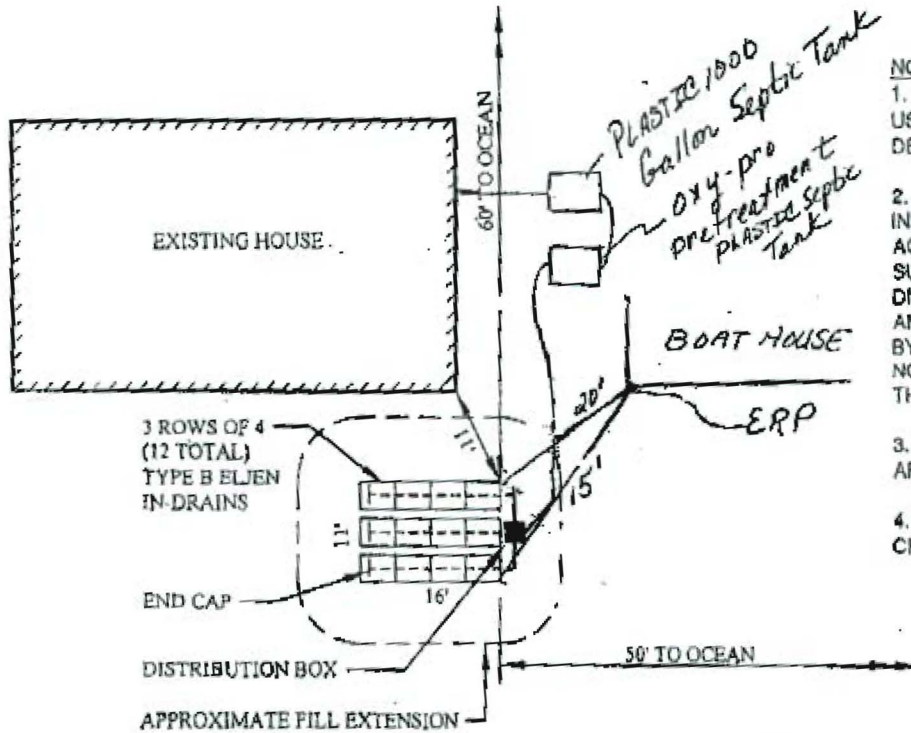

NOTES:

1. IF A GARBAGE DISPOSAL IS USED, THEN CHANGES TO THIS DESIGN ARE NECESSARY.
2. ALL MATERIALS AND INSTALLATION SHALL BE IN ACCORDANCE WITH THE MAINE SUBSURFACE WASTEWATER DISPOSAL RULES DATED 10/02, AS AMENDED, AND SUPPLEMENTED BY THE ATTACHED GENERAL NOTES WHICH BECOME A PART OF THIS DESIGN.
3. ALLOW FOR POSITIVE DRAINAGE AROUND THE LEACH FIELD.
4. SUBJECT TO REVISION AND CHANGES.

BACKFILL REQUIREMENTS

Depth of Fill (Upstope)

Depth of Fill (Downslope)

CONSTRUCTION ELEVATIONS

Finished Grade Elevation

Top of Distribution Pipe or Proprietary Device

Bottom of Disposal Area (Bottom of Stone)

ELEVATION REFERENCE POINT

Location & Description

Reference Elevation

DISPOSAL FIELD CROSS SECTION

SCALE:

SEE ATTACHED SHEET 4



Julia M. Toothaker
Site Evaluator Signature

#347
SE #

Aug 15 2008
Date
Revised Oct 22 2008
Boat House location