

DISPLAY THIS CARD ON PRINCIPAL FRONTAGE OF WORK



CITY OF PORTLAND

BUILDING PERMIT

This is to certify that JONATHAN W NOLAN

Located At 31 SHORE RD (CUSHINGS ISLAND)

Job ID: 2012-04-3713-SOB

CBL: 106A- B-002-001

has permission to build a Shed- Detached Accessory Structure (Single Family Residence).

provided that the person or persons, firm or corporation accepting this permit shall comply with all of the provisions of the Statues of Maine and of the Ordinances of the City of Portland regulating the construction, maintenance and use of the buildings and structures, and of the application on file in the department.

Notification of inspection and written permission procured before this building or part thereof is lathed or otherwise closed-in. 48 HOUR NOTICE IS REQUIRED.

A final inspection must be completed by owner before this building or part thereof is occupied. If a certificate of occupancy is required, it must be

Fire Prevention Officer

05/09/2012
Code Enforcement Officer / Plan Reviewer

THIS CARD MUST BE POSTED ON THE STREET SIDE OF THE PROPERTY
PENALTY FOR REMOVING THIS CARD

BUILDING PERMIT INSPECTION PROCEDURES

Please call 874-8703 or 874-8693 (ONLY)

or email: buildinginspections@portlandmaine.gov

With the issuance of this permit, the owner, builder or their designee is required to provide adequate notice to the city of Portland Inspections Services for the following inspections. Appointments must be requested 48 to 72 hours in advance of the required inspection. The inspection date will need to be confirmed by this office.

- **Please read the conditions of approval that is attached to this permit!! Contact this office if you have any questions.**
 - **Permits expire in 6 months. If the project is not started or ceases for 6 months.**
 - **If the inspection requirements are not followed as stated below additional fees may be incurred due to the issuance of a "Stop Work Order" and subsequent release to continue.**
1. Footings/Setbacks prior to pouring concrete
 2. Close In Elec/Plmb/Frame prior to insulate or gypsum
 3. Final Inspection

The project cannot move to the next phase prior to the required inspection and approval to continue, REGARDLESS OF THE NOTICE OF CIRCUMSTANCES.

IF THE PERMIT REQUIRES A CERTIFICATE OF OCCUPANCY, IT MUST BE PAID FOR AND ISSUED TO THE OWNER OR DESIGNEE BEFORE THE SPACE MAY BE OCCUPIED.



PORTLAND MAINE

Strengthening a Remarkable City, Building a Community for Life • www.portlandmaine.gov

Acting Director of Planning and Urban Development
Gregory Mitchell

Job ID: 2012-04-3713-SOB

Located At: 31 SHORE RD

CBL: 106A- B-002-001

Conditions of Approval:

Zoning

1. This permit is being approved on the basis of plans submitted. Any deviations shall require a separate approval before starting that work.
2. This property shall remain a single family dwelling. Any change of use shall require a separate permit application for review and approval.

Building

1. Separate permits are required for any electrical: plumbing, sprinkler, fire alarm, HVAC systems, commercial hood exhaust systems and fuel tanks. Separate plans may need to be submitted for approval as a part of this process.
2. Where ceiling joists are not connected to the rafters at the top wall plate, joists connected higher in the attic shall be installed as rafter ties, or rafter ties shall be installed to provide a continuous tie, see Section R802.3.1.
3. R803.1 Lumber sheathing. Allowable spans for lumber used as roof sheathing shall conform to Table R803.1. Spaced lumber sheathing for wood shingle and shake roofing shall conform to the requirements of Sections R905.7 and R905.8.
4. **Note: Owner stated that this detached accessory structures will be used as a tool storage shed, playhouses and similar uses only (not for living, sleeping, eating, cooking and sanitation).**

City of Portland, Maine - Building or Use Permit Application

389 Congress Street, 04101 Tel: (207) 874-8703, FAX: (207) 8716

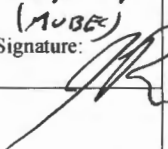
Job No: 2012-04-3713-SOB	Date Applied: 4/6/2012	CBL: 106A- B-002-001	
Location of Construction: 31 SHORE RD, Cushings Island	Owner Name: JONATHAN W NOLAN	Owner Address: 181 CRAIGIE ST PORTLAND, ME 04102	Phone: 207-450-1897
Business Name:	Contractor Name: Owner	Contractor Address:	Phone:
Lessee/Buyer's Name:	Phone:	Permit Type: BLDG - Building	Zone: IR-1
Past Use: Single family	Proposed Use: Same – Single family – build a 12' x 22' detached shed for storage in the winter& family activities in the summer	Cost of Work: 13000.00	CEO District:
		Fire Dept: <input type="checkbox"/> Approved <input type="checkbox"/> Denied <input type="checkbox"/> N/A Signature:	Inspection: Use Group: R3 Type: ✓ IR, 2009 (MUSE) Signature: 
Proposed Project Description: Build shed		Pedestrian Activities District (P.A.D.)	

Permit Taken By:	Zoning Approval		
1. This permit application does not preclude the Applicant(s) from meeting applicable State and Federal Rules. 2. Building Permits do not include plumbing, septic or electrical work. 3. Building permits are void if work is not started within six (6) months of the date of issuance. False informatin may invalidate a building permit and stop all work.	Special Zone or Reviews <input checked="" type="checkbox"/> Shoreland <i>proposed shed is just at 250' or beyond it.</i> <input type="checkbox"/> Wetlands <input type="checkbox"/> Flood Zone <input type="checkbox"/> Subdivision <input type="checkbox"/> Site Plan <input type="checkbox"/> Maj <input type="checkbox"/> Min <input type="checkbox"/> MM Date: <i>OK w/conditions 4/9/12 ABM</i>	Zoning Appeal <input type="checkbox"/> Variance <input type="checkbox"/> Miscellaneous <input type="checkbox"/> Conditional Use <input type="checkbox"/> Interpretation <input type="checkbox"/> Approved <input type="checkbox"/> Denied Date:	Historic Preservation <input checked="" type="checkbox"/> Not in Dist or Landmark <input type="checkbox"/> Does not Require Review <input type="checkbox"/> Requires Review <input type="checkbox"/> Approved <input type="checkbox"/> Approved w/Conditions <input type="checkbox"/> Denied Date: <i>ABM</i>
	CERTIFICATION		

I hereby certify that I am the owner of record of the named property, or that the proposed work is authorized by the owner of record and that I have been authorized by the owner to make this application as his authorized agent and I agree to conform to all applicable laws of this jurisdiction. In addition, if a permit for work described in the application is issued, I certify that the code official's authorized representative shall have the authority to enter all areas covered by such permit at any reasonable hour to enforce the provision of the code(s) applicable to such permit.

SIGNATURE OF APPLICANT	ADDRESS	DATE	PHONE
RESPONSIBLE PERSON IN CHARGE OF WORK, TITLE		DATE	PHONE

IR-I standard.

Entered 4/6/12 (BS)



General Building Permit Application

JO 2012-01-3713-508

If you or the property owner owes real estate or personal property taxes or user charges on any property within the City, payment arrangements must be made before permits of any kind are accepted.

31

Location/Address of Construction: <u>Shore Rd Cushings Island</u>		
Total Square Footage of Proposed Structure/Area <u>2644</u>	Square Footage of Lot	Number of Stories <u>1</u>
Tax Assessor's Chart, Block & Lot Chart# Block# Lot# <u>KOA B002</u> <u>106 A-B-2-4-5-8</u>	Applicant: (must be owner, lessee or buyer) Name <u>Jonathan Nolan</u> Address <u>181 Canigie St</u> City, State & Zip <u>Portland ME 04102</u>	Telephone: <u>450-1897</u> <u>13,000</u>
Lessee/DBA	Owner: (if different from applicant) Name Address City, State & Zip	Cost of Work: \$ <u>12,800</u> C of O Fee: \$ _____ Historic Review: \$ _____ Planning Amin.: \$ _____ Total Fee: \$ <u>160.00</u> <u>50.00</u> <u>\$ 210.00</u>
Current legal use (i.e. single family) <u>Single Family</u> Number of Residential Units _____ If vacant, what was the previous use? _____ Proposed Specific use: <u>Arts + Crafts summer / Storage winter</u> Is property part of a subdivision? <u>NO</u> If yes, please name _____ Project description: <u>12' x 22" Arts + Craft shed - Storage in the winter - Build *4/12 ver from 450-1897 - shed is for activities for family only - plan to go when bird water.</u>		
Contractor's name: <u>OWNER</u> Email: _____ Address: <u>Cushings Island e-mail</u> Telephone: _____ City, State & Zip _____ Telephone: _____ Who should we contact when the permit is ready: _____ Telephone: _____ Mailing address: _____		

RECEIVED
APR 06 2012
City of Building Inspections
City of Portland Maine

Please submit all of the information outlined on the applicable checklist. Failure to do so will result in the automatic denial of your permit.

In order to be sure the City fully understands the full scope of the project, the Planning and Development Department may request additional information prior to the issuance of a permit. For further information or to download copies of this form and other applications visit the Inspections Division on-line at www.portlandmaine.gov, or stop by the Inspections Division office, room 315 City Hall or call 874-8703.

and I hereby certify that I am the Owner of record of the named property, or that the owner of record authorizes the proposed work and that I have been authorized by the owner to make this application as his/her authorized agent. I agree to conform to all applicable laws of this jurisdiction. In addition, if a permit for work described in this application is issued, I certify that the Code Official's authorized representative shall have the authority to enter all areas covered by this permit at any reasonable hour to enforce the provisions of the codes applicable to this permit.

Signature: [Signature] Date: 4/4/12

This is not a permit; you may not commence ANY work until the permit is issued

31 Shore Rd., Cushings Island

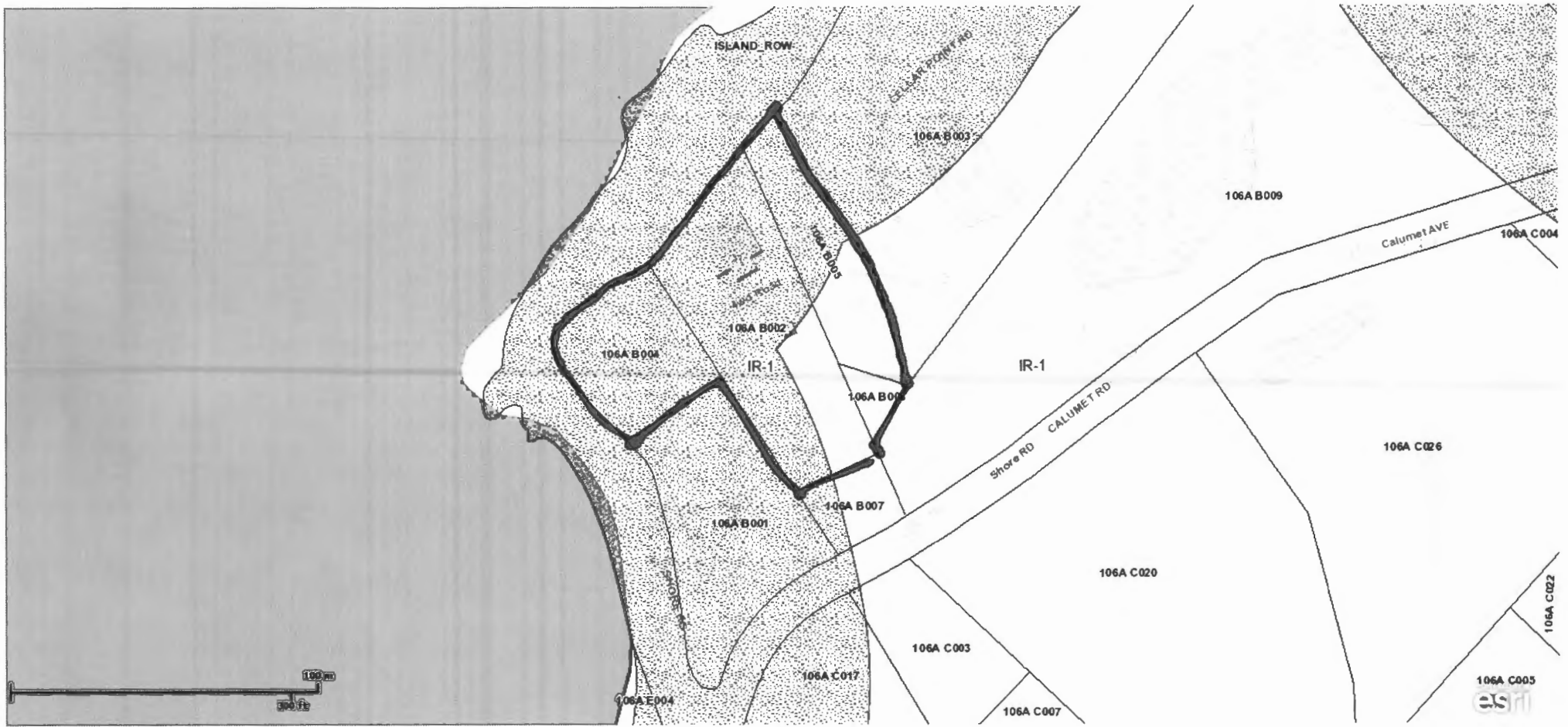

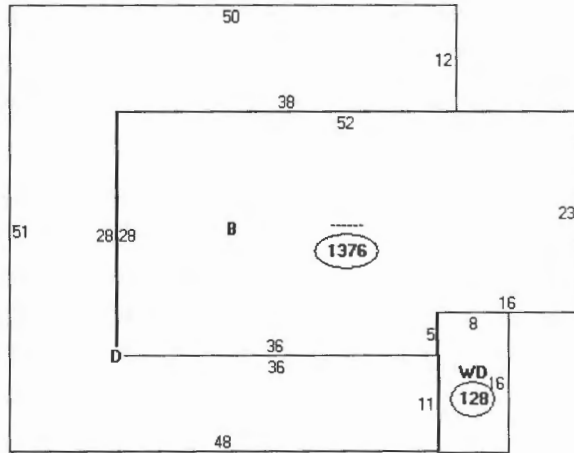

Descriptor/Area	
A: ---	1376 sqft
B: OFP	1464 sqft
C: WD	128 sqft
D: RS1	144 sqft

29.68

IR-1

lot size 71,323 sq ft

front 30' min.
 rear 30' min ← 31' from property line (sk)
 side 20' min.

lot coverage 20% = 14,264.6 sq ft

have 29,68
 shed 264

 32,32 (sk)



Google Earth - Edit Polygon

Name:

Description	Style, Color	View	Altitude	Measurements
-------------	--------------	------	----------	--------------

Description:

Nolan cottage
Cushings Island, Portland, ME

Shed to be set back from road approximately 20' and set back from property line approximately 30'. Blue line shows 20' set back from property line

Cancel



PORTLAND MAINE

Strengthening a Remarkable City, Building a Community for Life • www.portlandmaine.gov

Receipts Details:

Tender Information: Check , Check Number: 2099

Tender Amount: 200.00

Receipt Header:

Cashier Id: bsaucier

Receipt Date: 4/6/2012

Receipt Number: 42619

Receipt Details:

Referance ID:	5978	Fee Type:	BP-Constr
Receipt Number:	0	Payment Date:	
Transaction Amount:	150.00	Charge Amount:	150.00
Job ID: Job ID: 2012-04-3713-SOB - Build shed			
Additional Comments: 31 Shore Rd CI			

Referance ID:	5979	Fee Type:	BP-HRAD
Receipt Number:	0	Payment Date:	
Transaction Amount:	50.00	Charge Amount:	50.00
Job ID: Job ID: 2012-04-3713-SOB - Build shed			

Additional Comments:

Thank You for your Payment!