

SUBSURFACE WASTEWATER DISPOSAL SYSTEM APPLICATION

Maine Department of Human Services
Division of Health Engineering, Station 10 SHS
(207) 287-5672 FAX (207) 287-4172

PROPERTY LOCATION		>> Caution: Permit Required - Attach In Space Below <<	
City, Town, or Plantation	PORTLAND, PEAKS ISLAND	<i>2006-6-21</i>	
Street or Road	51 WOODS ROAD		
Subdivision, Lot #			
OWNER/APPLICANT INFORMATION		PORTLAND	PERMIT # 10432 TOWN COPY
Name (last, first, MI)	ASTARITA ARTHUR	Date Permit Issued: 10/2/07	\$ 1110.00 <input type="checkbox"/> If Double Fee Charged
Mailing Address of		Local Plumbing Inspector Signature: <i>Thomas N. Monteleone</i>	L.P.I. # 01744
Daytime Tel. #	766-5997	<i>42623</i>	
		Municipal Tax Map - 92	Lot 13, 3032
		Lat. N 43 40' 18" Lon. W 70 11' 6"	

Owner or Applicant Statement		Caution: Inspections Required	
I state and acknowledge that the information submitted is correct to the best of my knowledge and understand that any falsification is reason for the Department and/or Local Plumbing Inspector to deny a permit.		I have inspected the installation authorized above and found it to be in compliance with the Subsurface Wastewater Disposal Rules Application.	
<i>Astarita</i> 10 Oct 07			
Signature of Owner/Applicant		Local Plumbing Inspector Signature	
Date		(1st) Date Approved	
		(2nd) Date Approved	

PERMIT INFORMATION

TYPE OF APPLICATION 1. <input type="checkbox"/> First Time System 2. <input checked="" type="checkbox"/> Replacement System Type Replaced: <u>PLASTIC CHAMBERS</u> Year Installed: <u>1994</u> 3. <input type="checkbox"/> Expanded System a. <input type="checkbox"/> Minor Expansion b. <input type="checkbox"/> Major Expansion 4. <input type="checkbox"/> Experimental System 5. <input type="checkbox"/> Seasonal Conversion	THIS APPLICATION REQUIRES 1. <input checked="" type="checkbox"/> No Rule Variance 2. <input type="checkbox"/> First Time System Variance a. <input type="checkbox"/> Local Plumbing Inspector Approval b. <input type="checkbox"/> State & Local Plumbing Inspector Approval 3. <input type="checkbox"/> Replacement System Variance a. <input type="checkbox"/> Local Plumbing Inspector Approval b. <input type="checkbox"/> State & Local Plumbing Inspector Approval 4. <input type="checkbox"/> Minimum Lot Size Variance 5. <input type="checkbox"/> Seasonal Conversion Approval	DISPOSAL SYSTEM COMPONENTS 1. <input type="checkbox"/> Complete Non-Engineered System 2. <input type="checkbox"/> Primitive System (graywater & alt toilet) 3. <input type="checkbox"/> Alternative Toilet, specify: _____ 4. <input type="checkbox"/> Non-Engineered Treatment Tank (only) 5. <input type="checkbox"/> Holding Tank, _____ Gallons 6. <input checked="" type="checkbox"/> Non-Engineered Disposal Field (only) 7. <input type="checkbox"/> Separated Laundry System 8. <input type="checkbox"/> Complete Engineered System (2000 gpd) 9. <input type="checkbox"/> Engineered Treatment Tank (only) 10. <input type="checkbox"/> Engineered Disposal Field (only) 11. <input type="checkbox"/> Pre-treatment, specify: _____ 12. <input type="checkbox"/> Miscellaneous components
SIZE OF PROPERTY <u>3.32 ACRES</u> <input type="checkbox"/> sq. ft. <input type="checkbox"/> acres	DISPOSAL SYSTEM TO SERVE 1. <input checked="" type="checkbox"/> Single Family Dwelling Unit, No. of Bedrooms: <u>3</u> 2. <input type="checkbox"/> Multiple Family Dwelling, No. of Units: _____ 3. <input type="checkbox"/> Other: _____ SPECIFY Current Use <input type="checkbox"/> Seasonal <input checked="" type="checkbox"/> Year Round <input type="checkbox"/> Undeveloped	TYPE OF WATER SUPPLY 1. <input checked="" type="checkbox"/> Drilled Well 2. <input type="checkbox"/> Dug Well 3. <input type="checkbox"/> Private 4. <input type="checkbox"/> Public 5. <input type="checkbox"/> Other: _____
SHORELAND ZONING <input type="checkbox"/> Yes <input checked="" type="checkbox"/> No		

DESIGN DETAILS (SYSTEM LAYOUT SHOWN ON PAGE 3)

TREATMENT TANK 1. <input checked="" type="checkbox"/> Concrete a. <input checked="" type="checkbox"/> Regular b. <input type="checkbox"/> Low Profile 2. <input type="checkbox"/> Plastic 3. <input type="checkbox"/> Other: _____ CAPACITY <u>1000</u> gallons	DISPOSAL FIELD TYPE & SIZE 1. <input type="checkbox"/> Stone Bed 2. <input type="checkbox"/> Stone Trench 3. <input checked="" type="checkbox"/> Proprietary Device a. <input type="checkbox"/> Cluster array c. <input checked="" type="checkbox"/> Linear b. <input checked="" type="checkbox"/> Regular d. <input type="checkbox"/> H-20 loaded 4. <input type="checkbox"/> Other: _____ SIZE <u>92</u> sq. ft. <input type="checkbox"/> lin. f. ADD <input checked="" type="checkbox"/> Filter on tank outlet 19 ELJEN IN DRAIN UNIT	GARBAGE DISPOSAL UNIT 1. <input checked="" type="checkbox"/> No 3. <input type="checkbox"/> Maybe 2. <input type="checkbox"/> Yes >> Specify one below a. <input type="checkbox"/> Multi-compartment tank b. <input type="checkbox"/> _____ tanks in series c. <input type="checkbox"/> Increase in tank capacity d. <input checked="" type="checkbox"/> Filter on tank outlet	DESIGN FLOW 270 gallons per day BASED ON: 1. <input checked="" type="checkbox"/> Table 501.1 (dwelling unit(s)) 2. <input type="checkbox"/> Table 501.2 (other facilities) SHOW CALCULATIONS - for other facilities - 3 BEDROOMS AT 90 GALLONS PER DAY EACH
SOIL DATA & DESIGN CLASS PROFILE <u>12</u> CONDITION <u>A</u> DESIGN <u>2</u> AT Observation Hole # <u>TP 1</u> Depth <u>30</u> " OF MOST LIMITING SOIL FACTOR	DISPOSAL FIELD SIZING 1. <input type="checkbox"/> Small - 2.0 sq.ft./gpd 2. <input type="checkbox"/> Medium - 2.6 sq.ft./gpd 3. <input checked="" type="checkbox"/> Medium-Large - 3.3 sq.ft./gpd 4. <input type="checkbox"/> Large - 4.1 sq.ft./gpd 5. <input type="checkbox"/> Extra-Large - 5.0 sq.ft./gpd	EFFLUENT/EJECTOR PUMP 1. <input type="checkbox"/> Not required 2. <input checked="" type="checkbox"/> May be required 3. <input type="checkbox"/> Required >> Specify only for engineered or experimental systems: DOSE: _____ Gallons	3. <input type="checkbox"/> Section 503.0 (meter readings) ATTACH WATER-METER DATA

SITE EVALUATOR STATEMENT

I certify that on 9/6/06 (date) completed a site evaluation on this property, and state that the data reported is accurate and that the proposed system is in compliance with the Subsurface Wastewater Disposal Rules (10-144A CMP 241).

<i>Albert Frick</i>	163	<u>10/6/2006</u>
Site Evaluator Signature	SE #	Date
ALBERT FRICK	(207) 839-5563	AFA@MAINERR.COM
Site Evaluator Name Printed	Telephone Number	E-mail Address

ALBERT FRICK ASSOCIATES - 95A COUNTY ROAD ROAD GORHAM, MAINE 04038 - (207) 839-5563
 Note: Changes to or deviations from the design should be confirmed with the Site Evaluator
 HHE-200 Rev. 4 05

SUBSURFACE WASTEWATER DISPOSAL SYSTEM APPLICATION

Maine Department of Human Services
 Division of Health Engineering, Station 10, SHS
 (207) 287-5672 FAX: (207) 287-4172

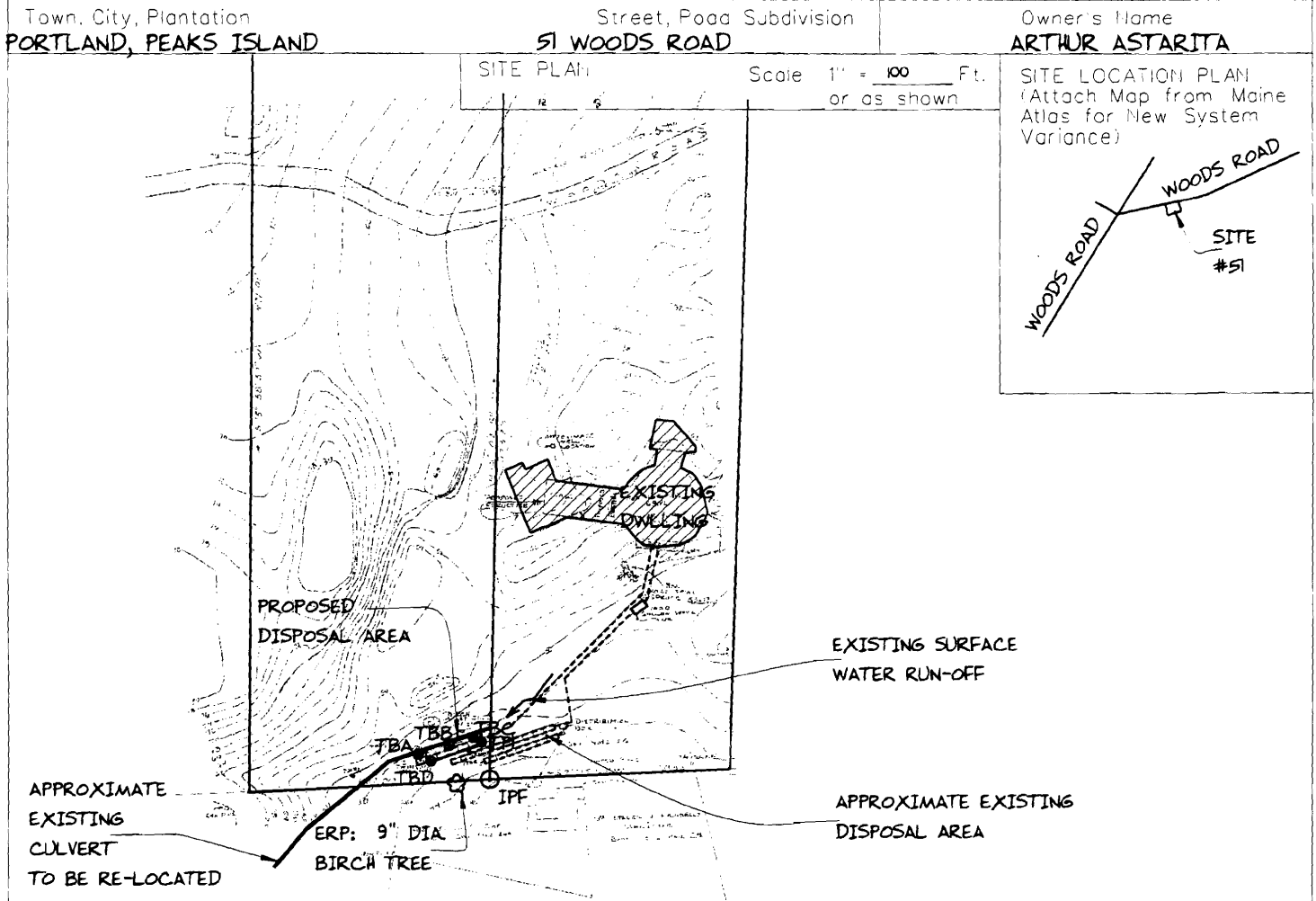

SOIL DESCRIPTION AND CLASSIFICATION (Location of Observation Holes Shown Above)

Observation Hole TP 1 Test Pit Boring
 " Depth of Organic Horizon Above Mineral Soil

DEPTH BELOW MINERAL SOIL SURFACE (inches)	Texture	Consistency	Color	Mottling
0	SANDY LOAM		BROWN	
10				
20	LOAMY SAND (FILL)	FRIABLE	YELLOW BROWN	
30	BEDROCK			
40				
50				

Soil Classification: Profile 12 Condition A Slope --- % Limiting Factor 30 " Ground Water Restrictive Layer Bedrock Pit Depth

Observation Hole _____ Test Pit Boring
 " Depth of Organic Horizon Above Mineral Soil

DEPTH BELOW MINERAL SOIL SURFACE (inches)	Texture	Consistency	Color	Mottling
0				
10				
20				
30				
40				
50				

Soil Classification: Profile _____ Condition _____ Slope _____ % Limiting Factor _____ " Ground Water Restrictive Layer Bedrock Pit Depth

Albert Frick
 Site Evaluator Signature

163
 SE

10/6/2006
 Date

Page 2 of 3
 HHE-200 Rev 10:02

SUBSURFACE WASTEWATER DISPOSAL SYSTEM APPLICATION

Maine Department of Human Services
 Division of Health Engineering, Station 10, SHS
 (207) 287-5672 FAX (207) 287-4112

Town, City, Plantation

Street, Road, Subdivision

Owner's Name

PORTLAND, PEAKS ISLAND

51 WOODS ROAD

ARTHUR ASTARITA

NOTE: THOROUGHLY SCARIFY (WITH ROTOTILLES SUBSURFACE WASTEWATER DISPOSAL PLAN OR EXCAVATOR TEETH) UNDER ENTIRE DISPOSAL FIELD, SHOULDER AREA, & FILL EXTENSION AREA PRIOR TO FILL PLACEMENT, THEN MIX FIRST 6" LIFT OF FILL INTO EXISTING SOIL SURFACE TO PROMOTE MIXING

SCALE 1" = 20 FT.

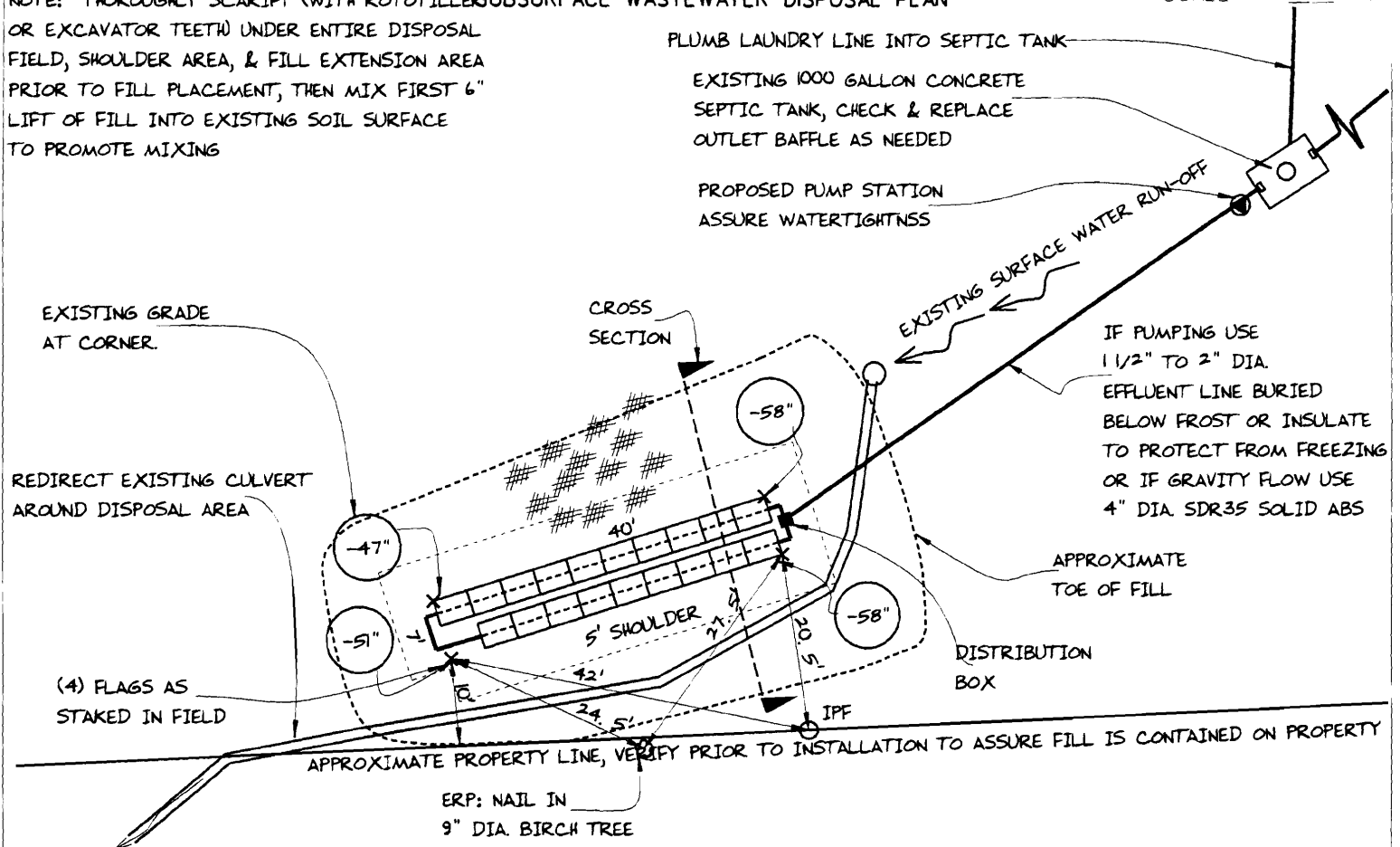

FILL REQUIREMENTS

Depth of Fill (Upslope) : 19" - 30"
 Depth of Fill (Downslope) : 23" - 30"
 DEPTHS AT CROSS-SECTION (shown below)

CONSTRUCTION ELEVATIONS

Finished Grade Elevation
 Top of Distribution Pipe or Proprietary Device
 Bottom of Disposal Area

ELEVATION REFERENCE POINT

SEE DETAIL BELOW Location & Description NAIL IN 9" DIA. BIRCH TREE, 88" ABOVE BASE OF TREE
 Reference Elevation is: 0.0" or -----

DISPOSAL AREA CROSS SECTION

SCALE:
 VERTICAL: 1" = 5 FT
 HORIZONTAL: 1" = 5 FT

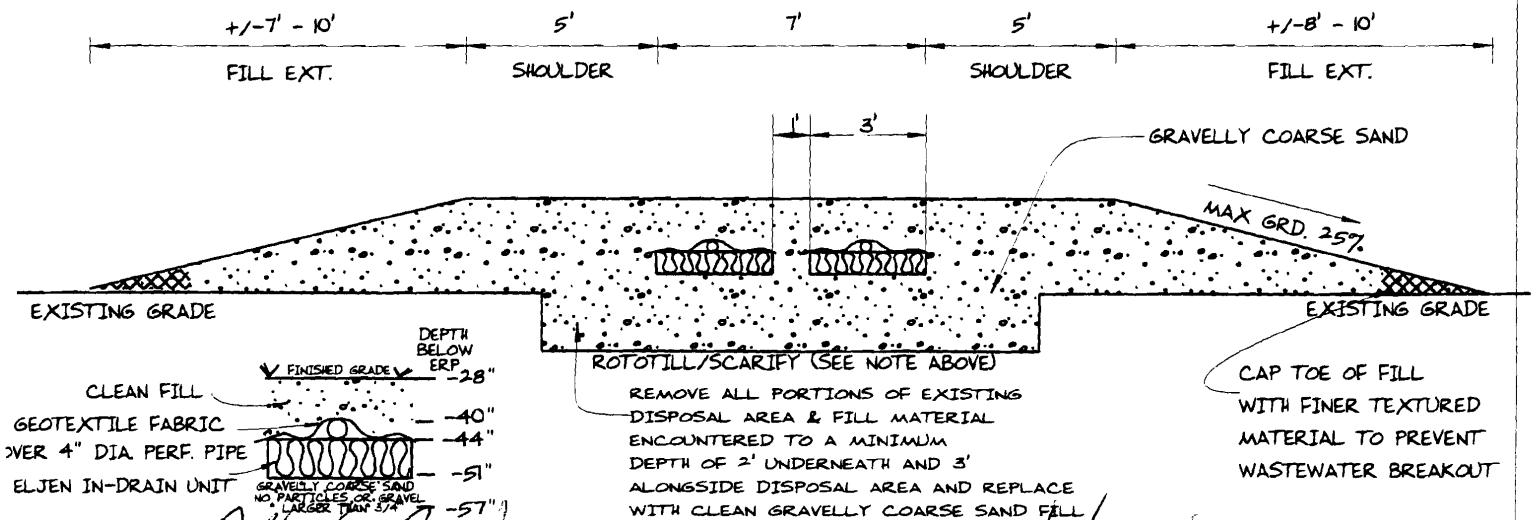

Albert Frick
 Site Evaluator Signature

163

SE "

10/6/2006
 Date

Page 3 of 3
 HHE-200 Rev. 10/02



Albert Frick Associates, Inc.

Soil Scientists & Site Evaluators

95A County Road Gorham, Maine 04058

(207) 859-5565

PORTLAND, PEAKS ISLAND	51 WOODS ROAD	ARTHUR ASTARITA
TOWN	LOCATION	APPLICANT'S NAME

1) The Plumbing and Subsurface Wastewater Disposal Rules adopted by the State of Maine, Department of Human Services pursuant to 22 M.R.S.A. § 42 (the "Rules") are incorporated herein by reference and made a part of this application and shall be consulted by the owner/applicant, the system installer and/or building contractor for further construction details and material specifications. The system Installer should contact Albert Frick Associates, Inc. 839-5563, if there are any questions concerning materials, procedures or designs. The system installer and/or building contractor installing the system shall be solely responsible for compliance with the Rules and with all state and municipal laws and ordinances pertaining to the permitting, inspection and construction of subsurface wastewater disposal systems.

2) This application is intended to represent facts pertinent to the Rules only. It shall be the responsibility of the owner/applicant, system Installer and/or building contractor to determine compliance with and to obtain permits under all applicable local, state and/or federal laws and regulations (including, without limitation, Natural Resources Protection Act, wetland regulations, zoning ordinances, subdivision regulations, Site Location of Development Act and minimum lot size laws) before installing this system or considering the property on which the system is to be installed a "buildable" lot. It is recommended that a wetland scientist be consulted regarding wetland regulations. Prior to the commencement of construction/installation, the local plumbing inspector or Code Enforcement Officer shall inform the owner/applicant and Albert Frick Associates, Inc of any local ordinances which are more restrictive than the Rules in order that the design may be amended. All designs are subject to review by local, state and/or federal authorities. Albert Frick Associates, Inc.'s liability shall be limited to revisions required by regulatory agencies pursuant to laws or regulations in effect at the time of preparation of this application.

3) All information shown on this application relating to property lines, well locations, subsurface structures and underground facilities (such as utility lines, drains, septic systems, water lines, etc.) are based solely upon information provided by the owner/applicant and has been relied upon by Albert Frick Associates, Inc. in preparing this application. The owner/applicant shall review this application prior to the start of construction and confirm this information. Well locations on abutting properties but not readily visible above grade should be confirmed by the owner/applicant prior to system installation to assure minimum setbacks.

4) Installation of a garbage (grinder) disposal is not recommended. If one is installed, an additional 1000 gallon septic tank or a septic tank filter shall be connected in series to the proposed septic tank.

5) The system user shall avoid introducing kitchen grease or fats into this system. Chemicals such as septic tank cleaners and/or chlorine (such as from water treatment units) and controlled or hazardous substances shall not be disposed of in this system. Additives such as yeast or enzymes are discouraged, since they have not been proven to extend system life.

6) The septic tank should be pumped within two years of installation and subsequently as recommended by the pump service, but in no event should the septic tank be pumped less often than every three years. All septic tank, pump stations and additional treatment tanks shall be installed to prevent ground water and surface water infiltration.

PORTLAND, PEAKS ISLAND

51 WOODS ROAD

ARTHUR ASTARITA

TOWN

LOCATION

APPLICANT'S NAME

7) The actual water flow or number of bedrooms shall not exceed the design criteria indicated on this application without a re-evaluation of the system as proposed. If the system is supplied by public water or a private service with a water meter, the water consumption per period should be divided by the number of days to calculate the average daily water consumption (water usage (cu. ft.) x 7.48 cu. ft. (gallons per cu. ft.) divided by the # of days in period).

8) The general minimum setbacks between a well and septic system serving a single family residence is 100-300 feet, unless the local municipality has a more stringent requirement. A well installed by an abutter within the minimum setback distances prior to the issuance of a permit for the proposed disposal system may void this design.

9) When a gravity system is proposed: BEFORE CONSTRUCTION/INSTALLATION BEGINS, the system installer or building contractor shall review the elevations of all points given in this application and the elevation of the existing and/or proposed building drain and septic tank inverts for compatibility to minimum slope requirement. In gravity systems, the invert of the septic tank(s) outlet(s) shall be at least 4 inches above the invert of the distribution box outlet at the disposal area. When an effluent pump is required, provisions shall be made to make certain that surface ground water does not enter the septic tank or pump station, by sealing/grouting all seams and connections, and by placement of a riser and lid at or above grade. An alarm device warning of a pump failure shall be installed. Also, when pumping is required of a chamber system, install a "T" connection in the distribution box and place 3 inches of stone or a splash plate in the first chamber. Insulate gravity pipes, pump lines and the distribution box as necessary to prevent freezing.

10) On all systems, remove the vegetation, organic duff and old fill material from under the disposal area and any fill extension. On sites where the proposed system is to be installed in natural soil, scarify the bottom and sides of the excavated disposal area with a rake. Do not use wheeled equipment on the scarified soil surface. For systems installed in fill, scarify the native soil by roto-tilling to a depth of at least 8 inches over the entire disposal and fill extension area to prevent glazing and to promote fill bonding. Place fill in loose layers no deeper than 8 inches and compact before placing more fill (this ensures that voids and loose pockets are eliminated to minimize the chance of leakage or differential setting). Do not use wheeled equipment on the scarified soil area until after 12 inches of fill is in place. Keep equipment off proprietary devices. Divert the surface water away from the disposal area by ditching or shallow landscape swales.

11) Unless noted otherwise, fill shall be gravelly coarse sand, which contains no more than 5% fines (silt and clay).

12) Do not install systems on loamy, silty, or clayey soils during wet periods since soil smearing/glazing may seal off the soil interface.

13) Seed all filled and disturbed surfaces with perennial grass seed, then mulch with hay or equivalent material to prevent erosion. Alternatively, bark or permanent landscape mulch may be used to cover system, Woody trees or shrubs are not permitted on the disposal area or fill extensions.



Albert Frick Associates, Inc.
Soil Scientists & Site Evaluators

95A County Road Gorham, Maine 04058
(207) 859-5565