

NOTES

Thompson Johnson
Woodworks
115 Island Avenue
Peaks Island ME 04108
207.766.5919

Proposed Demolition and Framing

PROJECT
Engdahl Kitchen 2015
14 Brook Lane
Peaks Island, ME 04108

DATE 12-30-14	REVISED
SCALE 1/2"=1'	DRAWN BY Heather

NOTES

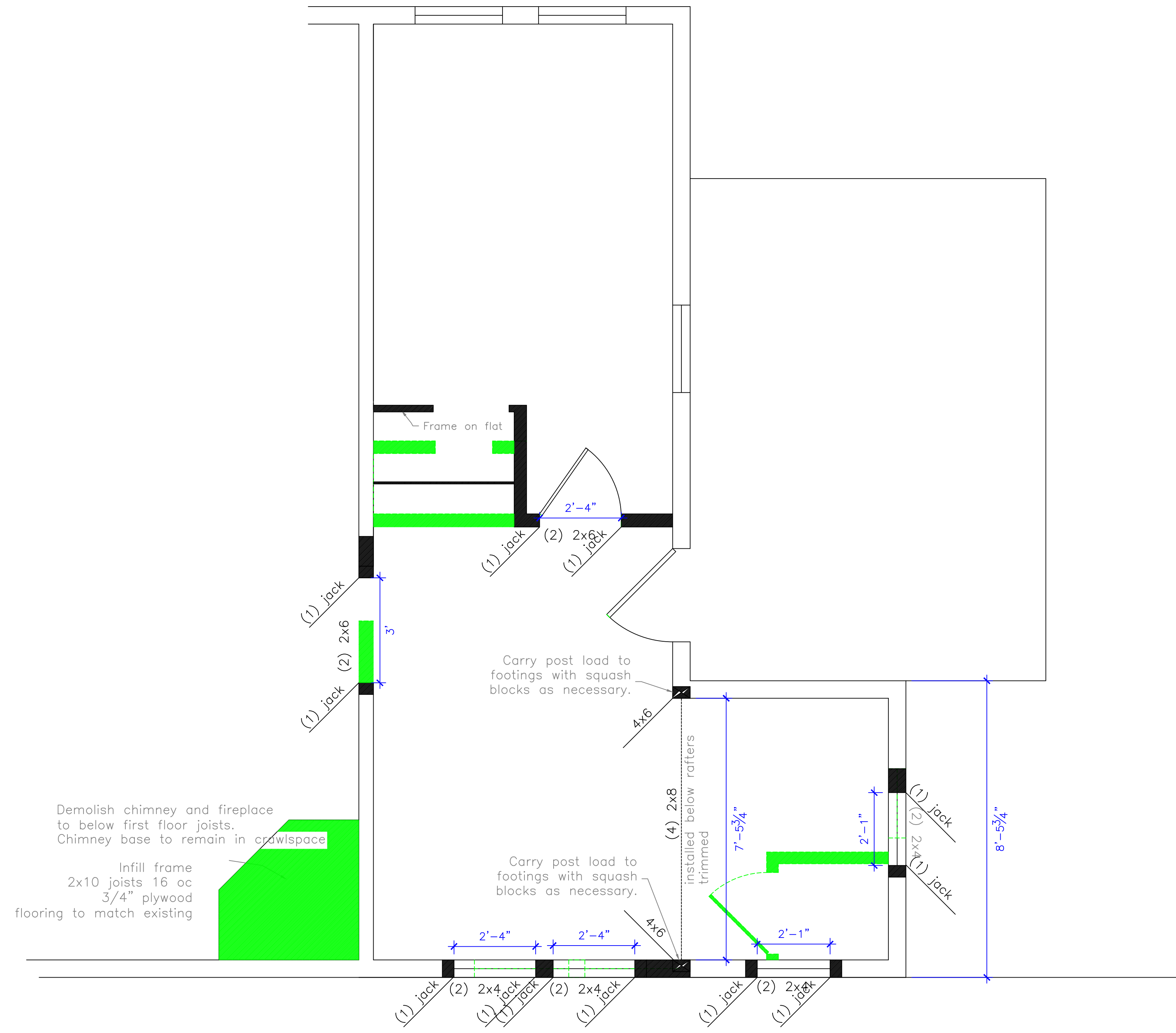

Demolish chimney and fireplace to below first floor joists. Chimney base to remain in crawlspace

Infill frame
2x10 joists 16 oc
3/4" plywood flooring to match existing

A Demolition and Framing Plan
scale: 1/2"=1'

- existing wall
- new wall
- demolition