

092-E-017+

SUBSURFACE WASTEWATER DISPOSAL SYSTEM APPLICATION

PROPERTY ADDRESS

Town Or Plantation: PORTLAND (PEAKS ISLAND)

Street Subdivision Lot #: MAP 92, SEC. E, LOTS 17 & 39 ISLAND AVENUE (617)

PROPERTY OWNERS NAME

Last: N/F CANTWELL First: MAUREEN

Applicant Name: MIKE LANGELLA

Mailing Address of Owner/Applicant (If Different): 17 LASKEY ROAD WINDHAM, ME. 04062

PORTLAND Date Permit Issued: 2.9.99 6756 TOWN COPY

\$ 100 FEB If Double Fee Charged

L.P.I. # 0124

Local Plumbing Inspector Signature: _____

4-30-99 Elevations on bed all OK to Back Fill T.R.

Owner/Applicant Statement

I certify that the information submitted is correct to the best of my knowledge and understand that any falsification is reason for the Local Plumbing Inspector to deny a Permit.

Michael Langella 2/9/99

Signature of Owner/Applicant Date

Caution: Inspection Required

I have inspected the installation authorized above and found it to be in compliance with the Subsurface Wastewater Disposal Rules.

[Signature] 1.4.99

Local Plumbing Inspector Signature Date Approved

PERMIT INFORMATION

THIS APPLICATION IS FOR:

1. NEW SYSTEM

2. REPLACEMENT SYSTEM

3. EXPANDED SYSTEM

4. EXPERIMENTAL SYSTEM

THIS APPLICATION REQUIRES:

1. NO RULE VARIANCE

2. NEW SYSTEM VARIANCE
Attach New System Variance Form

3. REPLACEMENT SYSTEM VARIANCE
Attach Replacement System Variance Form

a. Requiring Local Plumbing Inspector Approval

b. Requires State and Local Plumbing Inspector Approval

4. MINIMUM LOT SIZE VARIANCE

INSTALLATION IS:

COMPLETE SYSTEM

1. NON-ENGINEERED SYSTEM

2. PRIMITIVE SYSTEM
(Includes Alternative Toilet)

3. ENGINEERED (+ 2000 gpd)

INDIVIDUALLY INSTALLED COMPONENTS:

4. TREATMENT TANK (ONLY)

5. HOLDING TANK _____ GAL

6. ALTERNATIVE TOILET (ONLY)

7. NON-ENGINEERED DISPOSAL AREA (ONLY)

8. ENGINEERED DISPOSAL AREA (ONLY)

9. SEPARATED LAUNDRY SYSTEM

SEASONAL CONVERSION

to be completed by the LPI:

5. SYSTEM COMPLIES WITH RULES

6. CONNECTED TO SANITARY SEWER

7. SYSTEM INSTALLED - P# _____

8. SYSTEM DESIGN RECORDED AND ATTACHED

DISPOSAL SYSTEM TO SERVE:

1. SINGLE FAMILY DWELLING

2. MODULAR OR MOBILE HOME

3. MULTIPLE FAMILY DWELLING

4. OTHER _____

SPECIFY _____

APPLICANT SHALL PROVIDE INFORMATION TO C.E.O. THAT LOT IS GRANDFATHER PER MIN. LOT SIZE

IF REPLACEMENT SYSTEM:

YEAR FAILING SYSTEM INSTALLED N/A

THE FAILING SYSTEM IS:

1. BED 3. TRENCH

2. CHAMBER 4. OTHER: _____

SIZE OF PROPERTY: 17,500 S.F. #

ZONING: SHORELAND

DESIGN DETAILS (SYSTEM LAYOUT SHOWN ON PAGE 3)

TREATMENT TANK

1. SEPTIC: Regular Low Profile

2. AEROBIC (IF NECESSARY)

SIZE: 1000 GALS.

WATER CONSERVATION

1. NONE

2. LOW VOLUME TOILET

3. SEPARATED LAUNDRY SYSTEM

4. ALTERNATIVE TOILET

SPECIFY: _____

PUMPING

1. NOT REQUIRED

2. MAY BE REQUIRED
(DEPENDING ON TREATMENT TANK LOCATION AND ELEVATION)

3. REQUIRED

DOSE: _____ GALS.

CRITERIA USED FOR DESIGN FLOW (BEDROOMS, SEATING, EMPLOYEES, WATER RECORDS, ETC.)

SINGLE FAMILY DWELLING (3 BEDROOM)

DESIGN FLOW: 270
(GALLONS/DAY)

20 PLASTIC CHAMBERS

SOIL CONDITIONS USED FOR DESIGN PURPOSES

PROFILE	CONDITION
<u>2</u>	<u>A/C</u>

DEPTH TO LIMITING FACTOR: 25-34

SIZE RATINGS USED FOR DESIGN PURPOSES

1. SMALL

2. MEDIUM

3. MEDIUM-LARGE

4. LARGE

5. EXTRA LARGE

DISPOSAL AREA TYPE/SIZE

1. BED _____ Sq. Ft.

2. CHAMBER 500 Sq. Ft.

REGULAR H-20

3. TRENCH _____ Linear Ft.

4. OTHER: _____

SITE EVALUATOR STATEMENT

On DECEMBER 30, 1994 (date) I conducted a site evaluation for this project and certify that the data reported is accurate. The system I propose is in accordance with the Subsurface Wastewater Disposal Rules.

Albert Feick
Site Evaluator Signature

163
SE#

1/12/95
Date

(Local Plumbing Inspector's Signature if permit is for Seasonal Conversion.)

SUBSURFACE WASTEWATER DISPOSAL SYSTEM APPLICATION

Department of Human Services
Division of Health Engineering

Town, City, Plantation

Street, Road, Subdivision

Owners Name

PORTLAND (PEAKS ISLAND)

ISLAND AVENUE
SITE PLAN

N/F CANTWELL (MIKE LANGELLA)

Scale 1" = 50 ± Ft.

SITE LOCATION PLAN (Attach Map from Maine Atlas for New System Variance)

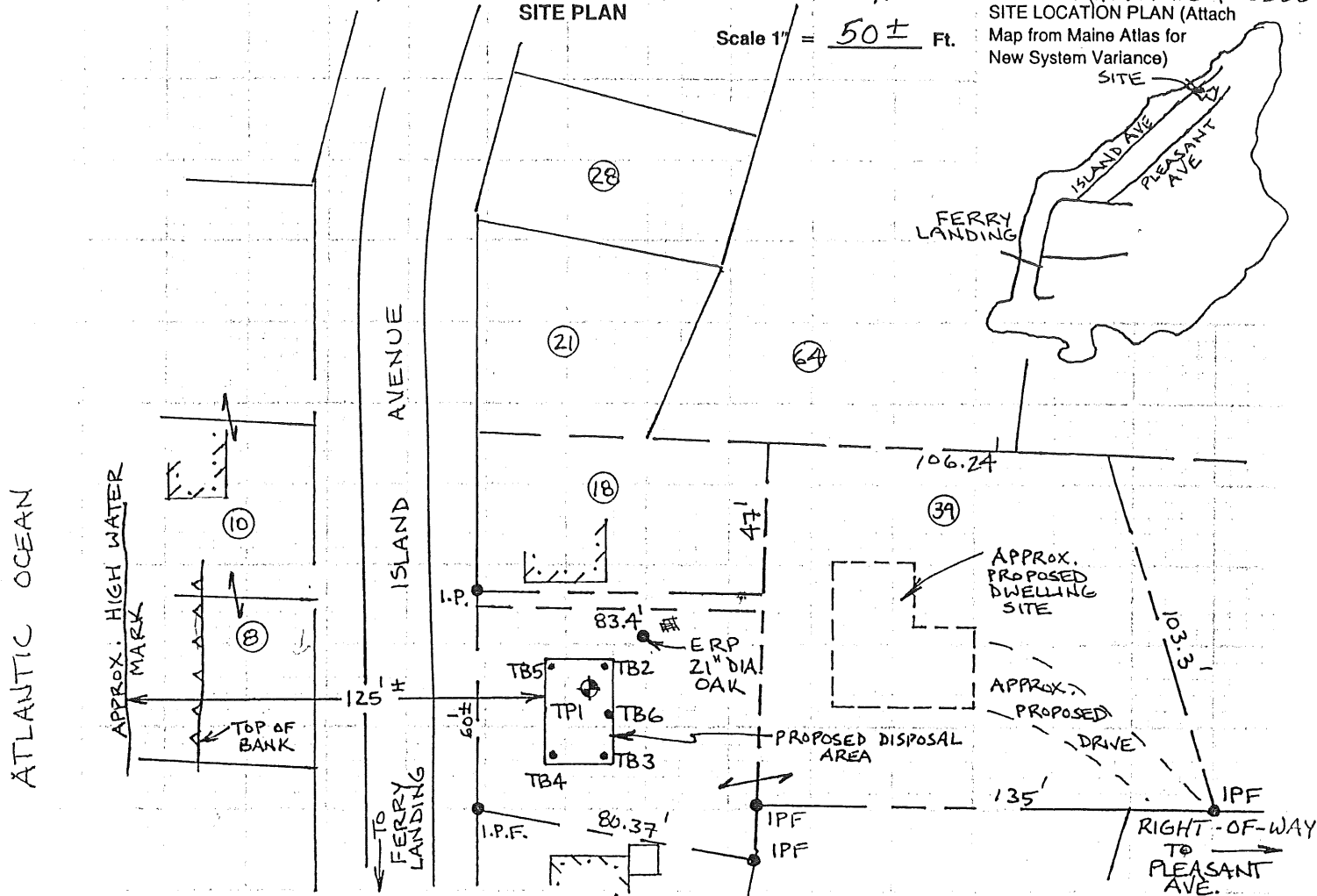

SOIL DESCRIPTION AND CLASSIFICATION

(Location of Observation Holes Shown Above)

Observation Hole TPI Test Pit Boring

_____ " Depth of Organic Horizon Above Mineral Soil

Texture	Consistency	Color	Mottling
0			
6		DARK	
10		BROWN	
15	FRIABLE		
20		DARK YELLOWISH	
25		BROWN	FEW, FAINT
30			
35			
40			
45			
50			

Soil Profile <u>2</u>	Classification Condition <u>A/C</u>	Slope _____ %	Limiting Factor <u>30</u>	<input type="checkbox"/> Ground Water
			<input type="checkbox"/> Restrictive Layer	<input checked="" type="checkbox"/> Bedrock

Observation Hole TB2 Test Pit Boring

_____ " Depth of Organic Horizon Above Mineral Soil

Texture	Consistency	Color	Mottling
0			
6			
10			
15			
20			
25			
30			
35			
40			
45			
50			

Soil Profile _____	Classification Condition _____	Slope _____ %	Limiting Factor <u>25</u>	<input type="checkbox"/> Ground Water
			<input type="checkbox"/> Restrictive Layer	<input checked="" type="checkbox"/> Bedrock

Albert Feick
Site Evaluator Signature

163
SE#

1/12/95
Date



Albert Frick Associates, Inc.
 Soil Scientists & Site Evaluators
 95A County Road Gorham, Maine 04038
 (207) 839-5563

Town, City, Plantation PORTLAND (PEAKS ISLAND)	Street, Road, Subdivision ISLAND AVENUE	Owners Name N/F CANTWELL (MIKE LANGELLA)
--	---	--

SOIL DESCRIPTION AND CLASSIFICATION																																																																																																	
Observation Hole <u>TB 3</u> <input type="checkbox"/> Test Pit <input checked="" type="checkbox"/> Boring _____ " Depth of Organic Horizon Above Mineral Soil	Observation Hole <u>TB 4</u> <input type="checkbox"/> Test Pit <input checked="" type="checkbox"/> Boring _____ " Depth of Organic Horizon Above Mineral Soil																																																																																																
<table border="1" style="width:100%; border-collapse: collapse;"> <tr> <th style="width:10%;">Texture</th> <th style="width:10%;">Consistency</th> <th style="width:10%;">Color</th> <th style="width:10%;">Mottling</th> </tr> <tr><td>0</td><td></td><td></td><td></td></tr> <tr><td>6</td><td></td><td></td><td></td></tr> <tr><td>10</td><td></td><td></td><td></td></tr> <tr><td>15</td><td></td><td></td><td></td></tr> <tr><td>20</td><td></td><td></td><td></td></tr> <tr><td>30</td><td></td><td></td><td></td></tr> <tr><td>40</td><td></td><td></td><td></td></tr> <tr><td>50</td><td></td><td></td><td></td></tr> </table> <p style="text-align: center;">BEDROCK</p> <table border="1" style="width:100%; border-collapse: collapse;"> <tr> <td style="width:15%;">Soil Classification</td> <td style="width:15%;">Slope</td> <td style="width:15%;">Limiting Factor</td> <td style="width:15%;"><input type="checkbox"/> Ground Water</td> </tr> <tr> <td>Profile _____ Condition _____</td> <td>_____ %</td> <td><u>33</u></td> <td><input type="checkbox"/> Restrictive Layer</td> </tr> <tr> <td></td> <td></td> <td></td> <td><input checked="" type="checkbox"/> Bedrock</td> </tr> </table>	Texture	Consistency	Color	Mottling	0				6				10				15				20				30				40				50				Soil Classification	Slope	Limiting Factor	<input type="checkbox"/> Ground Water	Profile _____ Condition _____	_____ %	<u>33</u>	<input type="checkbox"/> Restrictive Layer				<input checked="" type="checkbox"/> Bedrock	<table border="1" style="width:100%; border-collapse: collapse;"> <tr> <th style="width:10%;">Texture</th> <th style="width:10%;">Consistency</th> <th style="width:10%;">Color</th> <th style="width:10%;">Mottling</th> </tr> <tr><td>0</td><td></td><td></td><td></td></tr> <tr><td>6</td><td></td><td></td><td></td></tr> <tr><td>10</td><td></td><td></td><td></td></tr> <tr><td>15</td><td></td><td></td><td></td></tr> <tr><td>20</td><td></td><td></td><td></td></tr> <tr><td>30</td><td></td><td></td><td></td></tr> <tr><td>40</td><td></td><td></td><td></td></tr> <tr><td>50</td><td></td><td></td><td></td></tr> </table> <p style="text-align: center;">BEDROCK</p> <table border="1" style="width:100%; border-collapse: collapse;"> <tr> <td style="width:15%;">Soil Classification</td> <td style="width:15%;">Slope</td> <td style="width:15%;">Limiting Factor</td> <td style="width:15%;"><input type="checkbox"/> Ground Water</td> </tr> <tr> <td>Profile _____ Condition _____</td> <td>_____ %</td> <td><u>34</u></td> <td><input type="checkbox"/> Restrictive Layer</td> </tr> <tr> <td></td> <td></td> <td></td> <td><input checked="" type="checkbox"/> Bedrock</td> </tr> </table>	Texture	Consistency	Color	Mottling	0				6				10				15				20				30				40				50				Soil Classification	Slope	Limiting Factor	<input type="checkbox"/> Ground Water	Profile _____ Condition _____	_____ %	<u>34</u>	<input type="checkbox"/> Restrictive Layer				<input checked="" type="checkbox"/> Bedrock
Texture	Consistency	Color	Mottling																																																																																														
0																																																																																																	
6																																																																																																	
10																																																																																																	
15																																																																																																	
20																																																																																																	
30																																																																																																	
40																																																																																																	
50																																																																																																	
Soil Classification	Slope	Limiting Factor	<input type="checkbox"/> Ground Water																																																																																														
Profile _____ Condition _____	_____ %	<u>33</u>	<input type="checkbox"/> Restrictive Layer																																																																																														
			<input checked="" type="checkbox"/> Bedrock																																																																																														
Texture	Consistency	Color	Mottling																																																																																														
0																																																																																																	
6																																																																																																	
10																																																																																																	
15																																																																																																	
20																																																																																																	
30																																																																																																	
40																																																																																																	
50																																																																																																	
Soil Classification	Slope	Limiting Factor	<input type="checkbox"/> Ground Water																																																																																														
Profile _____ Condition _____	_____ %	<u>34</u>	<input type="checkbox"/> Restrictive Layer																																																																																														
			<input checked="" type="checkbox"/> Bedrock																																																																																														

SOIL DESCRIPTION AND CLASSIFICATION																																																																																																	
Observation Hole <u>TB 5</u> <input type="checkbox"/> Test Pit <input checked="" type="checkbox"/> Boring _____ " Depth of Organic Horizon Above Mineral Soil	Observation Hole <u>TB 6</u> <input type="checkbox"/> Test Pit <input checked="" type="checkbox"/> Boring _____ " Depth of Organic Horizon Above Mineral Soil																																																																																																
<table border="1" style="width:100%; border-collapse: collapse;"> <tr> <th style="width:10%;">Texture</th> <th style="width:10%;">Consistency</th> <th style="width:10%;">Color</th> <th style="width:10%;">Mottling</th> </tr> <tr><td>0</td><td></td><td></td><td></td></tr> <tr><td>6</td><td></td><td></td><td></td></tr> <tr><td>10</td><td></td><td></td><td></td></tr> <tr><td>15</td><td></td><td></td><td></td></tr> <tr><td>20</td><td></td><td></td><td></td></tr> <tr><td>30</td><td></td><td></td><td></td></tr> <tr><td>40</td><td></td><td></td><td></td></tr> <tr><td>50</td><td></td><td></td><td></td></tr> </table> <p style="text-align: center;">BEDROCK</p> <table border="1" style="width:100%; border-collapse: collapse;"> <tr> <td style="width:15%;">Soil Classification</td> <td style="width:15%;">Slope</td> <td style="width:15%;">Limiting Factor</td> <td style="width:15%;"><input type="checkbox"/> Ground Water</td> </tr> <tr> <td>Profile _____ Condition _____</td> <td>_____ %</td> <td><u>32</u></td> <td><input type="checkbox"/> Restrictive Layer</td> </tr> <tr> <td></td> <td></td> <td></td> <td><input checked="" type="checkbox"/> Bedrock</td> </tr> </table>	Texture	Consistency	Color	Mottling	0				6				10				15				20				30				40				50				Soil Classification	Slope	Limiting Factor	<input type="checkbox"/> Ground Water	Profile _____ Condition _____	_____ %	<u>32</u>	<input type="checkbox"/> Restrictive Layer				<input checked="" type="checkbox"/> Bedrock	<table border="1" style="width:100%; border-collapse: collapse;"> <tr> <th style="width:10%;">Texture</th> <th style="width:10%;">Consistency</th> <th style="width:10%;">Color</th> <th style="width:10%;">Mottling</th> </tr> <tr><td>0</td><td></td><td></td><td></td></tr> <tr><td>6</td><td></td><td></td><td></td></tr> <tr><td>10</td><td></td><td></td><td></td></tr> <tr><td>15</td><td></td><td></td><td></td></tr> <tr><td>20</td><td></td><td></td><td></td></tr> <tr><td>30</td><td></td><td></td><td></td></tr> <tr><td>40</td><td></td><td></td><td></td></tr> <tr><td>50</td><td></td><td></td><td></td></tr> </table> <p style="text-align: center;">BEDROCK</p> <table border="1" style="width:100%; border-collapse: collapse;"> <tr> <td style="width:15%;">Soil Classification</td> <td style="width:15%;">Slope</td> <td style="width:15%;">Limiting Factor</td> <td style="width:15%;"><input type="checkbox"/> Ground Water</td> </tr> <tr> <td>Profile _____ Condition _____</td> <td>_____ %</td> <td><u>30</u></td> <td><input type="checkbox"/> Restrictive Layer</td> </tr> <tr> <td></td> <td></td> <td></td> <td><input checked="" type="checkbox"/> Bedrock</td> </tr> </table>	Texture	Consistency	Color	Mottling	0				6				10				15				20				30				40				50				Soil Classification	Slope	Limiting Factor	<input type="checkbox"/> Ground Water	Profile _____ Condition _____	_____ %	<u>30</u>	<input type="checkbox"/> Restrictive Layer				<input checked="" type="checkbox"/> Bedrock
Texture	Consistency	Color	Mottling																																																																																														
0																																																																																																	
6																																																																																																	
10																																																																																																	
15																																																																																																	
20																																																																																																	
30																																																																																																	
40																																																																																																	
50																																																																																																	
Soil Classification	Slope	Limiting Factor	<input type="checkbox"/> Ground Water																																																																																														
Profile _____ Condition _____	_____ %	<u>32</u>	<input type="checkbox"/> Restrictive Layer																																																																																														
			<input checked="" type="checkbox"/> Bedrock																																																																																														
Texture	Consistency	Color	Mottling																																																																																														
0																																																																																																	
6																																																																																																	
10																																																																																																	
15																																																																																																	
20																																																																																																	
30																																																																																																	
40																																																																																																	
50																																																																																																	
Soil Classification	Slope	Limiting Factor	<input type="checkbox"/> Ground Water																																																																																														
Profile _____ Condition _____	_____ %	<u>30</u>	<input type="checkbox"/> Restrictive Layer																																																																																														
			<input checked="" type="checkbox"/> Bedrock																																																																																														

Albert Frick
 Site Evaluator

163
 SE#

1/12/95
 Date

SUBSURFACE WASTEWATER DISPOSAL SYSTEM APPLICATION

Department of Human Services
Division of Health Engineering

Town, City, Plantation

Street, Road, Subdivision

Owners Name

PORTLAND (PEAKS ISLAND)

ISLAND AVENUE

N/F CANTWELL (MIKE LANGELLA)

SUBSURFACE WASTEWATER DISPOSAL PLAN

Scale 1" = 20' ± Ft.

APPROX. PROPOSED DWELLING SITE

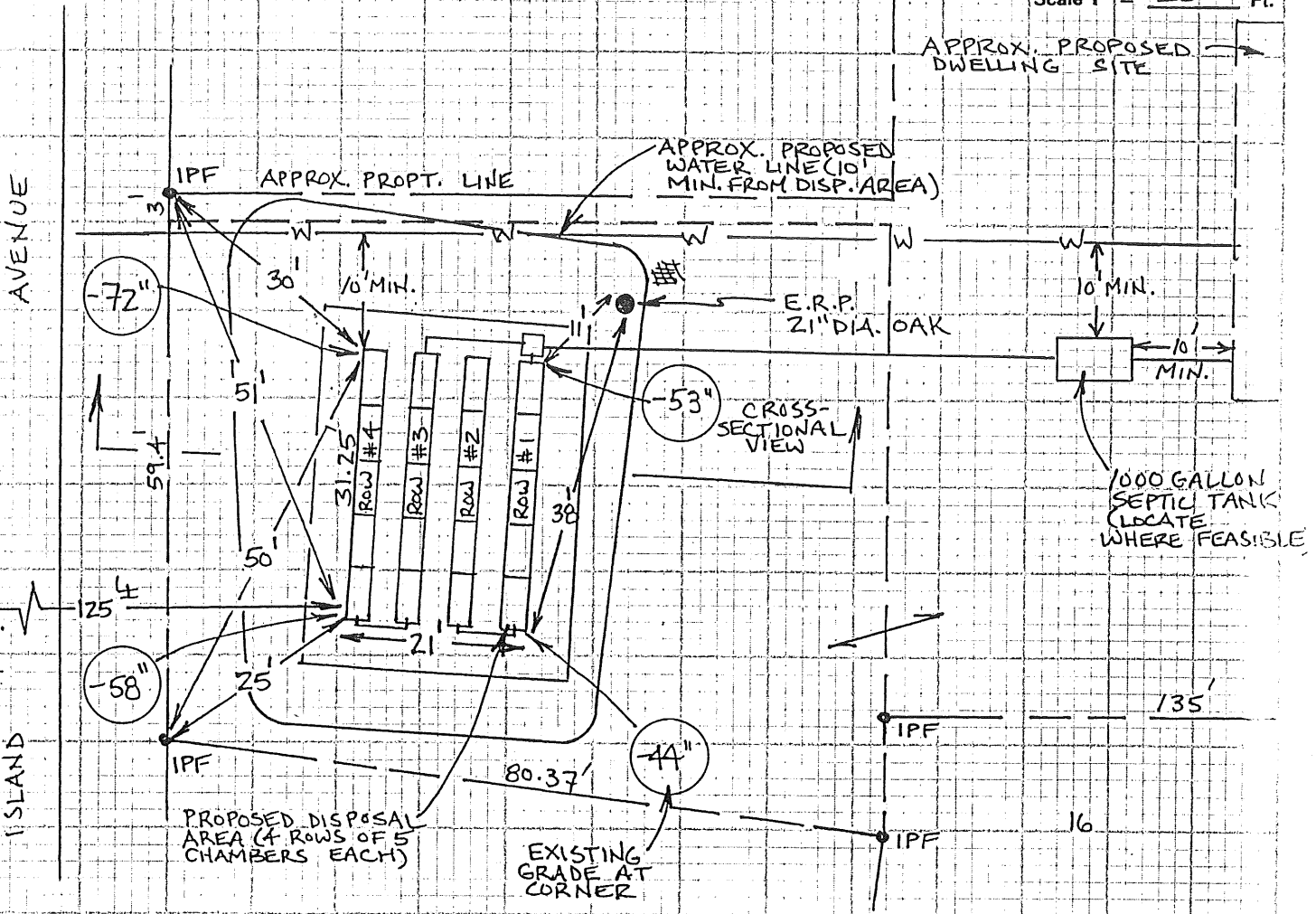

FILL REQUIREMENTS

Depth of Fill (Upslope)	24"-29"
Depth of Fill (Downslope)	19"-33"

CONSTRUCTION ELEVATIONS

Reference Elevation is	00
Bottom of Disposal Area	SEE DETAIL BELOW
Top of Distribution Lines or Chambers	SEE DETAIL BELOW

ELEVATION REFERENCE POINT LOCATION & DESCRIPTION
NAIL IN 21" DIA. FLAGGED OAK, 13" ABOVE BASE OF TREE.

DISPOSAL AREA CROSS SECTION

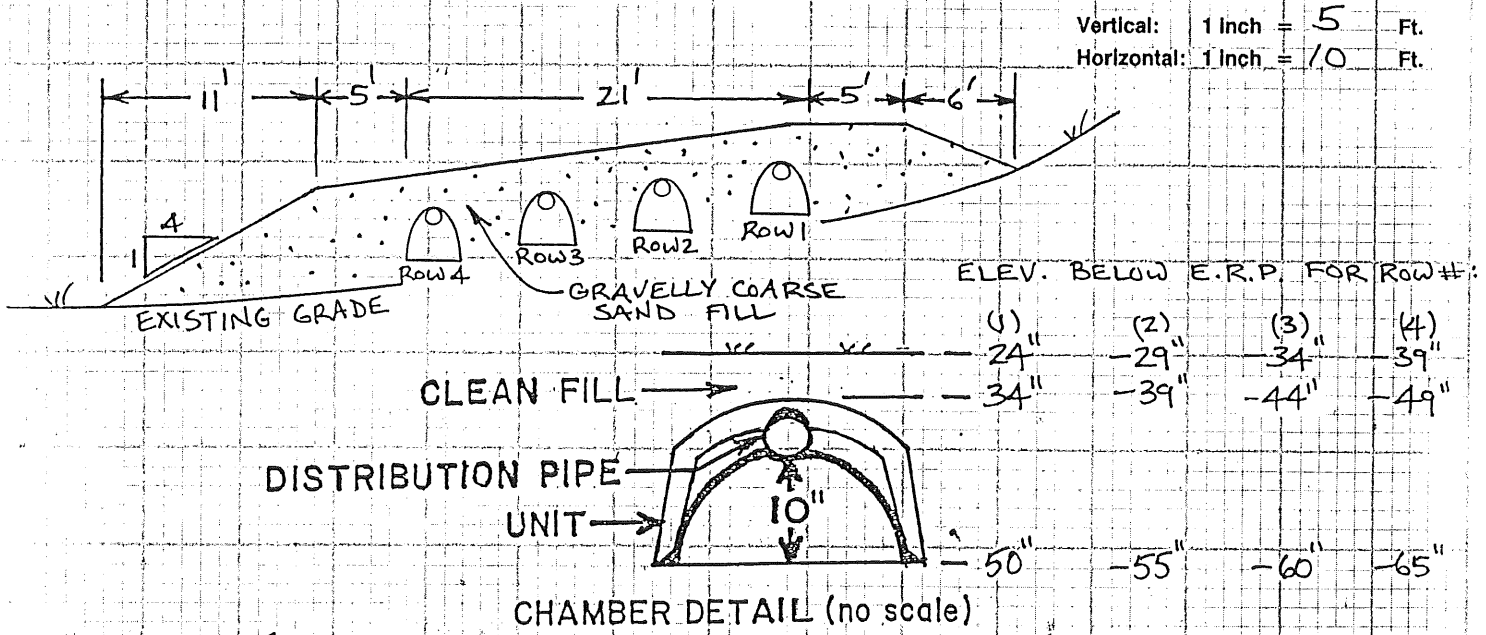

Albert Feick
Site Evaluator Signature

163
SE#

11/2/95
Date



Albert Frick Associates, Inc.

Soil Scientists & Site Evaluators

95A County Road Corham, Maine 04038
(207) 839-5563 FAX (207) 839-5564

Albert Frick SS, SE
James Logan SS, SE
Matthew Logan SE

PORTLAND (PEAKS ISLAND) ISLAND AVE. MIKE LANGELLA
TOWN LOCATION APPLICANT'S NAME

1) The Plumbing and Subsurface Wastewater Disposal Rules adopted by the State of Maine, Department of Human Services pursuant to 22 M.R.S.A. § 42 (the "Rules") are incorporated herein by reference and made a part of this application and shall be consulted by the owner/applicant, the system installer and/or building contractor for further construction details and material specifications. The system installer should contact **Albert Frick Associates, Inc.** 839-5563, if there are any questions concerning materials, procedures or designs. The system installer and/or building contractor installing the system shall be solely responsible for compliance with the Rules and with all state and municipal laws and ordinances pertaining to the permitting, inspection and construction of subsurface wastewater disposal systems.

2) This application is intended to represent facts pertinent to the Rules only. It shall be the responsibility of the owner/applicant, system installer and/or building contractor to determine compliance with and to obtain permits under all applicable local, state and/or federal laws and regulations (including, without limitation, Natural Resources Protection Act, wetland regulations, zoning ordinances, subdivision regulations, Site Location of Development Act and minimum lot size laws) before installing this system or considering the property on which the system is to be installed a "buildable" lot. It is recommended that a wetland scientist be consulted regarding wetland regulations.

Prior to the commencement of construction/installation, the local plumbing inspector shall inform the owner/applicant and Albert Frick Associates, Inc. of any local ordinances which are more restrictive than the Rules in order that the design may be amended. All designs are subject to review by local, state and/or federal authorities. Albert Frick Associates, Inc.'s liability shall be limited to revisions required by regulatory agencies pursuant to laws or regulations in effect at the time of preparation of this application.

3) All information shown on this application relating to property lines, well locations, subsurface structures and underground facilities (such as, utility lines, drains, septic systems, water lines, etc.) are based solely upon information provided by the owner/applicant and has been relied upon by Albert Frick Associates, Inc. in preparing this application. The owner/applicant shall review this application prior to the start of construction and confirm this information.

4) Installation of a garbage (grinder) disposal is not recommended. If one is installed, an additional 1000 gallon septic tank should be connected in series to the proposed septic tank.

5) The system user shall avoid introducing kitchen grease or fats into this system. Chemicals such as septic tank cleaners and/or chlorine (such as from water treatment) and controlled or hazardous substances shall not be disposed of in this system.

ATTACHMENT TO SUBSURFACE WASTEWATER DISPOSAL APPLICATION

PORTLAND (PEAKS ISLAND) TOWN ISLAND AVE. LOCATION MIKE LANGELLA APPLICANT'S NAME

- 6) The septic tank should be pumped within two years of installation and subsequently as recommended by the pump service, but in no event should the septic tank be pumped less often than once every three years.
- 7) The actual water flow or number of bedrooms shall not exceed the design criteria indicated on this application without a re-evaluation of the system as proposed. If the system is supplied by public water or a private service with a water meter, the water consumption per period should be divided by the number of days to calculate the average daily water consumption (water usage (cu.ft.) x 7.48 cu.ft.(gallons per cu.ft.) ÷ # of days in period).
- 8) The general minimum setbacks between a well and septic system serving a single family residence is 100-300 feet, unless the local municipality has a more stringent requirement. A well installed by an abutter within the minimum setback distances prior to the issuance of a permit for the proposed disposal system may void this design.
- 9) When a gravity system is proposed: **BEFORE CONSTRUCTION/INSTALLATION BEGINS**, the system installer or building contractor shall review the elevations of all points given in this application and the elevation of the existing and/or proposed building drain and septic tank inverts for compatibility to minimum slope requirements. In gravity systems, the invert of the septic tank(s) outlet(s) shall be at least 4 inches above the invert of the distribution box outlet at the disposal area. When an effluent pump is required, provisions shall be made to make certain that surface ground water does not enter the septic tank or pump station. An alarm device warning of a pump failure shall be installed. Also, when pumping is required to a chamber system, install a "T" connection in the distribution box and place 3 inches of stone or a splash plate in the first chamber. Insulate gravity pipes, pump lines and the distribution box as necessary to prevent freezing.
- 10) On all systems, remove the vegetation, organic duff and old fill material from under the disposal area and any fill extension. On sites where the proposed system is to be installed in natural soil, scarify the bottom and sides of the excavated disposal area with a rake. Do not use wheeled equipment on the scarified soil surface. For systems installed in fill, scarify the native soil by roto-tilling to a depth of at least 8 inches over the entire disposal and fill extension area to prevent glazing and to promote fill bonding. Place fill in loose layers no deeper than 8 inches and compact thoroughly before placing more fill (this ensures that voids and loose pockets are eliminated to minimize the chance of leakage). Do not use wheeled equipment on the scarified soil area until after 12 inches of fill is in place. Keep equipment off the chambers. Divert the surface water away from the disposal area by ditching or shallow swales.
- 11) Unless noted otherwise, fill shall be gravelly coarse sand which contains no more than 5% fines (silt and clay).
- 12) Do not install systems on loamy, silty, or clayey soils during wet periods since soil smearing/glazing may seal off the soil interface.
- 13) Seed all filled and disturbed surfaces with perennial grass seed, then mulch with hay or equivalent material to prevent erosion.



PLUMBING APPLICATION

092-E-017

Department of Human Sciences
Division of Health Engineering

PROPERTY ADDRESS

Town or Plantation	Portland Maine
Street Subdivision Lot #	617 Lakabd Ave Peaks

PROPERTY OWNERS NAME

Last: Langella First: Mike

Applicant Name: Marty Laberge

Mailing Address of Owner/Applicant (If Different) 71 BrahidKnight Rd Windham ME 04062

PORTLAND Date Permit Issued: 12-2-99 6943 TOWN COPY \$ 1641 FEE Double Fee Charged L.P.I. # 0124

[Signature]
Local Plumbing Inspector Signature

Owner/Applicant Statement

I certify that the information submitted is correct to the best of my knowledge and understand that any falsification is reason for the Local Plumbing Inspectors to deny a Permit.

Signature of Owner/Applicant _____ Date _____

Caution: Inspection Required

I have inspected the installation authorized above and found it to be in compliance with the Maine Plumbing Rules.

[Signature]
Local Plumbing Inspector Signature

Date Approved 1-4-00

PERMIT INFORMATION

This Application is for	Type of Structure To Be Served:	Plumbing To Be Installed By:
1. <input checked="" type="checkbox"/> NEW PLUMBING 2. <input type="checkbox"/> RELOCATED PLUMBING	1. <input checked="" type="checkbox"/> SINGLE FAMILY DWELLING 2. <input type="checkbox"/> MODULAR OR MOBILE HOME 3. <input type="checkbox"/> MULTIPLE FAMILY DWELLING 4. <input type="checkbox"/> OTHER - SPECIFY _____	1. <input type="checkbox"/> MASTER PLUMBER 2. <input type="checkbox"/> OIL BURNERMAN 3. <input type="checkbox"/> MFG'D. HOUSING DEALER/MECHANIC 4. <input type="checkbox"/> PUBLIC UTILITY EMPLOYEE 5. <input type="checkbox"/> PROPERTY OWNER LICENSE # <u>057993</u>

Hook-Up & Piping Relocation Maximum of 1 Hook-Up	Column 2		Column 1	
	Number	Type of Fixture	Number	Type of Fixture
HOOK-UP: to public sewer in those cases where the connection is not regulated and inspected by the local Sanitary District. OR HOOK-UP: to an existing subsurface wastewater disposal system.	1	Hosebibb / Sillcock	1	Bathtub (and Shower)
		Floor Drain	1	Shower (Separate)
PIPING RELOCATION: of sanitary lines, drains, and piping without new fixtures.		Urinal	1	Sink
		Drinking Fountain	2	Wash Basin
OR TRANSFER FEE [\$6.00]		Indirect Waste	2	Water Closet (Toilet)
		Water Treatment Softener, Filter, etc.	1	Clothes Washer
		Grease / Oil Separator	1	Dish Washer
		Dental Cuspidor		Garbage Disposal
		Bidet		Laundry Tub
		Other: _____	1	Water Heater
		Fixtures (Subtotal) Column 2	10	Fixtures (Subtotal) Column 1
			1	Fixtures (Subtotal) Column 2
			11	Total Fixtures
				Fixture Fee
				Transfer Fee
				Hook-Up & Relocation Fee
			44.00	Permit Fee (Total)

SEE PERMIT FEE SCHEDULE FOR CALCULATING FEE

92-E-17