

P:\Projects\26-Custom Float Services\peaks.dwg, 3/27/2006 12:46:56 PM, HP Design\let 500 42+HPGL2 Card

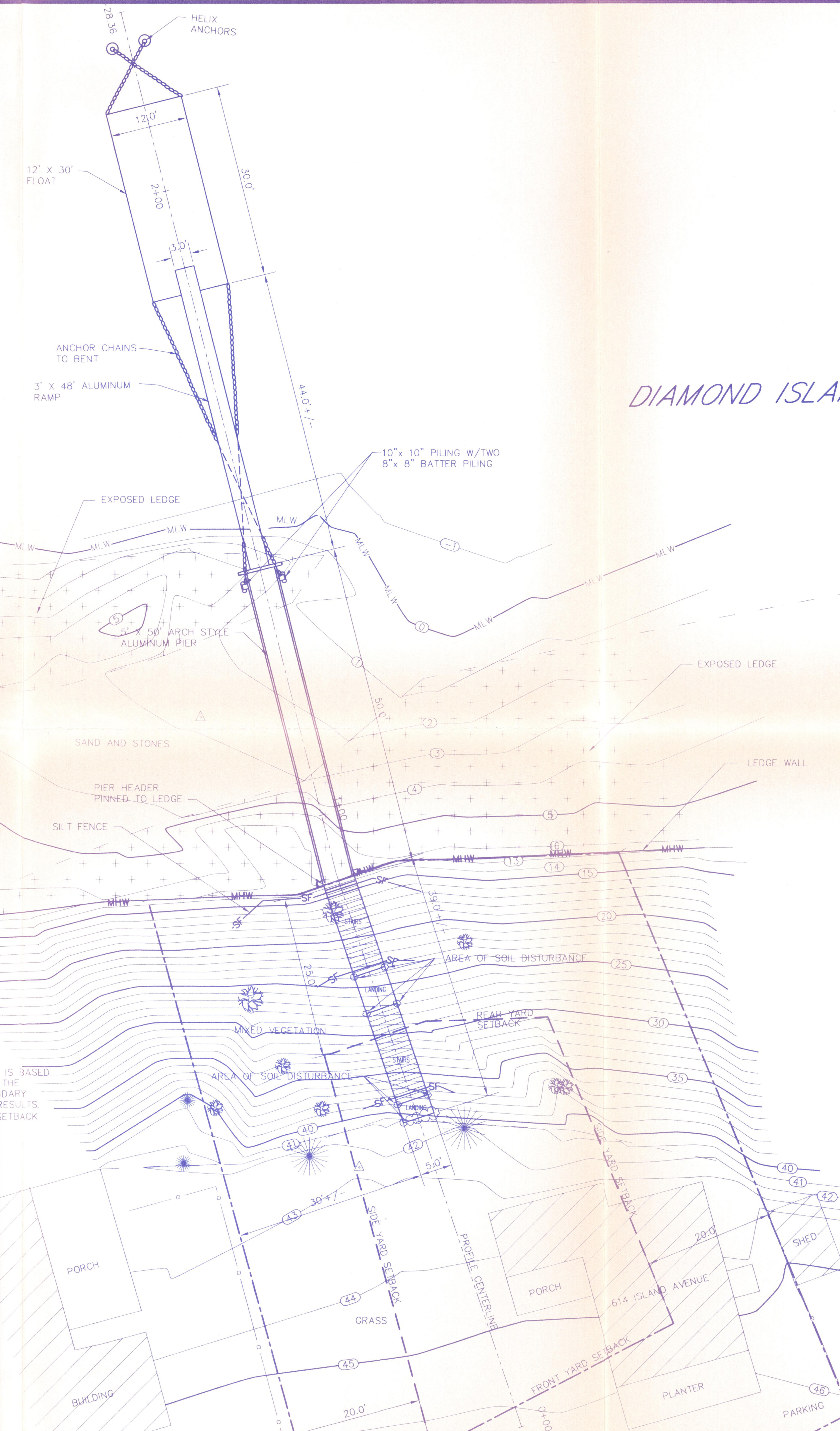
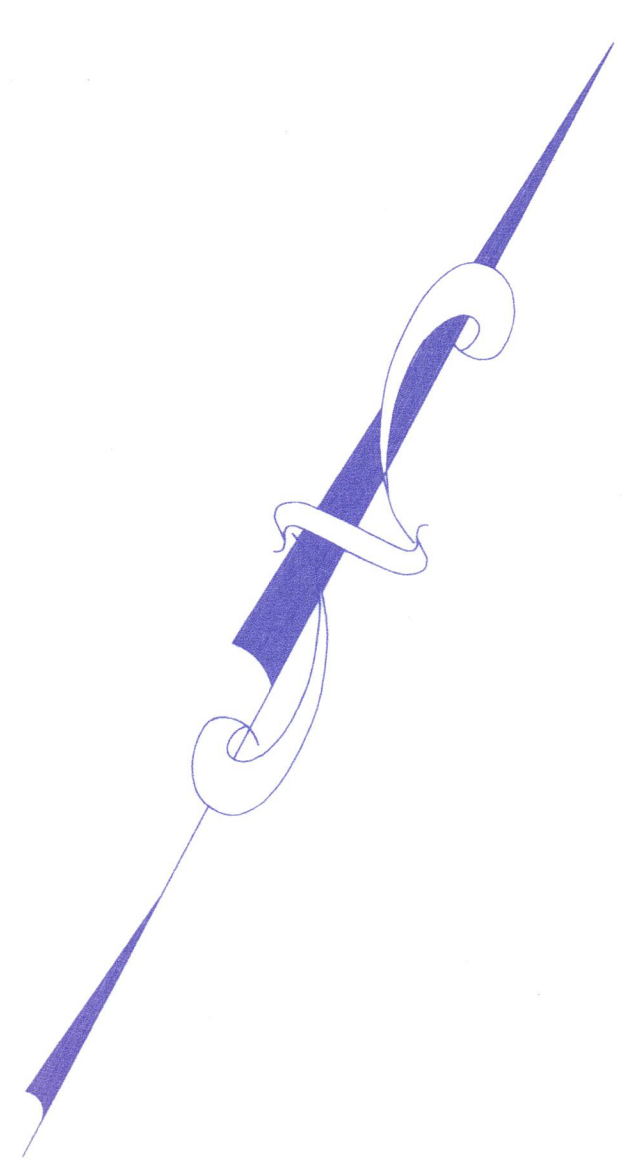

DIAMOND ISLAND PASS

-LEGEND-

- EXPOSED LEDGE AREA
- MEAN LOW WATER LINE
- MEAN HIGH WATER LINE
- APPROXIMATE PROPERTY LINE
- 4' WOOD FENCE
- CONTOUR
- SURVEY CONTROL POINT
- HYDRANT
- TREES

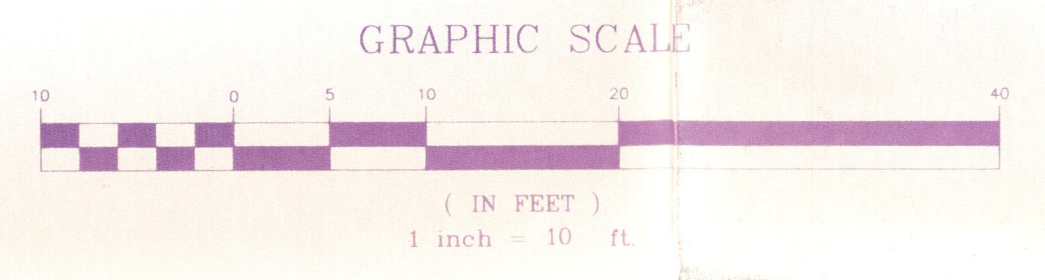

NOTES

1. ELEVATIONS ARE BASED ON MEAN LOW WATER DATUM. DATUM ESTABLISHED BY MEASURING THE WATER LEVEL AT TIME OF LOW WATER AND ADJUSTING FOR DAILY DEVIATION.
2. THIS PLAN DOES NOT REPRESENT A BOUNDARY SURVEY. BOUNDARY INFORMATION COMPILED FROM FIELD MEASUREMENTS AND MORTGAGE SURVEY BY LIVINGSTON-HUGHES PROFESSIONAL LAND SURVEYORS 88 GUINEE ROAD KENNEBUNK, MAINE 04046, JOB NUMBER 522-69, DATED 7/13/2005.
3. LANDING & STAIRS BY OTHERS. GRAPHIC REPRESENTATION ONLY. LANDING SIZE AND NUMBER OF STAIRS TO BE DETERMINED BY BUILDER.
4. EXISTING SOIL CONDITIONS; CUMBERLAND COUNTY SOL SURVEY LISTS SOIL AS (H1B) HINKLEY GRAVELY SANDY LOAM, HYDROLOGIC GROUP "A" WELL DRAINED SOIL.
5. DRAWING FOR PERMITTING PURPOSES ONLY, NOT FOR CONSTRUCTION.

SETBACK NOTES:
 1. REAR YARD SETBACK SHOWN IS BASED ON MEAN HIGH WATER LINE AS THE PROPERTY BOUNDARY. A BOUNDARY SURVEY MAY YIELD DIFFERENT RESULTS.
 2. POSSIBLE "GRANDFATERED" SETBACK RIGHTS ARE NOT SHOWN.

Revision
 CITY OF PORTLAND
 APPROVED SITE PLAN
 Subject to Dept. Conditions
 Date of Approval: 2-22-06

TIMOTHY NAPOLITANO 614 ISLAND AVE. PEAKS ISLAND, MAINE	
PIER INSTALLATION SITE PLAN	
SCALE 1"=10'	DATE 10/21/05
DESIGNED BY JDL	DRAWING NO. 2

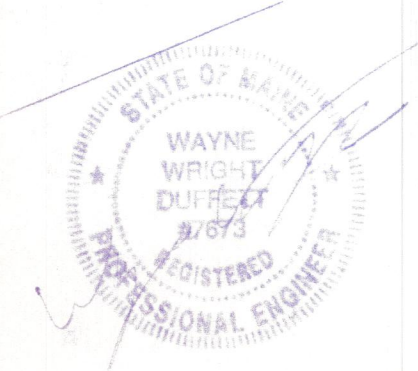

REV. 3/17/06 SOIL DISTURBANCE AREA
 REV. 3/06 ROTATION OF PIER

Handwritten notes:
 SR
 CH
 T
 10/21/05

P:\Projects\26-Custom Float Services\peaks\dwg\peaks-is.dwg, 3/17/2006 1:39:14 PM, HP DesignJet 500 42+HPGL2 Card

DIAMOND ISLAND PASS

-LEGEND-

- EXPOSED LEDGE AREA
- MEAN LOW WATER LINE
- MEAN HIGH WATER LINE
- APPROXIMATE PROPERTY LINE
- 4' WOOD FENCE
- CONTOUR
- SURVEY CONTROL POINT
- HYDRANT
- TREES

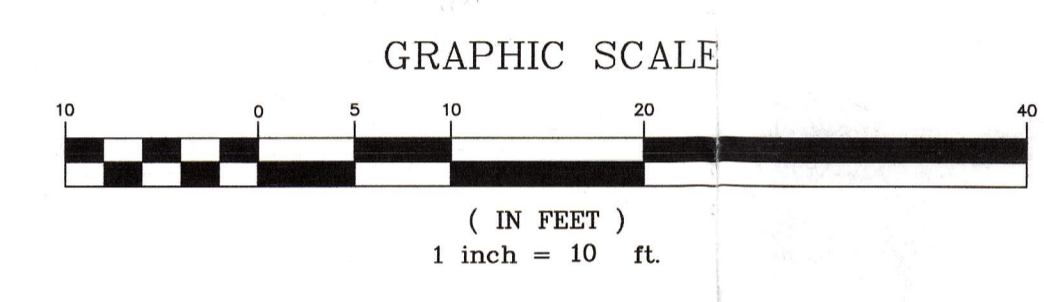

NOTES

1. ELEVATIONS ARE BASED ON MEAN LOW WATER DATUM. DATUM ESTABLISHED BY MEASURING THE WATER LEVEL AT TIME OF LOW WATER AND ADJUSTING FOR DAILY DEVIATION.
2. THIS PLAN DOES NOT REPRESENT A BOUNDARY SURVEY. BOUNDARY INFORMATION COMPILED FROM FIELD MEASUREMENTS AND MORTGAGE SURVEY BY LIVINGSTON-HUGHES PROFESSIONAL LAND SURVEYORS 88 GUINEE ROAD KENNEBUNK, MAINE 04046. JOB NUMBER 522-69, DATED 7/13/2005.
3. LANDING & STAIRS BY OTHERS. GRAPHIC REPRESENTATION ONLY. LANDING SIZE AND NUMBER OF STAIRS TO BE DETERMINED BY BUILDER.
4. EXISTING SOIL CONDITIONS; CUMBERLAND COUNTY SOIL SURVEY LISTS SOIL AS (H1B) HINKLEY GRAVELY SANDY LOAM, HYDROLOGIC GROUP "A" WELL DRAINED SOIL.
5. DRAWING FOR PERMITTING PURPOSES ONLY, NOT FOR CONSTRUCTION.

SETBACK NOTES:
 1. REAR YARD SETBACK SHOWN IS BASED ON MEAN HIGH WATER LINE AS THE PROPERTY BOUNDARY. A BOUNDARY SURVEY MAY YIELD DIFFERENT RESULTS.
 2. POSSIBLE "GRANDFATHERED" SETBACK RIGHTS ARE NOT SHOWN.

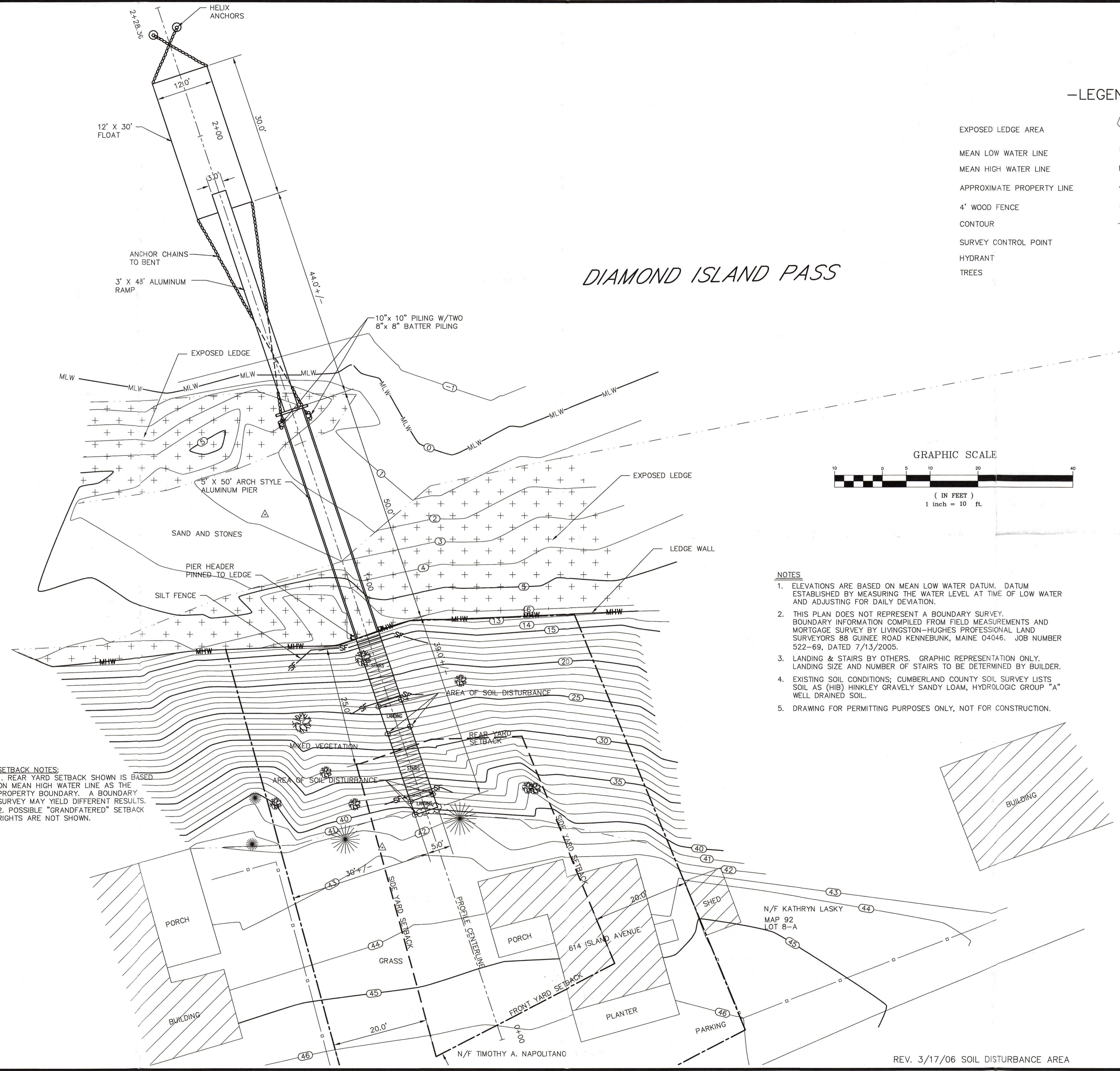

CITY OF PORTLAND
 APPROVED SITE PLAN
 Subject to Dept. Conditions
 Date of Approval: 3-22-06
JR

TIMOTHY NAPOLITANO 614 ISLAND AVE. PEAKS ISLAND, MAINE	
PIER INSTALLATION SITE PLAN	
TEC ASSOCIATES CONSULTING ENGINEERS 46 SAWYER STREET SOUTH PORTLAND, MAINE 04106	
SCALE 1"=10'	DATE 10/21/05
JOB NUMBER 0526-1	DESIGNED BY JDL
DRAWN BY JDL	DRAWING NO. 2

REV. 3/17/06 SOIL DISTURBANCE AREA

OK Timothy Napolitano