

SUBMITTAL DATA: MXZ-8C48NAHZ
4-TON MULTI-INDOOR INVERTER HEAT-PUMP SYSTEM

 Job Name: *Hoggin Energy for = 606 Island Avenue*

System Reference:

 Date: *9-10-15*
GENERAL FEATURES

- Quiet operation
- Built-in base pan heater to prevent ice in drain pan
- Limited warranty: five years parts and seven years compressors

ACCESSORIES

- Three-port Branch Box (PAC-MKA30BC)
- Five-port Branch Box (PAC-MKA50BC)
- Distribution Pipe for Flare Connection (MSDD-50AR; necessary for installing two branch boxes)
- Distribution Pipe for Braze Connection (MSDD-50BR; necessary for installing two branch boxes)
- 3/8" x 1/2" Port Adapter (MAC-A454JP)
- 1/2" x 3/8" Port Adapter (MAC-A455JP)
- 1/2" x 5/8" Port Adapter (MAC-A456JP)
- 1/4" x 3/8" Port Adapter (PAC-493PI)
- 3/8" x 5/8" Port Adapter (PAC-SG76RJ)
- Drain Socket (PAC-SH71DS-E)
- Airflow Guide (PAC-SH96SG-E)

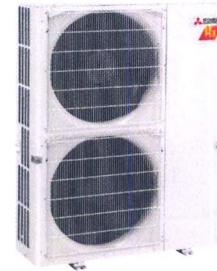

Outdoor Unit: MXZ-8C48NAHZ

INVERTER

(For data on specific indoor units, see the MXZ-C Technical and Service Manual.)

| Specifications | | | Model Name |
|---|-------------------------------|-----------------------|--|
| Unit Type | | | MXZ-8C48NAHZ |
| Cooling* (Non-ducted / Ducted) | Rated Capacity | Btu/h | 48,000 / 48,000 |
| | Capacity Range | Btu/h | 6,000 - 48,000 |
| | Rated Total Input | W | 4,000 / 5,050 |
| Heating at 47°F* (Non-ducted / Ducted) | Rated Capacity | Btu/h | 54,000 / 54,000 |
| | Capacity Range | Btu/h | 7,200 - 54,000 |
| | Rated Total Input | W | 4,220 / 4,990 |
| Heating at 17°F* (Non-ducted/Ducted) | Rated Capacity | Btu/h | 40,000 / 43,000 |
| | Maximum Capacity | Btu/h | 54,000 / 54,000 |
| | Rated Total Input | W | 4,340 / 5,250 |
| Heating at 5°F* | Maximum Capacity | Btu/h | 54,000 |
| Electrical Requirements | Power Supply | Voltage, Phase, Hertz | 208 / 230V, 1-Phase, 60 Hz |
| | Recommended Fuse/Breaker Size | A | 50 |
| | MCA | A | 42 |
| Voltage | Indoor - Outdoor S1-S2 | V | AC 208 / 230 |
| | Indoor - Outdoor S2-S3 | V | DC ±24 |
| Compressor | | | Hermetic |
| Fan Motor (ECM) | | F.L.A. | 0.4+0.4 |
| Sound Pressure Level | Cooling | dB(A) | 51 |
| | Heating | | 54 |
| External Dimensions (H x W x D) | | In / mm | 52-11/16 x 41-11/32 x 13+1 1338 x 1050 x 330+25 |
| Net Weight | | Lbs / kg | 276 / 125 |
| External Finish | | | Munsell No. 3Y 7.8/11 |
| Refrigerant Pipe Size O.D. — Eight Ports | Liquid (High Pressure) | In / mm | 3/8 / 9.52 |
| | Gas (Low Pressure) | | 5/8 / 15.88 |
| Max. Refrigerant Line Length | | Ft / m | 492 (150) |
| Max. Piping Length for Each Indoor Unit | | Ft / m | 262 (80) |
| Max. Refrigerant Pipe Height Difference | If IDU is Above ODU | Ft / m | 131 (40) |
| | If IDU is Below ODU | | 164 (50) |
| Connection Method | | | Flared/Flared |
| Refrigerant | | | R410A |

* Rating Conditions per AHRI Standard:

 Cooling | Indoor: 80° F (27° C) DB / 67° F (19° C) WB
 Cooling | Outdoor: 95° F (35° C) DB / 75° F (24° C) WB

 Heating at 47° F | Indoor: 70° F (21° C) DB
 Heating at 47° F | Outdoor: 47° F (8° C) DB / 43° F (6° C) WB

 Heating at 17° F | Indoor: 70° F (21° C) DB
 Heating at 17° F | Outdoor: 17° F (-8° C) DB / 15° F (-9° C) WB

Specifications are subject to change without notice.

© 2015 Mitsubishi Electric US, Inc.

*1. D.B. 5 to 115° F [D.B. -15 to 46° C],
when an optional Air Outlet Guide is installed.

| | | | | | |
|------------------------------|-------|-------|-------|------|------|
| Ducted and Non-ducted | 16.80 | 10.75 | 10.50 | 3.46 | 2.55 |
| Ducted | 14.7 | 9.5 | 10.0 | 3.17 | 2.40 |

Multi-zone Indoor/Outdoor Combination Table

| | MSZ-FH* | MSZ-GE* | MFZ* | MVZ* | SEZ-KD* | SLZ* | PCA (A24)* | PLA* | PEAD* |
|---------------------|----------------|----------------|-------------|-------------|----------------|-------------|-------------------|-------------|---------------|
| MXZ-8C48NAHZ | OK | OK | OK | OK | OK | OK | NO | OK | 24, 30, 36 OK |

* Refer to indoor unit submittal.

Notes:

- Minimum of two Indoor Units must be connected to the MXZ-8C48NAHZ.
 - Minimum installed capacity cannot be less than 12,000 Btu/h.
 - System can operate with only one Indoor Unit turned on.
 - May connect to any style indoor unit or combination.
 - Information provided at 208/230V.
- Refer to the MXZ-C Technical & Service Manual for detailed specifications and additional information per Indoor Unit Combination.

MVZ CONNECTION RULES:

- Up to 2 MVZ's may be connected to this system.
- When 2 MVZ's are connected, no additional indoor units can be used.
- When 1 MVZ is connected, additional indoor units can be connected.
- When 1 MVZ is connected, total connected capacity must be 130% or less.
- Connection limitations are altered with the use of the SPTB1 accessory. Refer to the SPTB1 documentation for more details.

Notes:

Job Name: *Hoggin Energy for 606 Island Avenue*
 System Reference: _____ Date: *9-10-15*

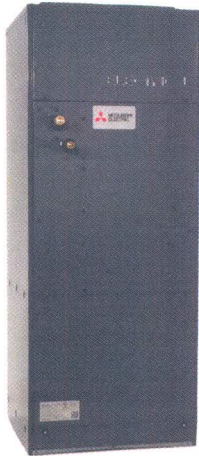

MVZ-A30AA4

GENERAL FEATURES:

- Multi-position air handling unit
- Multi-Position installation without any additional kits
- Quiet operation
- Selectable external static pressure settings with capabilities up to 0.80 In. W.G.
- Auto fan speed control: Low, Medium, High
- Indoor unit powered from outdoor unit using A-Control (Optional)
- Auto restart following a power outage
- Limited warranty: five years parts and seven years compressors

ACCESSORIES:

- Mini-Condensation Pump (SI30-115/230)
- Maxi Blue Diamond Condensate Pump 230V (X87-721)

SPECIFICATIONS:

| Rated Capacity* | | |
|------------------|-------|--------|
| Cooling | Btu/h | 30,000 |
| Heating at 47° F | Btu/h | 34,000 |

*Rating Conditions per AHRI Standard:
 Cooling | Indoor: 80° F (27° C) DB / 67° F (19° C) WB
 Cooling | Outdoor: 95° F (35° C) DB / 75° F (24° C) WB
 Heating at 47°F | Indoor: 70° F (21° C) DB / 60° F (16° C) WB
 Heating at 47°F | Outdoor: 47° F (8° C) DB / 43° F (6° C) WB

For data on specific indoor units (all ducted, all non-ducted, and both ducted and non-ducted) combinations, see the MXZ Technical and Service Manual

| | | |
|-------------------------------|----------------------------|--|
| Electrical Power Requirements | 208 / 230V, 1-Phase, 60 Hz | |
|-------------------------------|----------------------------|--|

| | | |
|--------------------------------|---|---|
| Minimum Circuit Ampacity (MCA) | A | 1 |
|--------------------------------|---|---|

| Voltage | | |
|------------------------|---------------|--|
| Indoor - Outdoor S1-S2 | AC 208 / 230V | |
| Indoor - Outdoor S2-S3 | +/- 24VDC | |

| | | |
|--------------------------|--------|--------------------|
| External Static Pressure | In. WG | 0.30 - 0.50 - 0.80 |
|--------------------------|--------|--------------------|

| | | |
|-----------------|------------------------------------|--|
| External Finish | High-gloss polyester powder coated | |
|-----------------|------------------------------------|--|

| | | |
|---------------------------------|---------|---|
| External Dimensions (H x W x D) | In.(mm) | 54-1/4 x 21 x 21-5/8 (1,378 x 534 x 548) |
|---------------------------------|---------|---|

| | | |
|------------|----------|----------|
| Net Weight | Lbs.(kg) | 141 (64) |
|------------|----------|----------|

| Sound Pressure Level (Low-Mid-Hi) | | |
|-----------------------------------|-------|--------------|
| Cooling | dB(A) | 32 - 36 - 40 |
| Heating | | 32 - 36 - 40 |

| Airflow Rate (Low-Mid-Hi) | | |
|---------------------------|-----|-----------------|
| Cooling (Dry) | CFM | 613 - 744 - 875 |
| Heating | | 613 - 744 - 875 |

| Refrigerant Piping | | |
|------------------------|---------|-------------|
| Liquid (High Pressure) | In.(mm) | 3/8 (9.52) |
| Gas (Low Pressure) | | 5/8 (15.88) |

| | | |
|-------------|-------|--|
| Refrigerant | R410A | |
|-------------|-------|--|

| | | |
|-------------------|--------|--|
| Connection Method | Flared | |
|-------------------|--------|--|

DIMENSIONS: MVZ-A30AA4

Unit: inch

| Model | A | B | C | D | E | F | G | H | J | ①Gas pipe | ②Liquid pipe |
|-----------|------|------------|----------|----------|----------|------------|-----------|-----------|-----------|-------------------|--------------|
| WZ-A12AA4 | 432 | 316 | 281 | 224 | 1275 | 880 | 823 | 735.5 | 360 | ①12.7 (1/2) | ②1/2 |
| WZ-A18AA4 | (17) | (14-13/16) | (11-1/8) | (8-7/8) | (50-1/4) | (26-13/16) | (32-7/16) | (29) | (14-3/16) | (1/2) | (1/2) |
| WZ-A24AA4 | 534 | 477 | 382.5 | 265.5 | 1378 | 737 | 653.5 | 792 | 461 | ①1.5, 98 (3/8) | ②1/2 |
| WZ-A30AA4 | (21) | (18-13/16) | (15-1/8) | (12-1/2) | (54-1/4) | (28-1/16) | (31-3/16) | (31-3/16) | (18-3/16) | (3/8) | (3/8) |

Unit:mm (in.)

| Model | ①Nominal Filter Size | Duct Connection |
|-----------|----------------------|-------------------|
| WZ-A12AA4 | 508x406, A25, 4 | 375x402 |
| WZ-A18AA4 | (2016x11) | (14-13/16)S-(7/8) |
| WZ-A24AA4 | 508x508x25, 4 | 477x402 |
| WZ-A30AA4 | (2020x11) | (18-13/16)S-(7/8) |

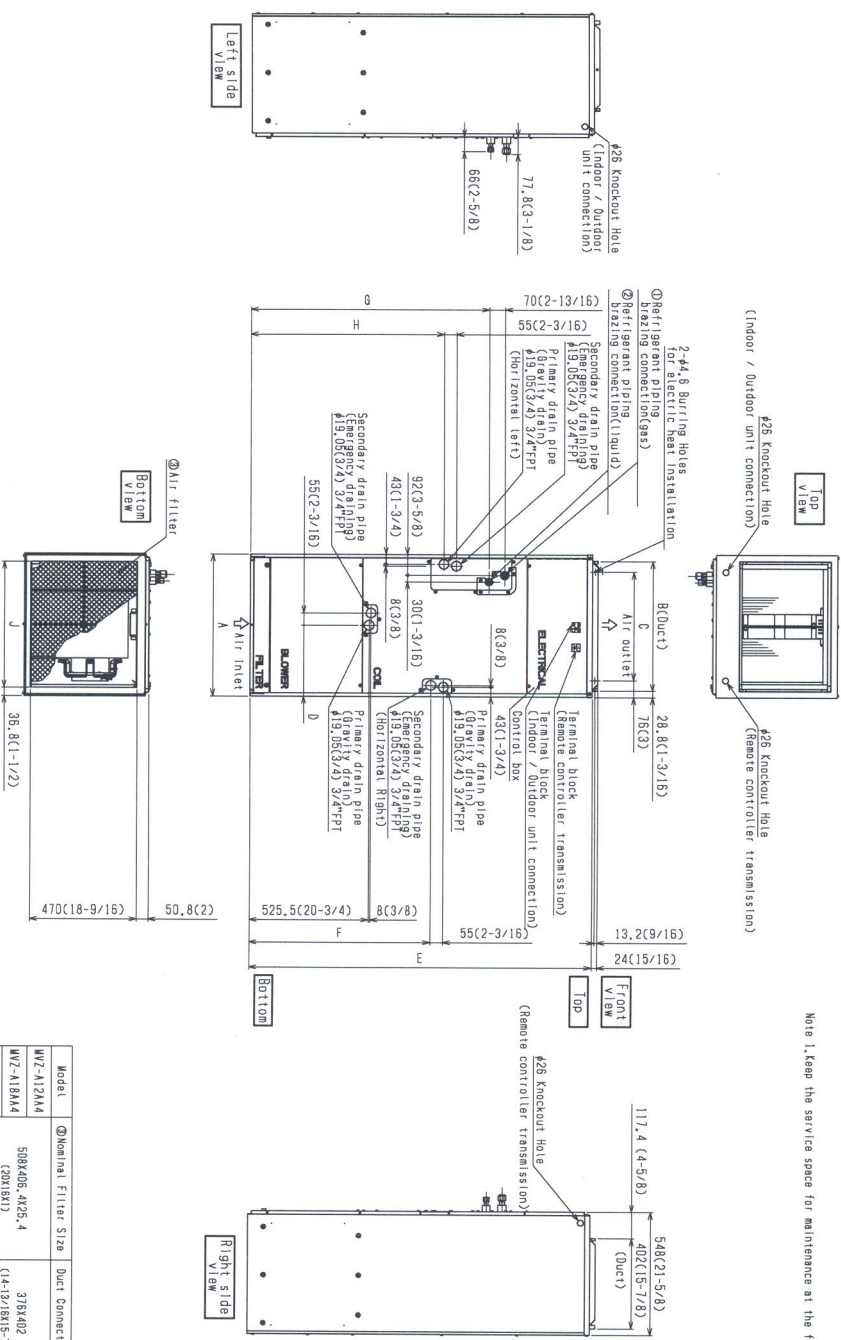

Note 1, keep the service space for maintenance at the front.



COOLING & HEATING
 1340 Satellite Boulevard, Suwanee, GA 30024
 Toll Free: 800-433-4822 www.mehvac.com



SUBMITTAL DATA: SEZ-KD18NA4 & SUZ-KA18NA**

18,000 BTU/H HORIZONTAL-DUCTED HEAT-PUMP SYSTEMS

| | | |
|---------------------------------------|--|----------------------|
| Job Name: <i>Hoggin Energy</i> | Location: <i>606 Island Ave</i> | Date: <i>9-10-15</i> |
| Purchaser: <i>Klepacki</i> | Engineer: <i>n/a</i> | |
| Submitted to: <i>City of Portland</i> | For <input type="checkbox"/> Reference <input type="checkbox"/> Approval <input type="checkbox"/> Construction | |
| System Designation: | Schedule No.: | |

****APPLIES TO INDOOR UNIT:**

- SEZ-KD18NA4
- SEZ-KD18NA4.TH
- SEZ-KD18NAR1.TH
- SEZ-KD18NA4R1.TH



Indoor Unit: SEZ-KD18NA4**



Outdoor Unit: SUZ-KA18NA

GENERAL FEATURES

- Horizontal-ducted indoor unit for concealed applications
- Ultra thin body: 7-7/8" high
- Built-in drain mechanism for condensate removal; lifts to 21-11/16"
- Air filter is included with indoor unit
- Quiet operation — as low as 23 dBA
- Indoor unit powered from outdoor unit using A-Control
- AUTO fan speed control
- Automatic restart following a power outage
- Limited warranty: five years parts and seven years compressors

ACCESSORIES
Indoor Unit

- Filter Box with MERV 8 Filters (FBL1-3)
- Bottom Return Plate (BRP-3)

Outdoor Unit

- Drain Socket (MAC-811DS)
- Drain Pan Heater (MAC-641BH-U)
- Three-pole Disconnect Switch (TAZ-MS303)
- Air Outlet Guide (MAC-856SG)
- Mounting Base (DSD-400N)
- Mounting Pad (ULTRILITE1)
- Wall-mounting Brackets (CWMB1)

Controller Options

- Wireless Wall-mounted Remote Controller Kit (MHK1)*
 - Portable Central Controller (MCCH1)*
 - Outdoor Air Sensor (MOS1)*
 - Wired Wall-mounted Controller (PAR-31MAA)*
 - Simple MA Remote Controller (PAC-YT53CRAU)*
- *See Submittal for information on each option.
- Remote Temperature Sensor (M21-JKO-307)
 - Hand-held Wireless Remote Controller (PAR-FL32MA; eq.PAR-FA32MA-E)
 - Wireless Signal Receiver Module PAR-FA32MA (for PAR-FL32MA)
 - Lockdown Bracket for Hand-held Controller (RCMKP1CB)

