

SUBSURFACE WASTEWATER DISPOSAL SYSTEM APPLICATION

Maine Department of Human Services
 Division of Health Engineering, Station 10 SHS
 (207) 287-5672 FAX (207) 287-4172

Town, City, Plantation

Street, Road, Subdivision

Owner's Name

PORTLAND, PEAKS ISLAND

37 MAGGI ROAD

BASIL & MARLEEN KLOSTERIDIS

SUBSURFACE WASTEWATER DISPOSAL PLAN

SCALE 1" = 20 FT.

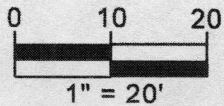
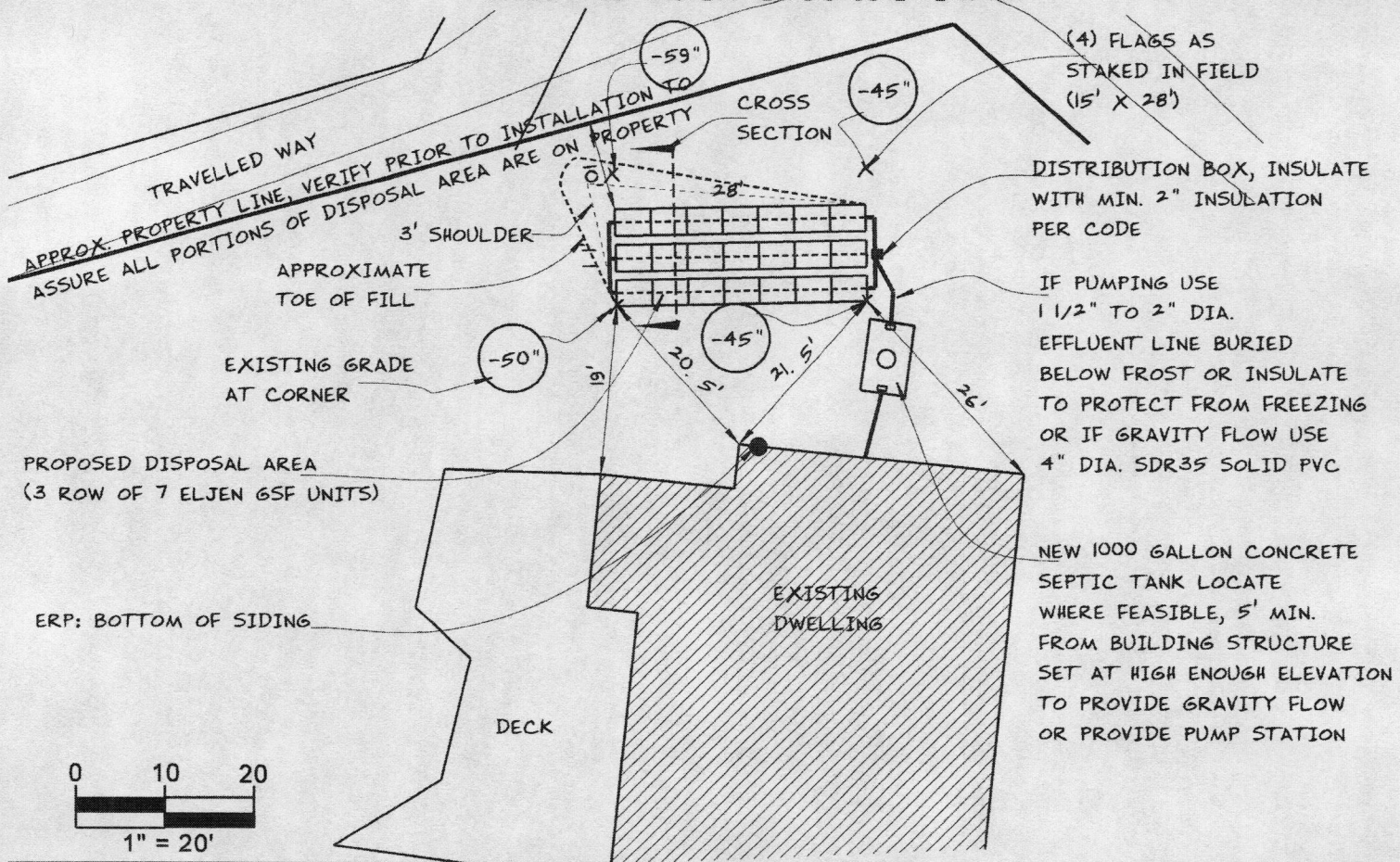

FILL REQUIREMENTS

Depth of Fill (Upslope) = 0"
 Depth of Fill (Downslope) = 0" - 9"
 DEPTHS AT CROSS-SECTION (shown below)

CONSTRUCTION ELEVATIONS

Finished Grade Elevation
 Top of Distribution Pipe or Proprietary Device
 Bottom of Disposal Area

SEE DETAIL BELOW
 ELEVATION REFERENCE POINT
 Location & Description
 BOTTOM OF SIDING
 40" ABOVE EXISTING GRADE
 Reference Elevation is: 0.0" or -----

DISPOSAL AREA CROSS SECTION

SCALE:
 VERTICAL: 1" = 5 FT
 HORIZONTAL: 1" = 5 FT

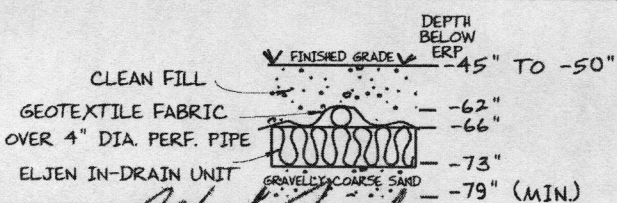
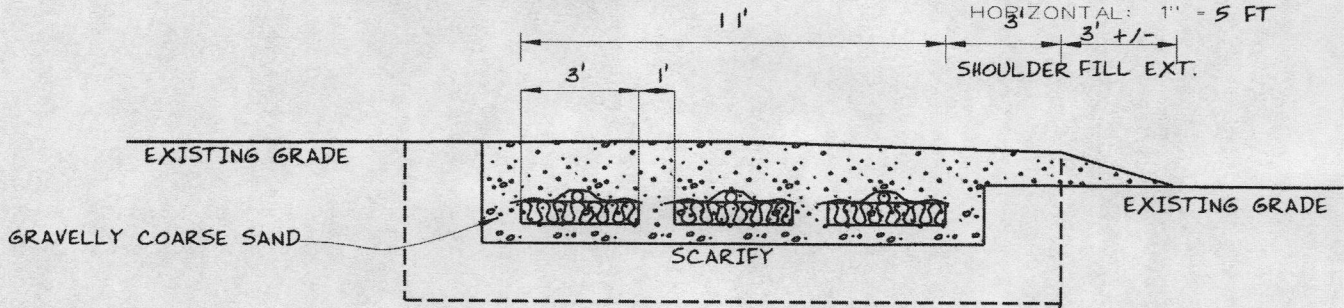

REMOVE ALL PORTIONS OF EXISTING DISPOSAL AREA ENCOUNTERED TO A MINIMUM DEPTH OF 2' UNDERNEATH AND 3' ALONGSIDE DISPOSAL AREA AND REPLACE WITH CLEAN GRAVELLY COARSE SAND FILL

Albert Frick
 Site Evaluator Signature

163
 SE *

10/19/15
 Date

Page 3 of 3
 HHE-200 Rev. 10/02