

City of Portland, Maine - Building or Use Permit Application

389 Congress Street, 04101 Tel: (207) 874-8703, Fax: (207) 874-8716

| | | |
|-----------------------|----------------------------------|----------------------|
| Permit No: 05-0694 | Issue Date: JUN 6 2005 | CELL: 091 P 10001 |
|-----------------------|----------------------------------|----------------------|

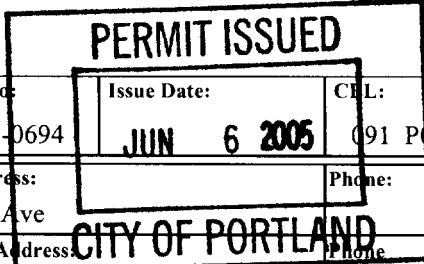

| | | | |
|--|--|--|---|
| Location of Construction: 113 Reed Ave | Owner Name: Hayman James H & Jeanne O Jts | Owner Address: 113 Reed Ave | Phone: |
| Business Name: | Contractor Name: Roberts & Roberts | Contractor Address: 379 Island Ave Peaks Island | Phone: 2077665819 |
| Lessee/Buyer's Name | Phone: | Permit Type: Alterations - Dwellings | Zone: -1 |
| Past Use: Single Family | Proposed Use: Single Family w/wraparound boardwalk & deck and a 5' x 12' covered entry | Permit Fee: \$111.00 | Cost of Work: \$10,000.00 |
| Proposed Project Description: Build a 637sf wraparound boardwalk & deck and a 5' x 12' covered entry | | CEO District: 2 | Signature: JMB 6/6/05 |
| | | FIRE DEPT: <input type="checkbox"/> Approved <input type="checkbox"/> Denied | INSPECTION: Use Group: R Type: accessory IRC-2003 |
| | | PEDESTRIAN ACTIVITIES DISTRICT (P.A.D.) | |
| | | Action: <input type="checkbox"/> Approved <input type="checkbox"/> Approved w/Conditions <input type="checkbox"/> Denied | |
| | | Signature: _____ Date: _____ | |

| | | | |
|--------------------------------|--|------------------------|--|
| Permit Taken By: jmb | Date Applied For: 06/06/2005 | Zoning Approval | |
|--------------------------------|--|------------------------|--|

| | | | |
|---|---|--|---|
| <p>1. This permit application does not preclude the Applicant(s) from meeting applicable State and Federal Rules.</p> <p>2. Building permits do not include plumbing, septic or electrical work.</p> <p>3. Building permits are void if work is not started within six (6) months of the date of issuance. False information may invalidate a building permit and stop all work..</p> | <p>Special Zone or Reviews</p> <p><input checked="" type="checkbox"/> Shoreland <i>well over 75' to thorn</i></p> <p><input type="checkbox"/> Wetland</p> <p><input checked="" type="checkbox"/> Flood Zone <i>Panel 9 Zone VE</i></p> <p><input type="checkbox"/> Subdivision</p> <p><input type="checkbox"/> Site Plan</p> <p>Maj <input type="checkbox"/> Minor <input type="checkbox"/> MM <input type="checkbox"/></p> <p>Date: <i>JMB 6/6/05</i></p> | <p>Zoning Appeal</p> <p><input type="checkbox"/> Variance</p> <p><input type="checkbox"/> Miscellaneous</p> <p><input type="checkbox"/> Conditional Use</p> <p><input type="checkbox"/> Interpretation</p> <p><input type="checkbox"/> Approved</p> <p><input type="checkbox"/> Denied</p> <p>Date: _____</p> | <p>Historic Preservation</p> <p><input checked="" type="checkbox"/> Not in District or Landmark</p> <p><input type="checkbox"/> Does Not Require Review</p> <p><input type="checkbox"/> Requires Review</p> <p><input type="checkbox"/> Approved</p> <p><input type="checkbox"/> Approved w/Conditions</p> <p><input type="checkbox"/> Denied</p> <p>Date: _____</p> |
|---|---|--|---|

CERTIFICATION

I hereby certify that I am the owner of record of the named property, or that the proposed work is authorized by the owner of record and that I have been authorized by the owner to make this application as his authorized agent and I agree to conform to all applicable laws of this jurisdiction. In addition, if a permit for work described in the application is issued, I certify that the code official's authorized representative shall have the authority to enter all areas covered by such permit at any reasonable hour to enforce the provision of the code(s) applicable to such permit.

| | | | |
|---|---------|------|-------|
| SIGNATURE OF APPLICANT | ADDRESS | DATE | PHONE |
| RESPONSIBLE PERSON IN CHARGE OF WORK, TITLE | | DATE | PHONE |

City of Portland, Maine - Building or Use Permit

389 Congress Street, 04101 Tel: (207) 874-8703, Fax: (207) 874-8716

| | | |
|------------------------------|--|----------------------------|
| Permit No: 05-0694 | Date Applied For: 06/06/2005 | CBL: 091 P010001 |
|------------------------------|--|----------------------------|

| | | | |
|--|---|---|--------------------------------|
| Location of Construction: 113 Reed Ave | Owner Name: Hayman James H & Jeanne O Jts | Owner Address: 113 Reed Ave | Phone: |
| Business Name: | Contractor Name: Roberts & Roberts | Contractor Address: 379 Island Ave Peaks Island | Phone (207) 766-5819 |
| Lessee/Buyer's Name | Phone: | Permit Type: Alterations - Dwellings | |

| | |
|--|--|
| Proposed Use: Single Family w/wraparound boardwalk & deck and a 5' x 12' covered entry | Proposed Project Description: Build a 637sf wraparound boardwalk & deck and a 5' x 12' covered entry |
|--|--|

| | | | |
|--|---|---------------------------------|---|
| Dept: Zoning | Status: Approved | Reviewer: Jeanine Bourke | Approval Date: 0610612005 |
| Note: | | | Ok to Issue: <input checked="" type="checkbox"/> |
| Dept: Building | Status: Approved with Conditions | Reviewer: Jeanine Bourke | Approval Date: 0610612005 |
| Note: | | | Ok to Issue: <input checked="" type="checkbox"/> |
| 1) Permit approved based on the plans submitted and reviewed w/owner/contractor, with additional information as agreed on and as noted on plans. | | | |

| | | | |
|-------------------|----------------|------------------|--|
| Dept: Fire | Status: | Reviewer: | Approval Date: |
| Note: | | | Ok to Issue: <input type="checkbox"/> |

All Purpose Building Permit Application

If you or the property owner owes real estate or personal property taxes or user charges on any property within the City, payment arrangements must be made before permits of any kind are accepted.

| | | |
|--|--|--|
| Location/Address of Construction: <u>113 REED RD , PEAKS ISLAND</u> | | |
| Total Square Footage of Proposed Structure <u>637 sq ft</u> | Square Footage of Lot <u>42,932</u> | |
| Tax Assessor's Chart, Block & Lot Chart# <u>91</u> Block# <u>P</u> Lot# <u>10</u> | Owner: <u>JAMES HAYMAN & JEANNE HAYMAN</u> | Telephone: |
| Lessee/Buyer's Name (If Applicable) | Applicant name, address & telephone: <u>CHRIS ROBERTS</u> <u>579 ISLAND AVE</u> <u>PEAKS ISLAND</u> | cost Of Work: \$ <u>10,000</u> Fee: \$ <u>111.-</u> |
| <p>If the location is currently vacant, what was prior use: <u>NA</u></p> <p>Approximately how long has it been vacant: <u>NA</u></p> <p>Proposed use: <u>NO CHANGE</u></p> <p>Project description: <u>ADD DECK, FENCE, AND SHED</u></p> | | |
| <p>Contractor's name, address & telephone: <u>ROBERTS & ROBERTS</u></p> <p>Who should we contact when the permit is ready: <u>CHRIS 766-5819</u></p> <p>Mailing address: <u>379 ISLAND AVE</u> <u>PEAKS ISLAND</u></p> <p>We will contact you by phone when the permit is ready. You must come in and pick up the permit and review the requirements before starting any work, with a Plan Reviewer. A stop work order will be issued and a \$100.00 fee if any work starts before the permit is picked up. PHONE: <u>766 5819</u></p> | | |

IF THE REQUIRED INFORMATION IS NOT INCLUDED IN THE SUBMISSIONS THE PERMIT WILL BE AUTOMATICALLY DENIED AT THE DISCRETION OF THE BUILDING/PLANNING DEPARTMENT WE MAY REQUIRE ADDITIONAL INFORMATION IN ORDER TO APPROVE THIS PERMIT.

I hereby certify that I am the Owner of record of the named property, or that the owner of record authorizes the proposed work and that I have been authorized by the owner to make this application as his/her authorized agent. I agree to conform to all applicable laws of this jurisdiction. In addition, if a permit for work described in this application is issued, I certify that the Code Official's authorized representative shall have the authority to enter all areas covered by this permit at any reasonable hour to enforce the provisions of the codes applicable to this permit.

| | |
|--|-----------------------|
| Signature of applicant: <u>[Signature]</u> | Date: <u>06/06/05</u> |
|--|-----------------------|

This is NOT a permit, you may not commence ANY work until the permit is issued.
If you are in a Historic District you may be subject to additional permitting and fees with the Planning Department on the 4th floor of City Hall

This page contains a detailed description of the Parcel ID you selected. Press the **New Search** button at the bottom of the screen to submit a new query.

Current Owner Information

| | |
|---------------|--|
| Card Number | 1 of 1 |
| Parcel ID | 091 P010001 |
| Location | 113 REED AVE |
| Land Use | SINGLE FAMILY |
| | |
| Owner Address | HAYMAN JAMES H & JEANNE O JTS 113 REED AVE PEAKS ISLAND ME 04108 |
| | |
| Book/Page | 11283/227 |
| Legal | 91-P-10 REED AVE PEAKS ISLAND 40000 SF |

#694

Current Valuation Information

| | | |
|-----------|-----------|-----------|
| Land | Building | Total |
| \$106,050 | \$177,140 | \$283,190 |

New Estimated Valuation Information

| | | | |
|-----------|-----------|-----------|----------------|
| Land | Building | Total | Phase-In Value |
| \$396,900 | \$259,600 | \$656,500 | \$469,845 |

Property Information

| | | | | | | |
|------------|------------|--------------|-------------|-------------|-----------|--|
| Year Built | Style | Story Height | Sq. Ft. | Total Acres | | |
| 1998 | Contemp | 2 | 2516 | 0.918 | | |
| Bedrooms | Full Baths | Half Baths | Total Rooms | Attic | Basement | |
| 3 | 3 | | 7 | None | Pier/slab | |

Outbuildings

| | | | | | |
|------|----------|------------|------|-------|-----------|
| Type | Quantity | Year Built | Size | Grade | Condition |
|------|----------|------------|------|-------|-----------|

Sales Information

| | | | |
|------------|---------------|-----------|-----------|
| Date | Type | Price | Book/Page |
| 02/07/1994 | LAND + BLDING | \$122,500 | 11283-227 |

Picture and Sketch

| | | |
|---------|--------|---------|
| Picture | Sketch | Tax Map |
|---------|--------|---------|

[Click here](#) to view Tax Roll Information.

Any information concerning tax payments should be directed to the Treasury office at 874-8490 or e-mailed.

[Click here](#) to view comparable sales or below to view **by**



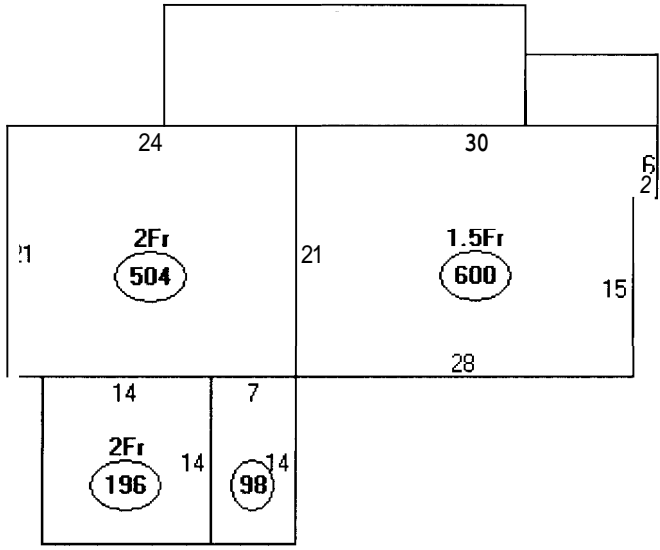

Descriptor/Area

- A: 2Fr
504 sqft
- E: 1.5Fr
600 sqft
- C: WD
300 sqft
- D: WD/1Fr
66 sqft
- E: 2Fr
196 sqft
- F: NIA
98 sqft

1764

Adding 637 SF

2,401

OK

Lot 42,932
x 20%

8,586 SF

BUILDING PERMIT INSPECTION PROCEDURES

Please call 874-8703 or 874-8693 to schedule your inspections as agreed upon

Permits expire in 6 months, if the project is **not** started or ceases for 6 months.

The Owner or their designee is required to notify the inspections office for the following inspections and provide adequate notice. Notice must be called in ~~48-72~~ hours in advance in order to schedule an inspection:

By initializing at each inspection time, you are agreeing that you understand the inspection procedure and additional fees from a "Stop Work Order" and "Stop Work Order Release" will be incurred if the procedure is not followed as stated below.

A Pre-construction Meeting will take place upon receipt of your building permit.

- Footings/Building Location Inspection:** Prior to pouring concrete
- Re-Bar Schedule Inspection:** Prior to pouring concrete
- Foundation Inspection:** Prior to placing ANY backfill
- Framing/Rough Plumbing/Electrical:** Prior to any insulating or drywalling
- Final/~~Certificate of Occupancy~~:** Prior to any occupancy of the structure or use. **NOTE: ~~There is a \$75.00 fee per~~ inspection at this point.**

Certificate of Occupancy is not required for certain projects. Your inspector can advise you if your project requires a Certificate of Occupancy. All projects DO require a final inspection

If any of the inspections do not occur, the project cannot go on to the next phase, REGARDLESS OF THE NOTICE OR CIRCUMSTANCES.

CERTIFICATE OF OCCUPANCIES MUST BE ISSUED AND PAID FOR, BEFORE THE SPACE MAY BE OCCUPIED

[Signature]
Signature of Applicant/Designee

6/6/05
Date

[Signature]
Signature of Inspections Official

6/6/05
Date

CBL: 91-P-10

Building Permit #: 05-0694

DISPLAY THIS CARD ON PRINCIPAL FRONTAGE OF WORK
CITY OF PORTLAND

Please Read Application And Notes, If Any, Attached

PERMIT ISSUED
JUN 6 2005
Permit Number: 050694
CITY OF PORTLAND

PERMIT

This is to certify that Hayman James H & Jeanne C / Robert
has permission to Build a 637sf wraparound boardwalk & deck and a 12' covered entry
AT 113 Reed Ave 091 P010001

provided that the person or persons, firm or corporation accepting this permit shall comply with all of the provisions of the Statutes of Maine and of the ordinances of the City of Portland regulating the construction, maintenance and use of buildings and structures, and of the application on file in this department.

Apply to Public Works for street line and grade if nature of work requires such information.

Notification of inspection must be given and written permission procured before this building or part thereof is occupied or closed-in. **HEAR NOTICE IS REQUIRED.**

A certificate of occupancy must be procured by owner before this building or part thereof is occupied.

OTHER REQUIRED APPROVALS
Fire Dept. _____
Health Dept. _____
Appeal Board _____
Other _____
DepartmentName

Jamie Bourke 6/6/05
Director - Building & Inspection Services

PENALTY FOR REMOVING THIS CARD