

This page contains a detailed description of the Parcel ID you selected. Press the **New Search** button at the bottom of the screen to submit a new query.

**Current Owner Information**

Card Number	1 of 1
Parcel ID	091 M006001
Location	11 OCEAN SPRAY RD
Land Use	SINGLE FAMILY
Owner Address	WHALEBACK ASSOCIATES LLC 822 SEASHORE AVE PEAKS ISLAND ME 04108
Book/Page	22206/144
Legal	91-M-6 SEASHORE AVE PEAKS ISLAND 10000 SF

*Robyn & Steve 9AM  
5/24*

*# 610*

*\$ 971*

**Current Valuation Information**

Land	Building	Total
\$107,730	\$75,810	\$183,540

**New Estimated Valuation Information**

Land	Building	Total	Phase-In Value
\$344,000	\$80,100	\$424,100	\$303,820

**Property Information**

Year Built	Style	Story Height	sq. Ft.	Total Acres	
1931	Cottage	2	1391	0.23	
Bedrooms	Pull Baths	Half Baths	Total Rooms	Attic	Basement
2	1	1	5	None	Pier/slab

**Outbuildings**

Type	Quantity	Year Built	Size	Grade	Condition
------	----------	------------	------	-------	-----------

**Sales Information**

Date	Type	Price	Book/Page
01/06/2005	LAND + BLDING	\$5207000	22206-144

**Picture and Sketch**

Picture	Sketch	Tax Map
---------	--------	---------

[Click here](#) to view Tax Roll Information.

Any information concerning tax payments should be directed to the Treasury office at 874-8490 or [e-mailed](#).

[Click here](#) to view comparable sales or below to view **by**:



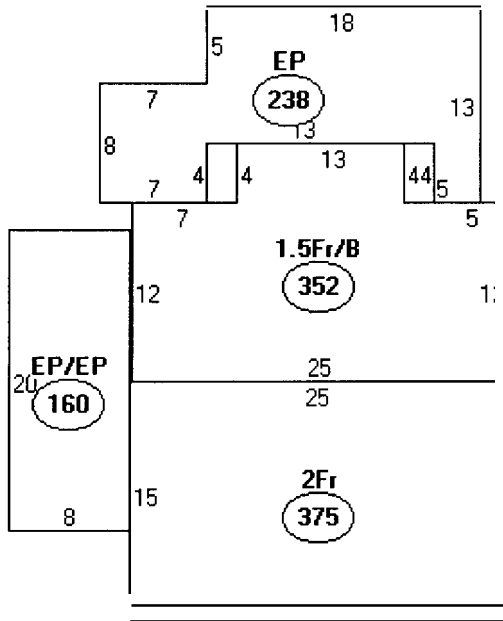

Descriptor/Area

- A: 2Fr  
375 sqft
- B: EP/EP  
160 sqft
- C: 1.5Fr/B  
352 sqft
- D: EP  
238 sqft
- E: 1Fr  
25 sqft

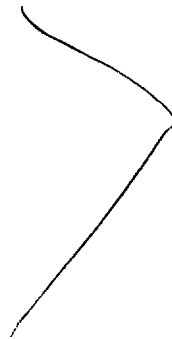

1,150

Lot 10,000 ft<sup>2</sup>  
x 20%  
-----  
2,000

EXHIBIT A

A CERTAIN LOT OR PARCEL OF LAND WITH THE BUILDINGS THEREON, SITUATED ON PEAKS ISLAND IN THE CITY OF PORTLAND, BEING A PART OF LOT NUMBER FIVE (5) SHOWN ON PLAN OF THE FRANCIS WOODBURY FARM, MADE BY CHARLES H. HOWE AND RECORDED IN CUMBERLAND REGISTRY OF DEEDS, PLAN BOOK 2, PAGE 49, BOUNDED AND DESCRIBED AS FOLLOWS:

BEGINNING AT A POINT FIFTY (50) FEET NORTHERLY OF THE SOUTHERLY SIDE LINE OF SAID LOT IN THE DIVIDING LINE BETWEEN SAID LOT AND THE LAND NOW OR FORMERLY OF NANCY P. SKILLINGS ON THE EASTERLY SIDE OF SEASHORE AVENUE; THENCE NORTHERLY BY SEASHORE AVENUE FIFTY (50) FEET TO A POINT; THENCE EASTERLY ON A LINE PARALLEL WITH THE DIVIDING LINE ON THE SOUTHERLY SIDE OF SAID LOT AND LAND NOW OR FORMERLY OF NANCY P. SKILLINGS TWO HUNDRED (200) FEET, MORE OR LESS, TO THE SEASHORE; THENCE SOUTHERLY BY THE SEA SHORE TO A POINT FIFTY (50) FEET NORTHERLY OF LAND NOW OR FORMERLY OF NANCY P. SKILLINGS AND THE SOUTHERLY SIDE OF SAID LOT NUMBERED FIVE (5); THENCE WESTERLY PARALLEL WITH THE DIVIDING LINE OF LOT NUMBERED FIVE (5) AND LAND NOW OR FORMERLY OF NANCY P. SKILLINGS TWO HUNDRED (200) FEET, MORE OR LESS, TO THE POINT OF BEGINNING, SAID LINE TO BE FIFTY (50) FEET FROM SAID SOUTHERLY SIDE LINE OF SAID LOT.

BEING THE SAME PREMISES CONVEYED TO WILLIAM B. GOOWIN BY VIRTUE OF A WARRANTY DEED FROM ELEANOR S. GOODWIN RECORDED JANUARY 8, 1975 IN THE CUMBERLAND COUNTY REGISTRY OF DEEDS IN BOOK 3639, PAGE 85.

Received  
Recorded Register of Deeds  
Jan 06, 2005 02:50:00P  
Cumberland County  
John B O'Brien

# BUILDING PERMIT INSPECTION PROCEDURES

Please call 874-8703 or 874-8693 to schedule your inspections as agreed upon

Permits expire in 6 months, if the project is not started or ceases for 6 months.

The Owner or their designee is required to notify the inspections office for the following inspections and provide adequate notice. Notice must be called in 48-72 hours in advance in order to schedule an inspection:

By initializing at each inspection time, you are agreeing that you understand the inspection procedure and additional fees from a "Stop Work Order" and "Stop Work Order Release" will be incurred if the procedure is not followed as stated below.

A Pre-construction Meeting will take place upon receipt of your building permit.

- NA Footing/Building Location Inspection: Prior to pouring concrete
- NA Re-Bar Schedule Inspection: Prior to pouring concrete
- NA Foundation Inspection: Prior to placing ANY backfill
- Framing/Rough Plumbing/Electrical: Prior to any insulating or drywalling
- Final/~~Certificate of Occupancy~~: Prior to any occupancy of the structure or use. ~~NOTE: There is a \$75.00 fee per inspection at this point.~~

Certificate of Occupancy is not required for certain projects. Your inspector can advise you if your project requires a Certificate of Occupancy. All projects DO require a final inspection

If any of the inspections do not occur, the project cannot go on to the next phase, REGARDLESS OF THE NOTICE OR CIRCUMSTANCES.

NA **CERIFICATE OF OCCUPANICES MUST BE ISSUED AND PAID FOR, BEFORE THE SPACE MAY BE OCCUPIED**

[Signature]  
Signature of Applicant/Designee

5/24/05  
Date

[Signature]  
Signature of Inspections Official

5/24/05  
Date

CBL: 91-M-6

Building Permit #: 05-0610