

DISPLAY THIS CARD ON PRINCIPAL FRONTAGE OF WORK

CITY OF PORTLAND

BUILDING INSPECTION

PERMIT

Please Read Application And Notes, If Any, Attached

Permit Number: 090477

PERMIT ISSUED

This is to certify that HALSEY WOODRUFF WILLIAMS TRUST

has permission to Moved header Amendment to # 09-0298

AT 90 PRINCE AVE 091 K042001

provided that the person or persons, firm or corporation accepting this permit shall comply with all of the provisions of the Statutes of Maine and of the Ordinances of the City of Portland regulating the construction, maintenance and use of buildings and structures, and of the application on file in this department.

Apply to Public Works for street line and grade if nature of work requires such information.

Notification of inspection must be given and written permission procured before this building or part thereof is lath or other work is set-in. 2 HOUR NOTICE IS REQUIRED.

A certificate of occupancy must be procured by owner before this building or part thereof is occupied.

OTHER REQUIRED APPROVALS

- Fire Dept. _____
- Health Dept. _____
- Appeal Board _____
- Other _____
Department Name

Cheryl H 5/20/09
Director - Building & Inspection Services

PENALTY FOR REMOVING THIS CARD

City of Portland, Maine - Building or Use Permit Application

389 Congress Street, 04101 Tel: (207) 874-8703, Fax: (207) 874-8716

Permit No: 09-0477	Issue Date: 5/20/09	CBL: 091 K042001
-----------------------	------------------------	---------------------

Location of Construction: 90 PRINCE AVE	Owner Name: HALSEY WOODRUFF W II & CO	Owner Address: 15 COLUMBUS AVE	Phone:
Business Name:	Contractor Name: Nolan Murphy	Contractor Address: 5 Benjamin Street Haverhill	Phone: 9789739719
Lessee/Buyer's Name	Phone:	Permit Type: Alterations - Dwellings	Zone:

Past Use: Single Family Home	Proposed Use: Single Family Home - Moved header	Permit Fee: \$60.00	Cost of Work: \$4,000.00	CEO District: 1
		FIRE DEPT: <input type="checkbox"/> Approved <input type="checkbox"/> Denied	INSPECTION: Use Group: R-3 Type: SB IRC-2003	

Proposed Project Description: Moved header	Amendment to permit # 090298			
		Signature:	Signature: <i>CL 5/20/09</i>	
PEDESTRIAN ACTIVITIES DISTRICT (P.A.D.)				
Action: <input type="checkbox"/> Approved <input type="checkbox"/> Approved w/Conditions <input type="checkbox"/> Denied				
		Signature:	Date:	

Permit Taken By: Ldobson	Date Applied For: 05/20/2009	Zoning Approval		
-----------------------------	---------------------------------	------------------------	--	--

<ol style="list-style-type: none"> This permit application does not preclude the Applicant(s) from meeting applicable State and Federal Rules. Building permits do not include plumbing, septic or electrical work. Building permits are void if work is not started within six (6) months of the date of issuance. False information may invalidate a building permit and stop all work.. 	Special Zone or Reviews <input type="checkbox"/> Shoreland <input type="checkbox"/> Wetland <input type="checkbox"/> Flood Zone <input type="checkbox"/> Subdivision <input type="checkbox"/> Site Plan Maj <input type="checkbox"/> Minor <input type="checkbox"/> MM <input type="checkbox"/> Date: <i>5/20/09 CL</i>	Zoning Appeal <input type="checkbox"/> Variance <input type="checkbox"/> Miscellaneous <input type="checkbox"/> Conditional Use <input type="checkbox"/> Interpretation <input type="checkbox"/> Approved <input type="checkbox"/> Denied Date:	Historic Preservation <input type="checkbox"/> Not in District or Landmark <input checked="" type="checkbox"/> Does Not Require Review <input type="checkbox"/> Requires Review <input type="checkbox"/> Approved <input type="checkbox"/> Approved w/Conditions <input type="checkbox"/> Denied Date:
	<i>Amendment only O.K.</i>		

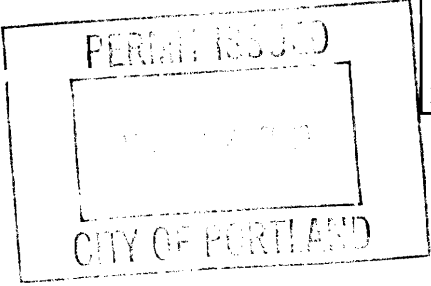

CERTIFICATION

I hereby certify that I am the owner of record of the named property, or that the proposed work is authorized by the owner of record and that I have been authorized by the owner to make this application as his authorized agent and I agree to conform to all applicable laws of this jurisdiction. In addition, if a permit for work described in the application is issued, I certify that the code official's authorized representative shall have the authority to enter all areas covered by such permit at any reasonable hour to enforce the provision of the code(s) applicable to such permit.

SIGNATURE OF APPLICANT	ADDRESS	DATE	PHONE
RESPONSIBLE PERSON IN CHARGE OF WORK, TITLE		DATE	PHONE

City of Portland, Maine - Building or Use Permit

389 Congress Street, 04101 Tel: (207) 874-8703, Fax: (207) 874-8716

Permit No: 09-0477	Date Applied For: 05/20/2009	CBL: 091 K042001
------------------------------	--	----------------------------

Location of Construction: 90 PRINCE AVE	Owner Name: HALSEY WOODRUFF W II & CO	Owner Address: 15 COLUMBUS AVE	Phone:
Business Name:	Contractor Name: Nolan Murphy/ Head Above Builder	Contractor Address: 5 Benjamin Street Haverhill	Phone (978) 973-9719
Lessee/Buyer's Name	Phone:	Permit Type: Alterations - Dwellings	

Proposed Use: Single Family Home - Moved header	Proposed Project Description: Moved header
---	--

Dept: Zoning **Status:** Approved **Reviewer:** Chris Hanson **Approval Date:** 05/20/2009
Note: **Ok to Issue:**

Dept: Building **Status:** Approved with Conditions **Reviewer:** Chris Hanson **Approval Date:** 05/20/2009
Note: **Ok to Issue:**

- 1) Permit approved based on the plans submitted and reviewed w/owner/contractor, with additional information as agreed on and as noted on plans.



General Building Permit Application

If you or the property owner owes real estate or personal property taxes or user charges on any property within the City, payment arrangements must be made before permits of any kind are accepted.

Location/Address of Construction: <u>90 Prince Ave</u>		
Total Square Footage of Proposed Structure/Area	Square Footage of Lot	Number of Stories <u>2</u>
Tax Assessor's Chart, Block & Lot Chart# Block# Lot# <u>91</u> <u>K</u> <u>42</u>	Applicant * must be owner, Lessee or Buyer * Name <u>Woodruff Halsey</u> Address <u>10 Columbus St</u> City, State & Zip <u>Haverhill MA 01832</u>	Telephone: <u>(978) 204-5795</u>
Lessee/DBA (If Applicable)	Owner (if different from Applicant) Name Address City, State & Zip	Cost Of Work: \$ <u>4000</u> C of O Fee: \$ _____ Total Fee: \$ <u>60</u>
Current legal use (i.e. single family) <u>Single family</u> Number of Residential Units <u>1</u> If vacant, what was the previous use? _____ Proposed Specific use: _____ Is property part of a subdivision? <u>NO</u> If yes, please name _____ Project description: <u>Moved header</u>		
Contractor's name: <u>Nolan Murphy</u> Address: <u>5 Benjamin St</u> City, State & Zip <u>Haverhill, MA 01832</u> Telephone: <u>(978) 973-9719</u> Who should we contact when the permit is ready: <u>Nolan Murphy</u> Telephone: <u>(978) 973-9719</u> Mailing address: <u>5 Benjamin St Haverhill MA</u>		

Please submit all of the information outlined on the applicable Checklist. Failure to do so will result in the automatic denial of your permit.

In order to be sure the City fully understands the full scope of the project, the Planning and Development Department may request additional information prior to the issuance of a permit. For further information or to download copies of this form and other applications visit the Inspections Division on-line at www.portlandmaine.gov, or stop by the Inspections Division office, room 315 City Hall or call 874-8703.

I hereby certify that I am the Owner of record of the named property, or that the owner of record authorizes the proposed work and that I have been authorized by the owner to make this application as his/her authorized agent. I agree to conform to all applicable laws of this jurisdiction. In addition, if a permit for work described in this application is issued, I certify that the Code Official's authorized representative shall have the authority to enter all areas covered by this permit at any reasonable hour to enforce the provisions of the codes applicable to this permit.

Signature: Nolan Murphy Date: 5-20-09

This is not a permit; you may not commence ANY work until the permit is issue

90 Price Ave

1st Floor

Peaks Island

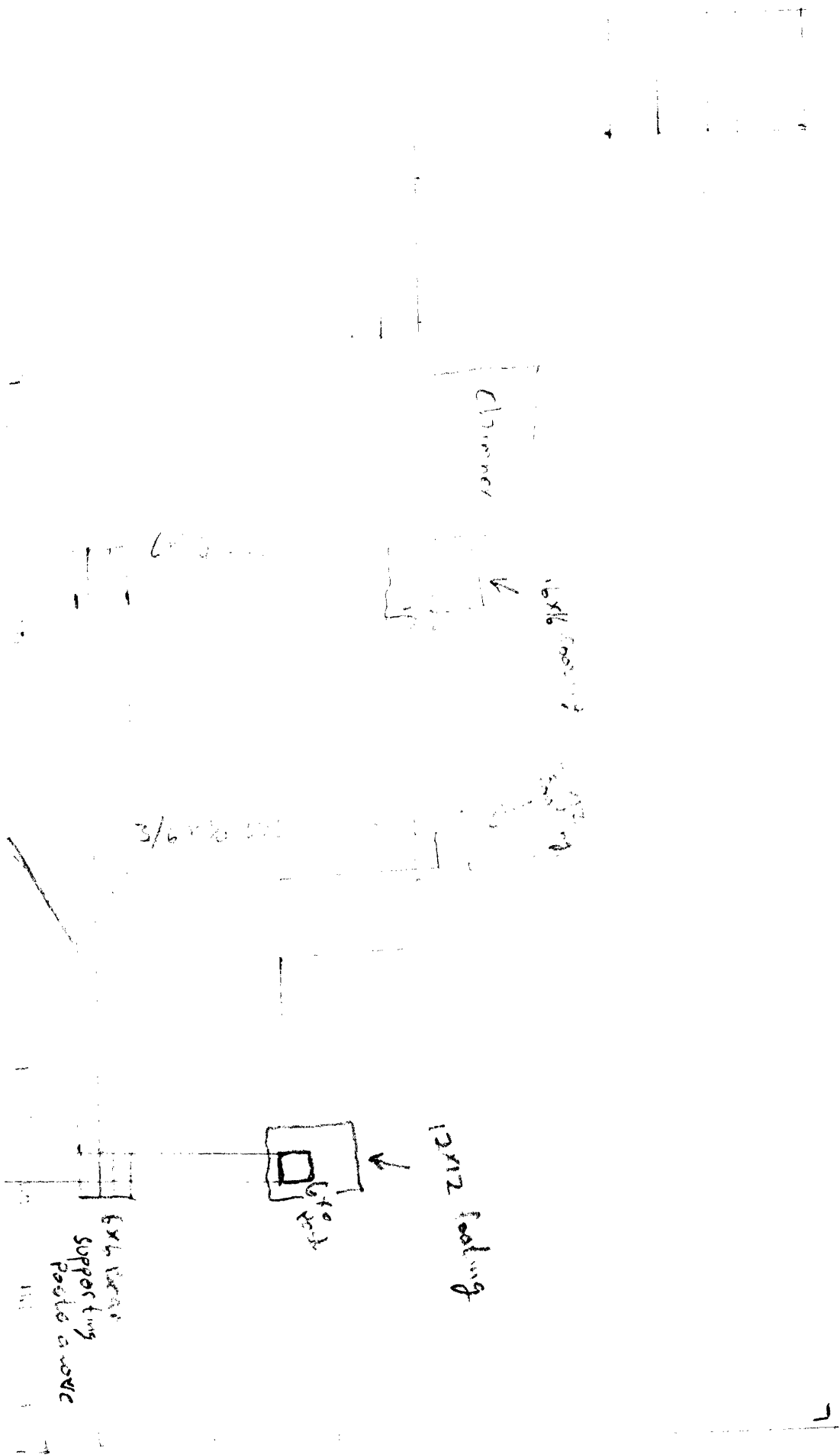

Floor plan

ASCE 7-10

Add it



Adding to support ridge

2x8 collar tie

New collar ties
& new 2x8 for Ridge



4x12