

SUBSURFACE WASTEWATER DISPOSAL SYSTEM APPLICATION

Maine Department of Human Services
 Division of Health Engineering, Station 10 SHS
 (207) 287-5672 FAX (207) 287-4172

Town, City, Plantation
PORTLAND, PEAKS ISLAND

Street, Road, Subdivision
109 SARGENT ROAD

Owner's Name
LAWRENCE C. FOSTER III

SUBSURFACE WASTEWATER DISPOSAL PLAN

SCALE 1" = 20 FT.

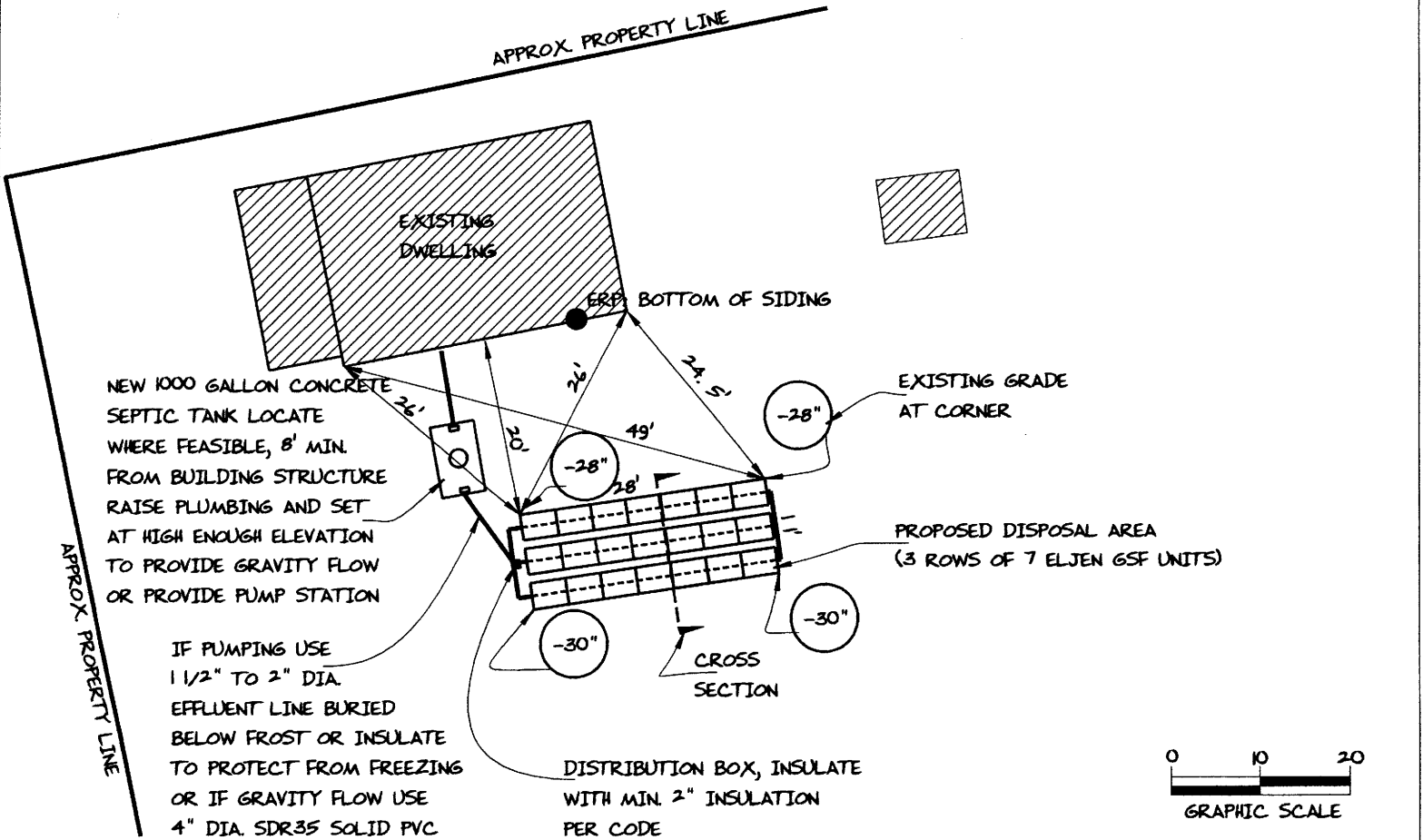

FILL REQUIREMENTS

Depth of Fill (Upslope) = 0"
 Depth of Fill (Downslope) = 0"
 DEPTHS AT CROSS-SECTION (shown below)

CONSTRUCTION ELEVATIONS

Finished Grade Elevation
 Top of Distribution Pipe or Proprietary Device
 Bottom of Disposal Area

ELEVATION REFERENCE POINT

SEE DETAIL BELOW Location & Description
 BOTTOM OF WHITE SIDING, 25" ABOVE EXISTING GRADE
 Reference Elevation is: 0.0" or GRADE

DISPOSAL AREA CROSS SECTION

SCALE:
 VERTICAL: 1" = 5 FT
 HORIZONTAL: 1" = 5 FT

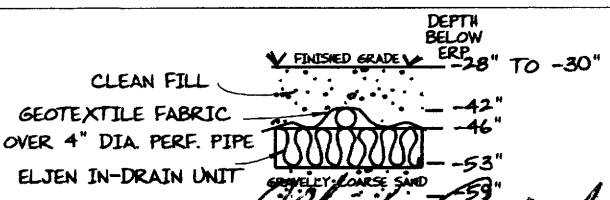
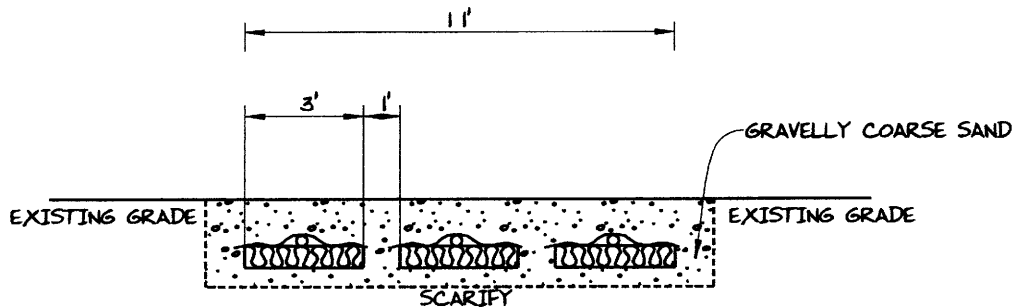

Albert Frick
 Site Evaluator Signature

163
 SE *

8/3/2015
 Date