

Rachel Conly
Architectural Design

26 Sterling Street
Peaks Island, Maine 04108
207.766.5625

Existing
South and West
Elevations

PROJECT

**Braun Hogan
Residence**
265 Pleasant Ave.
Peaks Island, ME

DATE
07.29.14

REVISED

SCALE
1/4" = 1'-0"

DRAWN BY
**Rachel &
Harvey**

NOTES

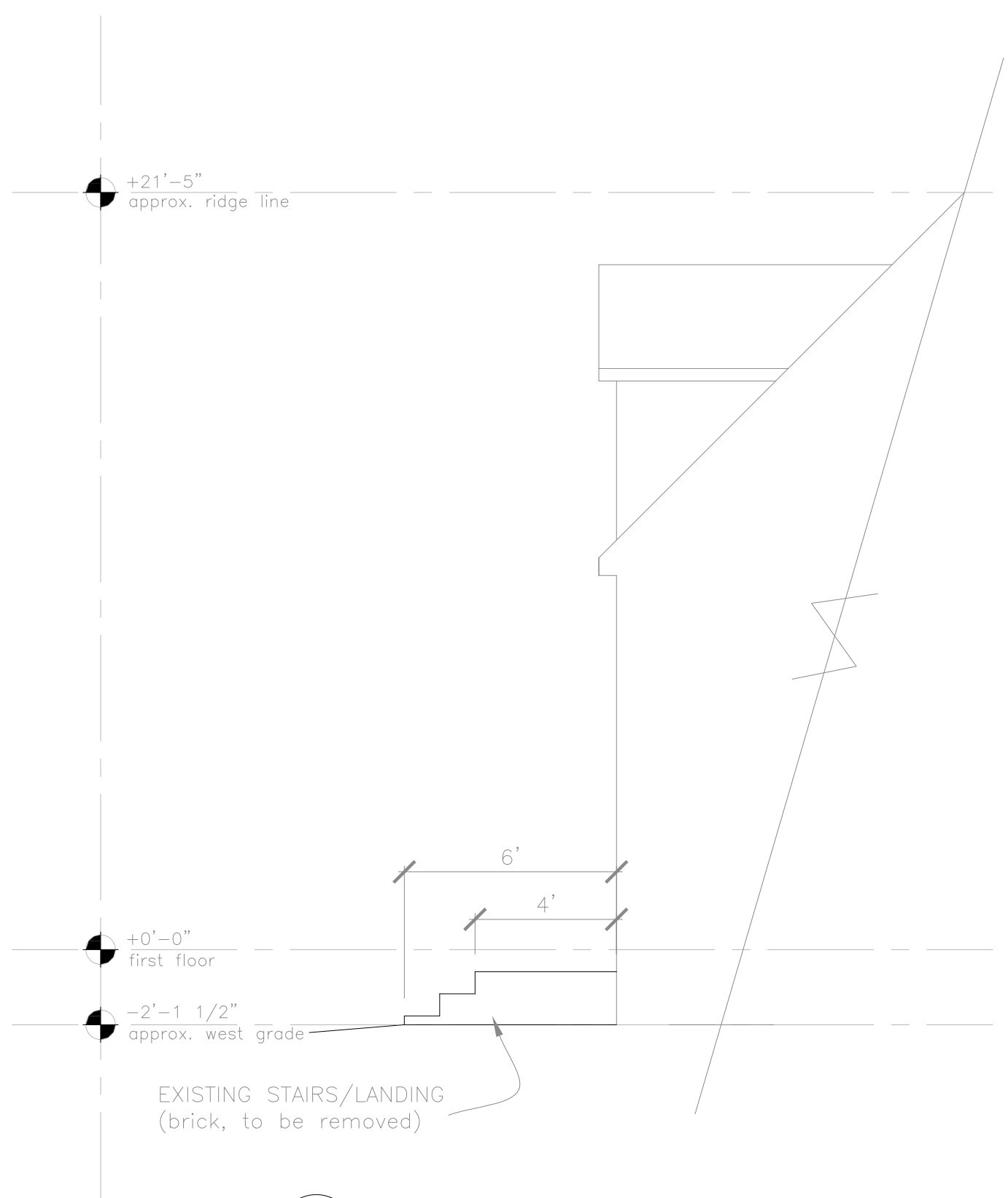

(A) Existing South Elevation
1/4" = 1'-0"



(B) Existing West Elevation
1/4" = 1'-0"

