

2012-9-8023



11149

Human Services and Prevention
6 Water Street
11 State House Station
Augusta, Maine 04333-0011
Tel: (207) 287-5672
Fax: (207) 287-4172; TTY: 1-800-606-0215

SUBSURFACE WASTEWATER DISPOSAL SYSTEM VARIANCE REQUEST

This form must accompany an application (HHE-200 Form) for any subsurface wastewater disposal system which requires a variance to provisions of the Subsurface Wastewater Disposal Rules. The Local Plumbing Inspector must not issue a permit for the installation of a subsurface wastewater disposal system requiring a variance from the Department of Health and Human Services until approval has been received from the Department.

GENERAL INFORMATION Town of Portland (Peaks Island)

Property Owner's Name: Kristen MacLeod (C/O Monica Stevenson) Tel No _____

System's Location: 531 Island Avenue (Map 90, Lot R-1,2)

Property Owner's Address: _____ Zip Code _____

e-mail address: _____

The subsurface wastewater disposal system design for the subject property requires a replacement system variance first time system variance to the Subsurface Wastewater Disposal Rules. This variance requires local approval local and state approval

SPECIFIC VARIANCE REQUESTED (To be filled in by Site Evaluator. Use additional sheets if needed.)	SECTION OF RULE
1. <u>To allow a replacement disposal field to be installed 11' from a full foundation</u>	<u>8 (Table 8 A)</u>
2. _____	_____
3. _____	_____

SITE EVALUATOR

When a property is found to be unsuitable for subsurface wastewater disposal by a licensed Site Evaluator, the Evaluator shall so inform the property owner. If the property owner, after exploring all other alternatives, wishes to request a variance to the Rules, and the Evaluator in his professional opinion feels the variance request is justified and the site limitations can be overcome, he shall document the soil and site conditions on the Application. The Evaluator shall list the specific variances necessary plus describe below the proposed system design and function. The Evaluator shall further describe how the specific site limitations are to be overcome, and provide any other support documentation as required prior to consideration by the Department. Attach a separate sheet if necessary.

I, Albert Frick, S.E., certify that a variance to the Rules is necessary since a system cannot be installed which will completely satisfy all the Rule requirements. In my judgment, the proposed system design on the attached Application is the best alternative available, enhances the potential of the site for subsurface wastewater disposal, and that the system should function properly.

Albert Frick SIGNATURE OF SITE EVALUATOR 11/27/12 REVISED DATE

PROPERTY OWNER

I, _____, am the owner/agent for the owner of the subject property. I understand that the installation on the Application is not in total compliance with the Rules. Should the proposed system malfunction, I release all concerned provided they have performed their duties in a reasonable and proper manner, and I will promptly notify the Local Plumbing Inspector and make any corrections required by the Rules. By signing the variance request form, I acknowledge permission for representatives of the Department to enter onto the property to perform such duties as may be necessary to evaluate the variance request.

Monica Stevenson SIGNATURE OF OWNER 11/27/12 DATE
 X AGENT FOR THE OWNER

LOCAL PLUMBING INSPECTOR - Approval at local level

The local plumbing inspector shall review all First Time System Variance requests prior to rendering a decision. I, Jonathan Roud the undersigned, have visited the above property and find that the variance request submitted by the applicant does not conform with certain provisions of the wastewater disposal rules. The variance request submitted by the applicant is the best alternative for a subsurface wastewater disposal system on this property. The proposed system does does not conflict with any provisions controlling subsurface wastewater disposal in the shoreland zone. Therefore, I do do not approve the requested variance. I will will not issue a permit for the system's installation as proposed by the application.

LPI Signature 11/28/12
Date

LOCAL PLUMBING INSPECTOR - Referral to the Department

The local plumbing inspector shall review all First Time System Variance requests prior to forwarding to the Division of Environmental Health. I, _____ the undersigned, have visited the above property and find that the variance request submitted by the applicant does not conform with certain provisions of the wastewater disposal rules. The variance request submitted by the applicant is the best alternative for a subsurface wastewater disposal system on this property. The proposed system does does not conflict with any provisions controlling subsurface wastewater disposal in the shoreland zone. Therefore, I do do not recommend the issuance of a permit for the system's installation as proposed by the application.

LPI Signature Date

FOR USE BY THE DEPARTMENT ONLY

The Department has reviewed the variance(s) and does does not give its approval. Any additional requirements, recommendations, or reasons for the Variance denial, are given in the attached letter.

SIGNATURE OF THE DEPARTMENT DATE

- Notes: 1. Variances for soil conditions may be approved at the local level as long as the total point assessment is at least the minimum allowed. (See Section 7 B 4 of the Subsurface Wastewater Disposal Rules for Municipal Review.)
2. Variances for other than soil conditions or soil conditions beyond the limit of the LPI's authority are to be submitted to the Department for review. (See Section 7 B 3 for Department Review.) The LPI's signature is required on these variance requests prior to sending them to the Department.

SOIL, SITE AND ENGINEERING FACTORS FOR FIRST TIME SYSTEM VARIANCE ASSESSMENT WITH LIMITING SOIL DRAINAGE CONDITIONS (SEE TABLES 7C THROUGH 7M).

	CHARACTERISTIC	POINT ASSESSMENT
Soil Profile		
Depth to Groundwater/Restrictive Layer		
Terrain		
Size of Property		
Waterbody Setback		
Water Supply		
Type of Development		
Disposal Area Adjustment		
Vertical Separation Distance		
Additional Treatment		
TOTAL POINT ASSESSMENT:		

Minimum Points (Check One) Outside Shoreland Zone-50 Inside Shoreland Zone-65 Subdivision-65

REPLACEMENT SYSTEM VARIANCE REQUEST ATTACHMENT

Table 8A

Setback Distances for Replacement System, Limits of LPI Authority

VARIANCE CATEGORY	LIMIT OF LPI'S APPROVAL AUTHORITY						VARIANCE REQUESTED TO	
	Disposal Fields (total design flow)			Septic Tanks and Holding Tanks (total design flow)			Disposal Fields	Septic Tanks
	Less than 1000 gpd	1000 to 2000 gpd	Over 2000 gpd	Less than 1000 gpd	1000 to 2000 gpd	Over 2000 gpd	To	To
SOILS								
Soil Profile	Ground Water Table						inches	
Soil Condition	Restrictive Layer						inches	
from HHE-200	Bedrock						inches	
Site Features vs. disposal system components of various sizes	Disposal Fields (total design flow)			Septic Tanks and Holding Tanks (total design flow)			Disposal Fields	Septic Tanks
	Less than 1000 gpd	1000 to 2000 gpd	Over 2000 gpd	Less than 1000 gpd	1000 to 2000 gpd	Over 2000 gpd	To	To
Wells with water usage of 2000 or more gpd or public water supply wells	300 ft	300 ft	300 ft	150 ft	150 ft	150 ft		
Potable Supply Well	100 down to 60 ft	200 down to 100 ft	300 down to 150 ft	50 down to 25 ft	100 down to 50 ft	100 down to 50 ft		
Water supply line	10 ft	20 ft	25 ft	10 ft	10 ft	10 ft		
Water course, major	100 down to 50 ft	200 down to 120 ft	300 down to 180 ft	100 down to 25 ft [a]	100 down to 50 ft	100 down to 50 ft		
Water course, minor	50 down to 20 ft	100 down to 50 ft	150 down to 75 ft	50 down to 25 ft	50 down to 25 ft	50 down to 25 ft		
Drainage ditches	25 down to 12 ft	50 down to 25 ft	75 down to 35 ft	25 down to 12 ft	25 down to 12 ft	25 down to 12 ft		
Edge of fill extension -- Coastal wetlands, special freshwater wetlands, great ponds, rivers, streams	20 ft	25 ft	25 ft	25 ft	25 ft	25 ft		
Slopes greater than 3:1	10 ft	18 ft	25 ft	N/A	N/A	N/A		
No full basement [e.g. slab]	15 down to 7 ft	30 down to 15 ft	40 down to 20 ft	8 down to 5 ft	14 down to 7 ft	20 down to 10 ft		
Full basement [below grade foundation, frost wall, columns]	20 down to 10 ft	30 down to 15 ft	40 down to 20 ft	8 down to 5 ft	14 down to 7 ft	20 down to 10 ft	11'	
Property lines	10 down to 5 ft [b]	18 down to 9 ft [b]	20 down to 10 ft [b]	10 down to 4 ft [b]	15 down to 7 ft [b]	20 down to 10 ft [b]		
Burial sites or graveyards boundaries, measured from the down toe of the fill extension	25 ft	25 ft	25 ft	25 ft	25 ft	25 ft		
Stormwater infiltration systems	100 down to 60 feet	200 down to 120 feet	300 down to 180 feet	100 down to 50 feet	100 down to 50 feet	100 down to 50 feet		
Wetponds, retention ponds, and detention basins (excavated below grade). Soil filters underdrained swales, underdrained outlets, and similar structures	50 down to 25 feet	100 down to 50 feet	150 down to 75 feet	50 down to 25 feet	50 down to 25 feet	50 down to 25 feet		
Stormwater detention basins (basin bottom at or above predevelopment grade)	25 down to 12 feet	50 down to 25 feet	75 down to 35 feet	25 down to 12 feet	25 down to 12 feet	25 down to 12 feet		
OTHER								
1								
2								
3								

Notes:

[a] This distance may be reduced to 25 feet, if the septic or holding tank is tested in LPI's presence and shown to be watertight or of monolithic construction.

[b] Additional setbacks may be needed to prevent fill material extensions from encroaching onto abutting property.

[c] All ground disturbance or clearing of woody vegetation necessary for the installation of a subsurface wastewater disposal system that occurs within 100 feet of the normal high water mark of a major water body/course must comply with these Rules pertaining to work adjacent to or within wetlands and waterbodies (see Section 11(M)).

SUBSURFACE WASTEWATER DISPOSAL SYSTEM APPLICATION

Maine Dept. Health & Human Services
Div. of Environmental Health 11 SHS
(207) 287-6672 FAX (207) 287-3168

PROPERTY LOCATION

>>CAUTION: LPI APPROVAL REQUIRED<<

City, Town, or Plantation: **PORTLAND (PEAKS ISLAND)**
Street or Road: **531 ISLAND AVENUE**
Subdivision, Lot #:

Town/City: _____ Permit #: _____
Date Permit Issued: _____ Fee \$ _____ Double Fee Charged:
Local Plumbing Inspector Signature: *[Signature]* LPI # **1081**

OWNER/APPLICANT INFORMATION

Name (last, first, MI): **N/F MACLEOD KRISTEN** Owner Applicant
Mailing Address of Applicant: **MONICA STEVENSON**
548 ISLAND AVENUE
PEAKS ISLAND, MAINE 04108
Daytime Tel: # _____

The Subsurface Wastewater Disposal System ~~shall not~~ be installed until a Permit is issued by the Local Plumbing Inspector. The Permit shall authorize the owner or installer to install the disposal system in accordance with this application and the Maine Subsurface Wastewater Disposal Rules.

Municipal Tax Map # **90** Lot # **R 12**

OWNER OR APPLICANT STATEMENT

I state and acknowledge that the information submitted is correct to the best of my knowledge and understand that any falsification is reason for the Department and/or Local Plumbing Inspector to deny a permit.

CAUTION INSPECTION REQUIRED

I have inspected the installation authorized above and found it to be in compliance with the Subsurface Wastewater Disposal Rules Application.

[Signature] 11/27/12
Signature of Owner/Applicant Date

Local Plumbing Inspector Signature (1st) Date Approved

(2nd) Date Approved

PERMIT INFORMATION

TYPE OF APPLICATION

- 1. First Time System
- 2. Replacement System
Type Replaced: **CESSPOOL**
Year Installed: **PRE-1974**
- 3. Expanded System
 - a. <25% Expansion
 - b. >25% Expansion
- 4. Experimental System
- 5. Seasonal Conversion

SIZE OF PROPERTY

+/- **10,000** SQ. FT. ACRES

SHORELAND ZONING

Yes No

THIS APPLICATION REQUIRES

- 1. No Rule Variance
- 2. First Time System Variance
 - a. Local Plumbing Inspector Approval
 - b. State & Local Plumbing Inspector Approval
- 3. Replacement System Variance
 - a. Local Plumbing Inspector Approval
 - b. State & Local Plumbing Inspector Approval
- 4. Minimum Lot Size Variance
- 5. Seasonal Conversion Permit

DISPOSAL SYSTEM TO SERVE

- 1. Single Family Dwelling Unit, No. of Bedrooms **4**
- 2. Multiple Family Dwelling, No. of Units
- 3. Other

(specify)

Current Use Seasonal Year Round Undeveloped

DISPOSAL SYSTEM COMPONENTS

- 1. Complete Non-Engineered System
- 2. Primitive System (graywater & airt toilet)
- 3. Alternative Toilet specify:
- 4. Non-Engineered Treatment Tank (only)
- 5. Holding Tank, _____ gallons
- 6. Non-Engineered Disposal Field (only)
- 7. Separated Laundry System
- 8. Complete Engineered System (2000gpd+)
- 9. Engineered Treatment Tank (only)
- 10. Engineered Disposal Field (only)
- 11. Pre-treatment, specify:
- 12. Miscellaneous components

TYPE OF WATER SUPPLY

- 1. Drilled Well ...
- 2. Dug Well
- 3. Private
- 4. Public
- 5. Other

DESIGN DETAILS (SYSTEM LAYOUT SHOWN ON PAGE 3)

TREATMENT TANK

- 1. Concrete
 - a. Regular
 - b. Low Profile
- 2. Plastic
- 3. Other

CAPACITY: **1000** GAL

SOIL DATA & DESIGN CLASS

PROFILE: **3** CONDITION: **C**

at Observation Hole # **TP 1**
Depth **34**"
of Most Limiting Soil Factor:

DISPOSAL FIELD TYPE & SIZE

- 1. Stone Bed
- 2. Stone Trench
- 3. Proprietary Device
 - a. Cluster array
 - b. Regular
 - c. Linear
 - d. H-20 loaded
- 4. Other:

DISPOSAL FIELD SIZING

- 1. Medium - 2.6 sq ft./gpd
- 2. Medium-Large - 3.3 sq ft./gpd
- 3. Large - 4.1 sq ft./gpd
- 4. Extra-Large - 5.0 sq ft./gpd

GARBAGE DISPOSAL UNIT

- 1. No
 - 2. Yes
 - 3. Maybe
- If Yes or Maybe, specify one below:
- a. Multi-compartment tank
 - b. tanks in series
 - c. increase in tank capacity
 - d. Filter on tank outlet

EFFLUENT/EJECTOR PUMP

- 1. Not required
 - 2. May be required
 - 3. Required
- Specify only for engineered systems

DOSE: _____ gallons

DESIGN FLOW

360 gallons per day
BASED ON:
1. Table 4A (dwelling units)
2. Table 4C (other facilities)
SHOW CALCULATIONS for other facilities

4 BEDROOMS AT 90 GALLONS PER DAY EACH

3. Section 4G (meter readings)
ATTACH WATER-METER DATA
LATITUDE AND LONGITUDE
at center of disposal area
Lat **N 43 d 40 m 8 s**
Lon **W 70 d 11 m 49 s**
(1/4 degree state margin of error)

SITE EVALUATOR STATEMENT

I certify that on **9/7/12** (date) I completed a site evaluation on this property and state that the data reported is accurate and that the proposed system is in compliance with the Subsurface Wastewater Disposal Rules (10-144A CMR 241)

[Signature]
Site Evaluator Signature

43
SE #

11/27/12 REVISED
Date

ALBERT FRICK
Site Evaluator Name Printed

(207) 839-5563
Telephone Number

ALBERT@ALBERTFRICK.COM
E-mail Address

ALBERT FRICK ASSOCIATES - 95A COUNTY ROAD ROAD GORHAM, MAINE 04038 - (207) 839-5563
Note: Changes to or deviations from the design should be confirmed with the Site Evaluator

Page 1 of 3
HHE-200 Rev. 02/2011

SUBSURFACE WASTEWATER DISPOSAL SYSTEM APPLICATION

PORTLAND (PEAKS ISLAND)

53 ISLAND AVENUE

N/F MACLEOD (FOR MONICA STEVENSON)
40

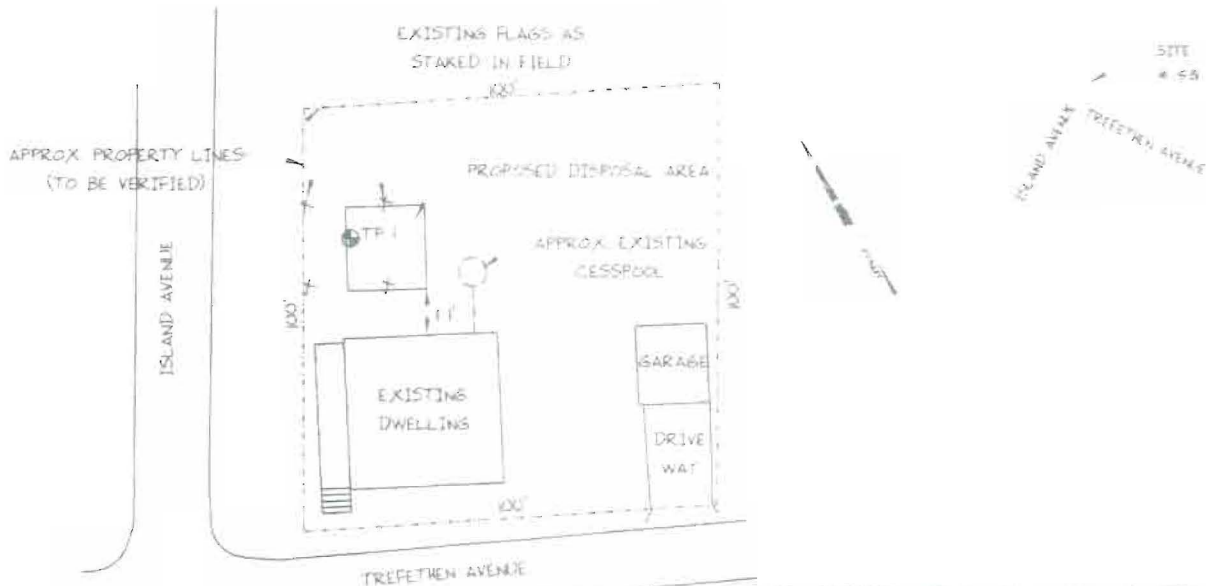

NOTE: PROPERTY INFORMATION APPROXIMATED PER TOWN TAX MAP AND AERIAL PHOTOGRAPH. VERIFY LOT LINES TO ASSURE PROPER SETBACKS. VERIFY WATER LINE LOCATION TO ASSURE PROPER SETBACKS. RELOCATE IF NECESSARY.

SOIL DESCRIPTION AND CLASSIFICATION (Location of Observation Holes Shown Above)

TP 1 ■

SANDY LOAM		DARK BROWN
LOAMY SAND		DARK YEL BROWN
FRIABLE		
MEDIUM SAND		YELLOWISH BROWN
LOAMY FINE SAND	FIRM	OLIVE BROWN
COMMON, DISTINCT		
LIMIT OF EXCAVATION		
3'	C	6-8' 34"

Albert Frick

163

11/27/12 REVISED

SUBSURFACE WASTEWATER DISPOSAL SYSTEM APPLICATION

PORTLAND (PEAKS ISLAND)

53 ISLAND AVENUE

N/F MACLEOD (FOR MONICA STEVENSON)

SUBSURFACE WASTEWATER DISPOSAL PLAN

20

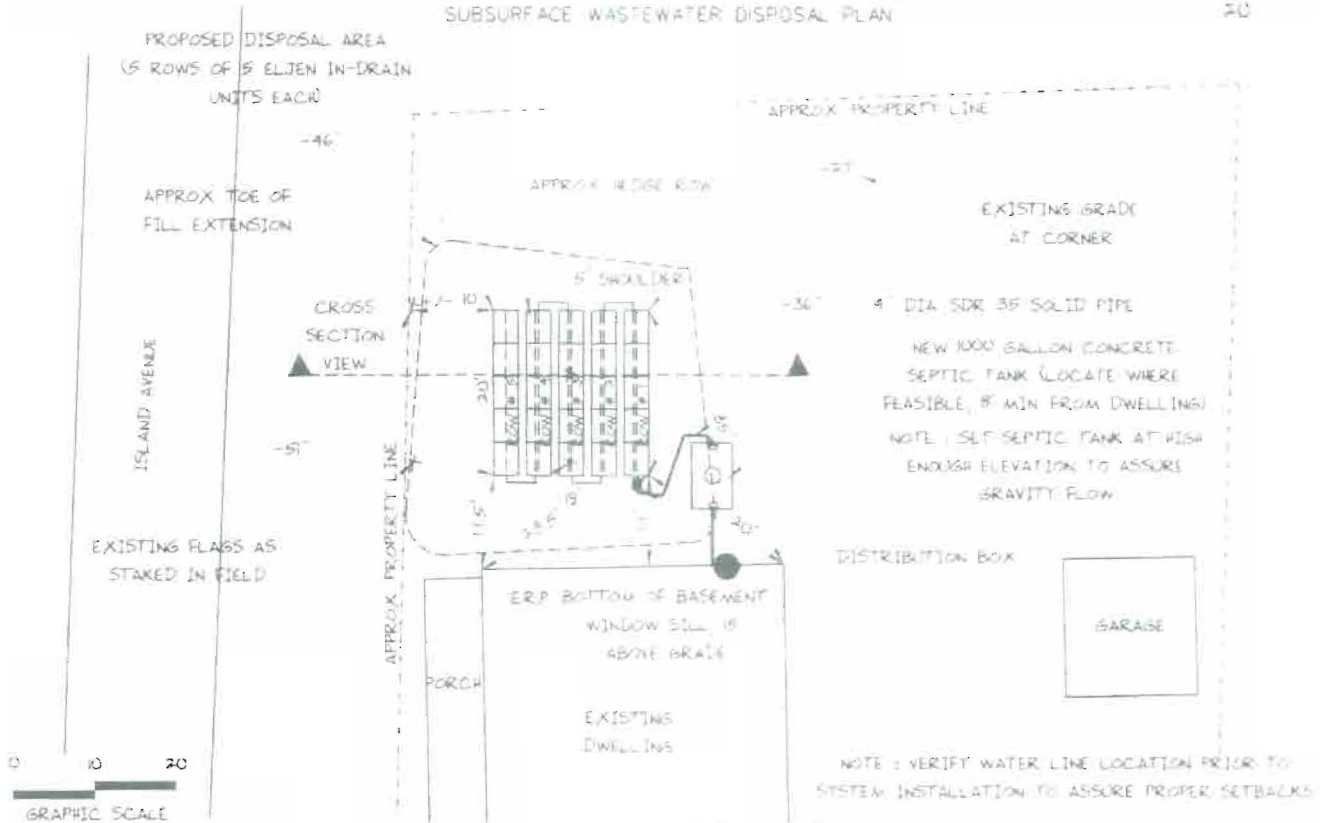

FILL REQUIREMENTS

- Depth of Fill (Upslope) = 1'-8"
- Depth of Fill (Downslope) = 4'-9"

CONSTRUCTION ELEVATIONS

- Finished Grade Elevation
- Top of Distribution Pipe or Proprietary Device
- Bottom of Disposal Area

SEE DETAIL BELOW

ELEVATION REFERENCE POINT
Location & Description: BOTTOM OF BASEMENT WINDOW SILL IS ABOVE GRADE
Reference Elevation is 0.0' or -----

4" DIA PERFORATED DISTRIBUTION PIPE

+/- 3'-5" FILL EXT. SHOULDER

DISPOSAL AREA CROSS SECTION

BRVELLY COARSE SAND

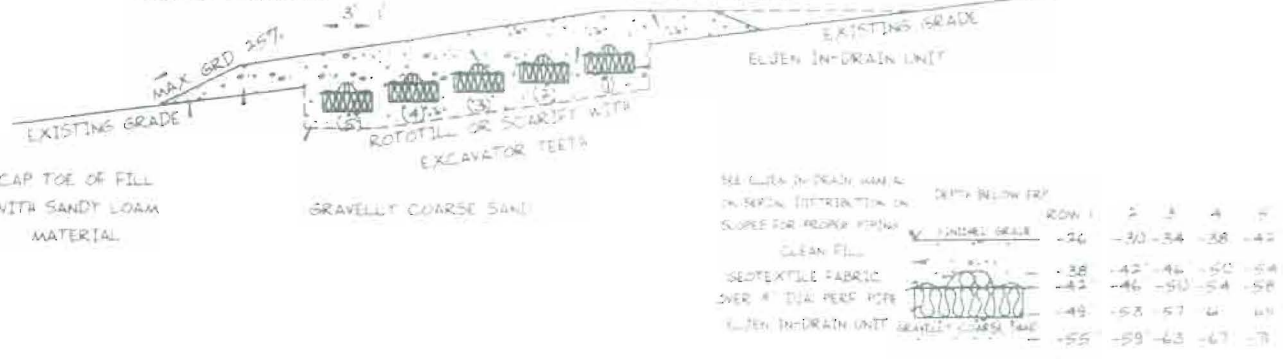

Albert Frick

163

11/29/12 REVISED